

SUBMITTAL TO THE BOARD OF SUPERVISORS
COUNTY OF RIVERSIDE, STATE OF CALIFORNIA

329B



FROM: TLMA – Transportation Dept. SUBMITTAL DATE: June 9, 2003

SUBJECT: Approval of TRACT 28880-1 (and Common Facilities for Tracts 28880, 28880-1, 28880-2, 28880-3, and 28880-4)
Schedule "A" Subdivisions in the Eastvale Area

RECOMMENDED MOTION: That the Board approve the Improvement Agreements and Securities as approved by County Counsel, approve the final map and authorize the Chairman to sign the Improvement Agreements for Tract 28880-1 (and Common Facilities for Tracts 28880, 28880-1, 28880-2, 28880-3, and 28880-4) and the map for Tract 28880-1.

BACKGROUND: This map complies in all respects with the provisions of Division 3 of Title 15 of the Government Code and applicable local ordinances. The developer desires to enter into Improvement Agreements to guarantee the construction of the required improvements and has submitted Improvement Agreements and Securities which have been approved by County Counsel. The developer desires to enter into Improvement Agreements to guarantee the construction of the required improvements for Tract 28880-1 and common facilities improvements necessary for the above tracts, which may not be recorded at this time. This submittal of common agreements and securities eliminates the need for duplicate bonding for said improvements. All Improvement Agreements and Securities which have been approved by County Counsel.

REVIEWED BY EXECUTIVE OFFICE
[Signature]
DATE: 6/16/03

[Signature]
George A. Johnson
Director of Transportation

HS:lf
Submittals: Final Map
Road/Drainage Improvement Agrmts
Water System Improvement Agrmts
Sewer System Improvement Agrmts
Survey Monument Agreements

Policy
 Policy

Department Recommendation: Consent
Per Executive Office: Consent

05 JUN 12 11:51

ATTACHMENTS FILED
WITH THE CLERK OF THE BOARD

2.28

TR 28880-01

Eastvale

District 2

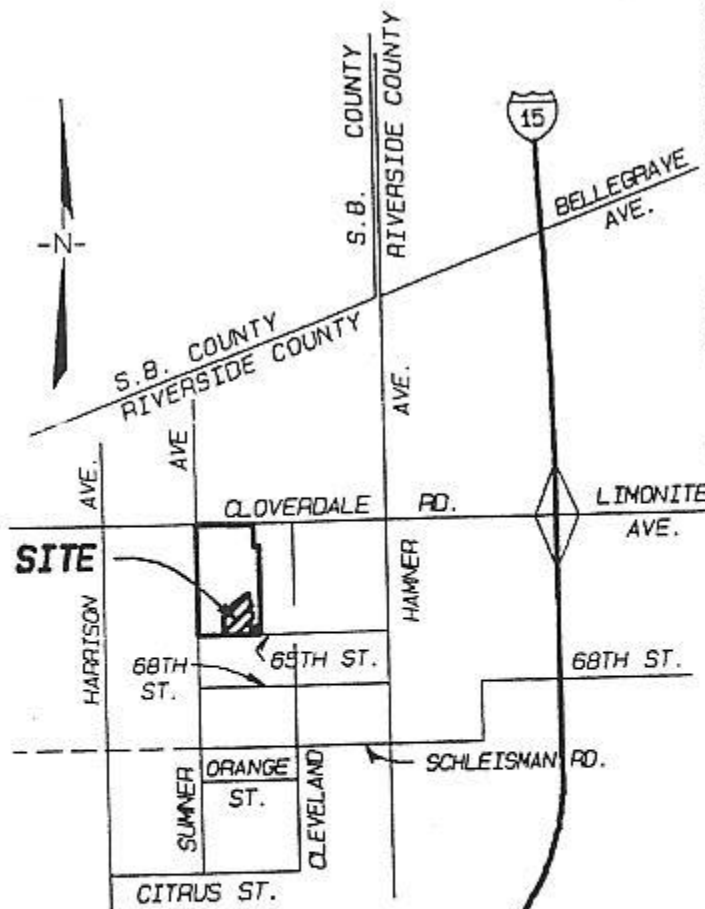

VICINITY MAP
NOT TO SCALE