

SUBMITTAL TO THE BOARD OF SUPERVISORS
COUNTY OF RIVERSIDE, STATE OF CALIFORNIA

606B



FROM: TLMA – Transportation Dept.

SUBMITTAL DATE: July 7, 2003

SUBJECT: Summarily vacating the right to accept a 60 foot wide road, in the Menifee area, Third Supervisorial District.

RECOMMENDED MOTION: That the Board adopt Resolution No. 2003-80, Summarily vacating a 60 foot wide road.

BACKGROUND: This vacation was requested by one of the two adjoining property owner's in order to expand their property to the centerline of the 60 foot wide road easement. The second property owner does not object to the vacation and their property will also expand to the centerline. No parcels will be landlocked as a result of this vacation. Transportation has reviewed this vacation request and has no objection.

REVIEWED BY EXECUTIVE OFFICE
James R. Hight
DATE 7/8/03

FORM APPROVED
COUNTY COUNSEL

MAY 14 2003
BY *Sharon V. Ubo*

George A. Johnson
George A. Johnson
Director of Transportation

VJL
Attachments: Resolution No. 2003-80
Vicinity Map
Exhibits

Department Recommendation: Consent Policy
Per Executive Office: Consent Policy

Prev. Agn. Ref.

Dist. 3

AGENDA NO.

2
3 RESOLUTION NO. 2003-80

4
5 SUMMARILY VACATING THE RIGHT TO ACCEPT
6 A 60 FOOT WIDE ROAD, IN THE MENIFEE AREA
7 (AB02018)
8 (THIRD SUPERVISORIAL DISTRICT)
9

10 **WHEREAS**, the hereinafter described 60 foot wide road was dedicated to the County
11 as Lot "F" and Lot "G" per Amended Parcel Map 10275, recorded in Book 80, Page 18,
12 inclusive, records of the County Recorder, Riverside County, California, and,
13

14 **WHEREAS**, the offer of dedication for said 60 foot wide road has not been accepted
15 by the County of Riverside; and,
16

17 **WHEREAS**, the hereinafter-described 60 foot wide road is not necessary and is
18 excess interest and not required for public street and highway purposes; now, therefore;
19

20 **BE IT RESOLVED, DETERMINED AND ORDERED** by the Board of Supervisors of
21 the County of Riverside, State of California, in regular session assembled on
22 July 15 , 2003, as follows:

23 ///
24 ///
25 ///
26 ///
27 ///

1 RESOLUTION NO. 2003-80

2
3 1. Pursuant to Section 8334(a) of the Streets and Highways Code that the hereinafter
4 described 60 foot wide road is an excess interest not required for highway purposes and is
5 hereby summarily vacated:

6
7 SEE LEGAL DESCRIPTION ATTACHED HERETO
8 AS EXHIBITS "A" AND "B" AND MADE A PART HEREOF

9
10 **EXCEPTING AND RESERVING** from the vacation any easement for any existing
11 public utilities and public services facilities, together with the right to maintain, operate,
12 replace, remove or renew such facilities, pursuant to Section 8340 of the Streets and
13 Highways Code.

14
15 2. That the herein-described 60 foot wide road is unnecessary for present or
16 prospective public use, including use as a non-motorized transportation facility.

17
18 **BE IT FURTHER RESOLVED, DETERMINED AND ORDERED** that the Clerk of this
19 Board shall cause a certified copy of this resolution to be recorded in the Office of the County
20 Recorder of the County of Riverside, California.

21
22
23
24
25
26 WO#AB02018

27 VJL

FORM APPROVED
COUNTY COUNSEL

MAY 14 2003

BY Arden V. Ubo

EXHIBIT "A"

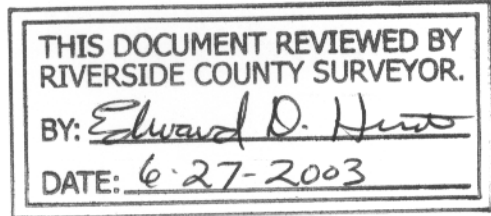

In the County of Riverside, State of California, Lying within Section 30, Township 5 South, Range 2 West, S. B. M., being all those portions of Lots "D", "E", "F", "G", "L" and "M" of Parcel Map No. 10275, as shown by map on file in Book 80, Page 18, of Parcel Maps, records of said County and State, described as follows;

Beginning at the northeast corner of said Lot "L";

Thence North 00° 01' 50" East, along the west line of said Lot "G", a distance of 1228.81 feet to the southeast corner of said Lot "D";

Thence North 45° 05' 55" West, along the south line of said Lot "D", a distance of 21.26 feet to an angle point therein, said point being 30.00 feet south of the center line of Grand Avenue, as measured at right angles thereto, as shown on said map;

Thence North 89° 46' 20" East, parallel with said center line a distance of 90.00 feet to an angle point in the southerly line of said Lot "E";

Thence South 44° 54' 05" West, along the southerly line of said Lot "E", a distance of 21.16 feet, to the east line of said Lot "F";

Thence South 00° 01' 50" West, along said east line, a distance of 1228.97 feet, to the northwest corner of said Lot "M";

Thence along the northerly line of said Lot "M", South 45° 02' 48" East, a distance of 21.24 feet, to a line parallel with and 30 feet north of, the south line of said Lot "M", as measured at right angles to;

Thence South 89° 52' 34" West, along said parallel line, a distance of 90.00 feet, to an angle point in the north line of said Lot "L";

Thence North 44° 57' 12" East, along the north line of said Lot "L", a distance of 21.18 feet, to the **Point of Beginning**.

Containing 1.74 ac. more or less.

See plat attached hereto as exhibit "B"

Prepared on January 13, 2003 by: Chester F. Ralston PLS 5174



EXHIBIT "B"

N 89°46'20"E
90.00'

N 89°46'20"E 1132.38'

N 89°46'20"E 377.45'

LOT D

LOT E

N45°05'55"W
21.26'

332.60'

PORTION
OF LOT D

S44°54'05"W
21.16'

PORTION
OF LOT E

BRIGGS ROAD



SCALE: 1" = 100'

30' 30'

N 00°01'50"E 1228.81'

1258.89'

S 00°01'50"W 1228.97'



Chester F. Ralston

PARCEL 3

PARCEL 4

PM 80 / 18

LOT G
LOT F

30' 30'

PORTION
OF LOT M

P.O.B.

N 44°57'12"E
21.18'

PORTION
OF LOT L

S 45°02'48"E
21.24'

336.00'

LOT L

LOT M

S 89°52'34"W
90.00'

SECTION 30, T. 5 S, R. 2 W., S.B.M.

THIS DOCUMENT REVIEWED BY
RIVERSIDE COUNTY SURVEYOR.
BY: *Edward D. Hunt*
DATE: *6-27-2003*

AB02018

Vacate 60' wide road

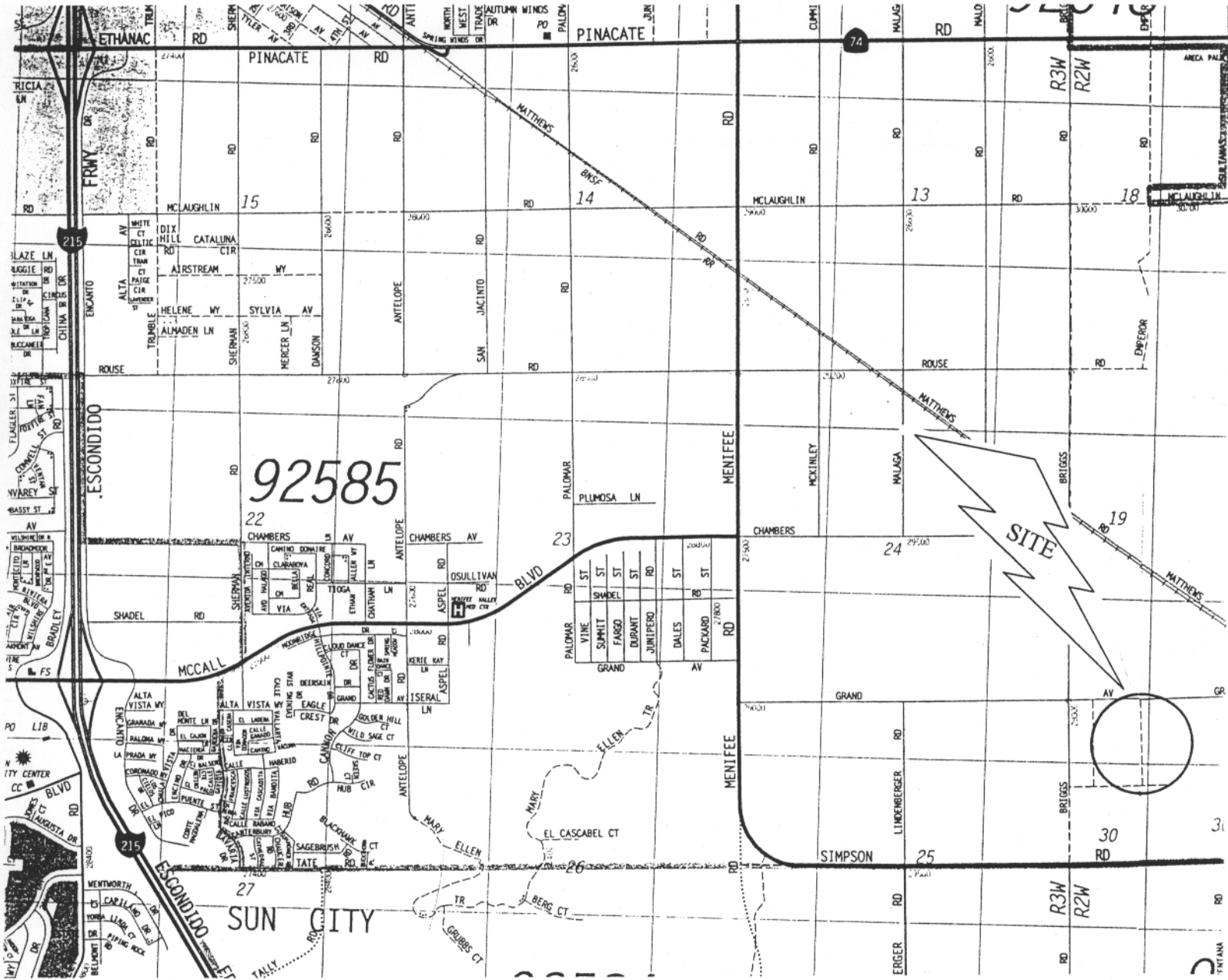

Vicinity map