

510

**SUBMITTAL TO THE BOARD OF SUPERVISORS  
COUNTY OF RIVERSIDE, STATE OF CALIFORNIA**

255A



**FROM:** Department of Facilities Management

**SUBMITTAL DATE:**  
August 20, 2003

**SUBJECT:** NOTICE OF INTENT TO CONDEMN REAL PROPERTY FOR FREEWAY IMPROVEMENT PURPOSES-STATE OF CALIFORNIA, DEPARTMENT OF TRANSPORTATION - INTERSTATE 215/91/60 SEQUENCING PROJECT

**RECOMMENDED MOTION:** That the Board of Supervisors consider approving Resolution 2003-408, Notice of Intent to Condemn Real Property for Caltrans Parcel 18027 for freeway improvement purposes, on behalf of the State of California, Department of Transportation (Caltrans), for the Interstate 215/91/60 Sequencing Project, and to set a public hearing for Resolution 2003-415, Authorizing Condemnation of Real Property for Freeway Improvement Purposes, on October 7, 2003.

Departmental Concurrence

**BACKGROUND:** Pursuant to Minute Order 3.33 approved by the Board of Supervisors on November 26, 2002, a resolution was passed agreeing to hear Resolutions authorizing Condemnation on behalf of the State of California, Department of Transportation. As a prelude thereto, it is necessary for the Board to consider adopting Resolutions of Notice of Intent to Condemn Real Property for parcels affected by the project.

*Michael J. Sylvester*  
MICHAEL J. SYLVESTER, Director  
Department of Facilities Management

MJS:JMP:JS:sh  
8.579

<b>FINANCIAL DATA</b>	Current F.Y. Total Cost:	\$ 0	In Current Year Budget:	Yes
	Current F.Y. Net County Cost:	0	Budget Adjustment:	N/A
	Annual Net County Cost:	0	For Fiscal Year:	N/A

<b>SOURCE OF FUNDS:</b> State of California, Department of Transportation	Positions To Be Deleted Per A-30	<input type="checkbox"/>
	Requires 4/5 Vote	<input type="checkbox"/>

**C.E.O. RECOMMENDATION:** **APPROVE**

Dep't Recomm.:  Policy  
Per Exec. Ofc.:  Policy  
 Consent  
 Consent

County Executive Office Signature

*[Signature]*

Prev. Agn. Ref.:

District: 1, 2, 5

Agenda Number:

3 35

1  
2  
3  
4  
5  
6  
7  
8  
9  
10  
11  
12  
13  
14  
15  
16  
17  
18  
19  
20  
21  
22  
23  
24  
25  
26  
27  
28

RESOLUTION NO. 2003-408

NOTICE OF INTENTION TO CONDEMN REAL PROPERTY  
FOR FREEWAY IMPROVEMENT PURPOSES

BE IT RESOLVED, FOUND, DETERMINED, AND ORDERED by the Board of Supervisors of Riverside County, State of California, in regular session assembled on September 9, 2003, and NOTICE IS HEREBY GIVEN as follows:

1. That this Board will consider passing a resolution of necessity authorizing the condemnation of certain parcels of real property for freeway improvement purposes described as portions of Assessor's Parcel Number 263-030-059, also known as Caltrans Parcel #18027, shown as legal descriptions and plat maps on file in the Office of the Clerk of the Board, and located in Riverside, and to hold a public hearing on October 7, 2003, at 9:30 a.m. in the meeting room of the Board of Supervisors located on the 1st Floor, County Administrative Center Annex, 4080 Lemon Street, Riverside, California, at which time the person or entity whose real property is sought to be condemned and whose name and address appears on the last equalized County Assessment Roll and who has filed a timely written request to appear and be heard, will be given an opportunity to be heard on the following matters:

a. Whether the public interest and necessity require the construction of the public improvement.

1  
2  
3  
4  
5  
6  
7  
8  
9  
10  
11  
12  
13  
14  
15  
16  
17  
18  
19  
20  
21  
22  
23  
24  
25  
26  
27  
28

b. Whether the public improvement is planned and located in the manner that will be most compatible with the greatest public good and the least private injury.

c. Whether the real property sought to be acquired is necessary for the construction of the public improvement.

2. That the failure of any person, whose real property is sought to be condemned, to file a written request to appear and be heard with the Clerk of the Board within 15 days after a copy of the resolution is mailed to, or personally served upon such person, will result in his or her waiver of the right to appear and be heard.

BE IT FURTHER RESOLVED that the State of California, Department of Transportation, has caused a letter of intent, see attached, and a copy of the right of way map to be mailed to or personally served upon each person or entity whose real property is sought to be condemned and whose name and address appears on the last equalized County Assessment Roll.

JS:sh  
8/14/03  
8.580

FORM APPROVED  
COUNTY COUNSEL  
AUG 18 2003  
BY   
ASSISTANT COUNTY COUNSEL

1 PARCEL No. 18027-1

2 For freeway purposes Parcel 1 of Parcel Map No. 28649, in the City of Riverside, County  
3 of Riverside, State of California, as shown on map filed in Book 192 of Parcel Maps, Pages 65  
4 through 66, inclusive, in the office of the County Recorder of said County.

5 / / / / / / / / / / / / / /

6 **Except** an undivided 50% interest in and to all minerals, oil, gas and other hydrocarbon  
7 substances below a depth of 100.00 feet from the surface of said land, without the right of surface  
8 entry, as said substances are more particularly described in and reserved by Southern Finance  
9 Services, a Corporation in the Document recorded on May 20, 1959, as instrument No. 43386.

10 / / / / / / / / / / / / / /

11 **Also Except** one half of any and all oil, gas and other mineral and mineral rights 500.00  
12 feet or more below the surface, without the right of entry upon the surface as conveyed by deed  
13 recorded July 18, 1960, as instrument No. 63434 of Official Records of Riverside County,  
14 California.

15 / / / / / / / / / / / / / /

16 / / / / / / / / / / / / / /

17 / / / / / / / / / / / / / /

18 / / / / / / / / / / / / / /

19 / / / / / / / / / / / / / /

20 / / / / / / / / / / / / / /

21 / / / / / / / / / / / / / /

22 / / / / / / / / / / / / / /

23 / / / / / / / / / / / / / /

24 This real property description has been prepared by me, or under my direction, in  
25 conformance with the Professional Land Surveyors Act.

26 Signature: R. T. Ynostroza  
Professional Land Surveyor

28 Date: JUNE 27, 2003





DIST.	COUNTY	ROUTE	KILOMETER POST
08	Riv	215	62.40

EXHIBIT "A"

PARCEL 18027-1



T.2.S.; R.4.W.; S.B.M.,  
SECTION 34

COUNTY OF RIVERSIDE

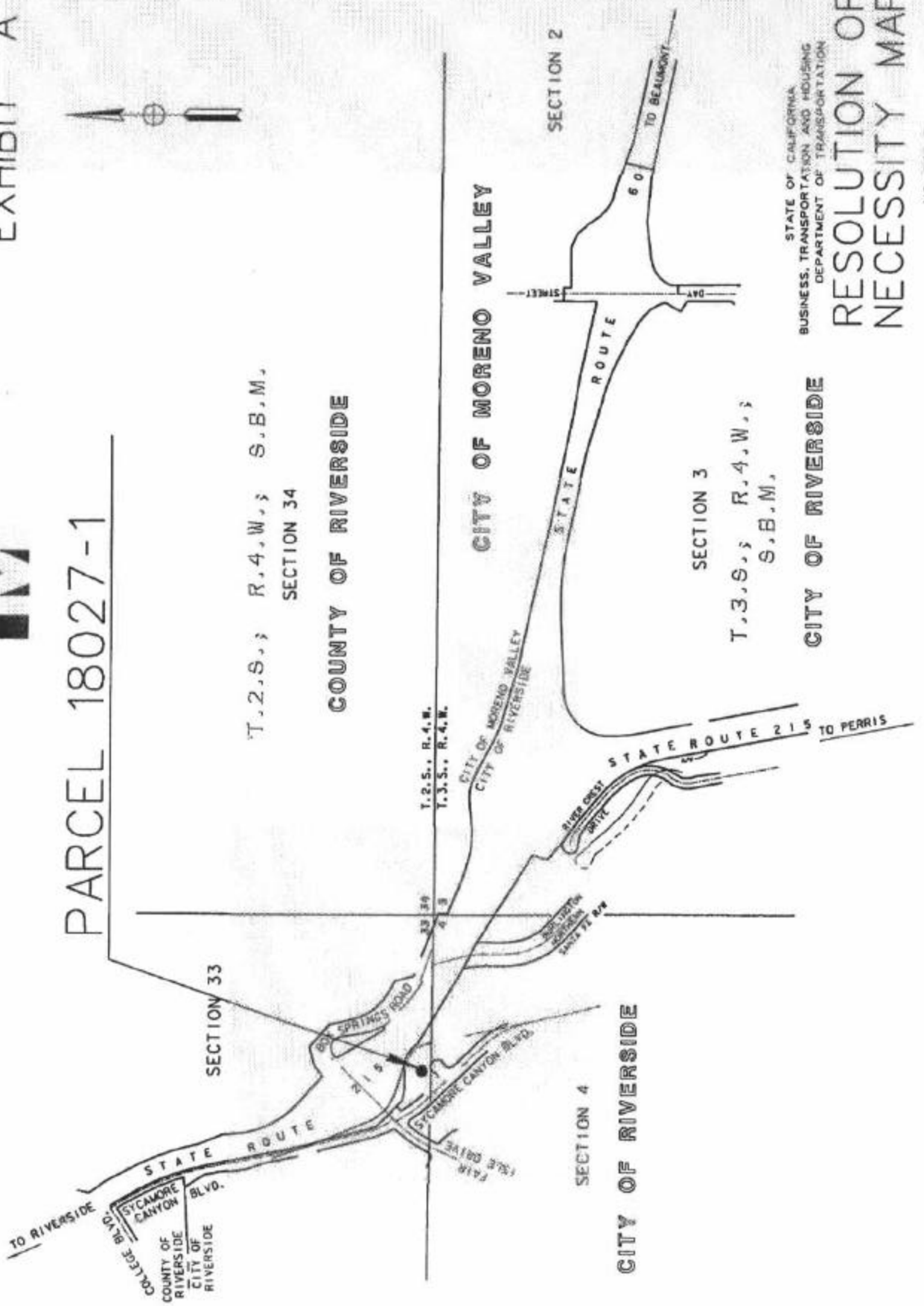

STATE OF CALIFORNIA  
BUSINESS, TRANSPORTATION AND HOUSING  
DEPARTMENT OF TRANSPORTATION

RESOLUTION OF  
NECESSITY MAP

NO SCALE

