

**SUBMITTAL TO THE BOARD OF SUPERVISORS  
COUNTY OF RIVERSIDE, STATE OF CALIFORNIA**

456



**FROM:** TLMA - Transportation Dept.

**SUBMITTAL DATE:** September 15, 2003

**SUBJECT:** Reconstruction and Resurfacing of Various Roads in the Woodcrest area

**RECOMMENDED MOTION:** That the Board of Supervisors approve the plans and specifications for the reconstruction and resurfacing of various roads in the Woodcrest area of Riverside County. Authorize the Clerk to advertise for bids to be received in the office of the Director of Transportation up to the hour of 2:00 pm, Wednesday, October 15, 2003, at which time bids will be opened.

**BACKGROUND:** The Transportation Improvement Program provides for the reconstruction and resurfacing of the streets listed on page two of this submittal. The submitted plans and specifications have been approved as to form by County Counsel. Environmental clearance is complete. Project No. X0307

FORM APPROVED  
COUNTY COUNSEL

SEP 16 2003

BY: *[Signature]*

GAJ:sd

*[Signature]*  
George A. Johnson  
Director of Transportation

(Continued On Attached Page)

**FINANCIAL DATA:**

<b>CURRENT YEAR COST</b>	\$ 513,000	<b>ANNUAL COST:</b>	\$ 0
<b>NET COUNTY COST</b>	\$ 0	<b>IN CURRENT YEAR BUDGET:</b>	Yes/ X No/
		<b>BUDGET ADJUSTMENT:</b>	Yes/ No/ X
		<b>FY:</b>	2003/2004

**SOURCE OF FUNDS:** Measure A/Western, AB2928

**C.E.O. RECOMMENDATION:**

**APPROVE**

*[Signature]*  
County Executive Officer Signature

Department Recommendation:  Policy  
 Consent  
Per Executive Office:  Policy  
 Consent

Prev. Agn. Ref.

Dist. 1

AGENDA NO.

3.43

The streets to be reconstructed and resurfaced are as follows:

- |                     |   |
|---------------------|---|
| 1. King Avenue      | Van Buren Boulevard to Krameria Avenue  |
| 2. Lois Lane        | Krameria Avenue to 661 Ft. northerly    |
| 3. Trisha Way       | Krameria Avenue to 661 Ft. northerly    |
| 4. Sally Lane       | Van Buren Boulevard to Pick Place       |
| 5. Pick Place       | Van Buren Boulevard to Sally Lane       |
| 6. Stoneridge Drive | Stoney Creek Drive to Canyon View Drive |
| 7. Tava Lane        | Suttles Drive to King Avenue            |

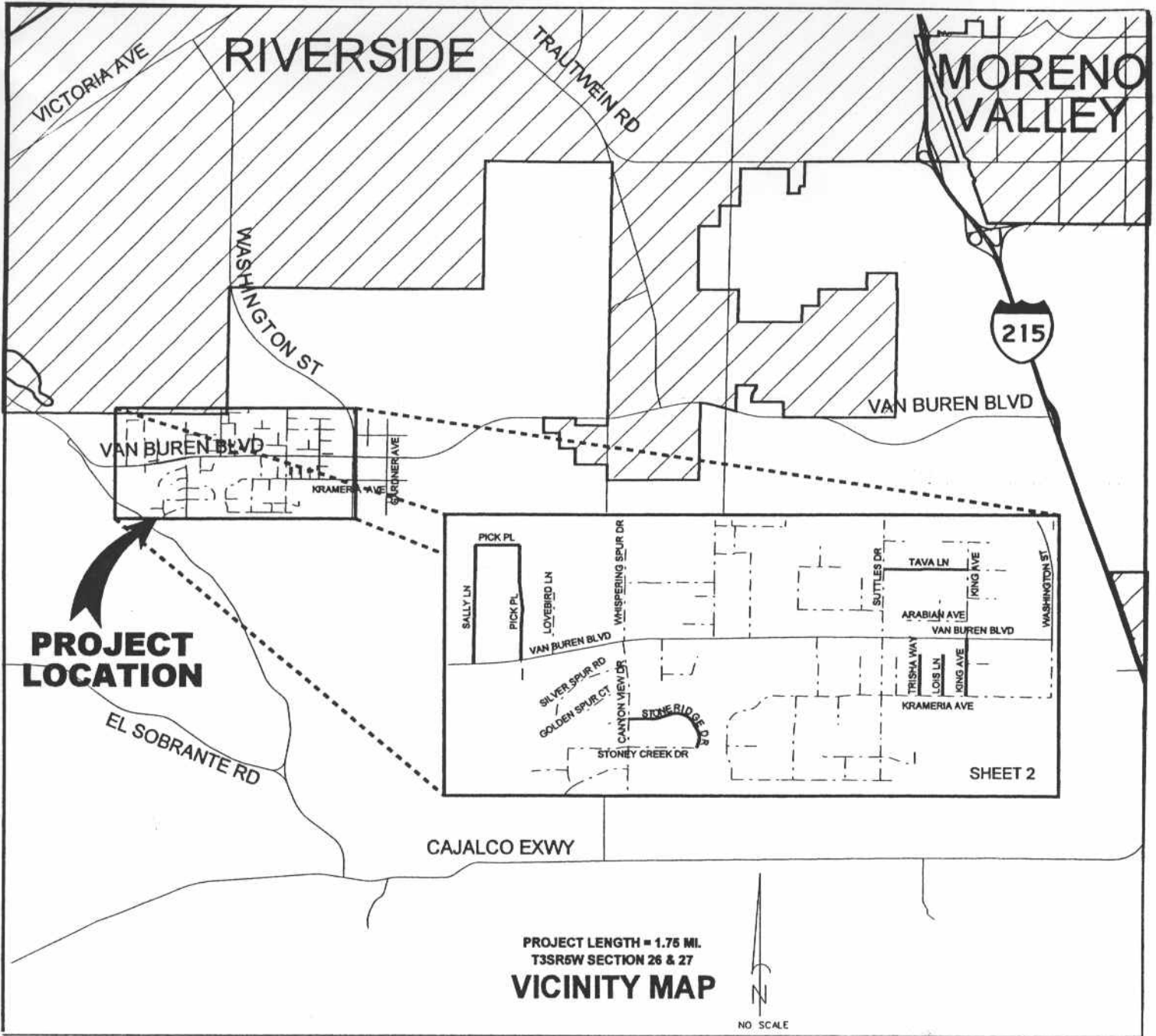

RESURFACING AND RECONSTRUCTION PROJECT

Engineer's Estimate

WOODCREST AREA

W.O.# X0307

ITEM NO	ITEM CODE	ITEM	UNIT	ESTIMATED QUANTITY	BID	AMOUNT
1	190101	ROADWAY EXCAVATION (KING AVE. ONLY ASSUMED AVERAGE DEPTH OF 1.66')	SQYD	3435	3.00	10,305.00
2	190101	ROADWAY EXCAVATION (OTHERS ASSUMED AVG. DEPTH VARIES FROM 0.25' TO 0.29')	SQYD	35945	2.20	79,079.00
3	260201	CLASS 2 AGGREGATE BASE	CY	1495	25.00	37,375.00
4	390103	ASPHALT CONCRETE (TYPE B)	TON	7135	40.00	285,400.00
5	017304	MINOR CONCRETE (CURB & GUTTER) (CRS 200)	LF	115	40.00	4,600.00
6	013903	PLACE ASPHALT CONCRETE DIKE (CRS 212) (6")	LF	15215	3.00	45,645.00
7	017302	MINOR CONCRETE (CROSS - GUTTER) (CRS 209)	SQFT	990	12.00	11,880.00
8	840515	THERMOPLASTIC PAVEMENT MARKING	SQFT	120	5.00	600.00
9	013905	ASPHALT CONCRETE (DRIVEWAY APPROACH) (CRS 206)	EA	4	800.00	3,200.00
10	013902	ASPHALT CONCRETE OVERSIDE DRAIN (CRS 306) (8' IN LENGHT)	EA	3	800.00	2,400.00
11	074020	WATER POLLUTION CONTROL	FA	1	3,000.00	3,000.00
12	170101	DEVELOP WATER SUPPLY	LS	1	3,000.00	3,000.00
13	066102	DUST ABATEMENT	LS	1	3,000.00	3,000.00
14	120100	TRAFFIC CONTROL SYSTEM	LS	1	15,000.00	15,000.00
15	160101	CLEARING AND GRUBBING (INCLUDING TRIMMING AND CUTTING OF TREE ROOTS)	LS	1	5,000.00	5,000.00
16	220101	FINISHING ROADWAY	LS	1	4,000.00	4,000.00

Subtotal: (Items 1-16) Five Hundred Thirteen Thousand Four Hundred Eighty Four Dollars and Zero Cent.

**513,484.00**

CONTINGENCY

999994	CONTINGENCY [ @ 10% ]
--------	-----------------------

**51,348.40**

GRAND TOTAL

FIVE HUNDRED SIXTY FOUR THOUSAND EIGHT HUNDRED THIRTY TWO DOLLARS AND FORTY CENTS.

**564,832.40**

"Words"

ERNIE DINGLASAN

8/28/2003 12:54

Prepared by: \_\_\_\_\_

Checked by: \_\_\_\_\_