

SUBMITTAL TO THE BOARD OF SUPERVISORS
COUNTY OF RIVERSIDE, STATE OF CALIFORNIA

510B



FROM: TLMA – Transportation Dept. SUBMITTAL DATE: October 10, 2003

SUBJECT: **TRACT 28369**
 A Schedule "A" Subdivision in the Eastvale Area
 ONE YEAR GUARANTEE AND MAINTENANCE
 AGREEMENTS

RECOMMENDED MOTION: That the Board approve the attached One Year Guarantee and Maintenance Agreements as approved by County Counsel and authorize the Chairman to sign these agreements for Tract 28369.

BACKGROUND: Improvements have been completed or are approaching completion on this project. Standard Pacific Corp. desires to enter into Maintenance Agreements to guarantee a one year maintenance of the improvements and has submitted agreements and securities which have been approved by County Counsel.

REVIEWED BY EXECUTIVE OFFICE
Jenny S. Wright
DATE 9/30/03

George A. Johnson

George A. Johnson
Director of Transportation

HS:lf
Submittals: Vicinity Map
 Road/Drainage Maintenance Agrmts
 Water System Maintenance Agrmts
 Sewer System Maintenance Agrmts

Department Recommendation: Consent Policy
Per Executive Office: Consent Policy

Prev. Agn. Ref. 06/19/01 - 2.18

Dist. 2

AGENDA NO.

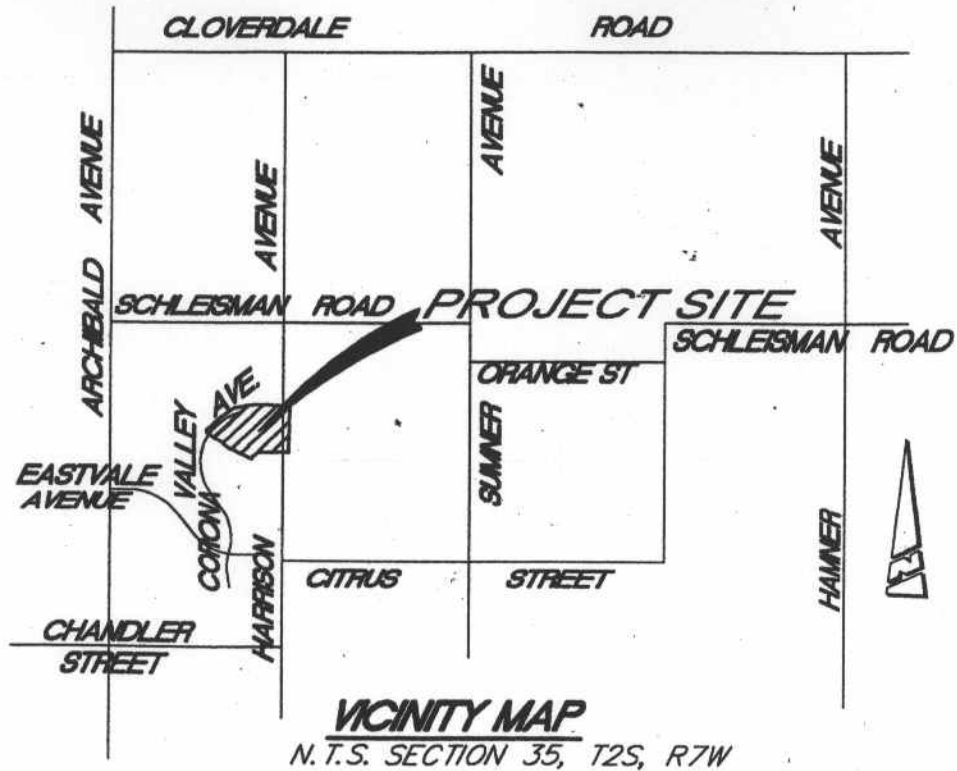

STRUCTION NOTES AND QUANTITY ESTIMATES

4" MIN. A.C. PAVEMENT OVER 7" MIN. COMPACTED AGGREGATE BASE	2,492 TONS
CURB & GUTTER TYPE A-6 PER R.C.T.D. STD. 200	3,982 L.F.
4" P.C.C. SIDEWALK PER R.C.T.D. STD. 400	22,097 S.F.
P.C.C. CROSS GUTTER PER R.C.T.D. STD. 209 & 209A	2,557 S.F.
ACCESS RAMP PER R.C.T.D. STD. 403, CASE A	6 EA.
C.B. NO. 1 PER R.C.F.C. & W.C.D. STD. DWG. NO. CB 100	3 EA.
LOCAL DEPRESSION PER R.C.T.D. STD. 311	3 EA.
P.C.C. DRIVEWAY APPROACH PER R.C.T.D. STD. 207	9,801 S.F.
STREET NAME SIGN PER R.C.T.D. STD. 816	3 EA.
STREET LIGHT (9500 LUMINARES) PER R.C.T.D. STD. 1000	13 EA.
BARRICADE PER R.C.T.D. STD. 810	35 L.F.
EXIST. BARRICADE	4 EA.
OVER EXIST. A.C. FOR SMOOTH JOIN (0.10' MIN. OVERLAY) PER DETAIL ON SHT. 1	3 EA.
CURB & GUTTER TYPE A-8 PER R.C.T.D. STD. 201	1,603 L.F.
TRENCH	2,793 L.F.
TC EMULSION	2.4 TONS
18" R.C.P. (CLASS IV)	46 L.F.
24" R.C.P. (CLASS IV)	14 L.F.
CONCRETE COLLAR PER R.C.F.C. & W.C.D. STD. DWG. NO. M 803	2 EA.
CONCRETE BULKHEAD AND JOIN EXISTING	