

SUBMITTAL TO THE BOARD OF SUPERVISORS
COUNTY OF RIVERSIDE, STATE OF CALIFORNIA

507B



FROM: TLMA - Transportation Dept.

SUBMITTAL DATE: December 15, 2003

SUBJECT: Resolution 413-546 to Establish No-Parking Zones on Skyview Road and Sharon Way, Pedley area

RECOMMENDED MOTION:

That the Board adopt Resolution 413-546 to establish No-Parking Zones on Skyview Road and Sharon Way in the Pedley area, as described in attached Resolution 413-546.

BACKGROUND:

The Transportation Department was contacted by the residents adjacent to Skyview Road concerning the parking of large commercial trucks and trailers. The residents have petitioned to establish parking restrictions on Skyview Road.

Transportation Department staff conducted a field review of the site and determined that, due to the narrow roadway width of Skyview Road, no-parking zones on the segment of Skyview Road between Avenue Juan Bautista and John Muir Drive, and the segment of Sharon Way between Valdez Avenue and Sharon Way, are appropriate. Based on staff contact with the residents, the majority of the affected residents support the proposed No-Parking Zones.

Based on this review, the Transportation Department recommends approval of these No-Parking Zones.

The Transportation Department staff has contacted the Riverside Area office of the California Highway Patrol regarding the proposed zones.

County Counsel has approved this resolution.

George A. Johnson
Director of Transportation

LTT:bjl
attachments
cc: County Counsel
Lawrence Tai

REVIEWED BY EXECUTIVE OFFICE

George A. Johnson
DATE 12/16/03

- Department Recommendation: Consent
- Per Executive Office: Consent
- Policy
- Policy

Prev. Agn. Ref.

Dist. 2

AGENDA NO.

2 RESOLUTION NO. 413-546
3 ESTABLISHING NO-PARKING ZONES
4 IN THE PEDLEY AREA

5 BE IT RESOLVED, DETERMINED AND ORDERED by the Board of Supervisors,
6 County of Riverside, State of California, in regular session on December 23, 2003, that
7 pursuant to Ordinance No. 413, the following No-Parking Zones are hereby established in the
8 Pedley area:

9 On the north side of Skyview Road starting at a point 60 feet west of the centerline of
10 Avenue Juan Bautista to a point 1,400 feet west of said centerline, a total distance of
11 approximately 1,340 feet.

12
13 On the south side of Skyview Road starting at a point 40 feet east of the centerline of
14 John Drive (W) to a point 1,175 feet east of said centerline, a total distance of
15 approximately 1,135 feet.

16
17 On the east side of Sharon Way starting at a point 50 feet north of the centerline of
18 Skyview Road to a point 275 feet north of said centerline, a total distance of
19 approximately 225 feet.

20
21 On the west side of Sharon Way starting at the centerline of Valdez Avenue to a point
22 285 feet south of said centerline, a total distance of approximately 285 feet.

23 AH:bjl
24 November 13, 2003



25 F:\PCDATA\Traffic\RESO\Resolutions\413-546; np.doc

FORM APPROVED
COUNTY COUNSEL

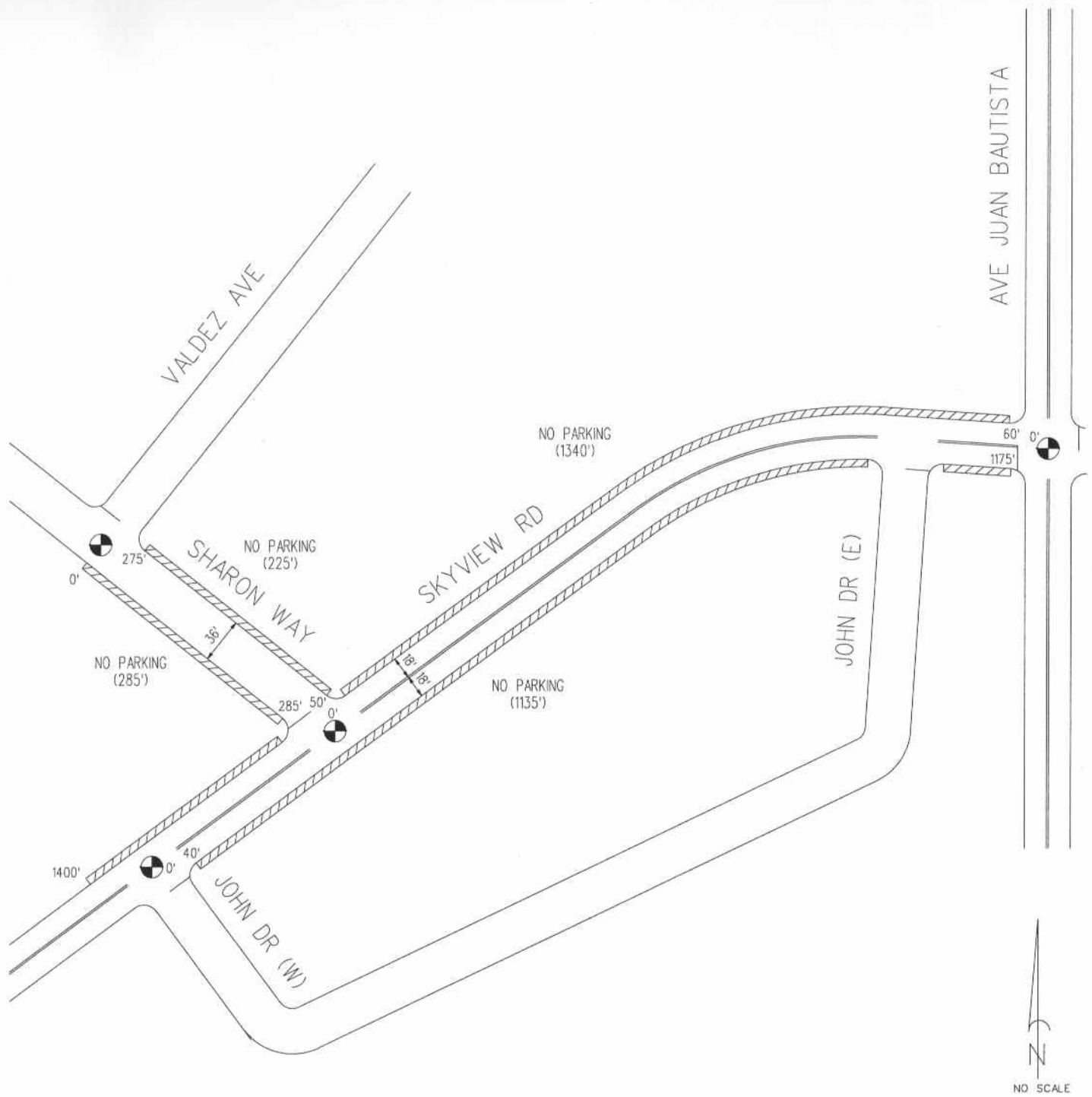
NOV 13 2003
BY Gordon V. Woo



LEGEND:

-  PROPOSED PASSENGER LOADING ZONE
-  POINT OF INTERSECTION

FILE REFERENCE	
SRF NO.	03-03-005
CAD FILE:	NOPARK231
MAP PAGE:	15B



COUNTY OF RIVERSIDE TRANSPORTATION DEPARTMENT TRAFFIC ENGINEERING SECTION		
RESTRICTED PARKING ZONES ON SKYVIEW ROAD & SHARON WAY IN THE PEDLEY AREA		
DATE	DRAWN BY	PAGE
10/29/2003	A. HIGGS	1 OF 1