

SUBMITTAL TO THE BOARD OF SUPERVISORS  
COUNTY OF RIVERSIDE, STATE OF CALIFORNIA

825B



FROM: TLMA - Transportation Dept.

SUBMITTAL DATE:

January 16, 2004

SUBJECT: Accepting offers of dedication for Cyrus Lane, in the Woodcrest area, First Supervisorial District.

RECOMMENDED MOTION: Adopt Resolution No. 2004-011, accepting offers of dedication for Cyrus Lane for public road and utility purposes, but not as part of the County Maintained Road System.

BACKGROUND: Southern California Edison has requested the acceptance of Cyrus Lane to enable their company to install their facilities by encroachment permit.

Departmental Concurrence

REVIEWED BY EXECUTIVE OFFICE  
*Edward J. Bruffert*  
DATE 1/20/04

FORM APPROVED  
COUNTY COUNSEL

DEC 29 2003

BY *Jordan V. Ubo*

EDH

Attachments: Resolution No. 2004-011  
Exhibit "A"

*George A. Johnson*  
George A. Johnson  
Director of Transportation

Dept't Recomm.:  Policy  Consent  
Per Exec. Ofc.:  Policy  Consent

Prev. Agn. Ref.:

District: 1

Agenda Number:

2  
3 **RESOLUTION NO 2004-011**

4 ACCEPTING OFFERS OF DEDICATION FOR CYRUS LANE,  
5 IN THE WOODCREST AREA OF RIVERSIDE COUNTY  
6 (FIRST SUPERVISORIAL DISTRICT)  
7

8 **WHEREAS**, the hereinafter-described Cyrus Lane was offered for dedication for public  
9 road and utility purposes by the maps herein-after referred to, which offers of dedication have  
10 not previously been accepted by the County, now, therefore,  
11

12 **BE IT RESOLVED, DETERMINED AND ORDERED** by the Board of Supervisors of  
13 the County of Riverside, State of California, in regular session assembled on \_\_\_\_\_  
14 January 27 , 2004, that this Board accepts the offers of dedication and recognizes  
15 that said road is a public road open for use by the general public;  
16

17 **BE IT FURTHER RESOLVED, DETERMINED AND ORDERED** that this acceptance  
18 is for the purpose of vesting title in the County of Riverside on behalf of the public, for public  
19 road and utility uses and is not an acceptance of the road into the County Maintained Road  
20 System pursuant to Section 941 of the Streets and Highways Code and that said road shall  
21 not become a part of the County Maintained Road System unless subsequently accepted into  
22 said maintained road system by resolution adopted by this Board;  
23

24 Said road is in the County of Riverside, State of California, and is described as follows:

25 ///  
26 ///  
27 ///

1     **RESOLUTION NO. 2004-011**

2

3     **CYRUS LANE**

4     Cyrus Lane lying northerly of Nandina Avenue, dedicated as Lots "B", "C", "D" & "E" on Parcel  
5     Map 12488, recorded in Parcel Map Book 67, Page 21; and Lots "B", "C", "D" & "E" on Parcel  
6     Map 12700, recorded in Parcel Map book 65, Page 77; both records of the Recorder,  
7     Riverside County, California.

8             AS SHOWN ON EXHIBIT "A" ATTACHED HERETO AND MADE A PART HEREOF .

9

10            **BE IT FURTHER RESOLVED, DETERMINED AND ORDERED** that the Clerk of this  
11     Board shall cause a certified copy of this resolution to be recorded in the Office of the  
12     Recorder of Riverside County, California.

13

14

15

16

17

18

19

20

21

22

23

24

25

26

EDH

W.O. # SU1020

C:\Files\WP\ACCEPTANCES\Cyrus\_Acceptance\_Res.wpd

FORM APPROVED  
COUNTY COUNSEL

DEC 29 2003

BY Gordon V. Ubo



1 2 3 4 5 6

53

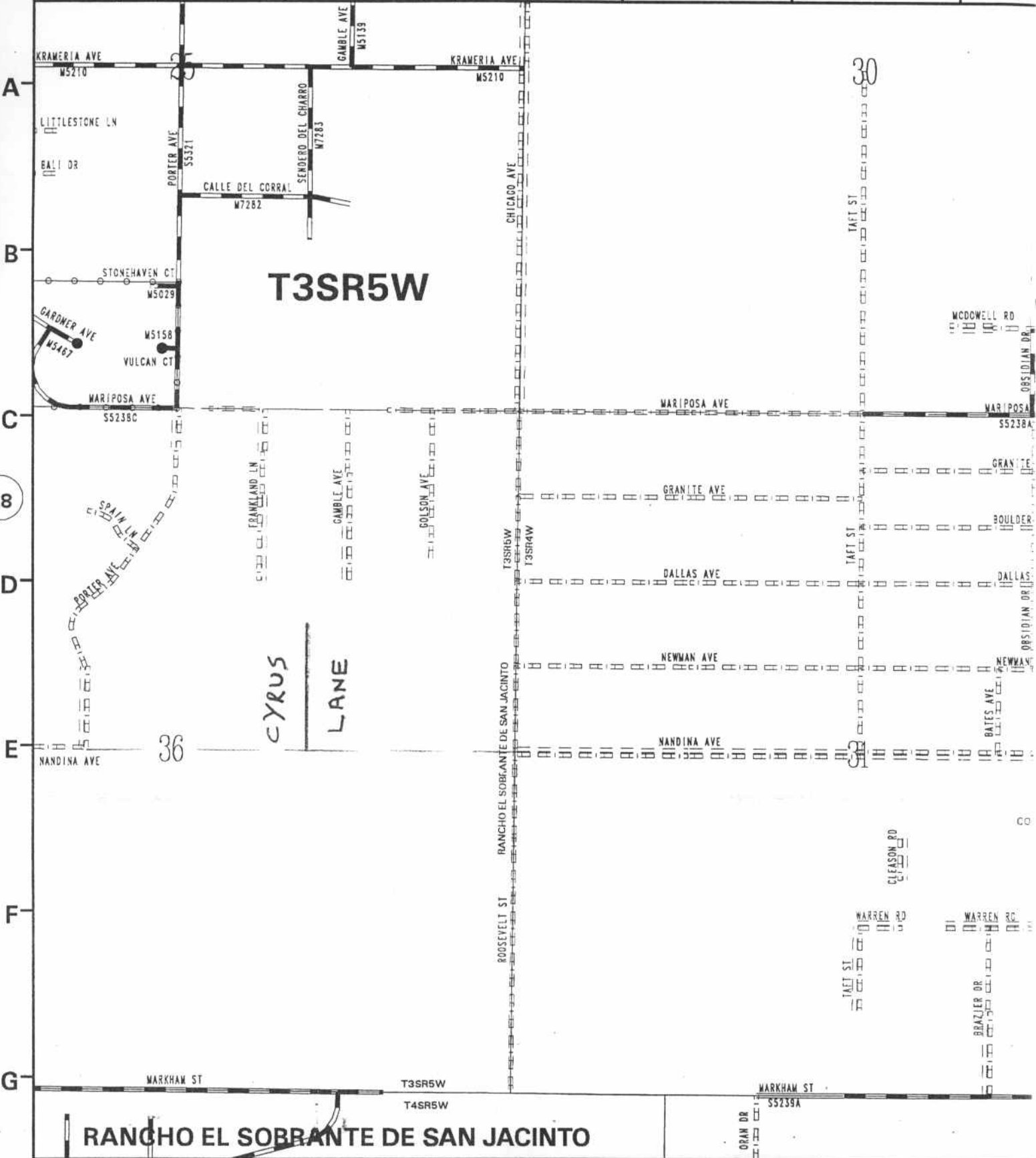

**REMOVE VICINITY MAP  
PRIOR TO  
RECORDATION**

57