

**SUBMITTAL TO THE BOARD OF SUPERVISORS  
COUNTY OF RIVERSIDE, STATE OF CALIFORNIA**

601 B



**FROM:** TLMA - Transportation Department

**SUBMITTAL DATE:**  
March 15, 2004

**SUBJECT:** Resolution 413-549 to Establish No-Parking Zones on Bonnie Lea Drive and on Pepper Drive, Lakeland Village

**RECOMMENDED MOTION:** That the Board adopt Resolution 413-549 to establish No-Parking Zones on Bonnie Lea Drive and on Pepper Drive in the Lakeland Village area, as described in attached Resolution 413-549.

**BACKGROUND:** The Transportation Department was contacted by area residents concerning parked vehicles on Bonnie Lea Drive and Pepper Drive by visitors to the beach on the lake front. The parked vehicles block driveways and the roads for access by residents.

Transportation Department staff conducted a field review of this area and determined that it is appropriate to install No-Parking Zones on these two streets.

Based on this review, the Transportation Department recommends approval of these No-Parking Zones.

The Transportation Department staff has contacted the Temecula Area office of the California Highway Patrol regarding the proposed zones.

County Council has approved this resolution.

LTT:bjl  
attachments

cc: County Counsel  
Lawrence Tai

Departmental Concurrence

REVIEWED BY EXECUTIVE OFFICE  
*[Signature]*  
DATE 3/16/04

*[Signature]*  
George A. Johnson  
Director of Transportation

Dept't Recomm.:  Consent  Policy  
Per Exec. Ofc.:  Consent  Policy

Prev. Agn. Ref.: | District: 1 | Agenda Number:

2 RESOLUTION NO. 413-549  
3 ESTABLISHING NO-PARKING ZONES  
4 IN THE LAKELAND VILLAGE AREA

5 BE IT RESOLVED, DETERMINED AND ORDERED by the Board of Supervisors,  
6 County of Riverside, State of California, in regular session on March 23, 2004,  
7 that pursuant to Ordinance No. 413, the following No-Parking Zones are hereby established in  
8 the Lakeland Village area:

9 On the northwest side of Bonnie Lea Drive starting at a point 10 feet northeast of  
10 the centerline of Avondale Way to a point 140 feet northeast of said centerline, a  
11 total distance of approximately 130 feet.

12  
13 On the southeast side of Pepper Drive starting at a point 10 feet northeast of the  
14 centerline of Avondale Way to a point 120 feet northeast of said centerline, a total  
15 distance of approximately 110 feet.

16  
17 AH:bjl  
18 December 4, 2003

19 F:\PCDATA\Traffic\RESO\Resolutions\413-549; np.doc

FORM APPROVED  
COUNTY COUNSEL

DEC 09 2003

BY Gordon V. Ubo

COMMON BEACH  
OF  
LAKE ELSINORE

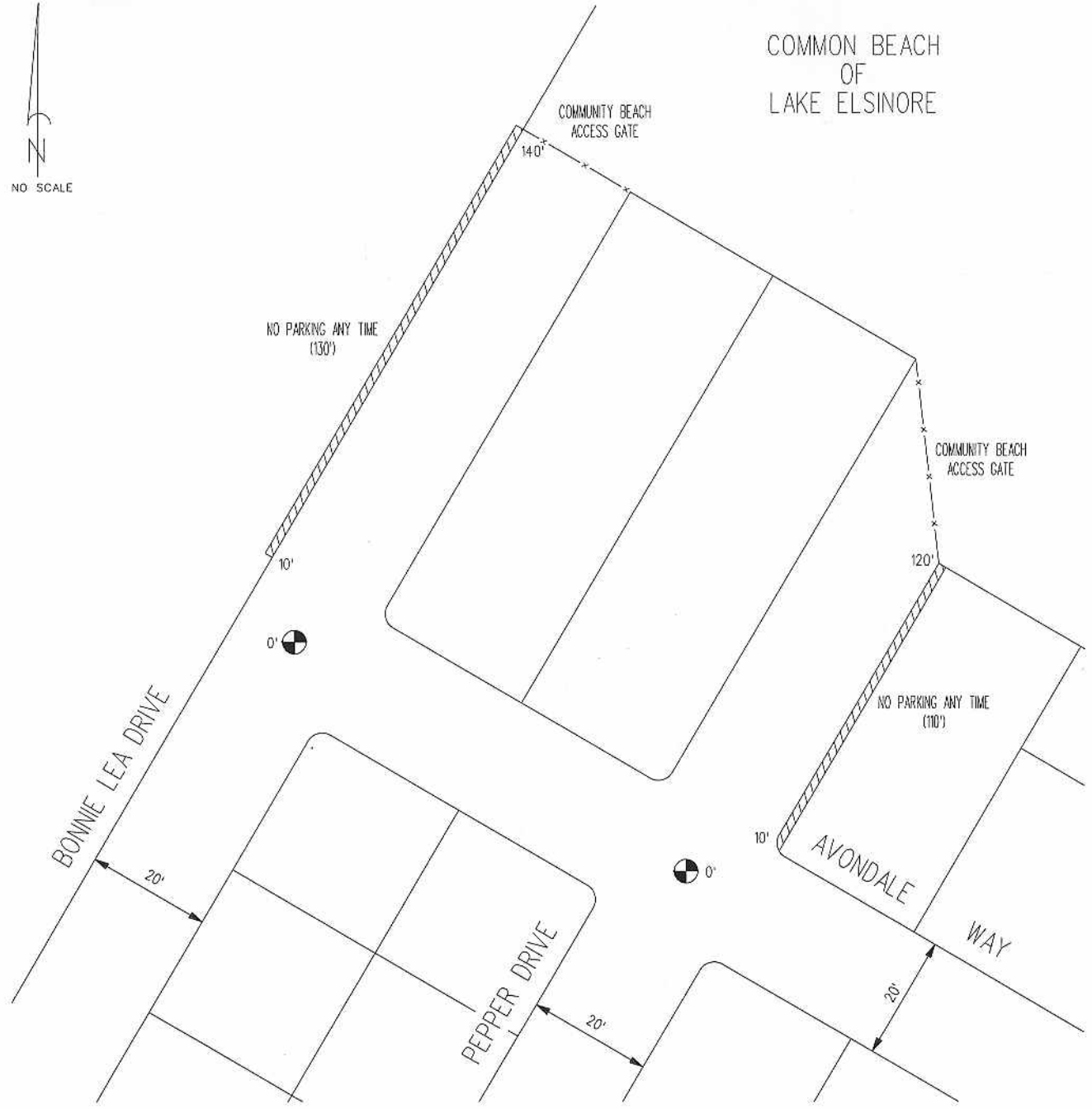

LEGEND:

- PROPOSED NO PARKING ANY TIME ZONE
- POINT OF INTERSECTION

COUNTY OF RIVERSIDE  
TRANSPORTATION DEPARTMENT  
TRAFFIC ENGINEERING SECTION

RESTRICTED PARKING ZONE  
ON  
BONNIE LEA DR & PEPPER DR  
IN THE  
LAKELAND VILLAGE AREA

FILE REFERENCE

SRF NO. 03-07-023  
CAD FILE: NOPARK232  
MAP PAGE: 40

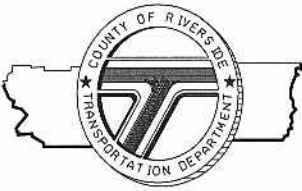

DATE 11/25/2003	DRAWN BY A. HIGGS	PAGE 1 OF 1
--------------------	----------------------	----------------