

SUBMITTAL TO THE BOARD OF SUPERVISORS
COUNTY OF RIVERSIDE, STATE OF CALIFORNIA



FROM: TLMA – Transportation Dept.

SUBMITTAL DATE:
March 15, 2004

SUBJECT: Approval of **TRACT 28920-1**
A Schedule "A" Subdivision in the Quail Valley Area

RECOMMENDED MOTION: That the Board approve the Improvement Agreements and Securities as approved by County Counsel, approve the final map and authorize the Chairman to sign the Improvement Agreements and map for Tract 28920-1.

BACKGROUND: This map complies in all respects with the provisions of Division 3 of Title 15 of the Government Code and applicable local ordinances. The developer desires to enter into Improvement Agreements to guarantee the construction of the required improvements and has submitted Improvement Agreements and Securities which have been approved by County Counsel.

REVIEWED BY EXECUTIVE OFFICE
James P. [Signature]
DATE 3/19/04

Departmental Concurrence

George A. Johnson
George A. Johnson
Director of Transportation

HS:lf
Submittals: Final Map
Road/Drainage Improvement Agrmts
Water System Improvement Agrmts
Sewer System Improvement Agrmts
Survey Monument Agreements

Consent Policy
 Consent Policy

Dep't Recomm.:
Per Exec. Ofc.:

Prev. Agn. Ref.: District: 3 Agenda Number:

IN THE UNINCORP

BEING A S
NO. 227
PARCEL MA
OF SECTION

CSL ENGINEERIN
DAVID E. CORYEI

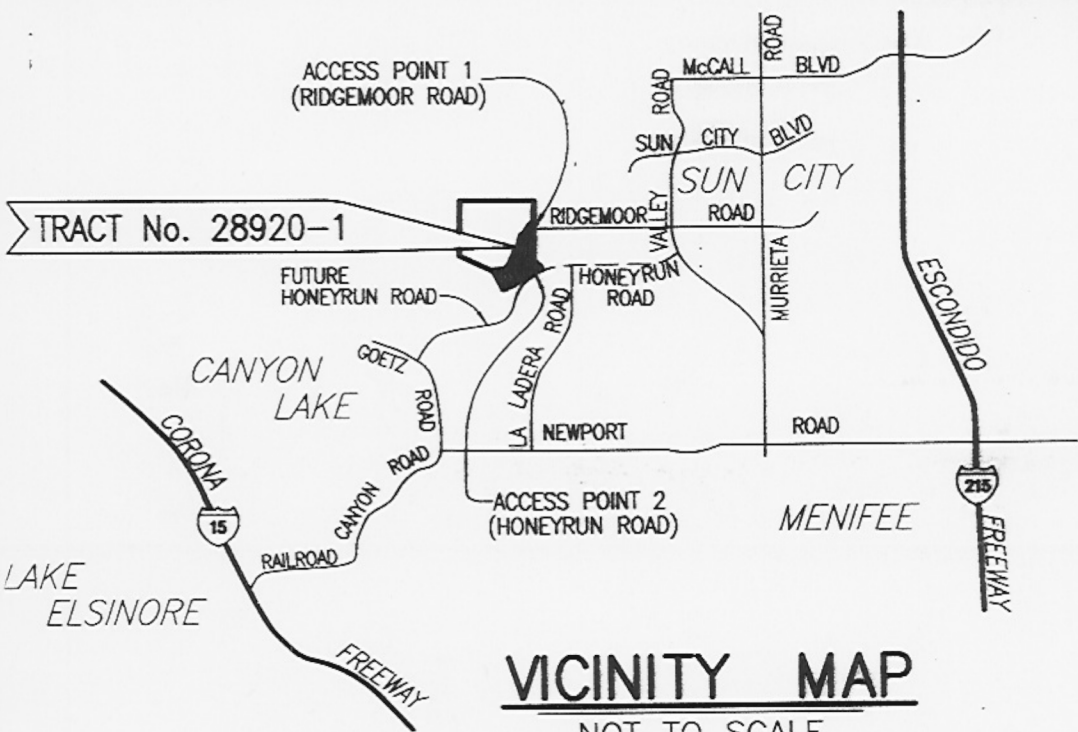

VICINITY MAP

NOT TO SCALE

SECTIONS 30, 31 & 32, TOWNSHIP 5 SOUTH, RANGE 3 WEST

BASIS OF BEARINGS

BEARINGS ARE BASED UPON THE WEST LINE OF SECTION 32 AS BEING $N00^{\circ}46'21''W$ PER TRACT MAP 28754-1, RECORDED IN M.B. 292/70-73 RIVERSIDE COUNTY RECORDS.

ENGINEER'S NOTES

- INDICATES FOUND 1" I.D. IRON PIPE WITH PLASTIC PLUG, R.C.E. 31574, FLUSH (UNLESS OTHERWISE NOTED) PER TRACT 28886-1 M.B. 322/22-25.
- INDICATES SET 1" I.D. IRON PIPE TAGGED R.C.E. 31574, FLUSH.
- INDICATES FOUND 1" I.D. IRON PIPE TAGGED R.C.E., 31574, FLUSH PER TRACT 28921 MB 303/67-70.
- () INDICATES RECORD DATA PER P.M.B. 155/71-74. (UNLESS OTHERWISE NOTED)
- < > INDICATES RECORD DATA PER R.S. 27/26-27
- [:] INDICATES RECORD INFORMATION PER PER TRACT 28886-1, M.B. 322/22-25
- << >> INDICATES RECORD DATA PER M.B. 28/89-93.
- (()) INDICATES RECORD DATA PER RIVERSIDE COUNTY R.A.M.P. MAP; 5S-3W, 5W WITH DISTANCES ADJUSTED FOR GROUND POSITION.
- [[]] INDICATES RECORD PER PUBLIC LAND SURVEY - DECEMBER 21, 1867
- 0. THIS TRACT CONTAINS 38.87 ACRES.
- 1. SET A 1" I.D. PIPE WITH PLASTIC PLUG MARKED R.C.E. 31574, FLUSH AT ALL LOT CORNERS, ANGLE POINTS IN SIDE OR REAR LOT LINES AND ANGLE POINTS IN SUBDIVISION BOUNDARY.

	BEARING	TA
1	N 65°30'19"W	
2	N 24°29'41"E	
3	N 90°00'00"W	
4	N 84°00'00"E	
5	N 75°00'00"W	
6	N 40°00'53"E	
7	N 21°07'50"E	
8	N 04°40'48"E	
9	N 60°38'09"E	
10	N 12°36'29"E	
11	N 45°48'53"E	
12	N 70°31'05"E	
13	N 04°14'12"E	
14	N 41°50'54"E	
15	N 12°59'48"E	