

SUBMITTAL TO THE BOARD OF SUPERVISORS
COUNTY OF RIVERSIDE, STATE OF CALIFORNIA

203 B



FROM: TLMA – Transportation Dept.

SUBMITTAL DATE:

June 21, 2004

SUBJECT: Approval of **TRACT 29072-2**
A Schedule "A" Subdivision in the Menifee Area

RECOMMENDED MOTION: That the Board approve the Improvement Agreements and Securities as approved by County Counsel, approve the final map and authorize the Chairman to sign the Improvement Agreements and map for Tract 29072-2.

BACKGROUND: This map complies in all respects with the provisions of Division 3 of Title 15 of the Government Code and applicable local ordinances. The developer desires to enter into Improvement Agreements to guarantee the construction of the required improvements and has submitted Improvement Agreements and Securities which have been approved by County Counsel.

Departmental Concurrence

REVIEWED BY EXECUTIVE OFFICE
[Signature]
DATE 6/21/04

HS:lf
Submittals: Final Map
Road/Drainage Improvement Agrmts
Water System Improvement Agrmts
Sewer System Improvement Agrmts
Survey Monument Agreements

[Signature]
George A. Johnson
Director of Transportation

- Consent
- Policy
- Consent
- Policy

Dep't Recomm.:
Per Exec. Ofc.:

Prev. Agn. Ref.: District: 3 Agenda Number:

2.18

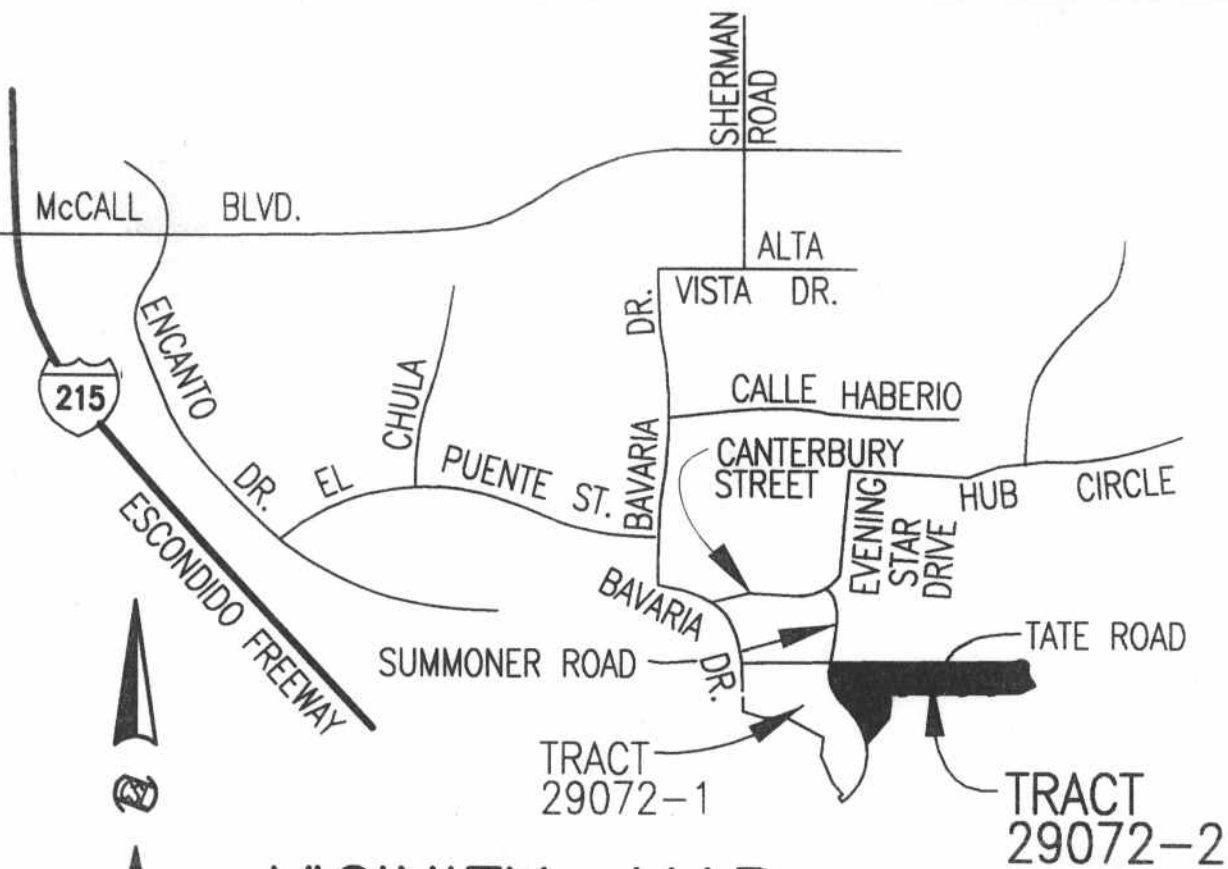

VICINITY MAP

NOT TO SCALE
T5S, R3W, SECTION 26 AND 27

LINE DATA			LINE DATA			L
LINE	BEARING	LENGTH	LINE	BEARING	LENGTH	LINE
-1	<<N01°40'59"E>>	<<60.01'>>	L-10	N08°21'45"E	73.63'	L-19
-2	<<N45°12'08"E>>	<<21.45'>>	L-11	N00°51'30"W	90.02'	L-20
-3	<<N41°17'55"W>>	<<133.08'>>	L-12	N89°08'30"W	89.63'	L-21
-4	<<N56°19'46"W>>	<<241.54'>>	L-13	N40°03'22"W	19.85'	L-22
-5	<<N32°32'18"W>>	<<165.27'>>	L-14	N89°08'30"W	60.00'	L-23
-6	<<N67°04'03"W>>	<<463.93'>>	L-15	N41°46'22"E	19.85'	L-24
-7	<<N74°36'55"E>>	<<299.89'>>	L-16	N89°08'30"W	232.00'	L-25
-8	<<N67°26'13"E>>	<<512.25'>>	L-17	N89°08'30"W	232.00'	L-26