

SUBMITTAL TO THE BOARD OF SUPERVISORS
COUNTY OF RIVERSIDE, STATE OF CALIFORNIA

941 B



FROM: TLMA – Transportation Dept.

SUBMITTAL DATE:
September 3, 2004

SUBJECT: Approval of **TRACT 29646**
A Schedule "A" Subdivision in the Mead Valley Area

RECOMMENDED MOTION: That the Board approve the Improvement Agreements and Securities as approved by County Counsel, approve the final map and authorize the Chairman to sign the Improvement Agreements and map for Tract 29646.

BACKGROUND: This map complies in all respects with the provisions of Division 3 of Title 15 of the Government Code and applicable local ordinances. The developer desires to enter into Improvement Agreements to guarantee the construction of the required improvements and has submitted Improvement Agreements and Securities which have been approved by County Counsel.

Departmental Concurrence

REVIEWED BY EXECUTIVE OFFICE
[Signature]
DATE 9/7/04

HS:lf
Submittals: Final Map
Road/Drainage Improvement Agrmts
Water System Improvement Agrmts
Sewer System Improvement Agrmts
Survey Monument Agreements

[Signature]
George A. Johnson
Director of Transportation

- Consent
- Policy
- Consent
- Policy

Dep't Recomm.:
Per Exec. Ofc.:

Prev. Agn. Ref.:

District: 1

Agenda Number:

ATTACHMENTS FILED
WITH THE CLERK OF THE BOARD

2.26

SET NAIL AND TAG MARKED "RCE 28949" IN TOP OF CURB AT THE PROLONGATION OF SIDE LOT LINES.

ALL MONUMENTS ARE SET AND TAGGED PER ORDINANCE NO. 461.9.

ALL MONUMENTS SHOWN "SET" ARE IN ACCORDANCE WITH THE MONUMENT AGREEMENT FOR THE MAP, UNLESS OTHERWISE NOTED.

ENVIRONMENTAL CONSTRAINT NOTE

ENVIRONMENTAL CONSTRAINT SHEET AFFECTING THIS MAP IS ON FILE IN THE OFFICE OF THE RIVERSIDE COUNTY SURVEYOR, IN E.C.S. BOOK 35, PAGE 66 THIS AFFECTS ALL LOTS.

—2004, O.R.

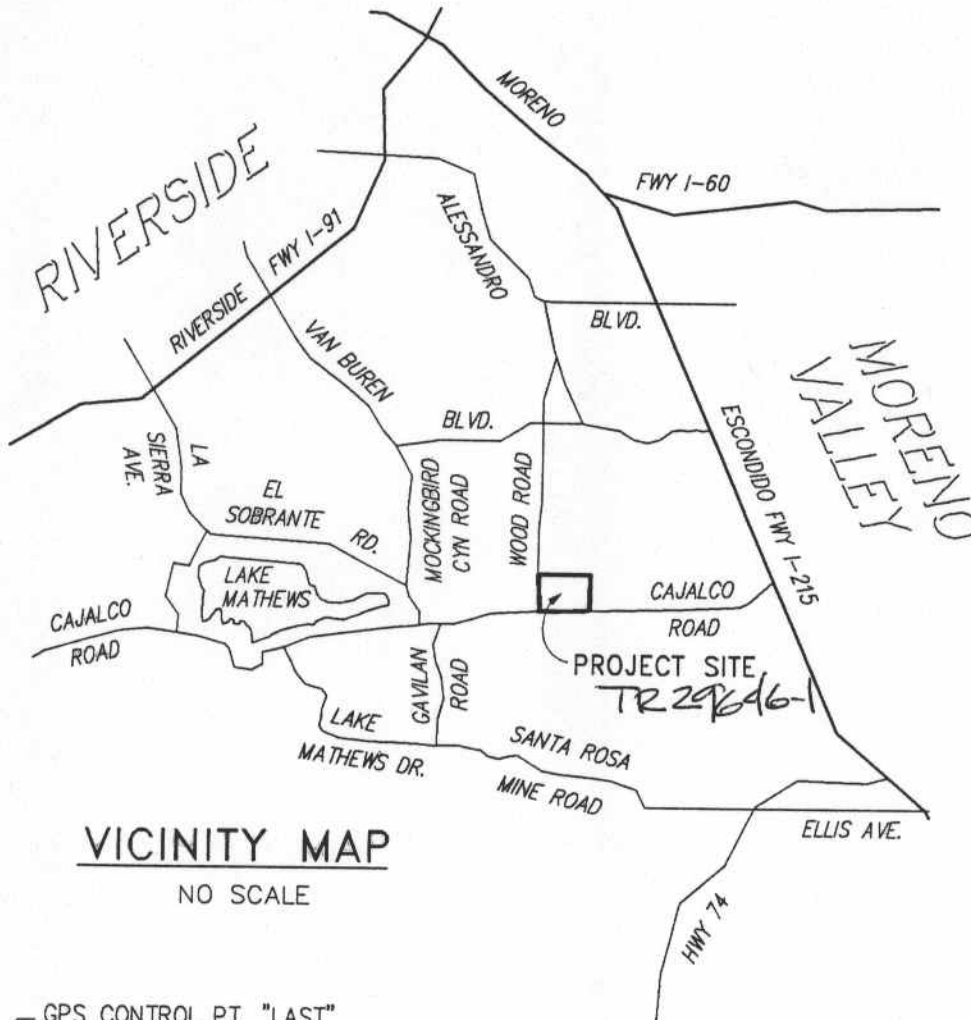

VICINITY MAP

NO SCALE

GPS CONTROL PT. "LAST"
FD. SURVEY DISK SET IN A DRILL HOLE IN BEDROCK STAMPED "LAST 1960" PER RECOVERY NOTE BY NATIONAL GEODETIC SURVEY, 1991.

N= 2,249,951.17
E= 6,240,012.52
NAD 83 (1992)

NOTE:

SEE SHEET 3 FOR SHEET INDEX MAP AND EASEMENT NOTES.