

**SUBMITTAL TO THE BOARD OF SUPERVISORS  
COUNTY OF RIVERSIDE, STATE OF CALIFORNIA**

420 B



**FROM:** TLMA - Transportation Department

**SUBMITTAL DATE:**  
October 18, 2004

**SUBJECT:** Resolution 413-562 to Establish a No-Stopping Zone on Olivia Way, Glen Avon area

**RECOMMENDED MOTION:** That the Board adopt Resolution 413-562 to establish a No-Stopping Zone on Olivia Way in the Glen Avon area, as described in attached Resolution 413-562.

**BACKGROUND:** The Transportation Department received a request from an area resident for a No-Stopping Zone on Olivia Way.

Transportation Department staff conducted a field review of the site and observed that Olivia Way is only 28 feet in width with residences on the south side of the street, and an open field on the north side. It was determined that, to provide unimpeded traffic flow and access, especially for emergency services, it is beneficial to prohibit parking on the north side of the street.

Based on this review, the Transportation Department recommends approval of the No-Stopping Zone. The Transportation Department staff has contacted the Riverside Area office of the California Highway Patrol regarding the proposed zone.

County Counsel has approved this resolution.

LTT:bjl  
attachments

cc: County Counsel  
Lawrence Tai

Departmental Concurrence

REVIEWED BY EXECUTIVE OFFICE  
*[Signature]*  
DATE 10/22/04

*[Signature]*  
George A. Johnson  
Director of Transportation

Dep't Recomm.:  Consent  Policy  
Per Exec. Ofc.:  Consent  Policy

Prev. Agn. Ref.:

District: 2

Agenda Number:

2.35

2 RESOLUTION NO. 413-562  
3 ESTABLISHING NO-STOPPING ZONE  
4 IN THE GLEN AVON AREA

5 BE IT RESOLVED, DETERMINED AND ORDERED by the Board of  
6 Supervisors, County of Riverside, State of California, in regular session on

7 October 19, 2004, that pursuant to Ordinance No. 413, the following No-  
8 Stopping Zone is hereby established in the Glen Avon area:

9  
10 On the north side of Olivia Way starting at a point 120 feet west of the  
11 centerline of Brookhill Terrace to a point 820 feet west of said centerline, a total  
12 distance of approximately 700 feet.  
13

14 AH:bjl  
15 June 14, 2004

16 F:\PCDATA\Traffic\RESO\Resolutions\413-562; ns.doc

FORM APPROVED  
COUNTY COUNSEL



17 JUN 21 2004  
18 BY Gordon V. Ubo  
19  
20  
21  
22  
23  
24  
25

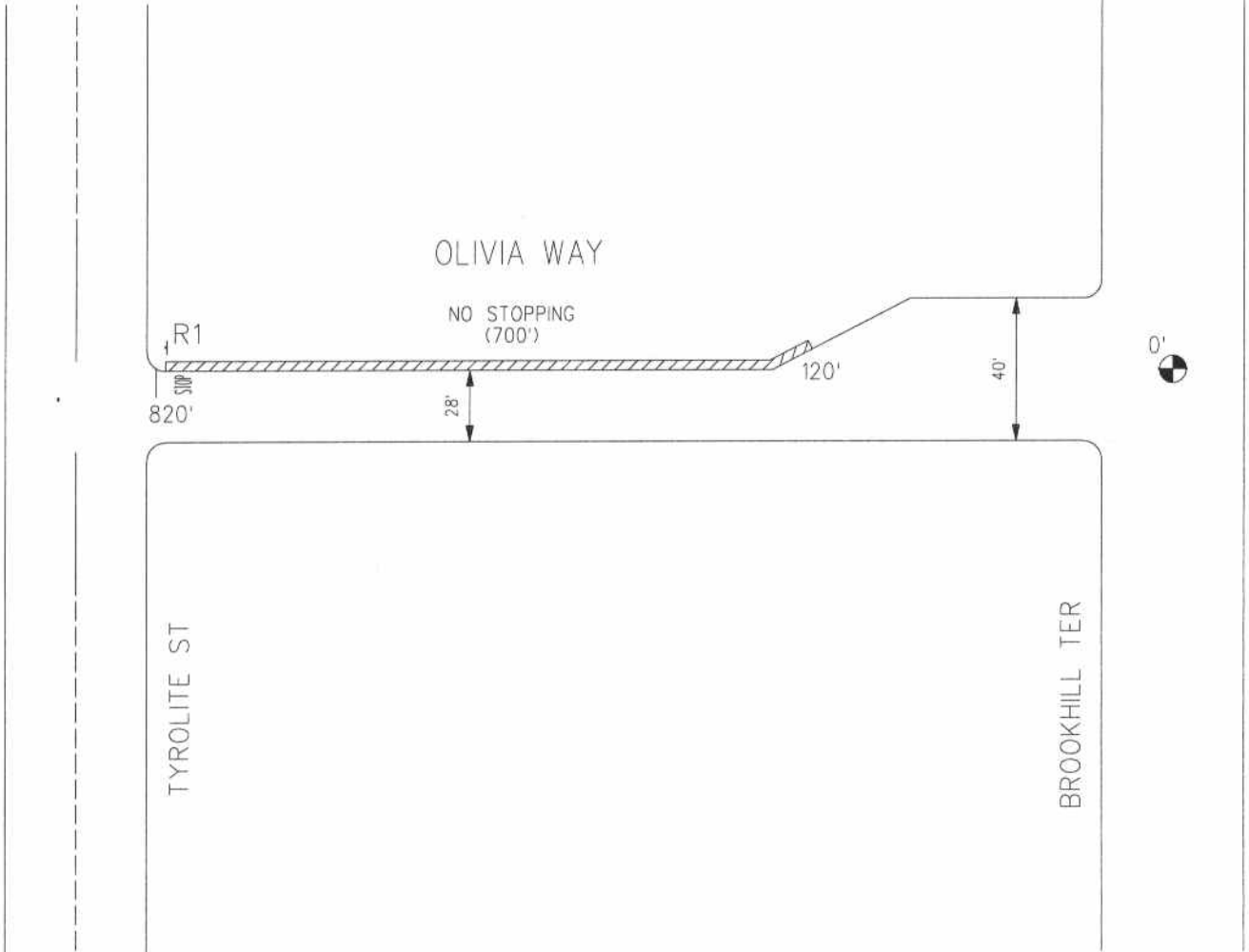

NO SCALE



**LEGEND:**

-  PROPOSED NO PARKING AREA
-  POINT OF INTERSECTION

COUNTY OF RIVERSIDE  
TRANSPORTATION DEPARTMENT  
TRAFFIC ENGINEERING SECTION

RESTRICTED PARKING ZONE  
ON  
OLIVIA WAY  
IN THE  
GLEN AVON AREA

FILE REFERENCE

SRF NO. 04-05-017  
CAD FILE: NOPARK242  
MAP PAGE: 10



DATE 6/14/2004	DRAWN BY A. HIGGS	PAGE 1 OF 1
-------------------	----------------------	----------------