

**SUBMITTAL TO THE BOARD OF SUPERVISORS  
COUNTY OF RIVERSIDE, STATE OF CALIFORNIA**

516 B



**FROM:** TLMA – Transportation Dept.

**SUBMITTAL DATE:**

October 18, 2004

**SUBJECT:** Approval of **TRACT 28714**

A Schedule "D" Subdivision in the Rancho California Area

**RECOMMENDED MOTION:** That the Board approve the Improvement Agreements and Securities as approved by County Counsel, approve the final map and authorize the Chairman to sign the Improvement Agreements and map for Tract 28714.

**BACKGROUND:** This map complies in all respects with the provisions of Division 3 of Title 15 of the Government Code and applicable local ordinances. The developer desires to enter into Improvement Agreements to guarantee the construction of the required improvements and has submitted Improvement Agreements and Securities which have been approved by County Counsel.

Departmental Concurrence

REVIEWED BY EXECUTIVE OFFICE  
*[Signature]*  
DATE 10/19/04

HS:lf

Submittals: Final Map  
Road/Drainage Improvement Agrmts  
Water System Improvement Agrmts  
Survey Monument Agreements

*[Signature]*

George A. Johnson  
Director of Transportation

- Consent
- Policy
- Consent
- Policy

*[Faint background stamp: COUNTY OF RIVERSIDE, OCT 20 2004]*

Dept't Recomm.:

Per Exec. Ofc.:

Prev. Agn. Ref.:

District: 3

Agenda Number:

BEI  
GO'  
JAN  
SAI  
  
BL/

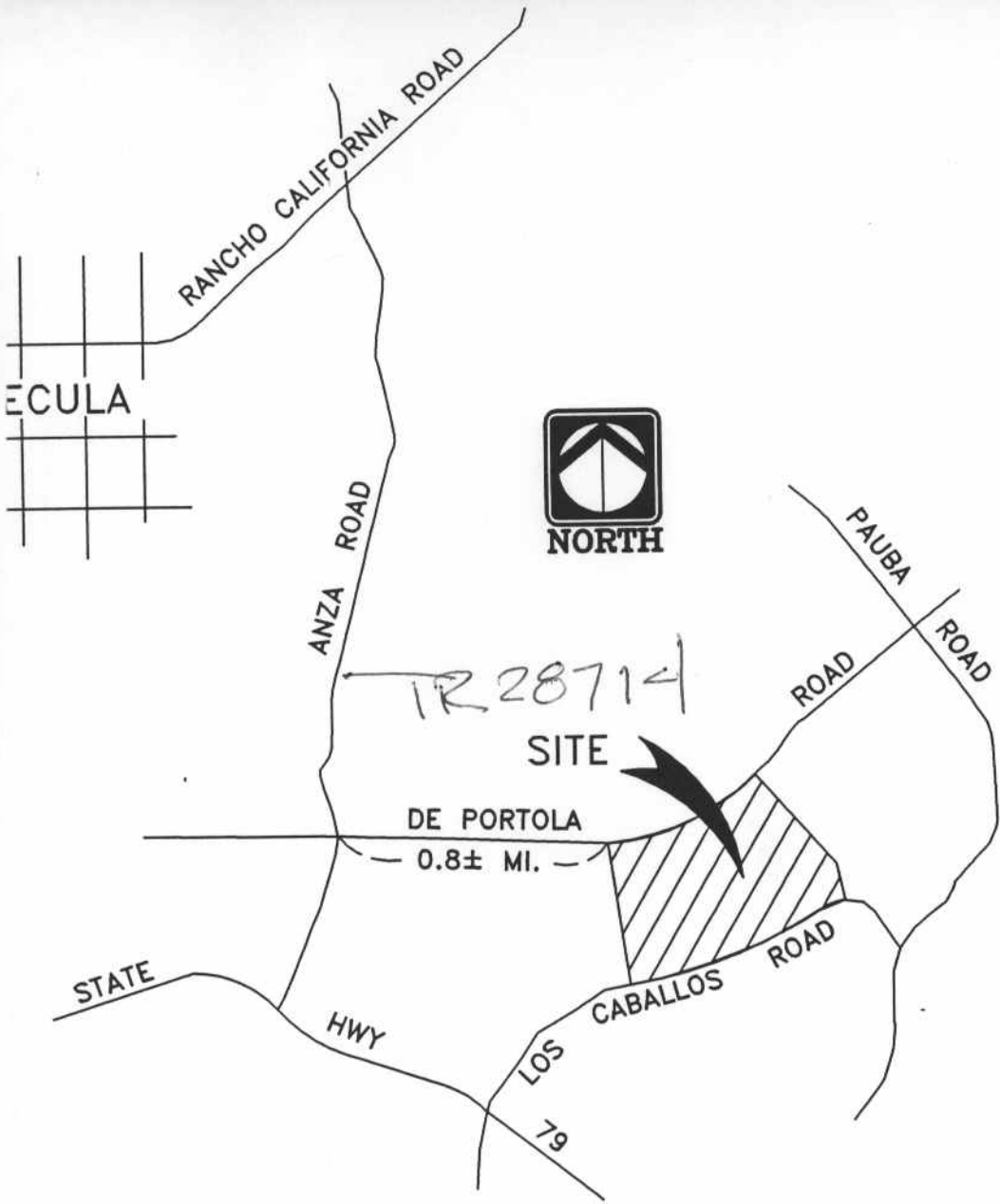

VICINITY MAP  
NTS

### JRVEYOR'S NOTES:

THE BASIS OF BEARINGS FOR THIS MAP IS THE CENTER LINE OF DE PORTOLA ROAD, BEING ALSO ALONG THE TANGENT OF THE NORTHERLY LINE OF PARCELS 1 AND 2 OF PM 17721, TAKEN AS N 42°34'31" E, PER PM 105/49-51, RECORDS OF RIVERSIDE COUNTY, CALIFORNIA.

TRACT MAP NO. 28714 HAS 11 LOTS PLUS LOTS 'A' THROUGH 'C', INCLUSIVE.

TRACT MAP NO. 28714 CONTAINS 130.96 GR. ACRES WITHIN THE DISTINCTIVE BORDER.

ALL PUBLIC UTILITIES AND PUBLIC SERVICES INSTALLED WITHIN THIS TRACT SHALL BE PLACED UNDERGROUND.

1" I.D. IRON PIPE W/ PLASTIC PLUG STAMPED "LS 7843" SET FLUSH AT ALL LOT CORNERS AND CUTBACKS, UNLESS OTHERWISE NOTED.

INDICATED 5/8" COPPER CLAD STEEL PIN WITH 1 1/2" BRASS