

SUBMITTAL TO THE BOARD OF SUPERVISORS  
COUNTY OF RIVERSIDE, STATE OF CALIFORNIA

914 B



FROM: TLMA – Transportation Dept.

SUBMITTAL DATE:  
November 15, 2004

**SUBJECT** Approval of Tract 26837  
A Schedule "D" Subdivision in the Reche Canyon Area  
**IMPROVEMENTS AGREEMENTS/NEW OWNER/SUBSTITUTION  
OF SECURITIES**

**RECOMMENDED MOTION:** That the Board approve the attached agreements (which grant twelve months to complete improvements) and approve and accept the substitution of securities as approved by County Counsel.

**BACKGROUND:** On January 14, 2003, the Board entered into agreements with Bonadiman McCain for the improvement of streets, the installation of a water and sewer system, and the setting of lot corners and subdivision monuments within the above referenced subdivision. Accompanying these agreements were securities posted by Gulf Insurance Company, as follows:

- \$528,000 - Bond BE2622497 for the completion of street improvements
- \$528,000 - Bond BE2622497 for the material and labor security
- \$15,000 - Bond BE2622498 for the monumentation security

(Continued)

HS:lf  
Submittals: Vicinity Map  
Road/Drainage Improvement Agrmts  
Survey Monument Agreements

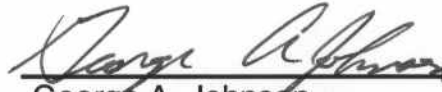
  
George A. Johnson  
Director of Transportation

REVIEWED BY EXECUTIVE OFFICE  
*[Signature]*  
DATE 11/15/04

Departmental Concurrence

- Consent
- Policy
- Consent
- Policy

Dep't Recomm.:  
Per Exec. Ofc.:

Prev. Agn. Ref.: 01/14/03 – 2.21 | District: 5 | Agenda Number:

**ATTACHMENTS FILED  
WITH THE CLERK OF THE BOARD**

2.11

The Honorable Board of Supervisors  
RE: Tract 26837  
November 15, 2004  
Page 2 of 2

Dynamic Homes substituted new securities for this project, posted by Western Insurance Company, as follows:

\$528,000 - Bond CDS60548 for the completion of street improvements  
\$528,000 - Bond CDS60548 for the material and labor security  
\$15,000 - Bond CDS60547 for the monumentation security

Our records indicate that this project is 0% completed for street and utility work. The agreements and new securities have been approved by County Counsel.

125.30'
200.02'
0.25'
124.59'
1200.12'

9. 1" Iron Pipes tagged RCE 3017, set flush at all property corners, street intersections, property line corner cutbacks and right of way BC's, EC's, PRC's and PCC's.
10. Natural drainage courses must be kept free of buildings, obstructions and encroachments.
11. B.C. Denotes Brass Cap.

## ENVIRONMENTAL CONSTRAINT NOTE

ENVIRONMENTAL CONSTRAINTS SHEET AFFECTING THIS MAP IS ON FILE IN THE OFFICE OF THE RIVERSIDE COUNTY SURVEYOR, IN E.C.S. BOOK **33**, PAGE **41**  
 THIS AFFECTS LOTS 1 THROUGH 18

### DESCRIPTION

- 1200' of the 4 of Sec 22
- 1200' of the 4 of Sec 22
- 200' of the 4 of Sec 22
- 600' of the 4 of Sec 22
- 800' of the 4 of Sec 22

ON MID SET

R INST

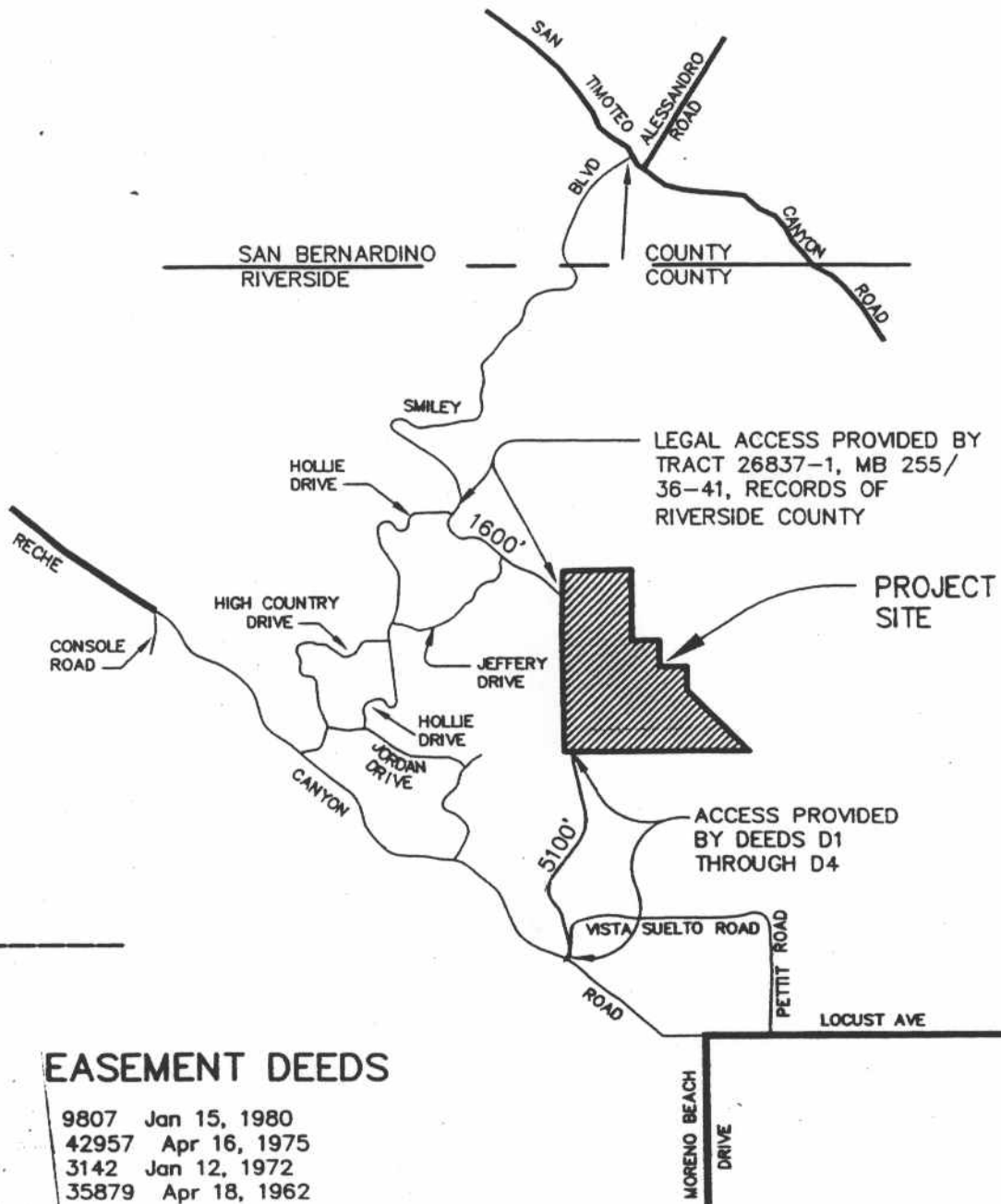

### EASEMENT DEEDS

- 9807 Jan 15, 1980
- 42957 Apr 16, 1975
- 3142 Jan 12, 1972
- 35879 Apr 18, 1962

VICINITY MAP