

SUBMITTAL TO THE BOARD OF SUPERVISORS
COUNTY OF RIVERSIDE, STATE OF CALIFORNIA

525B



FROM: TLMA – Transportation Dept.

SUBMITTAL DATE:

December 13, 2004

SUBJECT: Approval of **Parcel Map 32404**
A Schedule "E" Subdivision in the Mira Loma Area

RECOMMENDED MOTION: That the Board approve the final map and authorize the Chairman to sign the map for Parcel Map 32404.

BACKGROUND: This map complies in all respects with the provisions of Division 3 of Title 15 of the Government Code and applicable local ordinances.

REVIEWED BY EXECUTIVE OFFICE
[Signature]
DATE 12/13/04
Departmental Concurrence

HS:lf
Submittals: Final Map

[Signature]
George A. Johnson
Director of Transportation

- Consent
- Policy
- Consent
- Policy

500 DEC 13 6H 3:11

Prev. Agn. Ref.:

District: 2

Agenda Number:

2.14

VICINITY MAP PM 32404

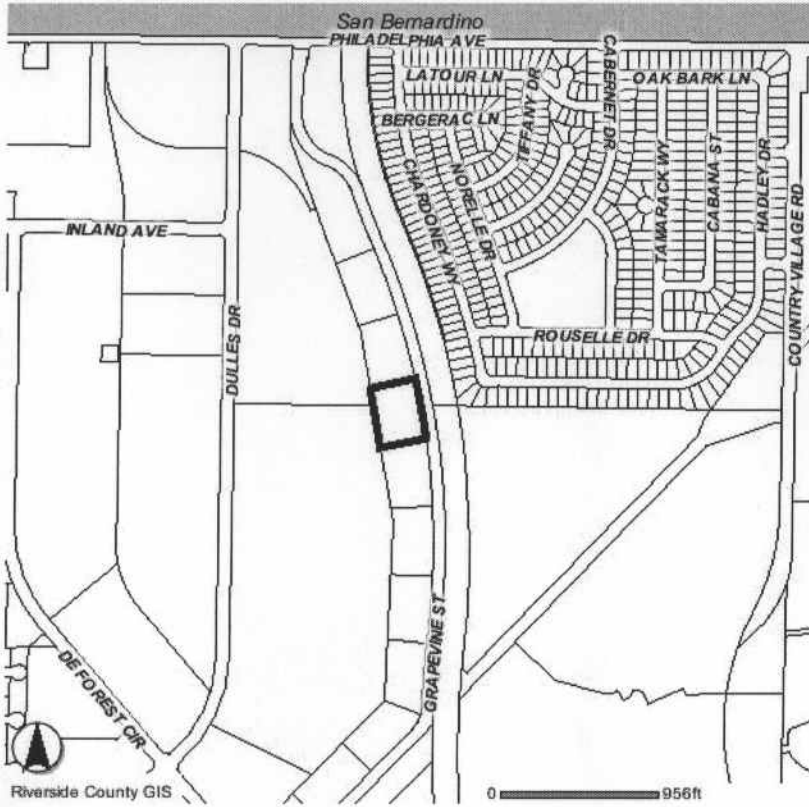

TOWNSHIP/RANGE:

2001 SUPERVISORIAL DISTRICT:

- T2SR6W SEC 4

- JOHN TAVAGLIONE, DISTRICT 2