

SUBMITTAL TO THE BOARD OF SUPERVISORS
COUNTY OF RIVERSIDE, STATE OF CALIFORNIA

204 B



FROM: TLMA - Transportation Department

SUBMITTAL DATE:
January 3, 2005

SUBJECT: Resolution 413-578 to Establish No-Stopping Zones on Cobble Drive, Horsethief Canyon area

RECOMMENDED MOTION: That the Board adopt Resolution 413-578 to establish No-Stopping Zones on Cobble Drive in the Horsethief Canyon area, as described in attached Resolution 413-578.

Also, that the Board rescind the portions of Resolution 413-386 related only to no-stopping zones on the east and west sides of Cobble Drive.

BACKGROUND: The Transportation Department was contacted by the principal of Luiseno Elementary School to request no-stopping zones on Cobble Drive near Mountain Road.

Transportation Department staff conducted a field review of the site and determined that the proposed No-Stopping Zones will improve sight distance for the school crosswalks at the intersection of Mountain Road and Cobble Drive.

Based on this review, the Transportation Department recommends approval of these No-Stopping Zones.

The Transportation Department staff has contacted the Riverside Area office of the California Highway Patrol regarding the proposed zones.

County Counsel has approved this resolution.

LTT:bjl
attachments

cc: County Counsel
Lawrence Tai

George A. Johnson
Director of Transportation

REVIEWED BY EXECUTIVE OFFICE

DATE 1/3/05

Departmental Concurrence

Dept't Recomm.: Consent Policy
Per Exec. Ofc.: Consent Policy

Prev. Agn. Ref.: 4-21-98 #2.9 | District: 1 | Agenda Number: 2.11

2 RESOLUTION NO. 413-578
3 ESTABLISHING NO-STOPPING ZONES
4 IN THE HORSETHIEF CANYON AREA

5 BE IT RESOLVED, DETERMINED AND ORDERED by the Board of
6 Supervisors, County of Riverside, State of California, in regular session on
7 January 11, 2005, that pursuant to Ordinance No. 413, the following No-
8 Stopping Zones are hereby established in the Horsethief Canyon area:

9
10 On the west side of Cobble Drive starting at a point 46 feet south of the
11 centerline of Mountain Road to a point 226 feet south of said centerline, a total
12 distance of approximately 180 feet.

13
14 On the east side of Cobble Drive starting at a point 46 feet south of the
15 centerline of Mountain Road to a point 160 feet south of said centerline, a total
16 distance of approximately 114 feet.

17
18
19 BE IT FURTHER RESOLVED, DETERMINED AND ORDERED that
20 portions of Resolution No. 413-386 related only to no-stopping zones on the east and
21 west sides of Cobble Drive adopted by this Board on April 21, 1998, are hereby
22 rescinded.

FORM APPROVED
COUNTY COUNSEL

23 RH:bjl
November 30, 2004

24 F:\PCDATA\Traffic\RESO\Resolutions\413-578; ns.doc

25
DEC 07 2004
BY Gordon V. Ubo

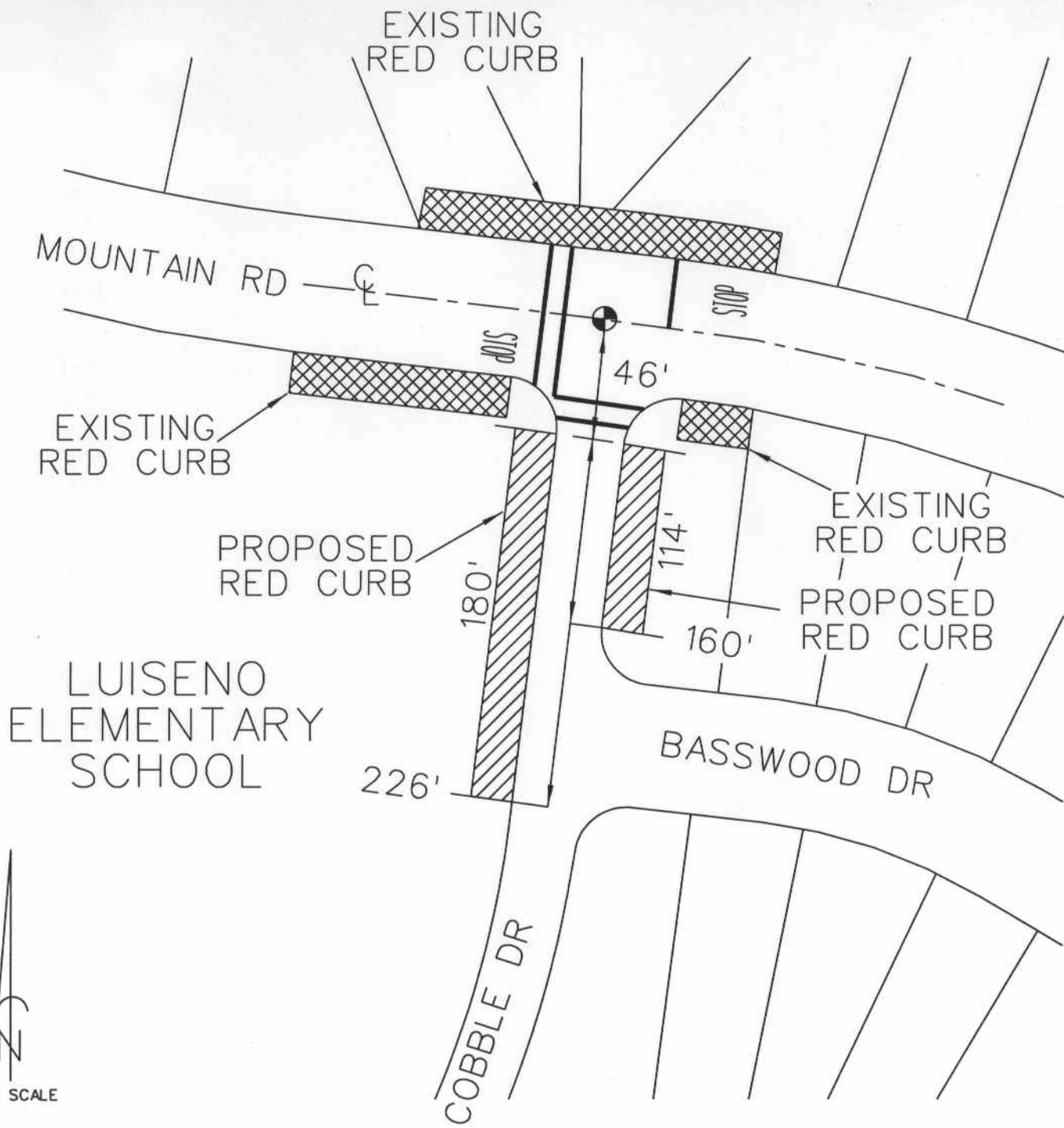



COUNTY OF RIVERSIDE
 TRANSPORTATION DEPARTMENT
 TRAFFIC ENGINEERING SECTION

NO STOPPING
 RED CURB
 ON COBBLE DRIVE
 IN THE
 HORSETHIEF CYN AREA

DATE 11/29/2004	DRAWN BY R. HEALY	PAGE 1 OF 1
--------------------	----------------------	----------------

LEGEND:

-  POINT OF INTERSECTION
-  PROPOSED NO STOPPING ZONE
-  CENTERLINE

FILE REFERENCE

SRF NO. 04-11-028
 CAD FILE: COBBLE
 RD BK PG: 35

