

**SUBMITTAL TO THE BOARD OF SUPERVISORS
COUNTY OF RIVERSIDE, STATE OF CALIFORNIA**

1038



FROM: TLMA - Transportation Department

SUBMITTAL DATE:
January 31, 2005

SUBJECT: Resolution 413-561 to Establish No-Stopping Zones on King Avenue, Woodcrest area

RECOMMENDED MOTION: That the Board adopt Resolution 413-561 to establish No-Stopping Zones on King Avenue in the Woodcrest area, as described in attached Resolution 413-561.

BACKGROUND: The Transportation Department received a request from area business owners for No-Stopping Zones on King Avenue to facilitate traffic movement on King Avenue south of Van Buren Boulevard.

Transportation Department staff conducted a field review of the site and determined that King Avenue is approximately 36 feet in width south of Van Buren Boulevard. A traffic signal has been installed at the intersection of Van Buren Boulevard and King Avenue. The proposed no-stopping zones (red curbing) will improve the operation of the intersection and safety at the driveways on King Avenue south of Van Buren Boulevard.

Based on this review, the Transportation Department recommends approval of these No-Stopping Zones. The Transportation Department staff has contacted the Riverside Area office of the California Highway Patrol regarding the proposed zones.

County Counsel has approved this resolution.

LTT:bjl
attachments

cc: County Counsel
Lawrence Tai

REVIEWED BY EXECUTIVE OFFICE

DATE 2/1/05

George A. Johnson
George A. Johnson
Director of Transportation

Departmental Concurrence

- Dep't Recomm.: Consent Policy
- Per Exec. Ofc.: Consent Policy

Prev. Agn. Ref.:

District: 1

Agenda Number:

2.11

2 RESOLUTION NO. 413-561
3 ESTABLISHING NO-STOPPING ZONES
4 IN THE WOODCREST AREA

5 BE IT RESOLVED, DETERMINED AND ORDERED by the Board of
6 Supervisors, County of Riverside, State of California, in regular session on
7 February 8, 2005, that pursuant to Ordinance No. 413, the following No-
8 Stopping Zones are hereby established in the Woodcrest area:

9
10 On the west side of King Avenue starting at a point 73 feet south of the
11 centerline of Van Buren Boulevard to a point 229 feet south of said centerline, a
12 total distance of approximately 156 feet.

13
14 On the east side of King Avenue starting at a point 73 feet south of the
15 centerline of Van Buren Boulevard to a point 149 feet south of said centerline, a
16 total distance of approximately 76 feet.

17
18
19 AH:bjl
June 14, 2004

20 F:\PCDATA\Traffic\RESO\Resolutions\413-561; ns.doc

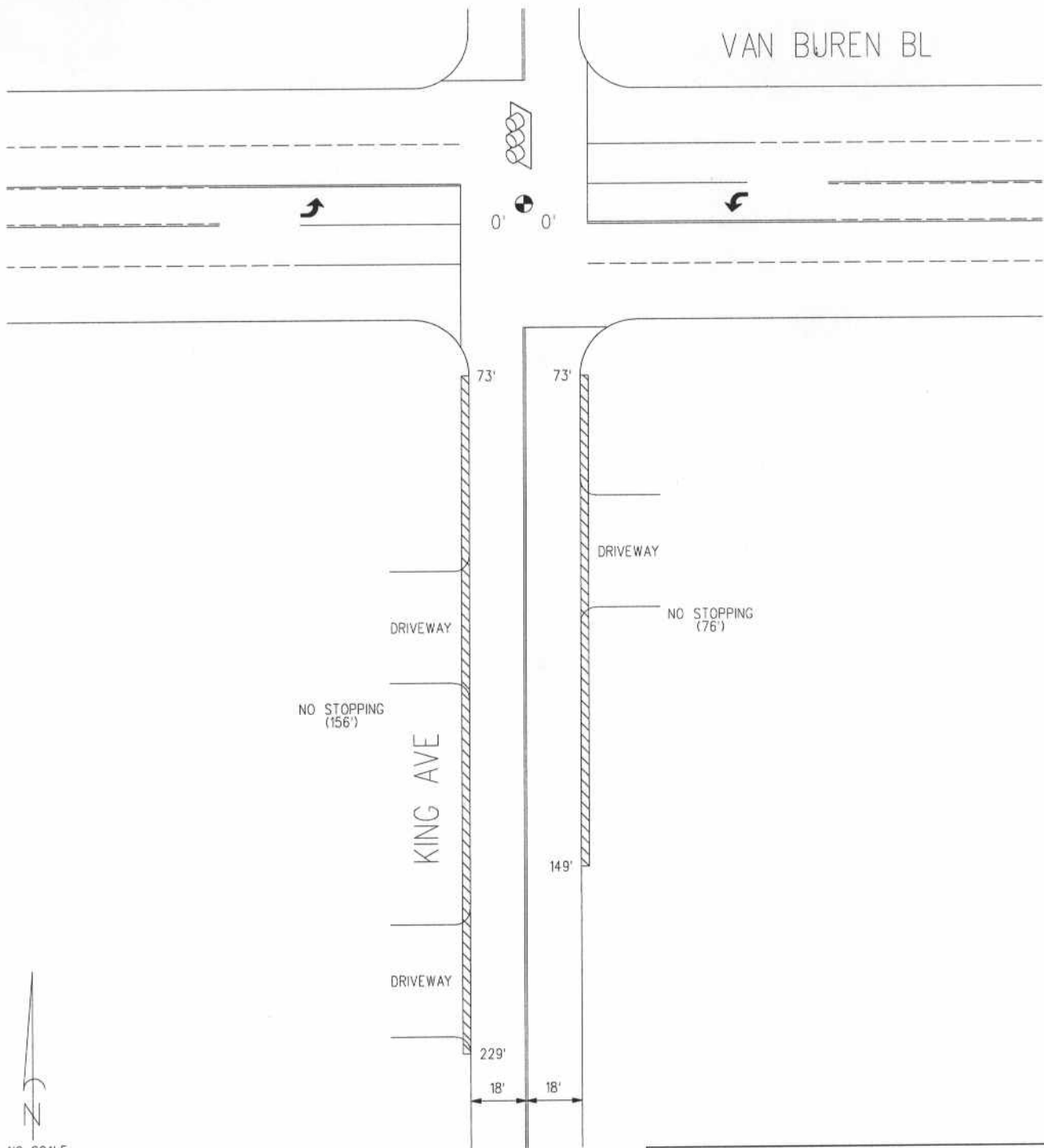

FORM APPROVED
COUNTY COUNSEL

21 JUN 21 2004
BY Gordon V. Ubo



NO SCALE

LEGEND:

-  PROPOSED NO STOPPING ZONE
-  POINT OF INTERSECTION

COUNTY OF RIVERSIDE
 TRANSPORTATION DEPARTMENT
 TRAFFIC ENGINEERING SECTION

RESTRICTED PARKING ZONE
 ON
 KING AVENUE
 IN THE
 WOODCREST AREA

FILE REFERENCE

SRF NO. 04-05-036
 CAD FILE: NOPARK242
 MAP PAGE: 27



DATE
 6/2/2004

DRAWN BY
 A. HIGGS

PAGE
 1 OF 1