

**SUBMITTAL TO THE BOARD OF SUPERVISORS
COUNTY OF RIVERSIDE, STATE OF CALIFORNIA**

211B



SUBMITTAL DATE:
February 4, 2005

FROM: TLMA – Transportation Dept.

SUBJECT: TRACT 26798-1

A Schedule "A" Subdivision in the Antelope Valley Area
EXTENSION OF TIME AGREEMENTS

RECOMMENDED MOTION: That the Board approve the attached agreements (which grant an extension of time for twelve months to complete improvements) and approve and accept the consent letter/rider as approved by County Counsel.

BACKGROUND: On September 24, 2002, the Board entered into agreements with SR/MV Menifee, LLC for the improvement of streets, the installation of a water and sewer system, and the setting of lot corners and subdivision monuments within the above referenced subdivision. Accompanying these agreements were securities posted by Gulf Insurance Company, as follows:

- \$949,500 - Bond BE2618847 for the completion of street improvements
 - \$214,000 - Bond BE2618848 for the completion of the water system
 - \$148,500 - Bond BE2618849 for the completion of the sewer system
 - \$623,000, \$ 107,000, and \$74,250 - Bonds BE2618847, BE2618848, and BE2618849, respectively for the material and labor security
 - \$10,100 - Bond BE2618850 for the monumentation security
- (Continued)**

Departmental Concurrence

REVIEWED BY EXECUTIVE OFFICE
George A. Johnson
DATE 2/7/05

George A. Johnson

HS:lf
Submittals: Vicinity Map
Road/Drainage Improvement Agrmts
Water System Improvement Agrmts
Sewer System Improvement Agrmts
Survey Monument Agreements

George A. Johnson
Director of Transportation

- Consent
- Policy
- Consent
- Policy

Dept't Recomm.:
Per Exec. Ofc.:

Prev. Agn. Ref.: 09/24/02 - 2.8 | District: 3 | Agenda Number:

**ATTACHMENTS FILED
WITH THE CLERK OF THE BOARD**

2.10

The Honorable Board of Supervisors

RE: Tract 26798-1

February 4, 2005

Page 2 of 2

The developer requests an extension of time for the completion of Tract 26798-1. Our records indicate that this project is approximately 0% completed for streets and utility work. The agreements for the extension of time have been approved by County Counsel.

STATE OF CALIFORNIA

798-1

PLAT OF THE NORTHEAST QUARTER, OF
SECTION 11, TOWNSHIP 6 NORTH, RANGE 12 EAST,
COUNTY OF RIVERSIDE, STATE OF CALIFORNIA.

THE KEITH COMPANIES, INC.

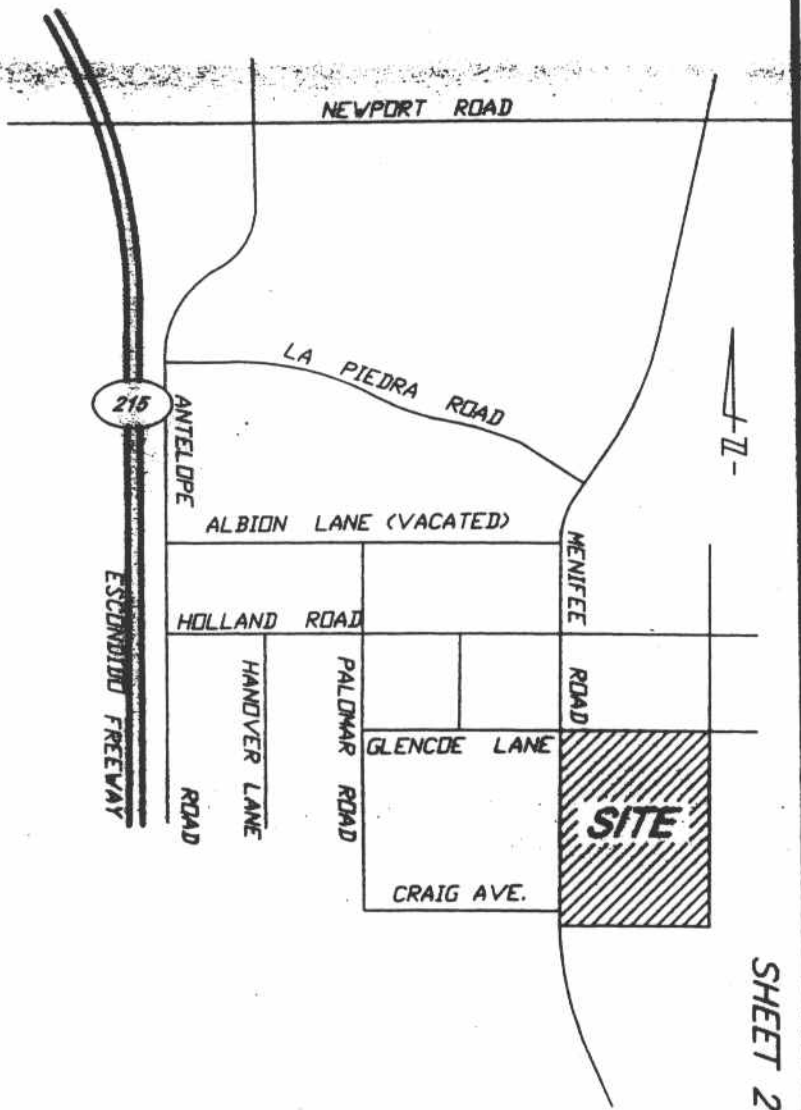
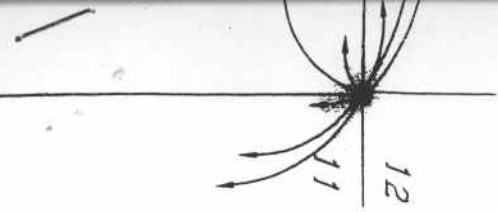

VICINITY MAP

N.T.S.

BASIS OF BEARINGS

THE NORTH LINE OF THE NORTHEAST QUARTER OF SECTION 11, TOWNSHIP 6

SHEET 2 OF 4 SHEETS