

**SUBMITTAL TO THE BOARD OF SUPERVISORS  
COUNTY OF RIVERSIDE, STATE OF CALIFORNIA**

327B



**FROM:** TLMA – Transportation Dept.

**SUBMITTAL DATE:**  
February 18, 2005

**SUBJECT: TRACT 28808-1**

A Schedule "A" Subdivision in the Mira Loma Area  
**EXTENSION OF TIME AGREEMENTS**

**RECOMMENDED MOTION:** That the Board approve the attached agreements (which grant an extension of time for twelve months to complete improvements) and approve and accept the consent letter/rider as approved by County Counsel.

**BACKGROUND:** On July 2, 2002, the Board entered into agreements with Tract 28808, LLC for the improvement of streets, the installation of a water and sewer system, and the setting of lot corners and subdivision monuments within the above referenced subdivision. Accompanying these agreements were securities posted Developers Surety and Indemnity Co, as follows:

- \$1,054,000 - Bond 848900S for the completion of street improvements
- \$313,500 - Bond 848900S for the completion of the water system
- \$340,500 - Bond 848900S for the completion of the sewer system
- \$854,000 - Bond 848900S for the material and labor security
- \$57,300 - Bond 848901S for the monumentation security

(Continued)

HS:lf  
 Submittals: Vicinity Map  
 Road/Drainage Improvement Agrmts  
 Water System Improvement Agrmts  
 Sewer System Improvement Agrmts  
 Survey Monument Agreements

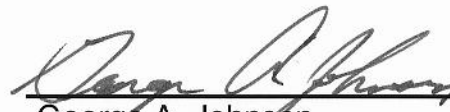
  
 \_\_\_\_\_  
 George A. Johnson  
 Director of Transportation

Departmental Concurrence

REVIEWED BY EXECUTIVE OFFICE

DATE 2-23-05 RK

Consent     Policy  
 Consent     Policy

COUNTY OF RIVERSIDE  
 ORDERED 13 6M 3-55  
 OFFICE  
 EXECUTIVE

Prev. Agn. Ref.: 07/02/02 – 2.7

District: 2

Agenda Number:

2.24

The Honorable Board of Supervisors

RE: Tract 28808-1

February 18, 2004

Page 2 of 2

The developer requests an extension of time for the completion of Tract 28808-1. Our records indicate that this project is approximately 90% completed for streets and utility work. The agreements for the extension of time have been approved by County Counsel.

50TH STREET

# SURVEYOR

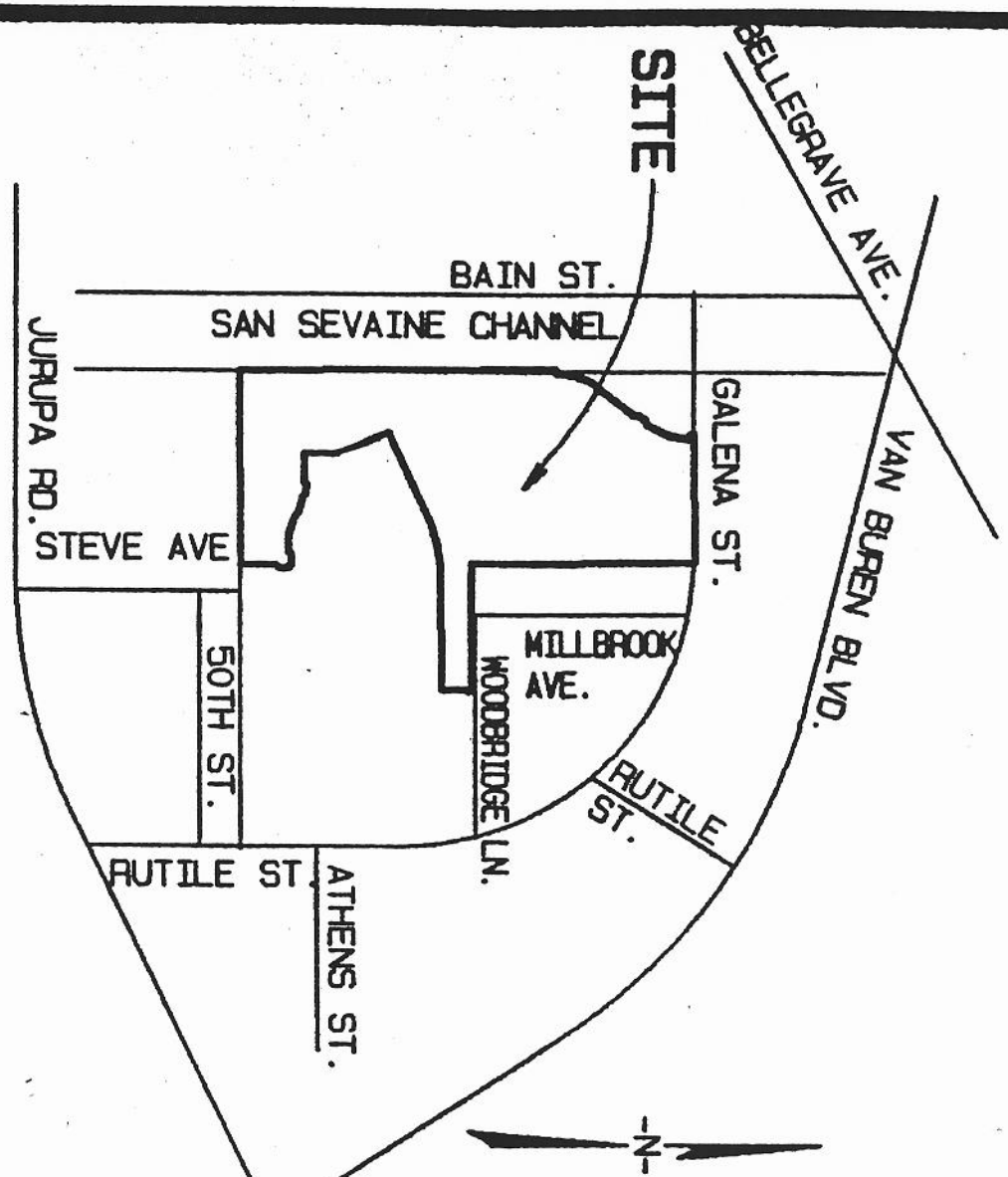

## VICINITY MAP

N.T.S.

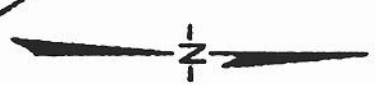

1. BASIS OF BEARING IS THE NORTH 00° 17' 29" WEST 114 OF MAPS, PAGES 84-
2. ( ) INDICATES RECORD OTHERWISE NOTED.
3. [ ] INDICATES RECORD
4. ● INDICATES FOUND
5. ○ INDICATES SET 1"
6. SET 1" IRON PIPE TAGGED CORNER CUTBACKS AND ANG EXIST, SET NAIL AND TAG BLOCK WALL IN LIEU OF 1
8. SET STEEL PIN AND TAG L LINES PROJECTED PER STD
9. ALL MONUMENTS SHOWN AS NO. 461.9.
10. THIS TRACT CONTAINS 54.
11. C.C. & RS PER INSTRUMENT
12. LLLLLLLL INDICATES RE