



The Honorable Board of Supervisors

RE: Installation of Highway Guide Signs and Associated Improvements, Washington Street at Interstate 10, Palm Desert area.

February 18, 2005

Page 2 of 2

The additional new signs that are proposed to be constructed on Washington Street at the Interstate 10 interchange will provide improved directional guidance for the motoring public and for the residents of the Bermuda Dunes and Del Webb communities.

Project no. A2-11222.



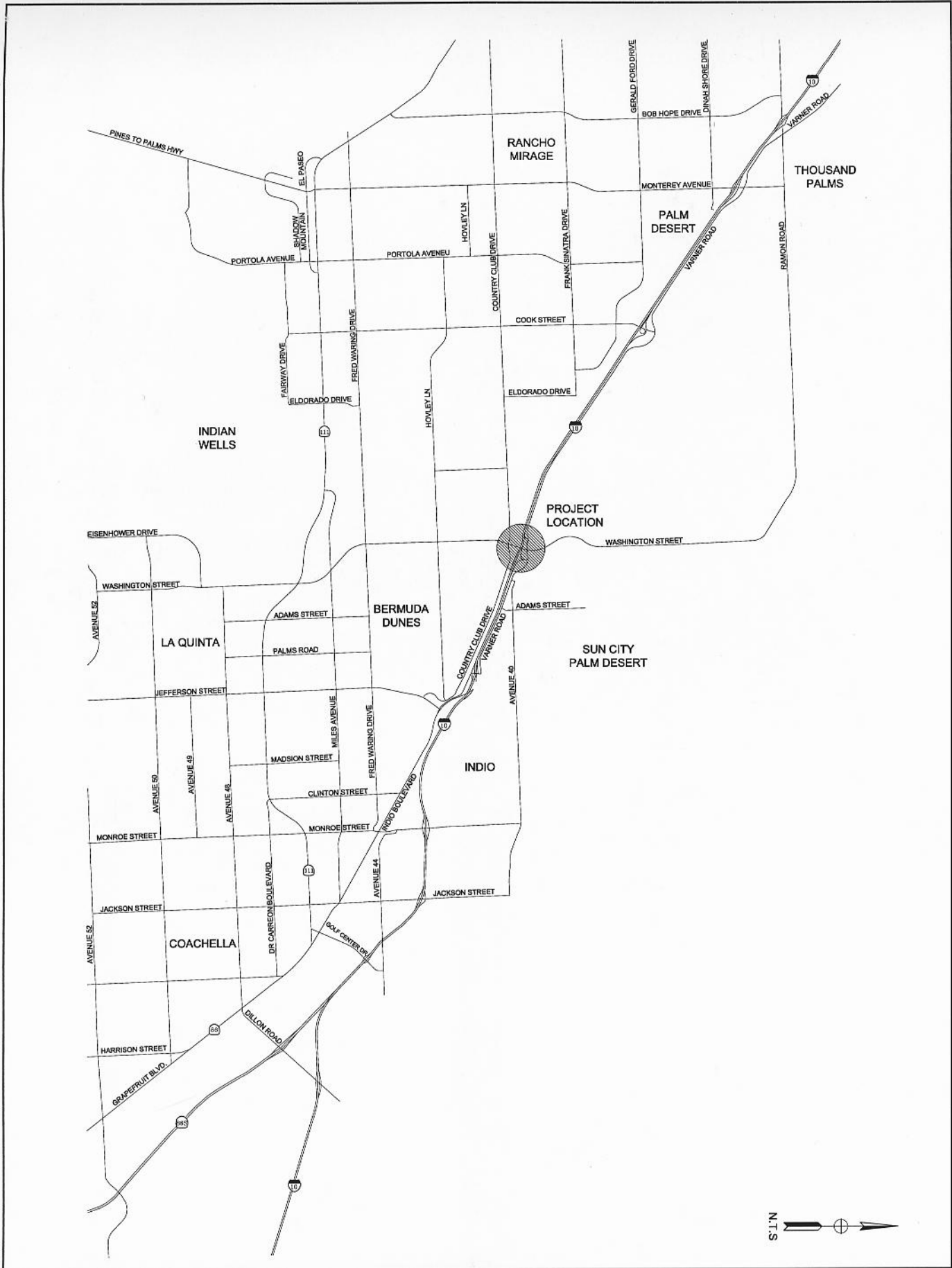

Washington Street Guide Signing



Location Map