

SUBMITTAL TO THE BOARD OF SUPERVISORS
COUNTY OF RIVERSIDE, STATE OF CALIFORNIA

513 B



FROM: TLMA – Transportation Dept.

SUBMITTAL DATE:

SUBJECT: Approval of **TRACT 30576-1**
A Schedule "A" Subdivision in the Eastvale Area

RECOMMENDED MOTION: That the Board approve the Improvement Agreements and Securities as approved by County Counsel, approve the final map and authorize the Chairman to sign the Improvement Agreements and map for Tract 30576-1.

BACKGROUND: This map complies in all respects with the provisions of Division 3 of Title 15 of the Government Code and applicable local ordinances. The developer desires to enter into Improvement Agreements to guarantee the construction of the required improvements and has submitted Improvement Agreements and Securities which have been approved by County Counsel.

Departmental Concurrence

HS:lf

Submittals: Final Map

- Road/Drainage Improvement Agmts (Onsite)
- Water System Improvement Agmts (Onsite)
- Sewer System Improvement Agmts (Onsite)
- Survey Monument Agreements (Onsite)
- Road/Drainage Improvement Agmts (Offsite)
- Water System Improvement Agmts (Offsite)
- Sewer System Improvement Agmts (Offsite)

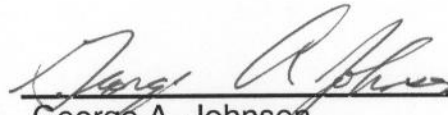
George A. Johnson
Director of Transportation

REVIEWED BY EXECUTIVE OFFICE
[Signature]
DATE 3/15/05

Consent Policy
 Consent Policy

Dep't Recomm.:
Per Exec. Ofc.:

Prev. Agn. Ref.:

District: 2

Agenda Number:

ATTACHMENTS FILED
WITH THE CLERK OF THE BOARD

2.5

IN AN AREA OF THE LOCALITY, WHICH THE SAME HAS BEEN IN OPERATION FOR MORE THAN THREE (3) YEARS, IF IT WASN'T A NUISANCE AT THE TIME IT BEGAN. THE TERM "AGRICULTURAL ACTIVITY, OPERATION OR FACILITY, OR APPURTENANCES THEREOF" INCLUDES, BUT IS NOT LIMITED TO, THE CULTIVATION AND TILLAGE OF THE SOIL, DAIRYING, THE PRODUCTION, CULTIVATION, GROWING AND HARVESTING OF ANY APICULTURE, OR HORTICULTURE, THE RAISING OF LIVESTOCK, FUR BEARING ANIMALS, FISH OR POULTRY, AND ANY PRACTICES PERFORMED BY A FARMER OR ON A FARM AS INCIDENT TO, OR IN CONNECTION WITH, SUCH FARMING OPERATIONS, INCLUDING PREPARATION FOR MARKET, DELIVERY TO STORAGE OR TO MARKET, OR TO CARRIERS FOR TRANSPORTATION TO MARKET.

FD. 2 1/2" IP W/ 3 1/4" BRASS CAP DN. 1.2'
 STAMPED AS SHOWN, PER RS 89/91-95

PRACTICES.
 THE SITE IS UNDER SOIL MIXTURES)
 THE POTENTIAL EXISTS ON THE CONSTRUCTION AND OF THE COUNTY

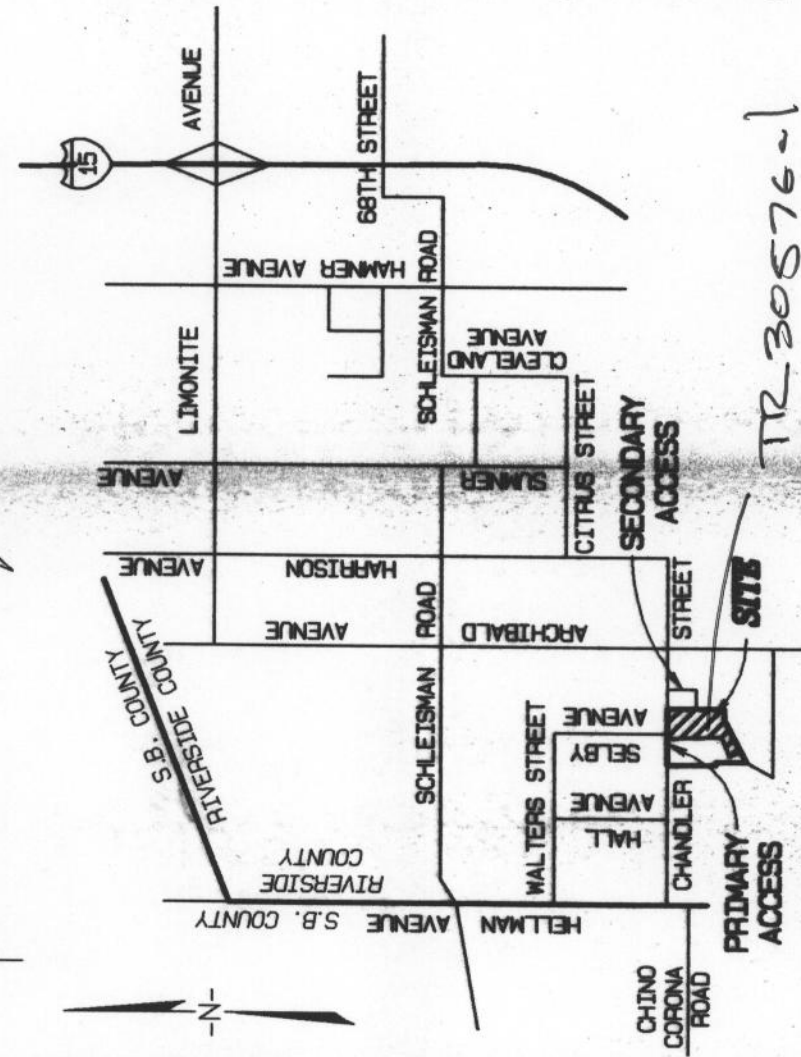
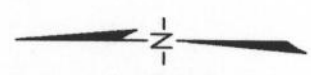

TR-30576-1

VICINITY MAP
 NOT TO SCALE

SURVEY

1. BASIS OF BEARD NORTH 89°21'45" BOOK 88, PAGES
2. ● INDICATES
3. ○ INDICATES
4. () INDICATES
5. < > INDICATES NO. 4714
6. SET 1" I.P. TA CORNER CUTBACK BLOCK WALLS FACE OF REAR
7. SET STEEL PIN LINES PROJECT
8. L L L L L INDICATES
9. TRACT CONTAINS
10. DRAINAGE EASEMENTS OBSTRUCTIONS.
11. RSM INDICATES