

**SUBMITTAL TO THE BOARD OF SUPERVISORS  
COUNTY OF RIVERSIDE, STATE OF CALIFORNIA**

638



**FROM:** TLMA - Transportation Dept.

**SUBMITTAL DATE:**  
March 21, 2005

**SUBJECT:** Construction of Interchange Landscaping Improvements, Interstate 10 at Monterey Avenue and Interstate 10 at Washington Street, Palm Desert area

**RECOMMENDED MOTION:** That the Board accept the low bid of Sierra Landscape Company, Inc. of Palm Desert, CA in the amount of \$775,321.00. Award the contract to that firm, and authorize the Chairman of the Board to execute the contract documents. Amend the Transportation Improvement Program's project budget as proposed on Attachment "A".

**BACKGROUND:** By Minute Order dated November 9, 2004 (agenda item 3.19) the Board authorized the Clerk of the Board to advertise for the construction of interchange landscape improvements at the Interstate 10 at Washington Street and Interstate 10 at Monterey Avenue freeway interchanges in the Palm Desert area of Riverside County. Bids for the project were opened in the office of the Director of Transportation at 2:00 pm, Wednesday, December 22, 2005. Three bids were received. The lowest and best bid was submitted by Sierra Landscape Company, Inc. in the amount of \$775,321.00.

*George A. Johnson*  
George A. Johnson  
Director of Transportation

GAJ:sd

(Continued On Attached Page)

<b>FINANCIAL DATA</b>	Current F.Y. Total Cost:	\$ 775,321.00	In Current Year Budget:	Yes
	Current F.Y. Net County Cost:	\$ 0.00	Budget Adjustment:	No
	Annual Net County Cost:	\$ 0.00	For Fiscal Year:	2004/2005
<b>SOURCE OF FUNDS:</b> Gas Tax, Transportation Enhancement Activities (TEA), State Exchange Funds			Positions To Be Deleted Per A-30	<input type="checkbox"/>
			Requires 4/5 Vote	<input type="checkbox"/>

**C.E.O. RECOMMENDATION: APPROVE**

County Executive Office Signature

*James P. ...*

- Dept't Recomm.:  Consent
- Per Exec. Ofc.:  Consent
- Policy
- Policy

Prev. Agn. Ref. 11/9/04 (3.19) | District: 4 | Agenda Number:

3.46

**ATTACHMENTS FILED WITH THE CLERK OF THE BOARD**

The Honorable Board of Supervisors

RE: Construction of Interchange Landscaping Improvements, Interstate 10 at Monterey Avenue and Interstate 10 at Washington Street, Palm Desert area

March 21, 2005

Page 2 of 2

The bid is \$199,921.00 (34.7%) more than the Engineer's Estimate. Bids exceeded the engineer's estimate due to higher than expected bid prices for the concrete work. Review of the bids indicates that it is not likely that lower bids would be received should this project be re-bid.

The Transportation Department has requested an increase in Transportation Enhancement Activities funding from the Riverside County Transportation Commission (RCTC), and the Commission is scheduled to act on that request on Friday, March 18, 2005. Approval of the funding increase is anticipated. The remaining funding shortfall will be funded by State Exchange Funds.

The contractor is qualified.

The project will provide landscaping and hard-scaping improvements at the two subject interchanges, except for the north-east quadrant of the I-10 and Monterey Avenue interchange which will be landscaped under a future, City of Palm Desert contract.

The State of California Department of Transportation (Caltrans) will assume maintenance responsibility for the proposed landscaping at the I-10 and Monterey Avenue interchange and at the I-10 and Washington Street interchange, 4 years and 20 years, respectively, after completion of the work. In the interim, the following entities will maintain the landscaping in accordance with forthcoming cooperative agreements:

1. I-10 and Monterey Avenue Interchange Landscaping  
Maintenance shared among the County of Riverside, City of Palm Desert and the City of Rancho Mirage.
2. I-10 and Washington Street Interchange Landscaping  
Maintenance shared among the County of Riverside, City of Palm Desert, City of La Quinta and the City of Indian Wells.

Project no. B1-0390.



**Riverside County Transportation Department  
Summary of Bids**

**PROJECT: I-10/Monterey Ave. & Washington St.  
Landscape Construction**

**Advertised: November 9, 2004 (Agenda item 3.19)  
Bids Open: 2:00 pm Date: December 22, 2004**

**PROJECT NOS. B1-0390; STPLNER-5956(146)**

COUNTY'S ESTIMATE						Sierra Landscape Company Palm Desert, CA 92255	
ITEM NO.	ITEM CODE	CONTRACT ITEM	UNITS	QUANTITY	UNIT PRICE	ENG ESTIMATE	AMOUNT
1	000003	LANDSCAPING AND IRRIGATION SYSTEM	LS	1	380,000.00	380,000.00	382,721.00
2	000003	CONCRETE INTERLOCKING STONE	M2	760	100.00	76,000.00	275,000.00
3	209801	MAINTENANCE VEHICLE PULLOUT	LS	1	40,000.00	40,000.00	48,000.00
4	160101	CLEARING AND GRUBBING	LS	1	4,000.00	4,000.00	4,000.00
5	120100	TRAFFIC CONTROL SYSTEM	LS	1	10,000.00	10,000.00	12,000.00
6	566011	ROADSIDE SIGN - ONE POST	EA	8	900.00	7,200.00	700.00
7	566012	ROADSIDE SIGN - TWO POST	EA	8	900.00	7,200.00	700.00
8	200002	ROADSIDE CLEARING	LS	1	4,000.00	4,000.00	4,000.00
9	074020	WATER POLLUTION CONTROL	FA	1	10,000.00	10,000.00	10,000.00
10	074019	PREPARE STORM WATER POLLUTION PREVENTION PLAN	FA	1	10,000.00	10,000.00	10,000.00
11	000003	PLANT ESTABLISHMENT (250 WORKING DAYS)	LS	1	22,000.00	22,000.00	6,400.00
12	066102	DUST ABATEMENT	LS	1	5,000.00	5,000.00	12,000.00
<b>TOTALS:</b>						<b>575,400.00</b>	<b>775,321.00</b>

COUNTY'S ESTIMATE						America West Landscaping Bellflower, CA 90707		Nativ Engineering, Inc. Reseda, CA 91335	
ITEM NO.	ITEM CODE	CONTRACT ITEM	UNITS	QUANTITY	BID	AMOUNT	BID	AMOUNT	AMOUNT
1	000003	LANDSCAPING AND IRRIGATION SYSTEM	LS	1	510,515.41	510,515.41	823,000.00	823,000.00	823,000.00
2	000003	CONCRETE INTERLOCKING STONE	M2	760	221.57	168,393.20	65.00	49,400.00	49,400.00
3	209801	MAINTENANCE VEHICLE PULLOUT	LS	1	52,591.60	52,591.60	10,000.00	10,000.00	10,000.00
4	160101	CLEARING AND GRUBBING	LS	1	4,000.00	4,000.00	100,000.00	100,000.00	100,000.00
5	120100	TRAFFIC CONTROL SYSTEM	LS	1	7,993.26	7,993.26	10,000.00	10,000.00	10,000.00
6	566011	ROADSIDE SIGN - ONE POST	EA	8	694.01	5,552.08	200.00	1,600.00	1,600.00
7	566012	ROADSIDE SIGN - TWO POST	EA	8	1,738.20	13,905.60	250.00	2,000.00	2,000.00
8	200002	ROADSIDE CLEARING	LS	1	12,734.04	12,734.04	10,000.00	10,000.00	10,000.00
9	074020	WATER POLLUTION CONTROL	FA	1	10,000.00	10,000.00	10,000.00	10,000.00	10,000.00
10	074019	PREPARE STORM WATER POLLUTION PREVENTION PLAN	FA	1	10,000.00	10,000.00	10,000.00	10,000.00	10,000.00
11	000003	PLANT ESTABLISHMENT (250 WORKING DAYS)	LS	1	45,047.17	45,047.17	20,000.00	20,000.00	20,000.00
12	066102	DUST ABATEMENT	LS	1	37,495.93	37,495.93	3,000.00	3,000.00	3,000.00
<b>TOTALS:</b>						<b>878,228.29</b>	<b>878,228.29</b>	<b>1,049,000.00</b>	<b>1,049,000.00</b>

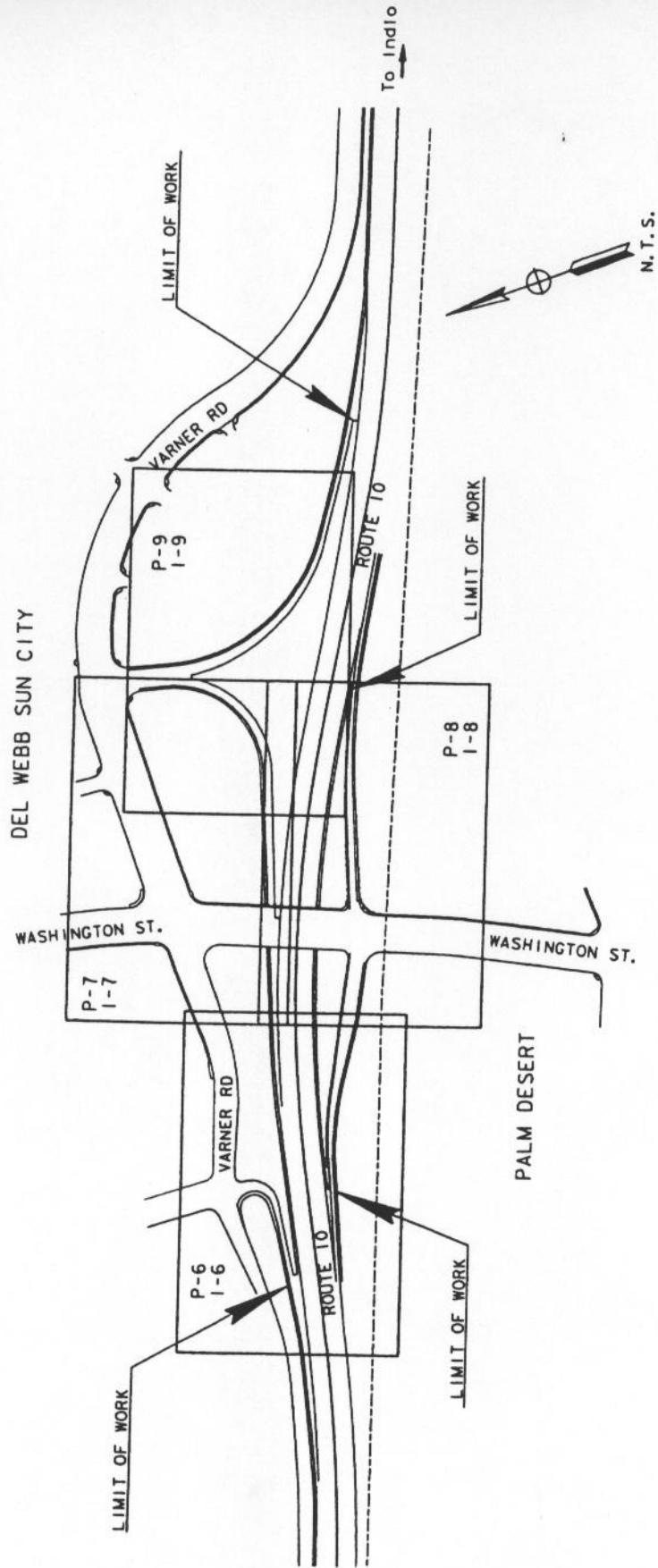

T5SR7E, SECT. 1, 6, 7 AND 12  
 VICINITY MAP (WASHINGTON ST.)

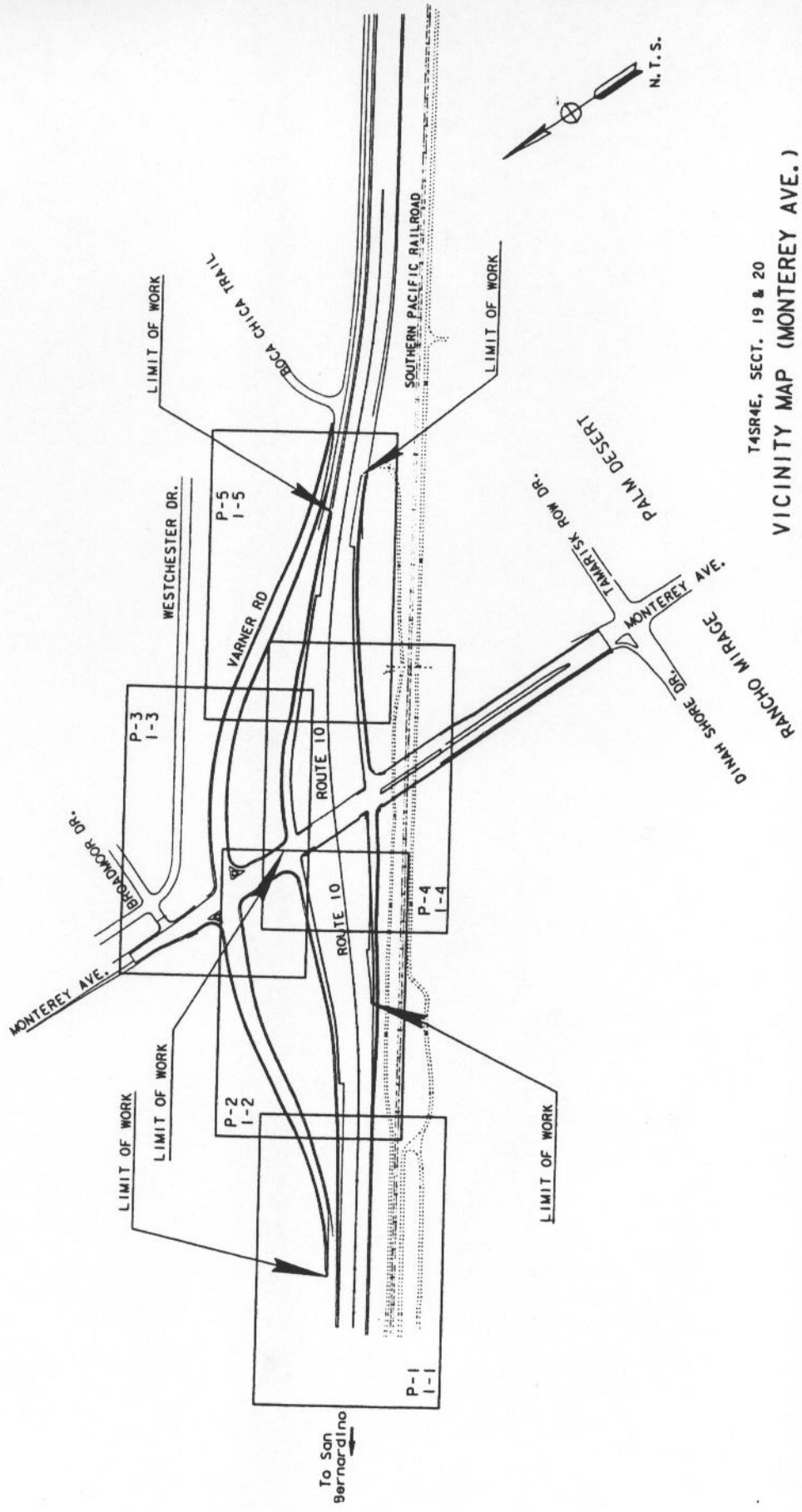

T4SR4E, SECT. 19 & 20  
VICINITY MAP (MONTEREY AVE.)