

SUBMITTAL TO THE BOARD OF SUPERVISORS
COUNTY OF RIVERSIDE, STATE OF CALIFORNIA

7058



FROM: TLMA – Transportation Dept.

SUBMITTAL DATE:
March 28, 2005

SUBJECT: Tract 29396

A Schedule "A" Subdivision in the Rancho California Area
ONE YEAR GUARANTEE AND MAINTENANCE AGREEMENTS

RECOMMENDED MOTION: That the Board approve the attached One Year Guarantee and Maintenance Agreements as approved by County Counsel and authorize the Chairman to sign these agreements for Tract 29396.

BACKGROUND: Improvements have been completed on this project. The developer desires to enter into Maintenance Agreements to guarantee a one year maintenance of the improvements and has submitted agreements and securities which have been approved by County Counsel.

Departmental Concurrence

REVIEWED BY EXECUTIVE OFFICE

DATE 3/28/05

HS:lf

Submittals: Vicinity Map
Road/Drainage Maint Agrmts
Water System Maint Agrmts
Sewer System Maint Agrmts

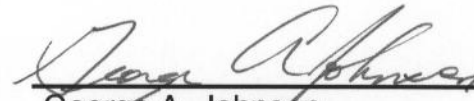
George A. Johnson
Director of Transportation

- Consent
- Policy
- Consent
- Policy

COUNTY OF RIVERSIDE
02 MAR 28 05 15:05

OFFICE EXECUTIVE
02 MAR 28 05 08:55

Prev. Agn. Ref.: 05/08/01 - 2.12

District: 3

Agenda Number:

**ATTACHMENTS FILED
WITH THE CLERK OF THE BOARD**

2.10

IN THE UNINCORPORATED TERRITORY OF THE COUNTY OF RIVERS TRACT NO. 29396

BEING A SUBDIVISION OF A PORTION OF LOTS 176, 177, 188 AND 189 OF THE MURRIETA RANCHO AS SHOWN BY THE MAP OF THE TEMECULA LAND AND WATER COMPANY ON FILE IN RECORDS OF SAN DIEGO COUNTY, CALIFORNIA.

K & A ENGINEERING, INC. JANUARY, 2000

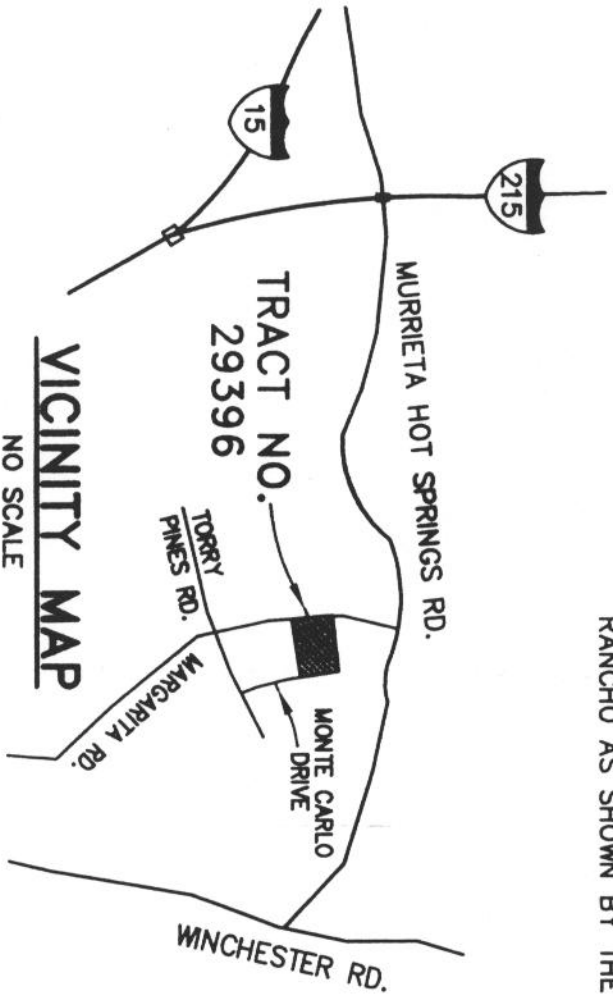

VICINITY MAP
NO SCALE



SCALE: 1" = 100'

SURVEYOR'S

1. THE BEARLI ROAD, BEI
2. TRACT NO.
3. TRACT NO.
- 4.
5. () 1
6. (())
7. < >
8. [] 1
9. { } 11
10. BUILDING
11. DRAINAGE

○ INDICATES

● INDICATES UNLESS C

■ INDICATES TRACT NC

ENVIRONMENTAL CONSTRAINT NOTE

ENVIRONMENTAL CONSTRAINT SHEET AFFECTING THIS MAP IS ON FILE IN THE OFFICE OF THE RIVERSIDE COUNTY SURVEYOR, IN E.C.S. BOOK 31, PAGE 15. THIS AFFECTS ALL LOTS.