

SUBMITTAL TO THE BOARD OF SUPERVISORS
COUNTY OF RIVERSIDE, STATE OF CALIFORNIA

614B



FROM: TLMA - Transportation Department

SUBMITTAL DATE:

May 27, 2005

SUBJECT: Resolution 413-588 to Establish No-Stopping Zones on McKinley Street and Indiana Avenue, Home Gardens area

RECOMMENDED MOTION: That the Board adopt Resolution 413-588 to establish No-Stopping Zones on McKinley Street and Indiana Avenue in the Home Gardens area, as described in attached Resolution 413-588.

BACKGROUND: The Transportation Department was contacted by area residents who were concerned about the visibility obstruction caused by vehicles, especially big-rig trucks, being parked on these two streets.

Transportation Department staff reviewed these two roadways in the field and determined that the proposed no-stopping zones would improve sight distance for cross-street traffic and improve overall traffic operations and safety on the segments of McKinley Street and Indiana Avenue.

Based on this review, the Transportation Department recommends approval of these No-Stopping Zones. The Transportation Department staff has contacted the Riverside Area office of the California Highway Patrol regarding the proposed zones.

County Counsel has approved this resolution.

LTT:bjl
attachments

cc: County Counsel
Lawrence Tai

REVIEWED BY EXECUTIVE OFFICE
[Signature]
DATE 5/31/05

Departmental Concurrence

[Signature]
George A. Johnson
Director of Transportation

Dept't Recomm.: Policy
Per Exec. Ofc.: Consent Policy

Prev. Agn. Ref.: | District: 2 | Agenda Number: 2.21

2 RESOLUTION NO. 413-588
3 ESTABLISHING NO-STOPPING ZONES
4 IN THE HOME GARDENS AREA

5 BE IT RESOLVED, DETERMINED AND ORDERED by the Board of
6 Supervisors, County of Riverside, State of California, in regular session on
7 June 7, 2005, that pursuant to Ordinance No. 413, the following No-Stopping
8 Zones are hereby established in the Home Gardens area:

9
10 On the east side of McKinley Street starting at a point 75 feet north of the centerline of
11 Indiana Avenue to a point 1,800 feet north of said centerline, a total distance of 1,725
12 feet.

13
14 On the west side of McKinley Street starting at a point 75 feet south of the centerline of
15 Harlow Avenue to a point 1,480 feet south of said centerline, a total distance of
16 approximately 1,405 feet.

17
18 On the south side of Indiana Avenue starting at a point 175 feet west of the centerline
19 of Somerdale Street to a point 4,885 feet east of said centerline, a total distance of
20 5,060 feet.

21
22 On the north side of Indiana Avenue starting at a point 75 feet west of the centerline of
23 Lincoln Street to a point 4,950 feet west of said centerline, a total distance of
24 approximately 4,875 feet.
25

1
2
3
4
5
6
7
8
9
10
11
12
13
14
15
16
17
18
19
20
21
22
23
24
25

BE IT FURTHER RESOLVED, DETERMINED AND ORDERED that Resolution
No. 413-478, heretofore adopted by this Board of Supervisors on August 14, 2001, for No-
Stopping Zones on Indiana Avenue, is hereby rescinded.

AH:bjl
April 7, 2005
F:\PCDATA\Traffic\RESO\Resolutions\413-588.doc

FORM APPROVED
COUNTY COUNSEL

APR 12 2005
BY Gordon V. Abo

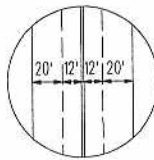
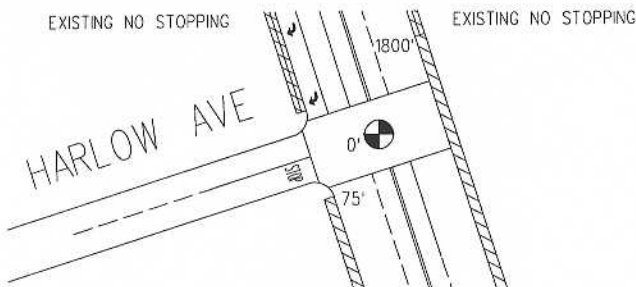

NO STOPPING
(1405')

NO STOPPING
(1725')

CLIFFSHIRE AVE

MCKINLEY ST

INDIANA AVE

LEGEND:

- PROPOSED NO STOPPING
- POINT OF INTERSECTION

COUNTY OF RIVERSIDE
TRANSPORTATION DEPARTMENT
TRAFFIC ENGINEERING SECTION

RESTRICTED PARKING ZONE
ON
MCKINLEY STREET
IN THE
HOME GARDENS AREA

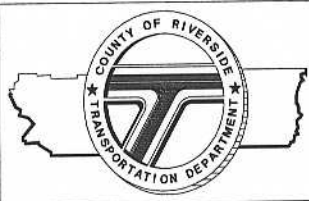

FILE REFERENCE	
SRF NO.	04-08-040
CAD FILE:	NOPARK242
MAP PAGE:	23A

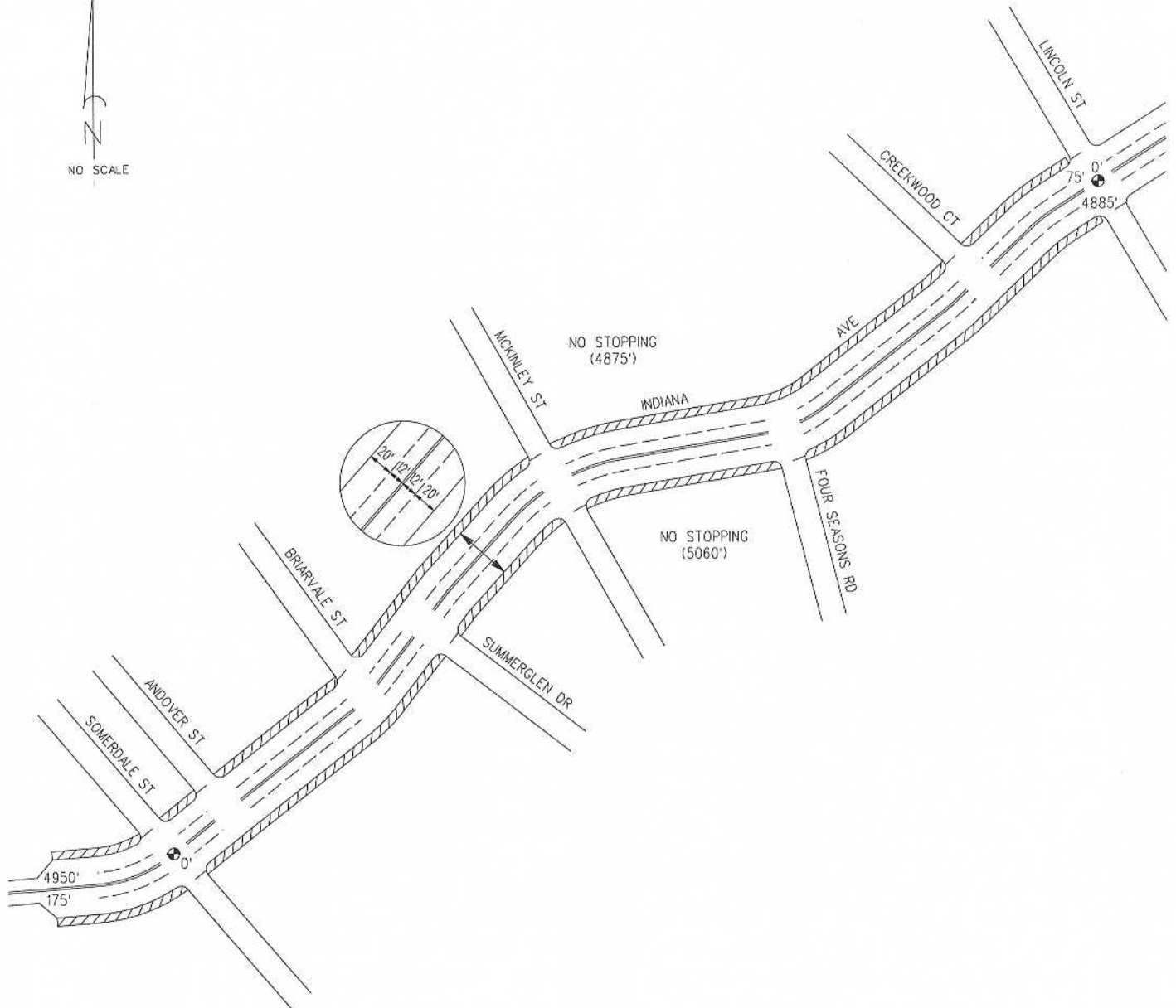

DATE	DRAWN BY	PAGE
3/24/2005	A. HIGGS	1 OF 1

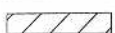

LEGEND:

-  PROPOSED NO STOPPING
-  POINT OF INTERSECTION

COUNTY OF RIVERSIDE
 TRANSPORTATION DEPARTMENT
 TRAFFIC ENGINEERING SECTION

RESTRICTED PARKING ZONE
 ON
 INDIANA AVE
 IN THE
 HOME GARDENS AREA

FILE REFERENCE	
SRF NO.	04-08-009
CAD FILE:	NOPARK242
MAP PAGE:	23A

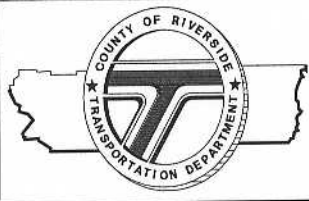

DATE	DRAWN BY	PAGE
2/24/2005	A. HIGGS	1 OF 1