

SUBMITTAL TO THE BOARD OF SUPERVISORS  
COUNTY OF RIVERSIDE, STATE OF CALIFORNIA

813 B



FROM: TLMA – Transportation Dept.

SUBMITTAL DATE:  
June 13, 2005

SUBJECT: TRACT 26007

A Schedule "A" Subdivision in the Alberhill Area  
**EXTENSION OF TIME AGREEMENTS**

**RECOMMENDED MOTION:** That the Board approve the attached agreements (which grant an extension of time for twelve months to complete improvements).

**BACKGROUND:** On April 29, 2003, the Board entered into agreements with KB Home Coastal, Inc. for the improvement of streets and the installation of a water and sewer system within the above referenced subdivision. Accompanying these agreements were faithful performance securities posted by Lumberman's Mutual Casualty Company as follows:

- \$1,242,500 - Bond #3S12714800 for the completion of street improvements
- \$246,500 - Bond #3S12714800 for the completion of the water system
- \$316,000 - Bond #3S12714800 for the completion of the sewer system
- \$54,700 - Bond #3S1271500 for the completion of the monumentation

(Continued)

HS:lf  
 Submittals: Vicinity Map  
 Road/Drainage Improvement Agrmts  
 Water System Maintenance Agrmts  
 Sewer System Maintenance Agrmts  
 Survey Monument Agreements

  
 \_\_\_\_\_  
 George A. Johnson  
 Director of Transportation

REVIEWED BY EXECUTIVE OFFICE  
*Ann... [Signature]*  
 DATE 6/14/05

Departmental Concurrence

Dep't Recomm.:  Consent  Policy  
 Per Exec. Ofc.:  Consent  Policy

Prev. Agn. Ref.: 04/29/03 – 2.19 | District: 1 | Agenda Number:

ATTACHMENTS FILED  
WITH THE CLERK OF THE BOARD

2.17

The Honorable Board of Supervisors  
RE: Tract 26007  
June 13, 2005  
Page 2 of 2

The developer requests an extension of time for the completion of Tract 26007. Our records indicate that this project is approximately 70% completed for streets and utility work. The agreements for the extension of time have been approved by County Counsel.

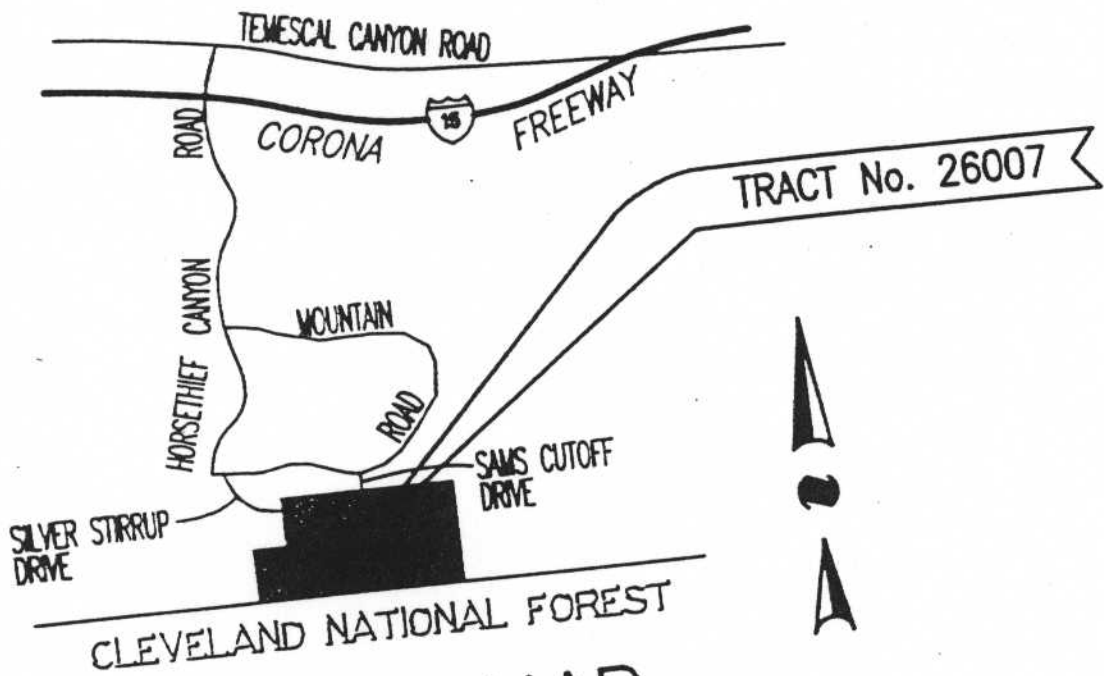

CLEVELAND NATIONAL FOREST

# VICINITY MAP

NOT TO SCALE  
SECTION 20, TOWNSHIP 5 SOUTH,  
RANGE 5 WEST