

**SUBMITTAL TO THE BOARD OF SUPERVISORS  
COUNTY OF RIVERSIDE, STATE OF CALIFORNIA**

343 B



**FROM:** TLMA - Transportation Department

**SUBMITTAL DATE:**

July 18, 2005

**SUBJECT:** Resolution 413-591 to Establish a No-Stopping Zone on Goetz Road, Canyon Lake area

**RECOMMENDED MOTION:** That the Board adopt Resolution 413-591 to establish a No-Stopping Zone on Goetz Road in the Canyon Lake area.

**BACKGROUND:** The Transportation Department was contacted by an area resident who is concerned about the daily parking of vehicles on Goetz Road by day laborers. There is a significant horizontal curve on Goetz Road at this location, and the dirt shoulder used for parking on Goetz Road is relatively narrow.

Transportation Department staff reviewed this location in the field and determined that the proposed No-Stopping Zone is appropriate, and will improve traffic operations and safety on this portion of Goetz Road.

Based on this review, the Transportation Department recommends approval of this No-Stopping Zone. The Transportation Department staff has contacted the Temecula Area office of the California Highway Patrol regarding the proposed zone.

County Counsel has approved this resolution.

LTT:bjl  
attachments

cc: County Counsel  
Lawrence Tai

Departmental Concurrence

REVIEWED BY EXECUTIVE OFFICE  
*[Signature]*  
DATE 7/19/05

*[Signature]*  
George A. Johnson  
Director of Transportation

Dept't Recomm.:  Consent  Policy  
Per Exec. Ofc.:  Consent  Policy

Prev. Agn. Ref.: | District: 3 | Agenda Number:

2.16

2 RESOLUTION NO. 413-591  
3 ESTABLISHING A NO-STOPPING ZONE  
4 IN THE CANYON LAKE AREA

5 BE IT RESOLVED, DETERMINED AND ORDERED by the Board of  
6 Supervisors, County of Riverside, State of California, in regular session on  
7 July 26, 2005, that pursuant to Ordinance No. 413, the following No-  
8 Stopping Zone is hereby established in the Canyon Lake area:

9  
10 On the east and west sides of Goetz Road starting at a point 75 feet north of  
11 the centerline of Newport Road to a point 1,000 feet north of said centerline, a  
12 total distance of approximately 925 feet.

13  
14 RH:bjl  
15 May 31, 2005

16 F:\PCDATA\Traffic\RESO\Resolutions\413-591; ns.doc

FORM APPROVED  
COUNTY COUNSEL

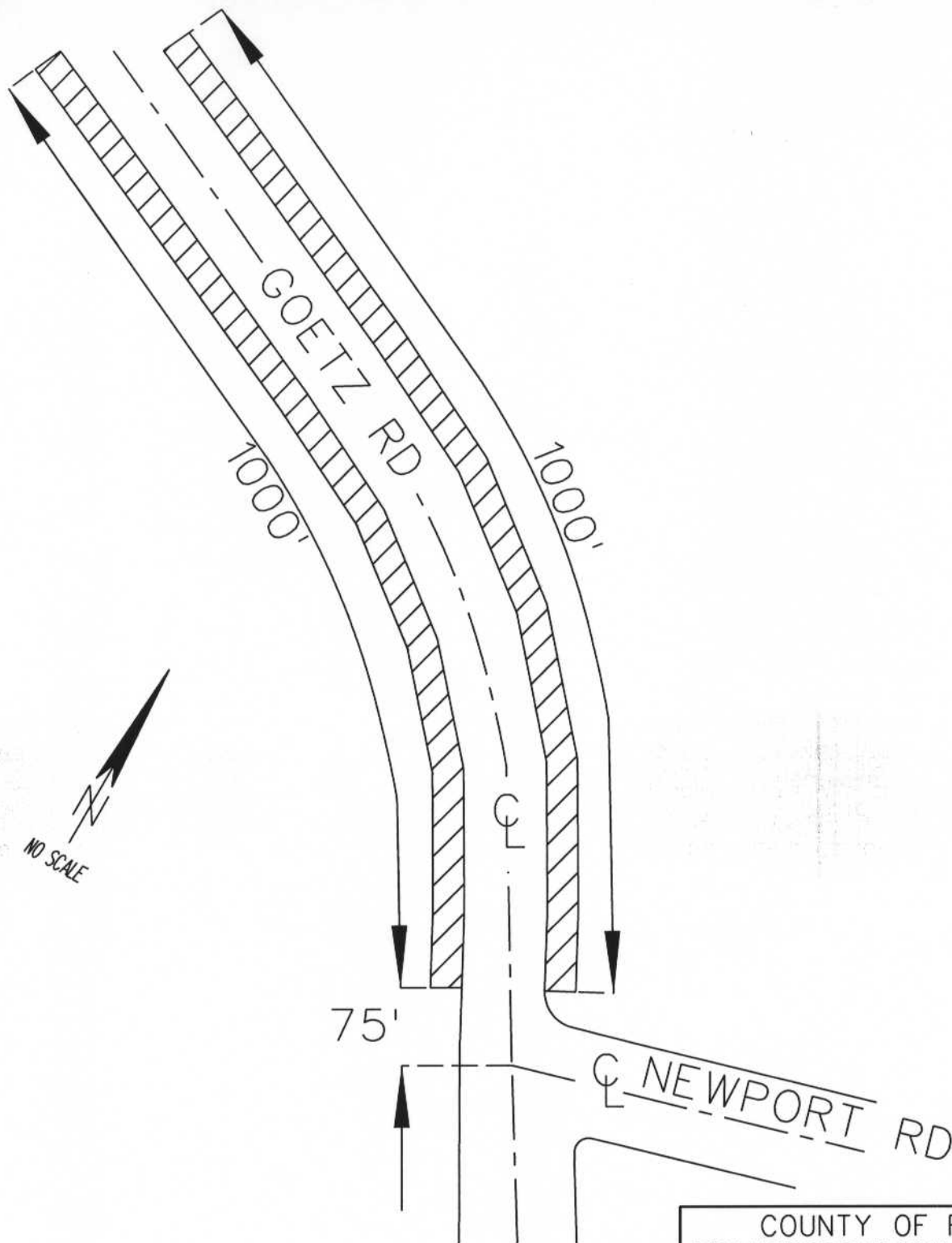

17 JUN 15 2005  
18 BY Arden V. Woo



COUNTY OF RIVERSIDE  
 TRANSPORTATION DEPARTMENT  
 TRAFFIC ENGINEERING SECTION

NO STOPPING ANYTIME  
 ZONE  
 ON GOETZ RD  
 IN THE  
 CANYON LAKE AREA

**LEGEND:**

-  PROPOSED NO STOPPING ZONE
-  CENTERLINE

**FILE REFERENCE**

SRF NO. 05-02-037  
 CAD FILE: GOETZ  
 RD BK PG: 68



DATE	DRAWN BY	PAGE
5/5/2005	R. HEALY	1 OF 1