

SUBMITTAL TO THE BOARD OF SUPERVISORS  
COUNTY OF RIVERSIDE, STATE OF CALIFORNIA

805 B



FROM: TLMA - Transportation Department

SUBMITTAL DATE:  
April 4, 2005

SUBJECT: Resolution 413-584 to Establish No-Stopping Zones on Reviere Drive, Menifee area

**RECOMMENDED MOTION:** That the Board adopt Resolution 413-584 to establish No-Stopping Zones on Reviere Drive in the Menifee area, as described in attached Resolution 413-584.

**BACKGROUND:** The Transportation Department was contacted by representatives of the Menifee Union School District, and the Callie Kirkpatrick Elementary School, which is located on Reviere Drive. During arrival and dismissal times, school-related traffic causes congestion and delay at the school driveway and the intersection of Menifee Road and Reviere Drive.

Transportation Department staff reviewed this roadway in the field and determined that no-stopping zones on both sides of Reviere Drive between Menifee Road and the school driveway will alleviate the congestion and improve operations and safety of the intersection at Menifee Road and Reviere Drive.

Based on this review, the Transportation Department recommends approval of these proposed No-Stopping Zones. The Transportation Department staff has contacted the Temecula Area office of the California Highway Patrol regarding the proposed zones.

County Counsel has approved this resolution.

LTT:bjl  
attachments

cc: County Counsel  
Lawrence Tai

George A. Johnson  
Director of Transportation

REVIEWED BY EXECUTIVE OFFICE

*[Handwritten signature]*  
DATE 7/14/05

Departmental Concurrence

- Dep't Recomm.:  Consent  Policy
- Per Exec. Ofc.:  Consent  Policy

COUNTY OF RIVERSIDE  
OFFICE OF THE EXECUTIVE  
7/14/05

7/14/05

Prev. Agn. Ref.: | District: 3 | Agenda Number: 2.16

2 RESOLUTION NO. 413-584  
3 ESTABLISHING NO-STOPPING ZONES  
4 IN THE MENIFEE AREA

5 BE IT RESOLVED, DETERMINED AND ORDERED by the Board of  
6 Supervisors, County of Riverside, State of California, in regular session on

7 April 12, 2005, that pursuant to Ordinance No. 413, the following No-  
8 Stopping Zones are hereby established in the Menifee area:

9  
10 On the north side of Reviere Drive starting at a point 43 feet west of the  
11 centerline of Menifee Road to a point 165 feet west of said centerline, a total  
12 distance of approximately 122 feet.

13  
14 On the south side of Reviere Drive starting at a point 43 feet west of the  
15 centerline of Menifee Road to a point 165 feet west of said centerline, a total  
16 distance of approximately 122 feet.

17  
18  
19 AH:bjl  
February 23, 2005

20 F:\PCDATA\Traffic\RESO\Resolutions\413-584.doc

FORM APPROVED  
COUNTY COUNSEL

21 FEB 28 2005  
BY Gordon V. Ubo

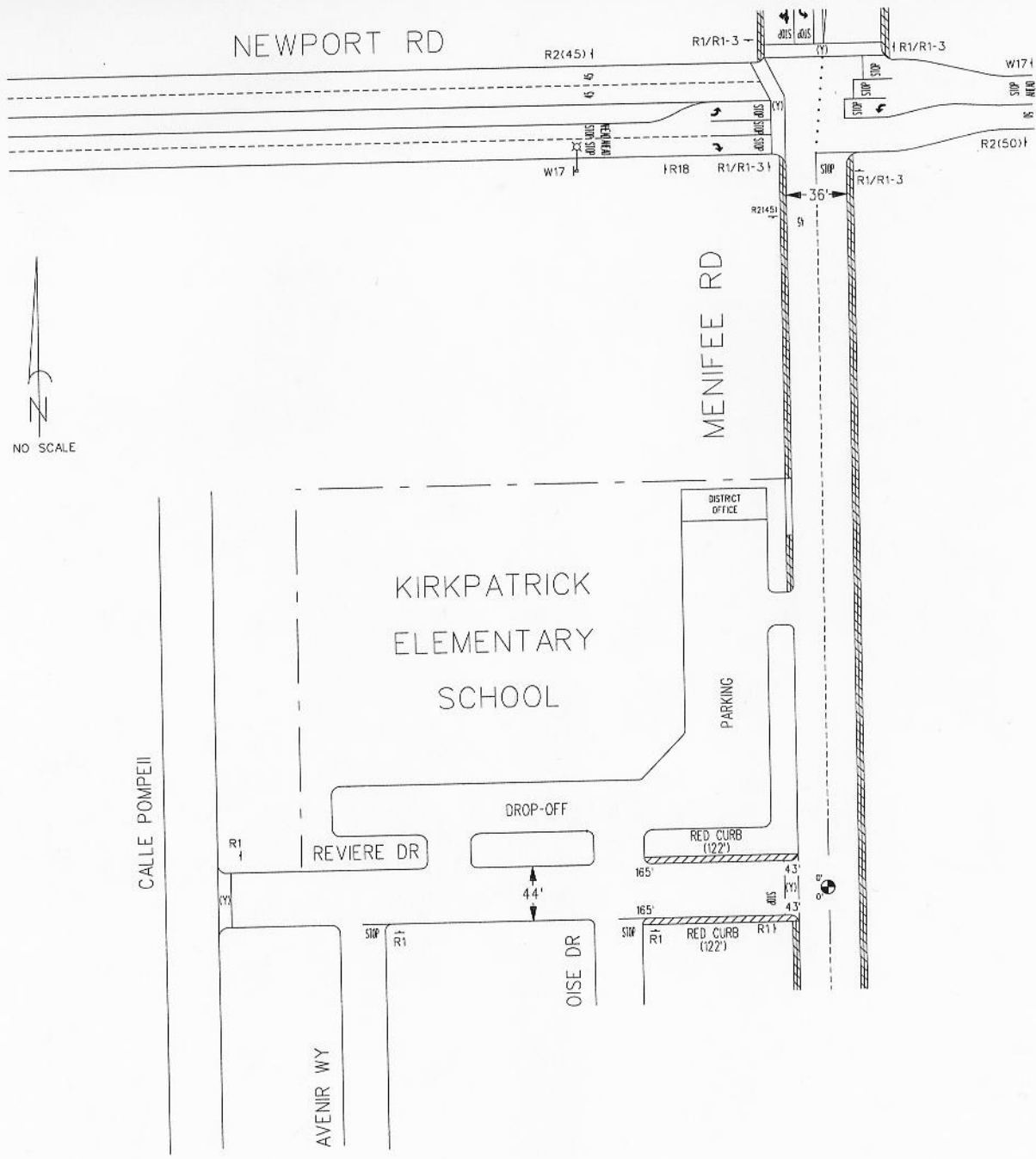

**LEGEND:**

- PROPOSED NO STOPPING
- EXISTING NO STOPPING
- POINT OF INTERSECTION

COUNTY OF RIVERSIDE  
 TRANSPORTATION DEPARTMENT  
 TRAFFIC ENGINEERING SECTION

RESTRICTED PARKING ZONE  
 ON  
 REVIERE DR  
 IN THE  
 MENIFEE AREA

**FILE REFERENCE**

SRF NO. 05-01-009  
 CAD FILE: NOPARK242  
 MAP PAGE: 117

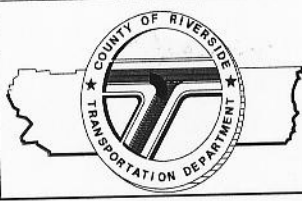

DATE 1/27/2005	DRAWN BY A. HIGGS	PAGE 1 OF 1
-------------------	----------------------	----------------