

**SUBMITTAL TO THE BOARD OF SUPERVISORS
COUNTY OF RIVERSIDE, STATE OF CALIFORNIA**

245 A



FROM: TLMA – Transportation Department

SUBMITTAL DATE:
April 25, 2005

SUBJECT: Underground Utility District No. 43, Lovekin Boulevard, Blythe City Limits ½ mile south of Seeley Avenue.

RECOMMENDED MOTION: That the Board of Supervisors adopt Resolution No. 2005-111 and call for a public hearing to be held on June 7, 2005.

BACKGROUND: The proposed underground utility district, on Lovekin Boulevard, between the Blythe City Limits and ½ mile south of Seeley Avenue, is a qualifying project under the California Public Utilities Commission Rule 20-A guidelines. This utility undergrounding project has been selected for implementation, consistent with the procedures approved by the Board on April 27, 1999 (agenda item no. 3.35) and as contained in the Transportation Improvement Program. The Southern California Edison Company provided the estimated cost of placing the appropriate overhead utilities underground at \$1,775,000, to be funded using a portion of the County's allocation of CPUC Rule 20-A funds, which are held in trust by the Southern California Edison Company.

BY Jim Johnson
 APR 25 2005
 Departmental Concurrence

 George Johnson
 Director of Transportation

FINANCIAL DATA	Current F.Y. Total Cost:	\$ 1,775,000	In Current Year Budget:	Yes
	Current F.Y. Net County Cost:	\$ 0.00	Budget Adjustment:	No
	Annual Net County Cost:	\$ 0.00	For Fiscal Year:	2004/05

SOURCE OF FUNDS: CPUC Rule 20-A	Positions To Be Deleted Per A-30	<input type="checkbox"/>
	Requires 4/5 Vote	<input type="checkbox"/>

C.E.O. RECOMMENDATION: **APPROVE**

County Executive Office Signature

- Policy
- Consent
- Dep't Recomm.:
- Per Exec. Ofc.:

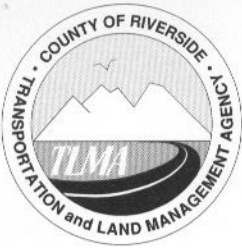

COUNTY OF RIVERSIDE
TRANSPORTATION AND
LAND MANAGEMENT AGENCY
Transportation Department



George A. Johnson, P.E.
Director of Transportation

REPORT REGARDING
PROPOSED UNDERGROUND UTILITY DISTRICT NO. 43

LOVEKIN BOULEVARD
Blythe City Limits
To ½ Mile South of Seeley Avenue

March 15, 2005

In 1967, the California Public Utilities Commission (CPUC) issued its decision No. 73078, known as CPUC Rule 20-A, which requires private electric and communication utilities in the State of California to set aside a certain amount of monies each year for the conversion of existing overhead distribution lines to an underground location.

By Minute Order dated April 27, 1999, agenda item no. 3.35, the Board of Supervisors approved Rule 20-A project selection methodology whereby technically sound and cost effective candidate projects are identified by the Transportation Department and the owning utility company for each Supervisorial District, and projects are to be funded over time so as to achieve relative spending equity among the five Supervisorial Districts, with final project selection to be made either by or after consultation with the respective Board member. Consistent with that Board action, the proposed project has been selected for implementation by Supervisor Wilson, Fourth District.

The Transportation Department recommends that the Board establish the Underground Utility District No. 43 (the "District"), on Lovekin Boulevard from the Blythe City Limits to ½ mile south of Seeley Avenue, a distance of approximately 7,140 feet, which is a qualifying project in the Fourth Supervisorial District, under the CPUC Rule 20-A guidelines.

The boundaries of the proposed underground utility district are as shown on the attached Underground Utility District Map, on file with the County Surveyor, and numbered 933-E (referred to as the "Underground Utility District").

The estimated cost of converting the electrical facilities to an underground location within the Underground Utility District is \$1,775,000, to be funded from the County of Riverside's CPUC Rule 20-A trust account, held by Southern California Edison. This estimated cost includes the cost of converting the affected property owner's meter panels to accept service from an underground location. No costs are to be borne by any property owners that may be affected by the project.

Construction should be completed within thirty-six months of the creation of the Underground Utility District. The Edison Company will perform or administer all of the design and construction work required for the conversion of their facilities.

One other affected utility company, Verizon Communications, will be required by the establishment of the Underground Utility District to relocate their overhead facilities to an underground location within the District's boundaries and to finance all conversion costs. This utility company has been advised of the proposed establishment of this Underground Utility District and has been requested to coordinate their design and construction activities with the Edison Company in order to reduce overall costs.

This CPUC Rule 20-A utility undergrounding project will remove all overhead conductors and wood poles within the project limits. Any existing street lights on wood poles will be replaced with ornamental granite street light poles.

This project is in the general public interest and a good candidate for an Underground Utility District as defined by the CPUC ruling. Additionally, the project will remove a concentration of overhead electric and communication distribution facilities that are in close proximity to a private airfield, and within the FAA's established "clear zone" for small airstrips. Removing the poles and conductors will therefore also be an aircraft safety improvement.

rb

UNDERGROUND UTILITY DISTRICT NO. 43 VICINITY MAP

LOVEKIN BOULEVARD

BLYTHE CITY LIMITS (SOUTH OF 14TH AVENUE)
TO 1/2 MILE SOUTH OF SEELEY AVENUE

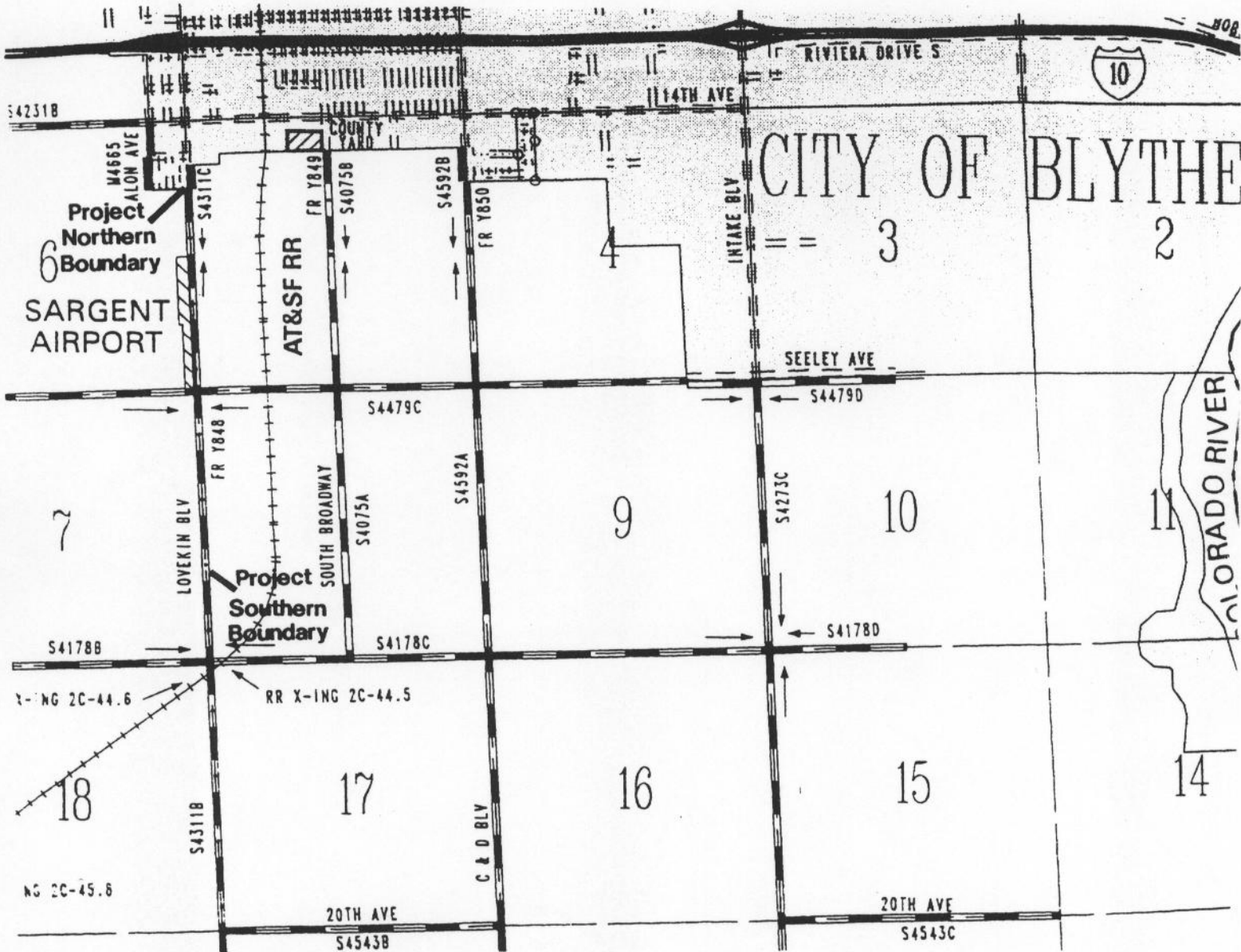

Proposed Underground Utility District No. 43
Lovekin Boulevard, Blythe

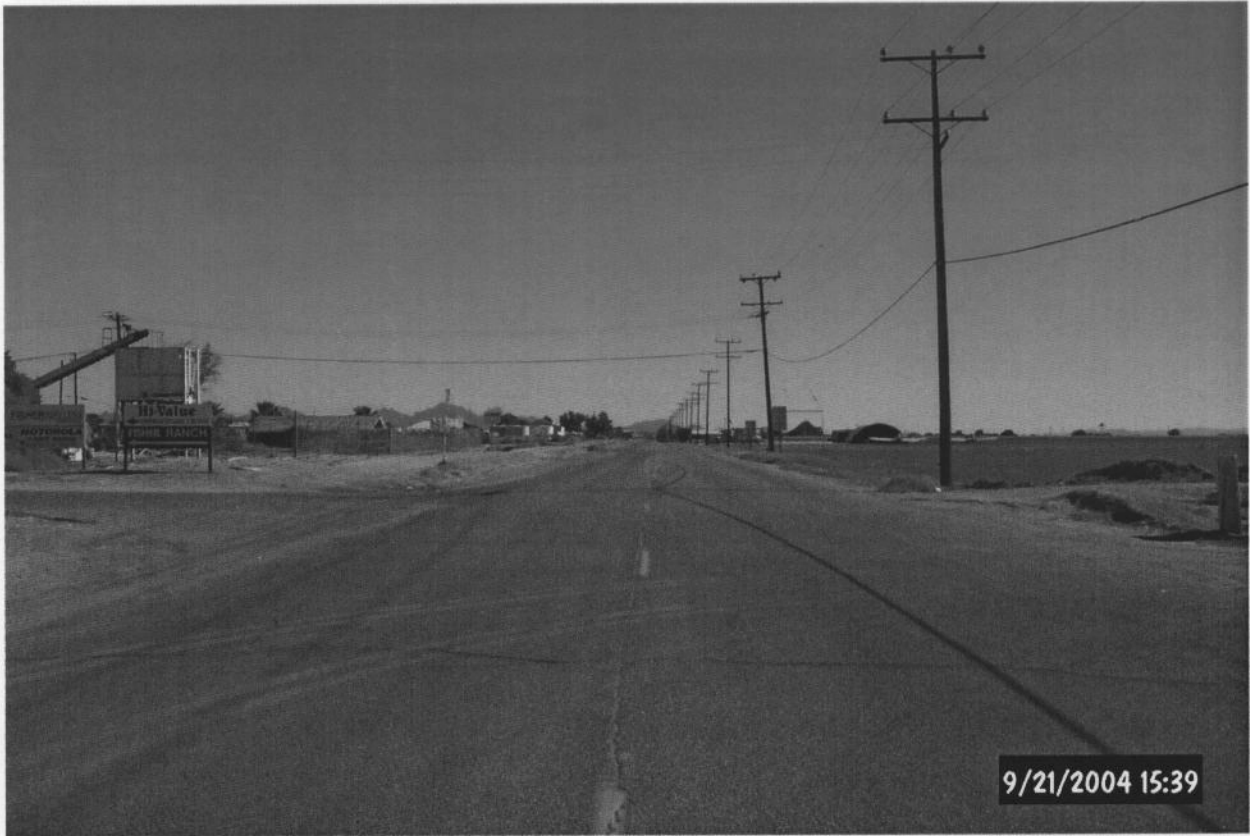

Lovekin Boulevard Southbound Adjacent to Sargent Airport

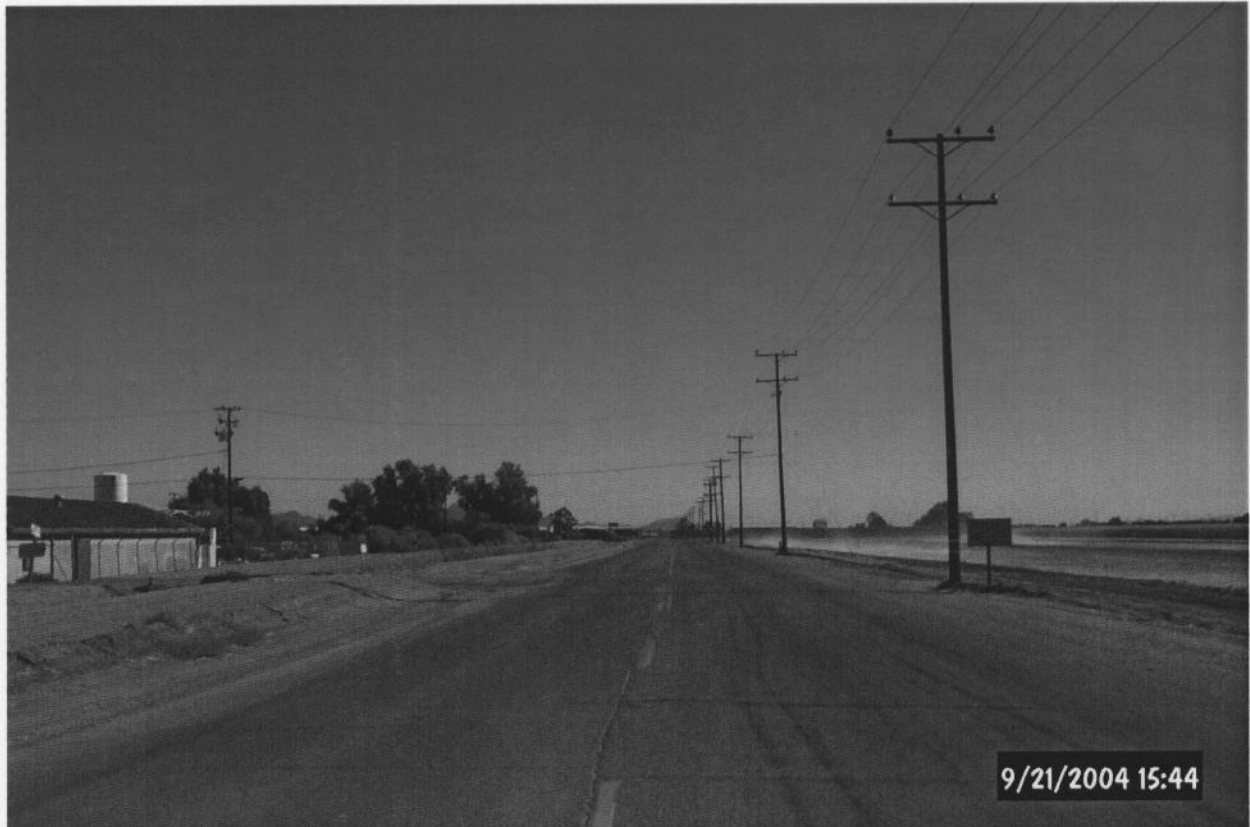

RESOLUTION NO. 2005-111

**RESOLUTION OF THE BOARD OF SUPERVISORS
OF THE COUNTY OF RIVERSIDE
GIVING NOTICE OF ITS INTENTION TO ESTABLISH
UNDERGROUND UTILITY DISTRICT NO. 43**

WHEREAS, Chapter 13.16 of the Riverside County Code establishes the procedure to establish an underground utility district and requires as the initial step the calling and noticing of a public hearing to ascertain whether public necessity, health, safety or welfare requires the removal of poles, overhead wires, and associated overhead structures and the underground installation of wires and facilities for supplying electric, communication, or similar associated service in the proposed underground utility district; and

WHEREAS, it has been recommended that such an underground utility district, hereinafter called "District," be formed in a portion of the County of Riverside, State of California, being a portion of Lovekin Boulevard from the Blythe City Limits to ½ mile south of Seeley Avenue;

NOW THEREFORE, BE IT RESOLVED, FOUND, DETERMINED, AND ORDERED by the Board of Supervisors of the County of Riverside, State of California, in regular session assembled on May 3, 2005 that:

Section 1. Notice is hereby given that a public hearing will be held by the Board of Supervisors on June 7, 2005 at the hour of 9:30 am, in the Meeting Room of the Board, at the County Administrative Center, 4080 Lemon Street, 1st Floor, Riverside, California, to ascertain whether the public necessity, health, safety or welfare requires the removal of poles, overhead wires and facilities for supplying electric, communication, or similar associated service in District No. 43 herein above described.

Section 2. At such hearing all such persons interested shall be given an opportunity to be heard.

Section 3. The Clerk of the Board of Supervisors shall notify all affected property owners as shown on the last equalized assessment roll and utilities concerned of the time and place of such hearing by mailing a copy of this resolution to such property owners and utilities concerned at least ten (15) days prior to the date thereof.

Section 4. The area proposed to be included in the District is shown upon that certain map entitled "In the County of Riverside, State of California, Underground Utility District No. 43, Lovekin Boulevard, Blythe City Limits Southerly To ½ Mile South of Seeley Avenue" dated May 6, 2004, and described in a legal description attached to said map, both of which are on file in the Office of the Clerk of the Board of Supervisors of the County of Riverside.

Section 5. The County Director of Transportation has prepared and filed a report (the "Report") that contains among other information the extent to which affected utilities will participate, the estimated total cost to the County and the affected property owners, and an estimate of the time required to complete such underground installation and removal of overhead facilities.

EXHIBIT "A"
UNDERGROUND UTILITY DISTRICT NUMBER 43

BEING A STRIP OF LAND FOR UNDERGROUND UTILITY PURPOSES 200.00 FEET WIDE LYING WITHIN SECTIONS 5, 6, 7, AND 8 TOWNSHIP 7 SOUTH, RANGE 22 EAST, SAN BERNARDINO BASE MERIDIAN, LYING 100.00 FEET ON EACH SIDE OF THE FOLLOWING DESCRIBED CENTERLINE:

BEGINNING AT THE WEST ONE QUARTER CORNER OF SAID SECTION 8, ALSO BEING A POINT ON THE CENTERLINE OF LOVEKIN BOULEVARD;

THENCE N 00°51'01"W, ALONG THE WEST LINE OF SAID SECTION 8, ALSO BEING THE CENTERLINE OF SAID LOVEKIN BOULEVARD, A DISTANCE OF 2640.96 FEET, TO THE NORTHWEST CORNER OF SAID SECTION 8, ALSO BEING THE CENTERLINE INTERSECTION OF LOVEKIN BOULEVARD AND SEELEY AVENUE;

THENCE N 00°46'12"W, CONTINUING ALONG THE WEST LINE OF SAID SECTION 5, ALSO BEING THE CENTERLINE OF SAID LOVEKIN BOULEVARD, A DISTANCE OF 2642.01 FEET TO THE WEST ONE QUARTER CORNER OF SAID SECTION 5;

THENCE N 00°46'30"W, CONTINUING ALONG SAID WEST LINE OF SECTION 5, ALSO BEING THE CENTERLINE OF SAID LOVEKIN BOULEVARD, A DISTANCE OF 1962.34 FEET TO THE SOUTHWEST CORNER OF THE NORTHWEST QUARTER OF THE NORTHWEST QUARTER OF SAID SECTION OF 5, SAID CORNER BEING THE **TERMINUS** OF SAID 200.00 FOOT WIDE STRIP.

EXCEPTING THEREFROM THAT PORTION LYING WITHIN THE NORTHEAST ONE-QUARTER OF THE NORTHEAST ONE-QUARTER OF SAID SECTION 6.

THE SIDELINES OF SAID STRIP OF LAND SHALL BE LENGTHENED OR SHORTENED SO AS TO TERMINATE ON THE EAST-WEST CENTER SECTION LINES OF SECTIONS 7 AND 8, AND ON THE SOUTHERLY CITY LIMITS LINE OF THE CITY OF BLYTHE AS IT EXISTS TODAY.

CONTAINING: 1,383,651 SQUARE FEET OR 31.76 ACRES, MORE OR LESS.

REFERENCE IS HEREBY MADE TO UNDERGROUND UTILITY DISTRICT MAP NUMBER 933-E, ON FILE IN THE OFFICE OF THE COUNTY SURVEYOR OF RIVERSIDE COUNTY, CALIFORNIA.

APPROVED BY: *M. Teich*
DATE: 5-6-04

