

227B



**SUBMITTAL TO THE FLOOD CONTROL AND WATER CONSERVATION DISTRICT BOARD
COUNTY OF RIVERSIDE, STATE OF CALIFORNIA**

FROM: General Manager-Chief Engineer

SUBMITTAL DATE:
January 10, 2006

SUBJECT: Notice of Completion
Mission Lakes Levee
Project No. 6-0-0075

RECOMMENDED MOTION:

The Board accept the referenced project as constructed; authorize the Chairman to execute the attached Notice of Completion; and direct the Clerk of the Board to record the executed Notice of Completion with the Riverside County Clerk and Recorder's Office within 10 calendar days in accordance with Section 3093 of the Civil Code.

BACKGROUND:

Continued on Page 2.

Departmental Concurrence

mcv

WARREN D. WILLIAMS
General Manager-Chief Engineer

FINANCIAL DATA	Current F.Y. District Cost:	N/A	In Current Year Budget:	N/A
	Current F.Y. County Cost:	N/A	Budget Adjustment:	N/A
	Annual Net District Cost:	N/A	For Fiscal Year:	N/A

SOURCE OF FUNDS: N/A	Positions To Be Deleted Per A-30	<input type="checkbox"/>
	Requires 4/5 Vote	<input type="checkbox"/>

C.E.O. RECOMMENDATION:

APPROVE

County Executive Office Signature

- Policy
- Policy
- Consent
- Consent
- Dep't Recomm.:
- Per Exec. Ofc.:

Prev. Agn. Ref.: 11.3, 03/15/05 | District: 5th | Agenda Number:

ATTACHMENTS FILED
WITH THE CLERK OF THE BOARD

11.1

**FLOOD CONTROL AND WATER CONSERVATION DISTRICT BOARD SUBMITTAL
COUNTY OF RIVERSIDE, STATE OF CALIFORNIA**

SUBJECT: Notice of Completion
Mission Lakes Levee
Project No. 6-0-0075
SUBMITTAL DATE: January 10, 2006
Page 2

BACKGROUND:

The Board approved the original contract with Fine Grade Equipment, Inc. as Agenda Item Number 11.3 on March 15, 2005 in an amount of \$1,888,778.90. The District anticipates a request for additional compensation for cement quantity overages in an amount estimated to be less than \$94,000. The total project construction cost is estimated not to exceed \$1,982,778.90, including all the costs associated with the claims for additional compensation.

Final inspection of the above referenced project was made, and the project was found to be complete according to plans and specifications. A brief project description and location map is attached.

MISSION LAKES LEVEE PROJECT NO. 6-0-0075

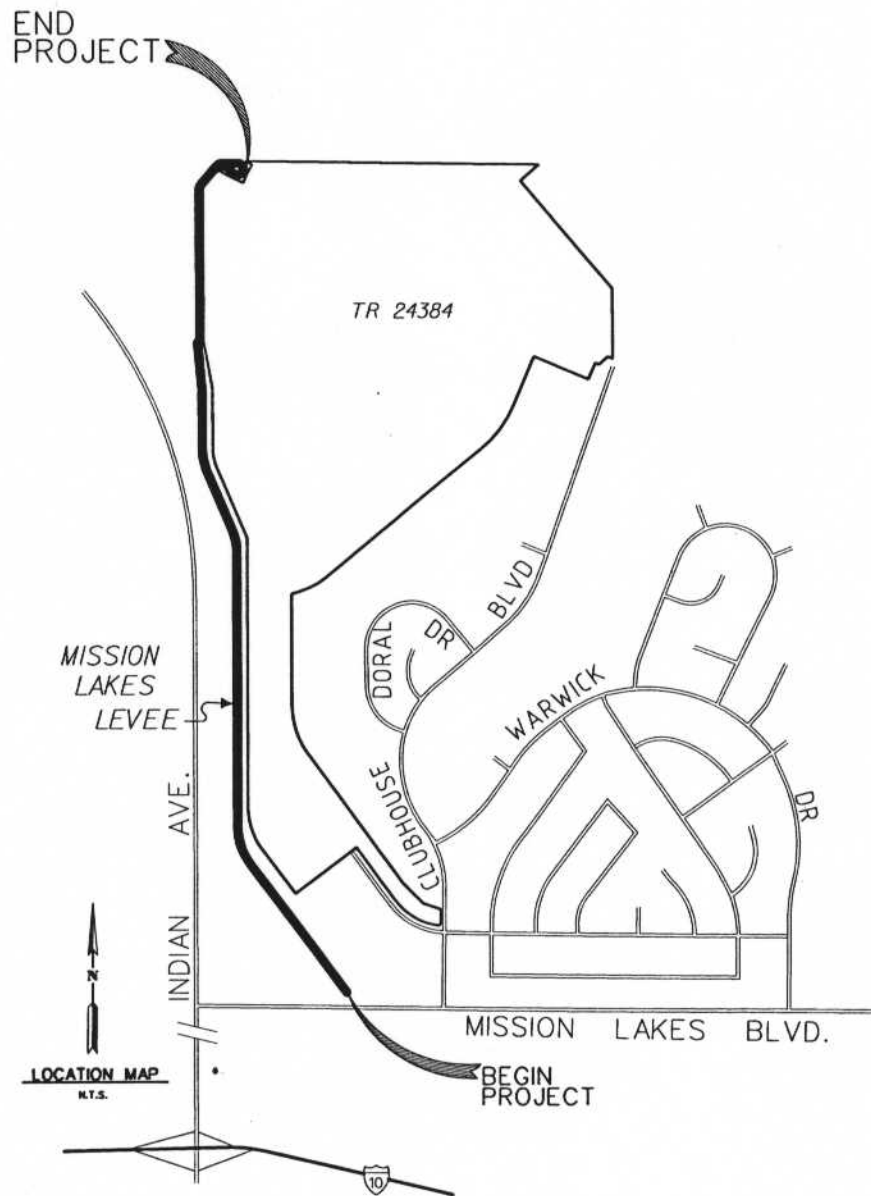

The project is located in unincorporated Riverside County west of the City of Desert Hot Springs and northeast of the intersection of Indian Avenue and Mission Lakes Boulevard. The project consists of the construction of approximately 4,300 lineal feet of new levee 11 feet high and reconstruction of 1,200 lineal feet of existing levee 5 feet high. The new levee portion of the project will be bid with alternative waterside slope facing materials which will consist of either portland cement concrete paving 6 inches thick or soil cement revetment 8 feet wide.