

BACKGROUND: By Minute Order dated October 25, 2005 (agenda item 3.44) the Board authorized the Clerk of the Board to advertise for the resurfacing of various roads in the Sun City area of Riverside County.

The project will provide for the resurfacing of the 54 roads that are listed on page 3 of this submittal, including associated improvements and the installation of 186 access ramps. The improvements will provide pavement replacement on the listed roads, which is necessary due to deteriorating pavement conditions, and will provide ADA required and compliant access ramps at all of the affected intersections. Related improvements include sidewalk replacement at certain locations in order to provide a safe passageway for local residents.

Bids for the project were opened in the office of the Director of Transportation at 2:00 pm, Wednesday, November 23, 2005. Four bids were received. The lowest and best bid was submitted by Silvia Construction, Inc. in the amount of \$3,046,594.20. The bid is \$753,129.20 (32.8%) more than the Engineer's Estimate.

Bids exceeded the Engineer's Estimate due to higher than estimated amounts bid for a number of individual bid items, especially the bid items for asphalt concrete and roadway excavation. The current construction and materials market is extremely volatile, and prices are escalating at an unusually fast and unpredictable rate. In addition to materials price increases, we attribute the high bid prices we are currently receiving to the saturated construction market in the Inland Empire. The demand on the local materials suppliers and contractors is at or may even exceed their capacity. This construction market makes construction cost estimating difficult. Although the low responsive and responsible bid received is higher than was estimated at the time that the project was advertised, the Transportation Department is of the opinion that the total bid price is consistent with current market trends, as evidenced by the four bids received, each of which is from a reputable local construction contractor. The Transportation Department recommends award due to the need for the improvements, and because re-bidding may result in even higher bids.

Community Improvement Designation Funds in the amount of \$100,000 for this project will be authorized under a separate Form 11. The Transportation Department's budget adjustment shown on Attachment "B" represents the Community Improvement Designation Funds and the increase in the 3rd District Developer Agreement Trust Funds.

The contractor is qualified.

The roads to be resurfaced are as follows:

- 1 Albany Dr: Decatur Way to Boston Dr
- 2 Allentown Dr: Provo Ct to Medford Way
- 3 Amhurst Ct: Sun City Blvd to 764' W'ly
- 4 Auckland Ct: St. Marys St to 129' N'ly
- 5 Birkdale Rd: Grosse Point to 698' W'ly
- 6 Boston Dr: Allentown Dr to Albany Dr
- 7 Brandywine Dr: Murrieta Rd to 2476' E'ly
- 8 Camden Way: Amhurst Ct to Chambers Ave
- 9 Cedar Crest Dr: Sun City Blvd to Pebble Beach Dr
- 10 Chambers Ave: Murrieta Rd to Connie Wy
- 11 Charlestown Dr: Allentown Dr to Harrisburg Dr
- 12 Chevy Chase Rd: Ridgemoor Rd to Carmel Rd
- 13 Coombe Hill Dr: West Worcester to West Worcester
- 14 Covington Way: Lancaster Dr to Brandywine Dr
- 15 Crestone Dr: Emory Ct to Grosse Point Dr
- 16 Croham Hurst Ct: Prestwick Rd to N'ly 0.02 mi
- 17 Danbury Dr: Cherry Hills Blvd to Roanoke Rd
- 18 Decatur Way: Provo Ct to Emory Ct
- 19 Del Monte Dr: Annandale Rd to Ridgemoor Rd
- 20 Emory Ct: Crestone Dr to 146' N'ly
- 21 Exmoor Ct: Glen Oaks Dr to E'ly Glen Oaks 0.02 mi
- 22 Fairlane Dr: Covington Way to Grosse Point
- 23 Falsterbor Dr: E Worcester Rd to E Worcester Rd
- 24 Fountainbleu Dr: Falsterbor Dr to E Worcester Rd
- 25 Foxgrove Rd: Waverly Dr to Del Monte Dr
- 26 Germantown Dr: Covington Way to Grosse Point
- 27 Glen Oaks Dr: Foxgrove Rd to Del Monte Dr
- 28 Harrisburg Dr: Charlestown Dr to Medford Way
- 29 Hartwick Rd: Portsmouth Rd to Danbury Rd
- 30 Hermitage Way: Pine Valley Rd to Mc Call Blvd
- 31 Hogan Dr: Par Dr to Olympia Wy
- 32 Inwood Ct: Cedar Crest Dr to 177' S'Ely
- 33 Joliet Way: Harrisburg Dr to Chambers Ave
- 34 Lancaster Dr: Radford Dr to Grosse Point
- 35 Lexington Ct: Lancaster Dr to 215' N'ly
- 36 Manchester Dr: Camden Way to Sun City Blvd
- 37 Medford Way: Allentown Dr to Harrisburg Dr
- 38 Niagara Ct: Lancaster Dr to 211' N'ly
- 39 Par Dr: Thornhill Dr to Olympia Wy
- 40 Pine Valley Rd: St. Marys St to End
- 41 Plum Hollow Dr: West Worcester to Coombe Hill
- 42 Prestwick Rd: Waverly Dr to Annandale Rd
- 43 Provo Ct: Allentown Dr to SW'ly 0.03 mi
- 44 Radford Dr: Sandy Lodge Rd to 1079' N'ly
- 45 Roanoke Rd: Valley Blvd to Cherry Hills Blvd
- 46 Saint Andrews Dr: Thornhill Dr to Olympia Wy
- 47 Saint Marys St: Pine Valley Rd to Grosse Point Dr
- 48 Sandtrap Dr: Medford Way to Harrisburg Dr
- 49 Sandy Lodge Rd: Mc Call Blvd to Murrieta Rd
- 50 Tanglewood Dr: Ridgemoor Rd to Sun City Blvd
- 51 Warwick Rd: Portsmouth Rd to Roanoke Rd
- 52 Waverly Dr: Ridgemoor Rd to S'ly 0.16 mi
- 53 Winthrop Ct: Sandy Lodge Rd to 123' N'ly
- 54 Burlington Dr: Amersfoot Way to E. Worcester Rd

Project No. X0602.

Attachment "A"

Riverside County Transportation Department

Project: **Sun City Resurfacing at Various Locations (Please See Attached)**

Project No.(s): **X0602**

Project Costs and Budget

Activity	Incurred Costs	Projected Costs	Total Costs	Existing Budget	Proposed Budget
Preliminary Survey					
Environmental	75	925	1,000	1,000	
Design	36,628	372	37,000	41,000	37,000
Right-of-way					
Utilities	1,033	(33)	1,000	3,000	1,000
Construction		3,046,594	3,046,594		
Construction Contingency 10.0%		304,659	304,659	2,454,000	3,351,000
Construction Engineering & Inspection 6.4%	9,404	185,578	194,982	195,000	195,000
Construction Survey 1.6%	165	48,581	48,746	49,000	91,000
Totals:	47,305	3,586,676	3,633,981	2,743,000	3,675,000

Project Funding

Code	Name	Existing Budget	Proposed Budget
201	Proposition 111 (Gas Tax)	293,000	457,000
214	Proposition 42 (Sales Tax and Gas Tax)	1,918,000	2,218,000
323	3rd District Developer Agreement Trust Fund	532,000	900,000
900	Miscellaneous (Community Improvement Designation Funds)		100,000
	Totals	2,743,000	3,675,000

Comments

ATTACHMENT "B"

Increase Estimated Revenues:

31680-3130500000-778190

Interfund Development Fees

\$468,000

Increase Appropriations:

31680-3130500000-537280

Interfund Exp-Misc. Project Expense

\$468,000

COUNTY OF RIVERSIDE

SUN CITY AREA RESURFACING PROJECTS

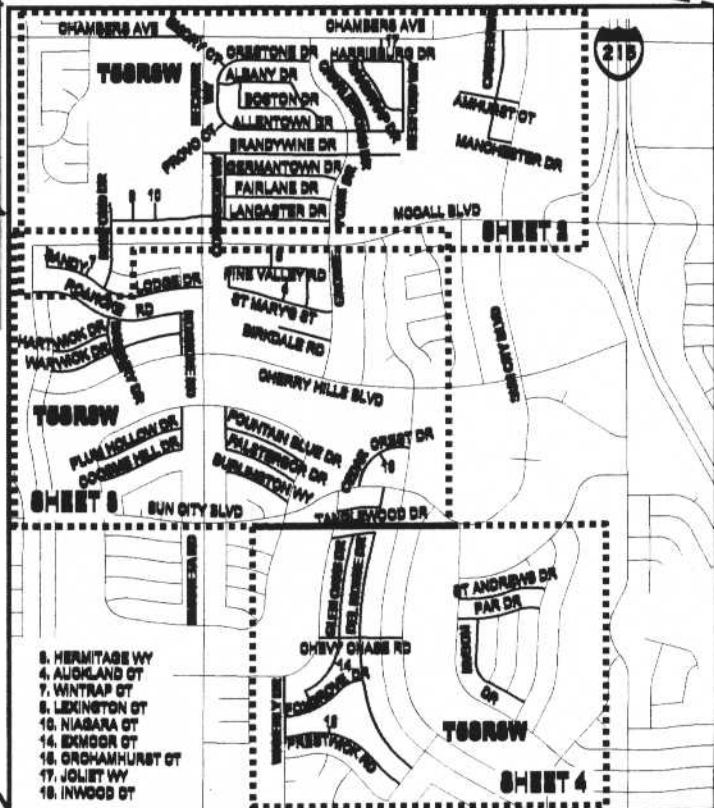
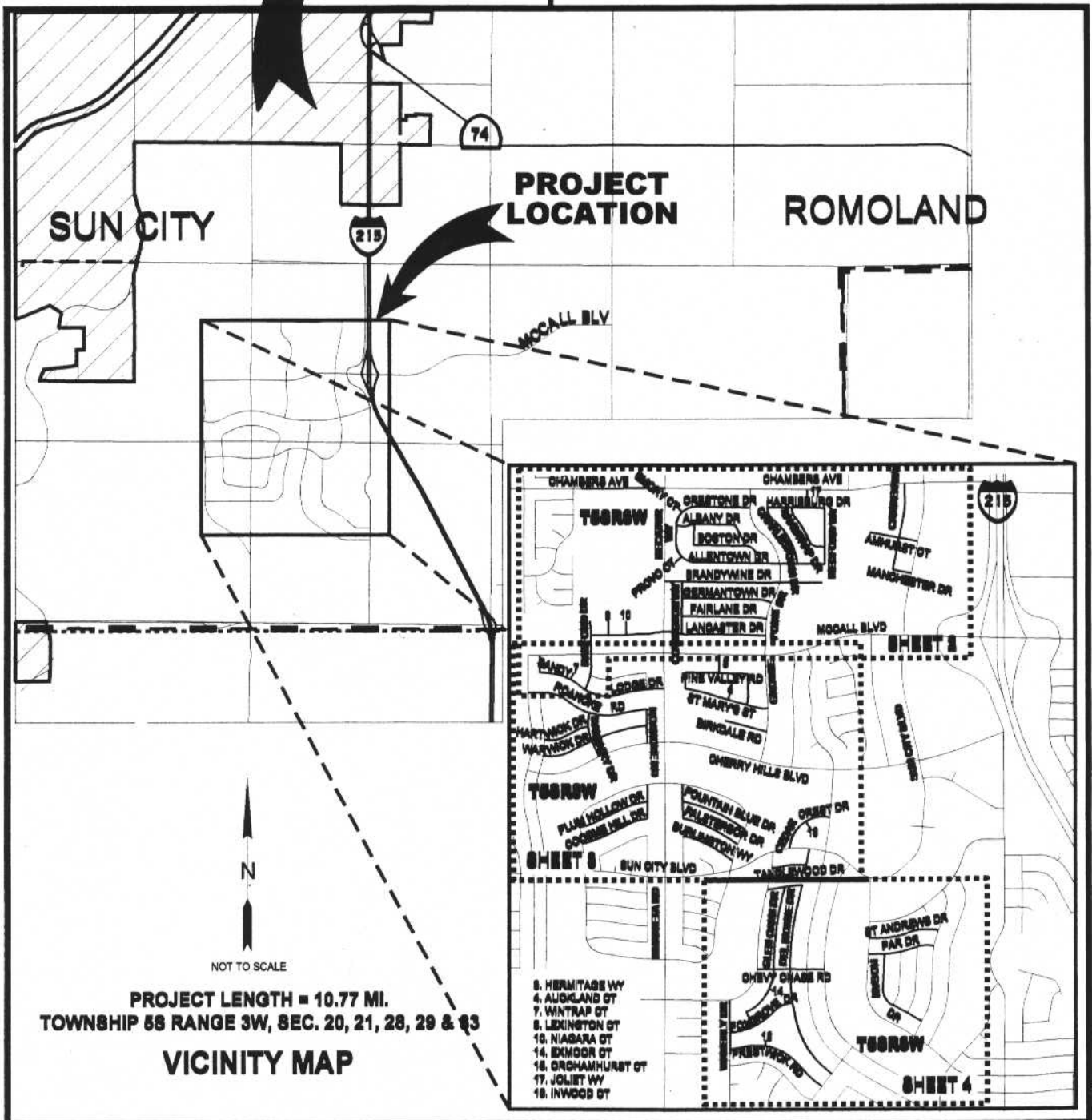
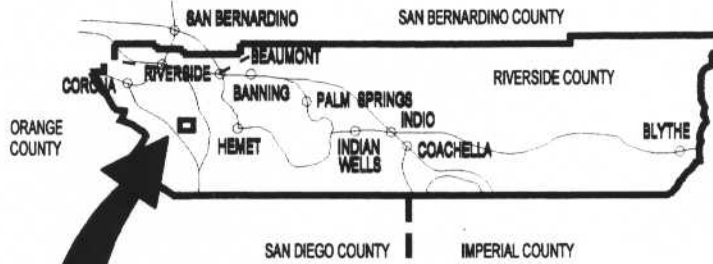

Riverside County Transportation Department Summary of Bids

PROJECT: Sun City Resurfacing

Advertised: October 25, 2005 (Agenda item 3.44)
Bids Open: 2:00 pm Date: November 23, 2005

PROJECT NO. X0602

ITEM NO.		ITEM CODE	CONTRACT ITEM	UNITS	QUANTITY	UNIT PRICE	ENG ESTIMATE	BID	AMOUNT
1	190101	ROADWAY EXCAVATION		CY	18,985	10.00	189,850.00	20.00	379,700.00
2	260201	CLASS 2 AGGREGATE BASE		CY	145	30.00	4,350.00	101.00	14,645.00
3	390103	ASPHALT CONCRETE (TYPE B)		TON	36,905	45.00	1,660,725.00	59.20	2,184,776.00
4	017317	MINOR CONCRETE (CROSS-GUTTER AND SPANDREL)		SQFT	3,495	10.00	34,950.00	10.20	35,649.00
5	840515	THERMOPLASTIC PAVEMENT MARKING		SQFT	1,175	6.00	7,050.00	2.40	2,820.00
6	017304	MINOR CONCRETE (CURB AND GUTTER) (CRS 200)		LF	365	20.00	7,300.00	27.40	10,001.00
7	017305	MINOR CONCRETE (CURB AND GUTTER) (CRS 201)		LF	35	25.00	875.00	52.00	1,820.00
8	013903	PLACE ASPHALT CONCRETE DIKE (CRS 212) (6")		LF	1,297	5.00	6,485.00	7.60	9,857.20
9	017315	MINOR CONCRETE (CURB RAMP) (CRS 403) (CASE B) MODIFIED		EA	186	1,300.00	241,800.00	1,553.00	288,858.00
10	510221	CLASS 3 CONCRETE (SIDEWALK) (CRS 401)		SQFT	3,060	8.00	24,480.00	4.90	14,994.00
11	013905	ASPHALT CONCRETE (DRIVEWAY APPROACH W/ ASPHALT CONCRETE DIKE) (CRS 206)		EA	12	800.00	9,600.00	626.00	7,512.00
12	013902	ASPHALT CONCRETE OVERSIDE DRAIN (CRS 306)		EA	1	1,000.00	1,000.00	525.00	525.00
13	074020	WATER POLLUTION CONTROL		FA	1	15,000.00	15,000.00	15,000.00	15,000.00
14	066102	DUST ABATEMENT		LS	1	15,000.00	15,000.00	9,057.00	9,057.00
15	220101	FINISHING ROADWAY		LS	1	15,000.00	15,000.00	4,640.00	4,640.00
16	170101	DEVELOP WATER SUPPLY		LS	1	15,000.00	15,000.00	2,140.00	2,140.00
17	120100	TRAFFIC CONTROL SYSTEM		LS	1	35,000.00	35,000.00	42,300.00	42,300.00
18	999990	MOBILIZATION		LS	1	10,000.00	10,000.00	22,300.00	22,300.00
TOTALS:							2,293,465.00		3,046,594.20

Riverside County Transportation Department Summary of Bids

PROJECT: Sun City Resurfacing

Advertised: October 25, 2005 (Agenda item 3.44)

Bids Open: 2:00 pm Date: November 23, 2005

PROJECT NO. X0602

ITEM NO.	ITEM CODE	CONTRACT ITEM	UNITS	QUANTITY	Match Corporation San Bernardino, CA 92412		R.J. Noble Company Orange, CA 92856	
					BID	AMOUNT	BID	AMOUNT
1	190101	ROADWAY EXCAVATION	CY	18,985	30.00	569,550.00	30.00	569,550.00
2	260201	CLASS 2 AGGREGATE BASE	CY	145	60.00	8,700.00	44.00	6,380.00
3	390103	ASPHALT CONCRETE (TYPE B)	TON	36,905	56.75	2,094,358.75	54.50	2,011,322.50
4	017317	MINOR CONCRETE (CROSS-GUTTER AND SPANDREL)	SQFT	3,495	10.50	36,697.50	16.05	56,094.75
5	840515	THERMOPLASTIC PAVEMENT MARKING	SQFT	1,175	3.00	3,525.00	2.40	2,820.00
6	017304	MINOR CONCRETE (CURB AND GUTTER) (CRS 200)	LF	365	95.00	34,675.00	54.00	19,710.00
7	017305	MINOR CONCRETE (CURB AND GUTTER) (CRS 201)	LF	35	175.00	6,125.00	54.00	1,890.00
8	013903	PLACE ASPHALT CONCRETE DIKE (CRS 212) (6")	LF	1,297	5.00	6,485.00	5.80	7,522.60
9	017315	MINOR CONCRETE (CURB RAMP) (CRS 403) (CASE B) MODIFIED	EA	186	2,200.00	409,200.00	3,470.00	645,420.00
10	510221	CLASS 3 CONCRETE (SIDEWALK) (CRS 401)	SQFT	3,060	11.50	35,190.00	8.00	24,480.00
11	013905	ASPHALT CONCRETE (DRIVEWAY APPROACH W/ ASPHALT CONCRETE DIKE) (CRS 206)	EA	12	750.00	9,000.00	1,870.00	22,440.00
12	013902	ASPHALT CONCRETE OVERSIDE DRAIN (CRS 306)	EA	1	2,000.00	2,000.00	1,700.00	1,700.00
13	074020	WATER POLLUTION CONTROL	FA	1	15,000.00	15,000.00	15,000.00	15,000.00
14	066102	DUST ABATEMENT	LS	1	7,500.00	7,500.00	62,000.00	62,000.00
15	220101	FINISHING ROADWAY	LS	1	5,000.00	5,000.00	2,650.00	2,650.00
16	170101	DEVELOP WATER SUPPLY	LS	1	5,000.00	5,000.00	14,300.00	14,300.00
17	120100	TRAFFIC CONTROL SYSTEM	LS	1	20,000.00	20,000.00	30,000.00	30,000.00
18	999990	MOBILIZATION	LS	1	176,437.75	176,437.75	82,000.00	82,000.00

TOTALS:

3,444,444.00

3,575,279.85

**Riverside County Transportation Department
Summary of Bids**

PROJECT: Sun City Resurfacing

**Advertised: October 25, 2005 (Agenda item 3.44)
Bids Open: 2:00 pm Date: November 23, 2005**

PROJECT NO. X0602

ITEM NO.		ITEM CODE	CONTRACT ITEM	UNITS	QUANTITY	BID	AMOUNT	BID	AMOUNT
1	190101	ROADWAY EXCAVATION		CY	18,985	26.00	493,610.00		0.00
2	260201	CLASS 2 AGGREGATE BASE		CY	145	110.00	15,950.00		0.00
3	390103	ASPHALT CONCRETE (TYPE B)		TON	36,905	62.00	2,288,110.00		0.00
4	017317	MINOR CONCRETE (CROSS-GUTTER AND SPANDREL)		SQFT	3,495	16.00	55,920.00		0.00
5	840515	THERMOPLASTIC PAVEMENT MARKING		SQFT	1,175	2.50	2,937.50		0.00
6	017304	MINOR CONCRETE (CURB AND GUTTER) (CRS 200)		LF	365	42.00	15,330.00		0.00
7	017305	MINOR CONCRETE (CURB AND GUTTER) (CRS 201)		LF	35	47.00	1,645.00		0.00
8	013903	PLACE ASPHALT CONCRETE DIKE (CRS 212) (6")		LF	1,297	10.00	12,970.00		0.00
9	017315	MINOR CONCRETE (CURB RAMP) (CRS 403) (CASE B) MODIFIED		EA	186	3,100.00	576,600.00		0.00
10	510221	CLASS 3 CONCRETE (SIDEWALK) (CRS 401)		SQFT	3,060	7.00	21,420.00		0.00
11	013905	ASPHALT CONCRETE (DRIVEWAY APPROACH W/ ASPHALT CONCRETE DIKE) (CRS 206)		EA	12	1,400.00	16,800.00		0.00
12	013902	ASPHALT CONCRETE OVERSIDE DRAIN (CRS 306)		EA	1	1,500.00	1,500.00		0.00
13	074020	WATER POLLUTION CONTROL		FA	1	15,000.00	15,000.00		0.00
14	066102	DUST ABATEMENT		LS	1	1,600.00	1,600.00		0.00
15	220101	FINISHING ROADWAY		LS	1	13,000.00	13,000.00		0.00
16	170101	DEVELOP WATER SUPPLY		LS	1	50,000.00	50,000.00		0.00
17	120100	TRAFFIC CONTROL SYSTEM		LS	1	66,000.00	66,000.00		0.00
18	999990	MOBILIZATION		LS	1	41,607.50	41,607.50		0.00
TOTALS:							3,690,000.00		0.00

**ENCUMBRANCE INFORMATION
FOR BOARD OF SUPERVISORS APPROVED CONTRACTS
COUNTY OF RIVERSIDE**

VENDOR NAME AND ADDRESS: Silvia Construction, Inc. 9007 Center Avenue Rancho Cucamonga, CA 91730-5311 (909) 481-8118	DEPT: Transportation DATE: December 12, 2005 BUDGET F.Y.: 2005 / 2006	B-PO NO.: B	BOS APPROVAL DATE: _____ AGENDA NUMBER: _____
--	---	--------------------	--

VENDOR CODE: _____	TRANS CODE: PO	TRANS DEPT: 3130500000	DOCUMENT TOTAL: \$ 3,046,594.20
--------------------	-----------------------	-------------------------------	--

LINE NO.	FUND	DEPT.	ORG.	SUB ORG.	APPR. CODE	OBJECT	ACTIVITY	JOB/PROJECT	LINE AMOUNT
	20000								

NOTE:

Fund 20000 is exempt from encumbering construction contracts per agreement with A-C General Accounting Division. (Contact: Bob Barton Ext. 5-3843)

<input checked="" type="checkbox"/> Regular contract or <input type="checkbox"/> Blanket contract. If blanket: <input type="checkbox"/> Encumber, <input type="checkbox"/> Do not encumber. <input type="checkbox"/> Current year contract, or <input type="checkbox"/> Multi-year contract.	If multi-year contract, encumbrance amount for: First year \$ <u>N/A</u> Second year \$ _____ Third year \$ _____
CONTRACT DESCRIPTION: Sun City Area Roadway Reconstruction Project number X0602	

PREPARED BY: Stan A. Dery DATE: December 12, 2005 APPROVED BY: <i>Stan A. Dery</i> DATE: 12/22/05	A-C ENCUMBRANCE: PHONE: (951) 955-6785 ENCUMBERED BY: _____ PHONE: 5-2002
---	--

Form 11 Attachment

Contract/Lease/Purchase Summary Data

Contract (for Services)

- Approval/Renewal
- Sole Source
- Personal Services
- Independent Contractor
- Other than Low Bid
- Change Order
- Public Works

Lease

- Approval/Renewal
- Multi-Year Lease
- Equipment
- Real Property
- Change Order

Purchase (for Materials)

- Sole Source
- Other than Low Bid
- Change Order

Selection Committee Member Names (RFP's Only)

User Department:	Transportation Department
-------------------------	---------------------------

N/A

Vendor/Lessor Name:	Silvia Construction, Inc.
----------------------------	---------------------------

Minority Status:

M W DV None

Vendor/Lessor Location:	Rancho Cucamonga, Ca.
--------------------------------	-----------------------

Local Preference Applied: Yes No N/A

Local Preference Award Cost \$
(5% maximum preference)

Local Preference FYTD: Cost \$

of Orders

Applicable Board Policy #

Comments:

RFQ/RFP Process:

Date Mailed:
Response Date:
of Responses:
of Qualified Responses:

Bidding Process:

Bid Range: \$ 3,046,594.20 To: \$3,690,000.00
Local Bid Range: N/A
Responsive and
Responsible Bid Range: \$ 3,046,594.20 To: \$3,690,000.00

Contract/Lease Renewals Only

Existing Agreement Items

Proposed Agreement Items

1. Rates
2. Terms
3. Conditions
4. Legal Issues
5. Accountability
6. Utilities

(continue on blank sheet if necessary)

NOTE: COMPETITIVELY BID PUBLIC WORKS CONTRACT