

SUBMITTAL TO THE BOARD OF SUPERVISORS
COUNTY OF RIVERSIDE, STATE OF CALIFORNIA

806 B



FROM: TLMA – Transportation Dept.

SUBMITTAL DATE: March 6, 2006

SUBJECT: Accepting a portion of Byers Road for public road and utility purposes, in the Romoland area, Third Supervisorial District.

RECOMMENDED MOTION: Adopt Resolution No. 2006-035 accepting the offers of dedication for a portion of Byers Road for public road and utility purposes, but not into the County Maintained Road System.

BACKGROUND: The acceptance of a portion of Byers Road is necessary for and in conjunction with the construction of offsite storm drain improvements required for Tract Map 25316.

Departmental Concurrence

REVIEWED BY EXECUTIVE OFFICE

James J. [Signature]
DATE 3/1/06

FORM APPROVED
COUNTY COUNSEL

FEB 03 2006

BY *Arden V. [Signature]*

AM

Attachments: Resolution No. 2006-035
Exhibit "A"

George A. Johnson
George A. Johnson
Director of Transportation

Dep't Recomm.: Consent Policy
Per Exec. Ofc.: Consent Policy

Prev. Agn. Ref.:

District: 3

Agenda Number:

2.14

2
3 **RESOLUTION NO 2006-035**

4 ACCEPTING A PORTION OF BYERS ROAD, IN THE ROMOLAND AREA FOR PUBLIC
5 USE.

6 (Third Supervisorial District)

7
8 **WHEREAS**, the hereinafter described portion of Byers Road, is offered for
9 dedication for public road and utility purposes by Tract Map and Parcel Maps hereafter-
10 referred to, which offers of dedication have not been previously accepted by the County of
11 Riverside, now, therefore;

12
13 **BE IT RESOLVED, DETERMINED AND ORDERED** by the Board of Supervisors
14 of the County of Riverside, State of California, in regular session assembled on
15 March 14, 2006, that this Board accepts the above-mentioned road and
16 recognizes that said road is a public road open for use by the general public;

17
18 **BE IT FURTHER RESOLVED, DETERMINED AND ORDERED**, that this
19 acceptance is for the purpose of vesting title in the County of Riverside on behalf of the
20 public for public roads and utility uses, and is not an acceptance of the road into the
21 County Maintained Road System pursuant to Section 941 of the Streets and Highways
22 Code and that said road will not become part of the County Maintained Road System
23 unless subsequently accepted into said Maintained Road System by a resolution adopted
24 by this Board;

1 **RESOLUTION No. 2006-035**

2
3 Said road is in the County of Riverside, State of California, and is described as
4 follows:

5
6 **BYERS ROAD** (See Exhibit "A")

7 Those portions of Byers Road (60.00 feet wide full-with), dedicated as lot "H" as
8 shown on Romola Farms No. 9 recorded in Map Book 14 at page 91, lot "E" (44.00 feet
9 wide half-with) as shown on Parcel Map No. 12984 recorded in Parcel Map Book 87 page
10 50 and lot "A" (44.00 feet wide half-with) as shown on Parcel Map No. 15080 recorded in
11 Parcel Map Book 106 pages 2 and 3, Official Records of Riverside County, California.

12
13 **BE IT FURTHER RESOLVED, DETERMINED AND ORDERED** that the Clerk of
14 the Board shall cause a certified copy of this resolution to be recorded in the Office of the
15 Recorder of Riverside County, California.

16
17
18
19
20
21
22
23
24 AM

25 W.O.# SUR05073

FORM APPROVED
COUNTY COUNSEL

FEB 03 2006

BY Gordon V. Ubo

Exhibit "A"

Section 17, T5S R3W

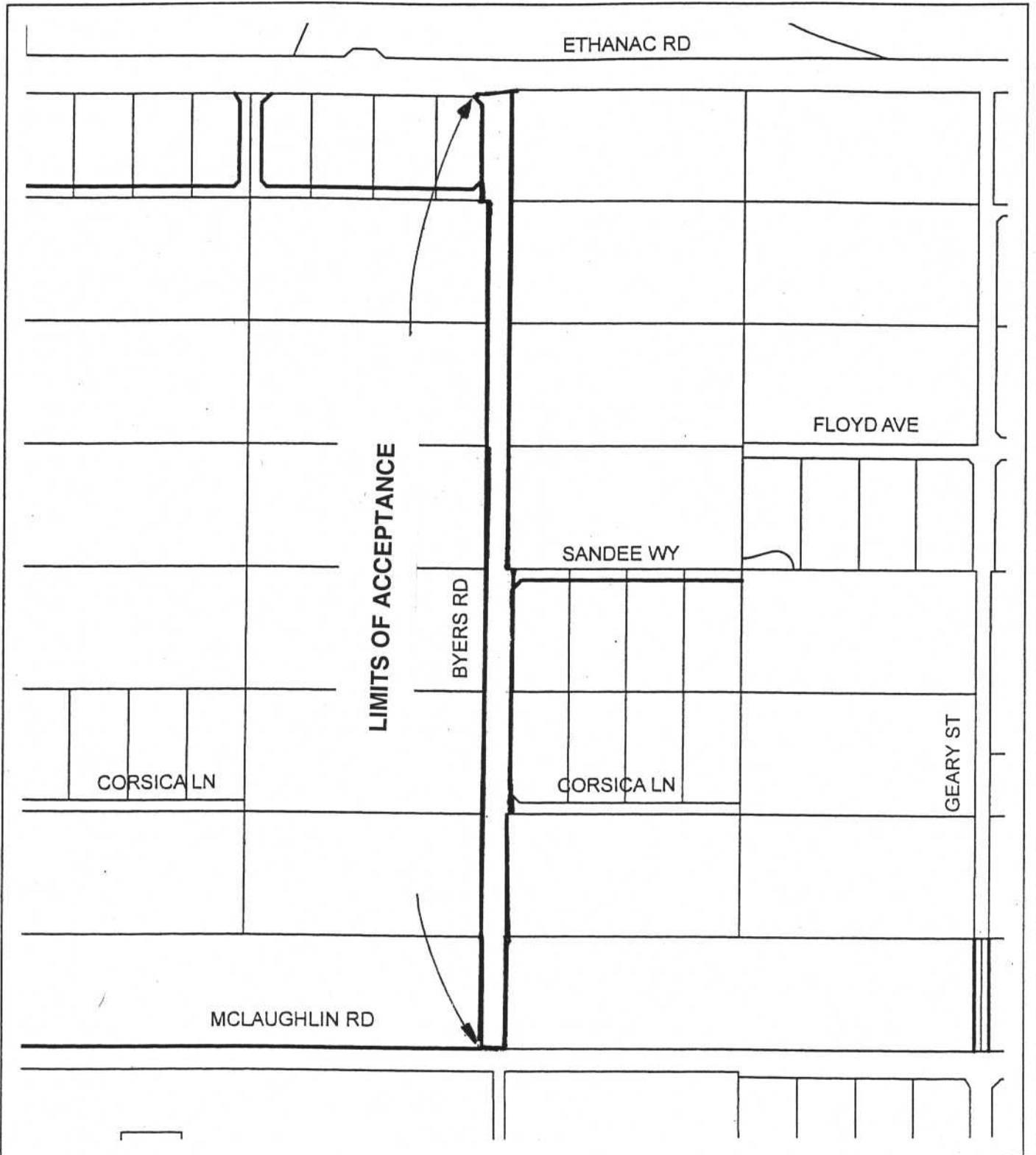

January 10, 2005

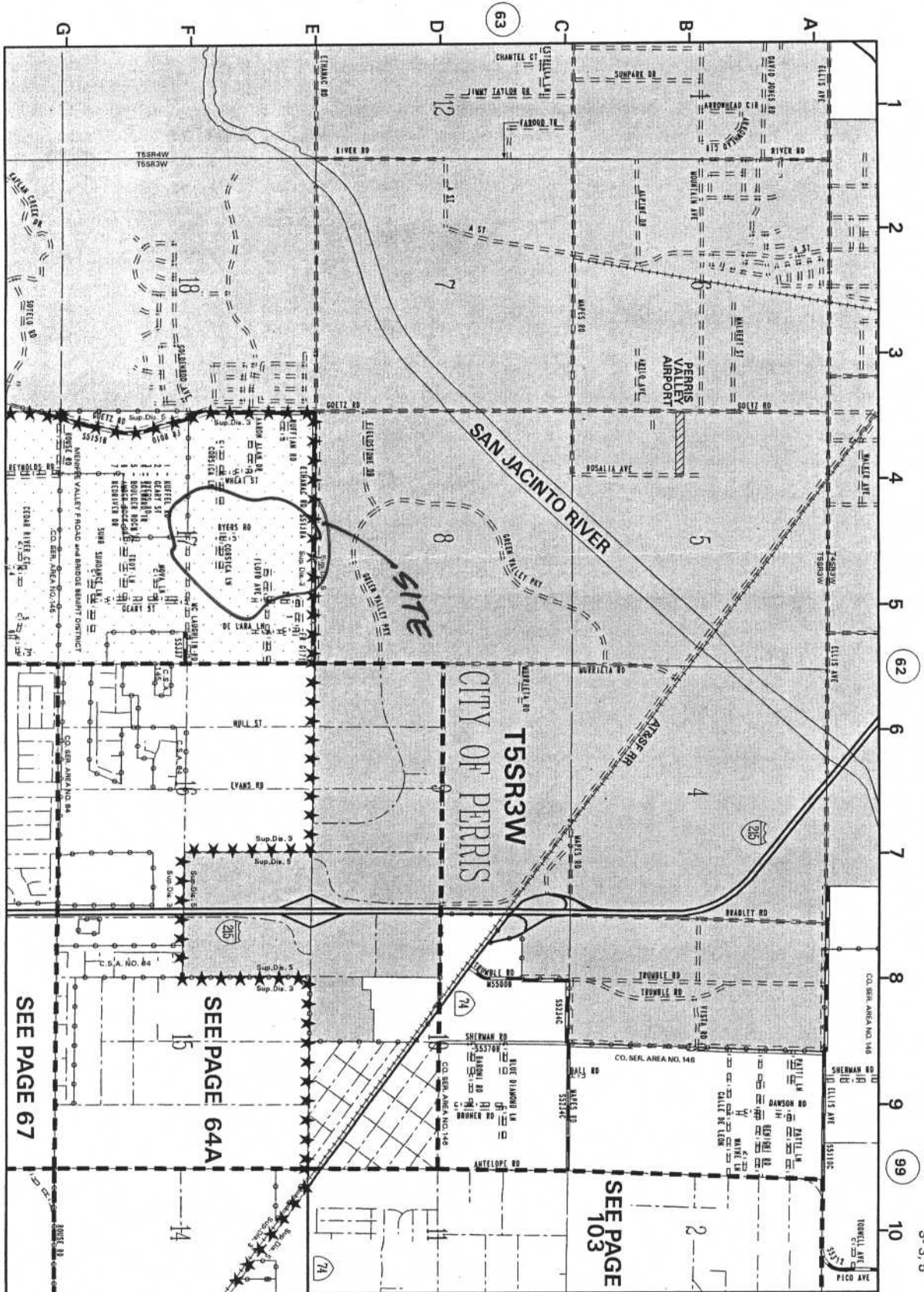

66

67

64

64