

**SUBMITTAL TO THE BOARD OF SUPERVISORS  
COUNTY OF RIVERSIDE, STATE OF CALIFORNIA**

118A



**FROM:** TLMA - Transportation Dept.

**SUBMITTAL DATE:**  
March 20, 2006

**SUBJECT:** Storm Damage Repairs, Reconstruction of a portion of Bridge Street, Southwest of Gilman Springs Road, Lakeview / Nuevo area

**RECOMMENDED MOTION:** That the Board of Supervisors approve the plans and specifications for the reconstruction of a portion of Bridge Street, Southwest of Gilman Springs Road, in the Lakeview / Nuevo area of Riverside County. Authorize the Clerk to advertise for bids to be received in the office of the Director of Transportation up to the hour of 2:00 pm, Wednesday, April 19, 2006, at which time bids will be opened.

**BACKGROUND:** Bridge Street has been closed since January 9, 2005 due to extensive storm damage that the roadway incurred during the 2004 / 2005 storm season. The Transportation Department's objective is to repair and re-open Bridge Street as soon as possible. However, the nature and scope of the necessary repair work required the preparation of engineered plans and specifications, and extensive time was required to navigate through the Federal Emergency Management Agency (FEMA) funding eligibility procedures.

George A. Johnson  
Director of Transportation

GAJ:sd

(Continued On Attached Page)

<b>FINANCIAL DATA</b>	Current F.Y. Total Cost:	\$ 800,000	In Current Year Budget:	Yes
	Current F.Y. Net County Cost:	\$ 0	Budget Adjustment:	No
	Annual Net County Cost:	\$ 0	For Fiscal Year:	2005/2006
<b>SOURCE OF FUNDS:</b> FEMA Reimbursable				Positions To Be Deleted Per A-30 <input type="checkbox"/>
				Requires 4/5 Vote <input type="checkbox"/>

**C.E.O. RECOMMENDATION: APPROVE**

**County Executive Office Signature**

Policy  
 Policy

Consent  
 Consent

Dep't Recomm.:  
 Per Exec. Ofc.:

Prev. Agn. Ref.

District: 5

Agenda Number:

**3 . 19**

FORM APPROVED COUNTY COUNSEL

MAR 17 2006

Departmental Concurrence BY *H. Blaker*

The Honorable Board of Supervisors

RE: Storm Damage Repairs, Reconstruction of a portion of Bridge Street, Southwest of Gilman Springs Road, Lakeview / Nuevo area

March 20, 2006

Page 2 of 3

Bridge Street serves as an important connector road between Ramona Expressway and Gilman Springs Road, and it is the Department's objective to have the repairs constructed and the road open to traffic prior to the 2006 / 2007 storm season. To accomplish this objective, the contractor selection process should begin at this time.

The Transportation Department has prepared three alternate designs for the improvements, and the bid documents include three alternate bid schedules. The preferred alternate is to pave Bridge Street within the floodplain with Portland Cement Concrete. Bids on the three alternate construction methods will enable the most informed decision to be made on the basis of benefit and cost.

Construction cost for this project is estimated at \$800,000 for the preferred alternate. The total project cost is estimated at \$1,100,000.

The Transportation Department is currently seeking reimbursement from FEMA for the major portion of the project costs. However, uncertainties remain at this time regarding the time-frame and availability of FEMA reimbursements. Under a separate submittal to the Board, the Transportation Department is advising the Board of the cash flow impacts to the Department of this and other emergency restoration projects.

By this submittal, the Transportation Department requests authorization to advertise for public bids in advance of final determination of funding for the project. After receipt of bids, the Department will prepare and submit a project budget analysis and recommendations regarding the construction contract.

The submitted plans and specifications have been approved as to form by County Counsel. Environmental clearance is complete.

Project No. 4505150103.

**COUNTY OF RIVERSIDE**

**BRIDGE STREET**

**RECONSTRUCTION OF STORM DAMAGED ROAD SEGMENT**

FROM 134' SW OF BETTINGER AVENUE  
TO 445' NW OF CENTRAL AVENUE

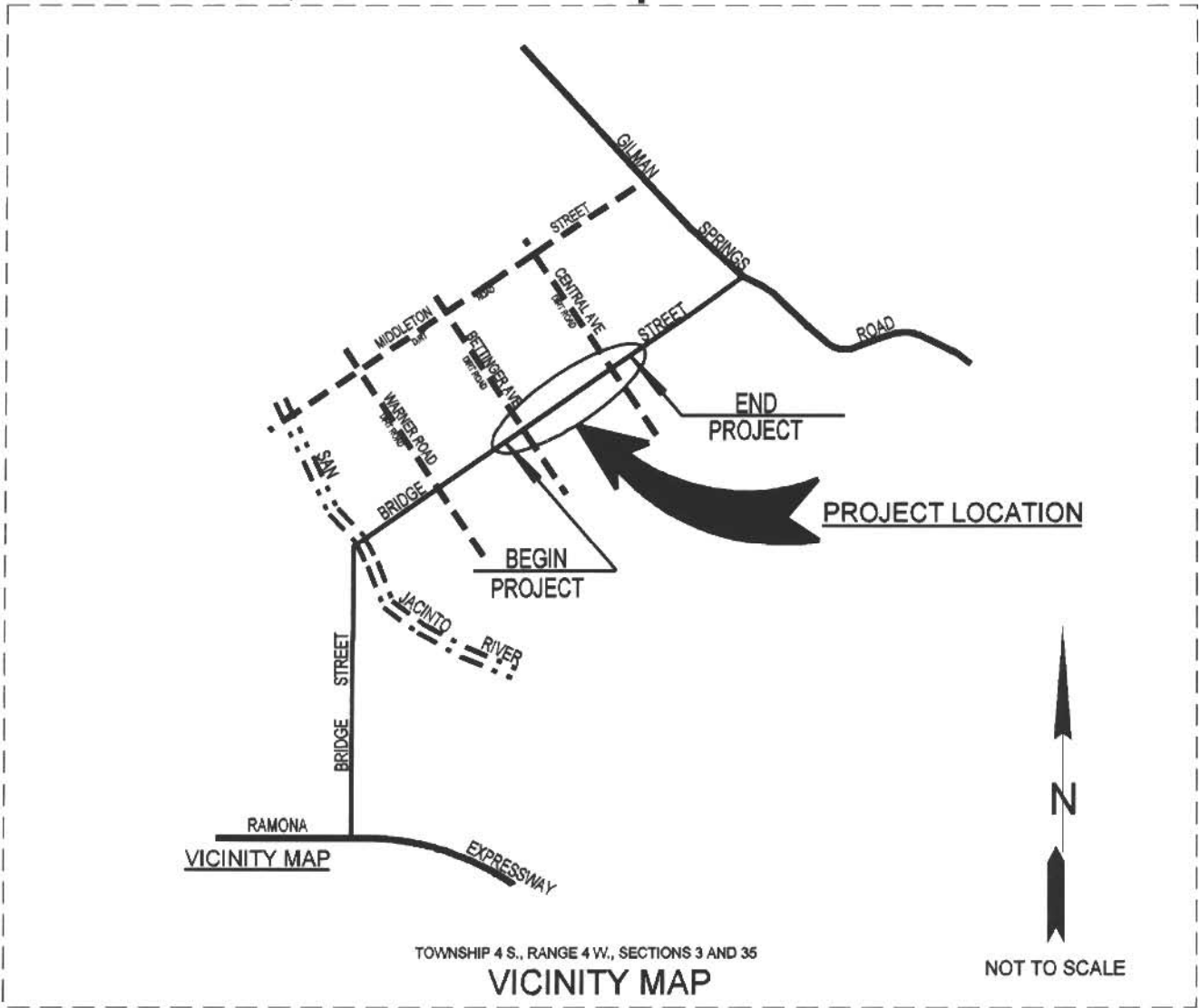
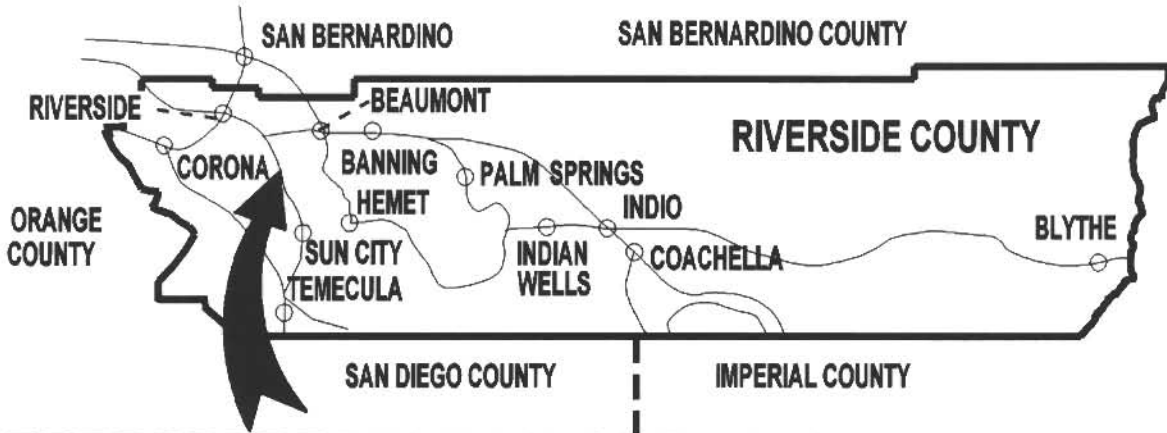

TOWNSHIP 4 S., RANGE 4 W., SECTIONS 3 AND 35  
**VICINITY MAP**