

**SUBMITTAL TO THE BOARD OF SUPERVISORS  
COUNTY OF RIVERSIDE, STATE OF CALIFORNIA**

448



**FROM:** Waste Management Department

**SUBMITTAL DATE:**  
June 19, 2006

**SUBJECT:** Solid Waste Facility Permit Revision for Robert A. Nelson Transfer Station/Material Recovery Facility

**RECOMMENDED MOTION:**

1. **Approval** of the Solid Waste Facility Permit Revision for the Robert A. Nelson Transfer Station/Materials Recovery Facility.
2. **Adoption** of a Mitigated Negative Declaration for Environmental Assessment No. 40362, based upon the findings in the Initial Study and the conclusion that the proposed revision to the Robert A. Nelson Transfer Station/Material Recovery Facility Solid Waste Facility Permit will not have a significant effect on the environment with the implementation of proposed mitigation measures incorporated into the project.
3. **Adoption** of the Mitigation Monitoring Program for EA No. 40362.
4. **Adoption** of a DeMinimis Impact Finding that the proposed project will not have a significant effect on biological resources.

**BACKGROUND:** The project is a proposal to revise the Solid Waste Facility Permit (SWFP) of the Robert A. Nelson Transfer Station/Material Recovery Facility (RAN TS/MRF), which is located at 1830 Agua Mansa Road within the Agua Mansa Industrial Park, west of the jurisdictional limits of the City of Riverside, in the unincorporated area of Jurupa in northwestern Riverside County. The RAN TS/MRF is an existing, municipal solid waste transfer station and material recovery facility that has been in operation since December 1997 and is operating under SWFP No. 33-AA-0258, issued by the Local Enforcement Agency (LEA) of the Riverside County Environmental Health Department on November 25, 1997. The RAN TS/MRF is operated by Burrtec Waste Industries, Inc. (Burrtec) through a lease

(Continued)

Hans W. Kernkamp, General Manager-Chief Engineer

<b>FINANCIAL DATA</b>	Current F.Y. Total Cost:	\$ 0	In Current Year Budget:	N/A
	Current F.Y. Net County Cost:	\$ 0	Budget Adjustment:	N/A
	Annual Net County Cost:	\$ 0	For Fiscal Year:	N/A

<b>SOURCE OF FUNDS:</b> N/A	<b>Positions To Be Deleted Per A-30</b>	<input type="checkbox"/>
	<b>Requires 4/5 Vote</b>	<input type="checkbox"/>

**C.E.O. RECOMMENDATION:**

**APPROVE**

**County Executive Office Signature**

- Dep't Recomm.:  Consent
- Per Exec. Ofc.:  Consent
- Policy  Policy
- Policy  Policy

RECEIVED RIVERSIDE COUNTY

**Prev. Agn. Ref.:** | **District:** 2 | **Agenda Number:** 12.3

**RAN TS/MRF Solid Waste Facility Permit Revision**

**Form 11 Submittal Date: June 19, 2006**

**Board Hearing Date: June 27, 2006**

**Page 2 of 4**

agreement with the Riverside County Waste Management Department (RCWMD). The area leased by Burrtec has grown from 12.2 acres in 1997 to the current lease area of approximately 19.03 acres. Of the remaining 7.4 acres that comprise the two underlying parcels that RCWMD owns, 1.6 acres have been developed as a LNG clean fuel facility and approximately 5.8 acres remain vacant along the easterly portion of the leased property. Burrtec constructed the existing facility and appurtenant structures, which include the following related components:

- A pre-engineered metal building, comprising 1) a 56,698-square foot waste transfer facility, with 45,000 square feet of tipping floor, four (4) access doors for collection trucks, and two (2) below-grade transfer truck load-out ports, 2) a 50,609-square foot MRF facility, with 9,500 square feet of tipping floor, two (2) access doors for trucks delivering commingled and source-separated recyclable loads from residential and commercial recycling programs, and a six-bay loading dock for sorted recyclables, and 3) a 5,091-square foot office area
- Green and woody waste processing area (southeast of TS/MRF building)
- Buy-back/drop-off recycling center (located within the MRF facility)
- A 700-square foot household hazardous waste (HHW) storage area (northwest of TS)
- Two (2) entrances and two (2) scalehouses, one on each side of the TS/MRF building
- A scale house computer system operating four (4) 70-foot in-floor scales
- Employee and public parking stalls along the northwesterly side of the TS/MRF building, with on-site parking for transfer vehicles along the more easterly side of the TS/MRF building
- Transfer truck tarping facility along easterly portion of TS/MRF
- Maintenance facility
- Fuel facilities for fueling equipment and vehicles (the adjacent LNG clean fuel station is not a part of the SWFP)
- Incidental storage areas for equipment, baled recyclables, and containers

The permitted traffic volume for the RAN TS/MRF is 1,582 vehicles per day. The proposed project to revise the SWFP does not include increasing this daily vehicle limit. In addition, the proposed project to revise the SWFP does not include any building of new or expanded structures.

**PROJECT DESCRIPTION:** The proposed project to revise the SWFP for the RAN TS/MRF will result in the following revisions to the permit:

- Change in the hours of operation as follows:

From

Offices	Monday through Friday	8:00 a.m. to 5:00 p.m.
Scalehouse	Monday through Sunday	7:00 a.m. to 6:00 p.m.
Transfer Station:		
Receipt of Waste	Monday through Sunday	7:00 a.m. to 6:00 p.m.
Loading	Monday through Sunday	24 hours

To

Scalehouse (Inbound Receipt of Waste)		
Monday through Sunday	5:00 a.m. to 8:00 p.m.	
Outbound Residuals and Recyclables		
Monday through Sunday	4:00 a.m. to Midnight	
Internal Operations (Office, MRF, Loading, Facility/Site Maintenance)		
Monday through Sunday	24 hours	
Green and Woody Waste Processing		
Monday through Sunday	7:00 a.m. to 6:00 p.m.	

**RAN Transfer Station Solid Waste Facility Permit Revision**

**Form 11 Submittal Date: June 19, 2006**

**Board Hearing Date: June 27, 2006**

**Page 3 of 4**

- Change in permitted tons per operating day from a maximum of 2,700 tpd (2,100 tpd for non-hazardous waste, 600 tpd for separated or co-mingled recyclables) to a maximum of 4,000 tpd for all waste material types received onsite (municipal solid waste, green and woody waste, recyclables, construction/demolition (C&D) debris, etc.).
- Change in the permitted site acreage from 12.5 acres to approximately 22.03 acres (the existing lease area of 19.03 acres, plus another 3 acres of the remaining 5.82 vacant acres owned by RCWMD, subject to a lease amendment).
- Increase of approximately 75 employees for a total of 245.
- Inclusion of the existing green and woody waste processing operations (also called organics processing facility), eliminating the need for separate Enforcement Agency Notification.

**ENVIRONMENTAL ANALYSIS:** Environmental Assessment (EA) No. 40362 was prepared by the RCWMD to evaluate potential impacts associated with the proposed revisions to the SWFP for the RAN TS/MRF, in accordance with the California Environmental Quality Act (CEQA) Guidelines (Section 15000 *et seq.*) and the Rules for Riverside County Implementing the California Environmental Quality Act. Based on the information contained in the EA, potential impacts may occur in the following areas:

- Seismicity/Soil/Slopes
- Water
- Transportation/Circulation
- Air Quality
- Public Health and Safety
- Noise

All identified potential impacts can be avoided or fully mitigated to a level of insignificance with implementation of the mitigation measures identified in the EA, or as modified herein. A Mitigation Monitoring Program (MMP), which is included herein for Board adoption, has been prepared to incorporate these mitigation measures. Likewise, a DeMinimis Impact Finding is also included for the Board to adopt, documenting findings that the proposed project will not result in impacts to biological resources. Consequently, pursuant to *CEQA Guidelines* Section 15063, a Mitigated Negative Declaration has been prepared for Board adoption that documents the finding that the project will not result in any significant impacts.

In accordance with CEQA, a Notice of Intent to Adopt a Mitigated Negative Declaration and EA No. 40362 were posted at the State Clearinghouse and with the County Clerk and transmitted to responsible agencies and interested parties for comment for a period of time that by regulation could not be less than 30 days. A public notice advertising the Notice of Intent and EA were published in the Press-Enterprise. All documents were also posted on the Department's internet website ([www.rivcowm.org](http://www.rivcowm.org)). Lastly, copies of the Mitigated Declaration and EA were made available to the public at the Riverside County Waste Management Department, the Western Riverside County Association of Governments, City of Riverside Main Library, Rubidoux Branch Library, Norco Branch Library, Highgrove Branch Library, and the Arlington Branch Library.

During the comment period of the EA, which officially began on March 29, 2006 and ended on May 1, 2006, and as of the writing of this Form 11, the Department received six (6) letters of comment from: 1) California Regional Water Quality Control Board, Santa Ana Region (SARWQCB), 2) California Department of Transportation (CALTRANS), District 8, 3) California Integrated Waste Management Board (CIWMB), 4) South Coast Air Quality Management

District (SCAQMD), 5) Riverside County Department of Environmental Health (LEA), and 6) Riverside County Flood Control and Water Conservation District. Although not required by CEQA, responses to SARWQCB, CALTRANS, CIWMB, and SCAQMD comments have been prepared and are attached for review by the Board of Supervisors in its consideration of approval of the project.

**CONSISTENCY WITH THE GENERAL PLAN, ZONING, AND OTHER APPLICABLE ENVIRONMENTAL PLANS OR POLICES:** According to the *Riverside County General Plan* (adopted by the Riverside County Board of Supervisors on October 7, 2003), the project site is designated as "PF" (Public Facilities) on the Jurupa Area Plan – Land Use Map (Figure 3). The operation of a transfer and recycling facility, which offers essential solid waste services to the unincorporated communities and cities in the northwestern portion of Riverside County, is consistent with this land use designation and the *General Plan*.

The RAN TS/MRF is an established land use in the Agua Mansa Industrial Park. The facility and its operations are compatible with surrounding land uses, which include: to the north, a LNG clean fuel facility, cement plant and quarry, and a soil amendment producer; to the south, a recreational vehicle manufacturing plant; to the east, vacant industrial property, with miscellaneous industrial and manufacturing facilities, including an indoor wood grinding facility; and, to the west, vacant industrial property.

The project site and the surrounding area are zoned M-H (Heavy Manufacturing). Per Riverside County Land Use and Zoning Ordinance No. 348, the M-H classification identifies "Disposal Service Operations" as being a conditionally permitted use. However, because the RAN TS/MRF is deemed a public project, the proposed project is not subject to the zoning requirements per Section 18.2a.b.(1) of Ordinance No. 348, which states, in part, that "no federal, state, county, or city government project shall be subject to the provisions of this ordinance."

The revision to the SWFP for the RAN TS/MRF is consistent with the goals and policies of the Countywide Integrated Waste Management Plan (CIWMP). The facility is identified and described in the Riverside County Non-Disposal Facility Element (NDFE), an element of the CIWMP. Unless otherwise required, the County's NDFE will be updated to reflect the proposed SWFP revisions through the Annual Report process to the CIWMB. The RAN TS/MRF facilitates recycling and solid waste diversion from the landfills through its materials recovery operations and provides opportunities for recycling to local residents by offering buy-back/drop-off of recyclable commodities. Increasing the daily capacity of the facility to accommodate growth and increasing acreage to allow for expanded organics processing only increase the recycling capability of this facility and provide further assistance to local jurisdictions in meeting mandated diversion goals. Further, the RAN Transfer Station provides a convenient, environmentally acceptable, and cost-effective facility to meet the increasing demand for solid waste services in northwestern Riverside County, significantly reducing the number of vehicle miles that would be traveled if waste went directly to a landfill, which in turn significantly reduces associated air quality impacts.

Lastly, the project is not located within any conservation area identified in the Western Riverside County Multiple Habitat Conservation Plan. In addition, the project is an established land use and does not include any building of new or expanded structures and will not result in any impacts to biological resources.

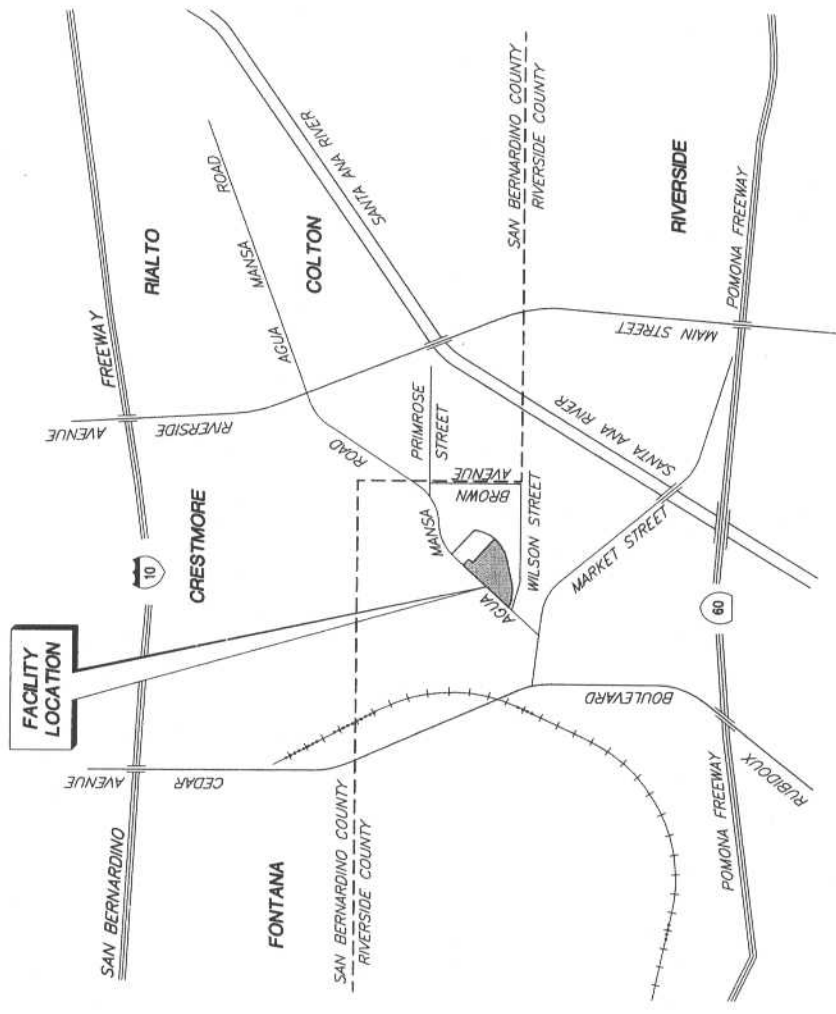

NO.	BY	DATE	REVISION

DATE: \_\_\_\_\_ TIME: 3:30 P.M.  
 SOCIAL: \_\_\_\_\_  
 DRAWING: \_\_\_\_\_  
 CHECKED: \_\_\_\_\_  
 PLOTTED: \_\_\_\_\_  
 SCALE: \_\_\_\_\_  
 CAUTION: The engineer's professional seal and signature are required for all plans for construction changes to or reuse of these plans. All changes to the plans must be in writing and must be approved by the engineer of these plans.

**NOLTE**  
 BEYOND ENGINEERING  
 881 EAST UNION STREET, SUITE 10  
 WESTLAND, MI 48090 TEL: 313.279.7418  
 CORONA, CA 92623  
 WWW.NOLTE.COM

EXHIBIT #1  
 SITE LOCATION MAP

ROBERT A. NELSON  
 TRANSFER STATION / MRF

PREPARED FOR: BURTEC WASTE INDUSTRIES

DATE SUBMITTED: 11/27/04

PROJECT NO: B007001

DATE	11/27/04
TIME	3:30 P.M.
SOCIAL	
DRAWING	
CHECKED	
PLOTTED	
SCALE	



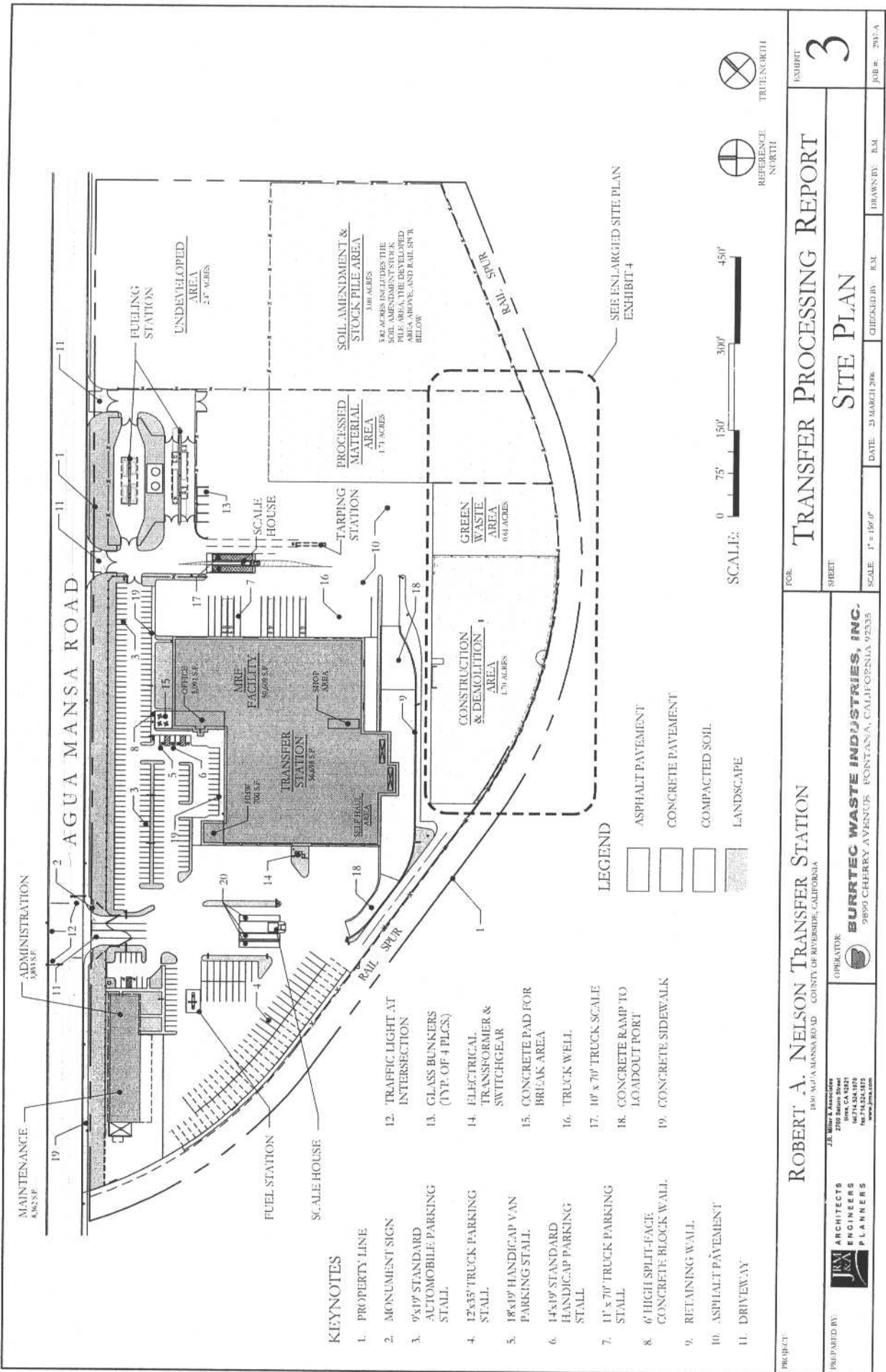

PROJECT:	<b>ROBERT A. NELSON TRANSFER STATION</b>			
PREPARED BY:	<b>JVA ARCHITECTS ENGINEERS PLANNERS</b> <small>2000 CALIFORNIA STREET, SUITE 200, OAKLAND, CALIFORNIA 94612          (415) 774-0242 FAX (415) 774-0243          WWW.JVA.COM</small>			
FOR:	<b>TRANSFER PROCESSING REPORT</b>			
SHEET:	<b>SITE PLAN</b>			
SCALE:	1" = 150' 0"	DATE:	23 MARCH 2006	
CHECKED BY:	R.M.	DRAWN BY:	B.M.	
EXHIBIT:	<b>3</b>		JOB #:	203-A

Total Proposed Lease Area 22.03 Acres

VACANT  
2.82 ACRES

APN 175-190-029  
PROPOSED LEASE  
AND STOCKPILE AREA  
(SOIL AMENDMENT  
EXPANSION AREA)  
3.00 ACRES

LNG FUELING  
STATION  
(1.6 ACRES)

ORIGINAL  
LEASE AND PARCEL BOUNDARY  
EXISTING MATERIAL  
RECOVERY FACILITY

APN 175-180-018  
ORIGINAL LEASE AREA

CURRENT LEASE AREA  
19.03 ACRES

Potential  
Rail Spur

Existing  
Rail Line



**Riverside County**  
**Waste Management Department**

# Robert A. Nelson Transfer Station Lease Amendment Boundaries

Exhibit 4

File Directory: /ogua/03am/spec/ran-burrtlec-leasearco-march-2006.dgn Date: March 2006

Scale: 1"=200'