

SUBMITTAL TO THE BOARD OF SUPERVISORS
COUNTY OF RIVERSIDE, STATE OF CALIFORNIA

510 B



FROM: TLMA - Transportation Dept.

SUBMITTAL DATE:
June 30, 2006

SUBJECT: Miles Avenue and Clinton Street: Road Improvement & Bridge Project
Indio Area - Fourth Supervisorial District

RECOMMENDED MOTION: ADOPTION of a Mitigated Negative Declaration for Environmental Assessment No. 40315, APPROVAL of the Miles Avenue and Clinton Street Road Improvement and Bridge Project, and ADOPTION of the Mitigation Monitoring and Reporting Program for the project.

BACKGROUND: Miles Avenue is an existing 2 lane road that crosses the Whitewater River within the City of Indio and adjacent unincorporated County areas. Miles Avenue is currently 4 lanes east and west of the project. This project proposes to replace the existing low water crossing at Whitewater with a 4 lane bridge and widen Miles Avenue from the Whitewater River to Clinton Street to 4 lanes with a striped median and left turn pockets at some intersections. Improvements to Clinton Street are planned to provide 4 lanes and a striped median from Miles Avenue to Fred Waring Drive. All missing sidewalks segments along both Miles and Clinton will be constructed. A traffic signal will be installed at the Miles Avenue intersection with Swingle Street to provide safe pedestrian crossings for Indio Middle School students.

The Transportation Department is the lead agency for the project under the California Environmental Quality Act (CEQA). The City of Indio and the Coachella Valley Association of Governments (CVAG) have participated in the development of the project. The project is funded through CVAG's Transportation Uniform Mitigation Fee (TUMF) program and by the City of Indio and the County. Initially the funding for the project was to include approximately \$2 million in Federal State Transportation Improvement Plan (FSTIP) funds. However, the Transportation Department determined that uncertainty about the availability of the funds due to the State's financial problems and the multi-year delays that were being experienced justified removal of the federal funds from the project.

(continued next page)

GAJ:mz

George A. Johnson
George A. Johnson
Director of Transportation

REVIEWED BY EXECUTIVE OFFICE

DATE 6/30/06 AG

Departmental Concurrence

Policy

Consent

Dept't Recomm.:

Policy

Consent

Per Exec. Ofc.:

Prev. Agn. Ref.:

District: 4

Agenda Number:

A Public Scoping meeting was held in June of 2002. At that time, the federal processing required the Transportation Department to consider more than one design alternative. Therefore, the residents who came to the meeting were shown two alignments on Miles Avenue and three alignments on Clinton Street. The alignments that required the acquisition of multiple homes (up to 2 homes on Miles Avenue and up to 8 homes on Clinton Street) have been eliminated. The residents have since been informed, via letter, that the alignments with impacts to multiple homes have been discarded in favor of an alignment with the least possible impacts to residents and property owners.

The preferred alternative for Miles Avenue requires the acquisition of an accessory structure in a plant nursery on the north side of Miles Avenue. The property owner is in support of the project. The preferred alternative for Clinton Street requires the relocation of one mobilehome in a mobilehome park.

Adoption of the Mitigated Negative Declaration and the Mitigated Monitoring Plan will complete the environmental documentation for the project. The final step in the environmental process is to obtain the permits for the construction of the project through the Army Corps of Engineers, Department of Fish & Game and the Regional Water Quality Control Board. Completion of these permits is expected in the fall of 2006. Final design is under way. The preparation of legals and plats for right of way acquisition has begun. Construction of the bridge is expected to begin in 2007.



NOTICE OF DETERMINATION
COUNTY OF RIVERSIDE TRANSPORTATION DEPARTMENT

EA No. 40315

SCH# 2005121078

PROJECT NAME : Clinton Street / Miles Avenue Widening & Bridge Project

DESCRIPTION AND LOCATION: The project is located within the City of Indio and the County of Riverside. The project proposes to replace an existing low-water crossing of the Whitewater River at Miles Avenue with a 4 lane bridge. Planned improvements to Clinton Street and Miles Avenue will result in 4 lanes of travel and completion of all missing sidewalk segments. A traffic signal will be installed at the intersection of Miles Avenue and Swingle Street.

- 1 The project will not have a significant effect on the environment.
2. A Mitigated Negative Declaration was prepared for this project pursuant to the provisions of CEQA.
3. Mitigation measures were made a condition of the approval of this project.
4. A Mitigation Monitoring plan was adopted.

The project will not have a significant effect on the environment and a Negative Declaration has been adopted pursuant to CEQA and may be examined, along with administrative record, at the Transportation Department, 4080 Lemon Street, 8th fl, Riverside, California 92501.

Laurie Dobson Correa

Title Principal Planner

Date 6-7-06

George A. Johnson

Title Director of Transportation

Date 6/16/06

HEARING BODY OR OFFICER

XX Board of Supervisors
 _____ Planning Commission

ACTION ON PROJECT

_____ Approval
 _____ Disapproval

Date: _____

Verifying: _____

Title: _____

Date: _____

For County Clerk Use

**CLINTON STREET/MILES AVENUE WIDENING AND BRIDGE PROJECT
MITIGATION MONITORING AND REPORTING PROGRAM**

Environmental Issue	Measure Number	Mitigation Measures	Time Frame for Implementation	Responsibility for Implementation	Oversight for Implementation	Verification
Air Quality	AQ-1.	<p>Prior to the issuance of grading permits or approval of grading plans, a dust control plan shall be a part of the construction contract standard specifications, which shall include measures to meet the requirements of SCAQMD Rules 402 and 403. Such measures may include, but are not limited to, the following:</p> <ul style="list-style-type: none"> ▪ Discontinue operation during second-stage smog alerts. ▪ Attempt to phase and schedule activities to avoid high-ozone days and first-stage smog alerts. ▪ Cover haul trucks covered prior to leaving the site to prevent dust from impacting the surrounding areas. ▪ Comply with AQMD Rule 403, particularly to minimize fugitive dust and noise impacts on surrounding areas. SCAQMD Rule 403.1, as amended, shall be adhered to, ensuring the clean up of the construction-related dirt on approach routes to the site, and the application of water and/or chemical dust retardants that solidify loose soils, shall be implemented for construction vehicle access, as directed by the RCTD. This shall include covering, watering or otherwise stabilizing all inactive soil piles (left more than 10 days) and inactive graded areas (left more than 10 days). ▪ Moisten soil each day prior to commencing grading to depth of soil cut. ▪ Water exposed surfaces at least twice a day under calm conditions, and as often as needed on windy days or during very dry weather in order to maintain a surface crust and minimize the release of visible emissions from the construction site. ▪ Treat any area that will be exposed for extended periods with a soil conditioner to stabilize soil or temporarily plant with vegetation. ▪ Wash mud-covered tires and undercarriages of trucks leaving construction sites. ▪ Provide for street sweeping, as needed, on adjacent roadways to remove dirt dropped by construction vehicles and mud, which would otherwise be carried off by trucks departing project sites. ▪ Securely cover all loads of fill coming to the site with a tight fitting tarp. ▪ Cease grading during periods when winds exceed 25 miles per hour. ▪ Permanently seal all graded areas, as applicable, at the earliest practicable time after soil disturbance. ▪ Maintain construction equipment in peak operating condition so as to reduce operating 	Construction Phase	Project Contractor	RCTD – Construction Inspection	

**CLINTON STREET/MILES AVENUE WIDENING AND BRIDGE PROJECT
MITIGATION MONITORING AND REPORTING PROGRAM**

Environmental Issue	Measure Number	Mitigation Measures	Time Frame for Implementation	Responsibility for Implementation	Oversight for Implementation	Verification
		<ul style="list-style-type: none"> ▪ emissions. ▪ Use low-sulfur diesel fuel in all equipment. ▪ Use electric equipment whenever practicable/shut off engines when not in use. ▪ Shut off engines when not in use. 				
Biological Resources						
Biological Resources	BIO-1.	<p>Within thirty days prior to the onset of construction activities, a qualified biologist shall survey within the limits of project disturbance and adjacent areas for the presence of any active raptor nests. Any nest found during the survey will be mapped on the construction plans. If no active nests are found, no further mitigation would be required. Results of the surveys shall be provided to the CDFG. If nesting activity is present at any raptor nest site, the active site shall be protected until nesting activity has ended to ensure compliance with Section 3503.5 of the California Fish and Game Code. To protect nest sites, the following restrictions on construction will be required between February 1 and June 30 (or until nests are no longer active as determined by a qualified biologist): (1) clearing limits will be established with a minimum of 91 m (300 ft) or as otherwise determined by a qualified biologist, in any direction from any occupied nest; and (2) access and surveying will not be allowed within 30 m (100 ft) of any occupied nest. Any encroachment into the 91/10 m (300/100 ft) buffer area around the known nest will be allowed only if it is determined by a qualified biologist that the proposed activity will not disturb the nest occupants.</p> <p>Due to impacts to jurisdictional waters and the streambed of the Whitewater River, the project will require a 404 Permit from the ACOE, a 1602 Streambed Alteration Agreement (SAA) from the CDFG, and a Section 401 Water Quality Certification from the RWQCB. For impacts on non-wetland waters, typical mitigation measures required by the regulatory agencies (ACOE, CDFG and RWQCB) include the following:</p> <ul style="list-style-type: none"> ▪ On-site preservation enhancement; ▪ Off-site preservation through the purchase of suitable habitat or participation in an existing mitigation bank; ▪ On-site treatment of flows from developed surfaces prior to such flows entering waters of the U.S. (e.g., mechanical filters, bio-swales, or other similar post-construction BMPs); ▪ No work will be performed within the Whitewater River during periods of water flow. <p>The ACOE usually requires a 1:1 habitat replacement ratio for impacts on jurisdictional non-wetland waters and a 3:1 habitat replacement ratio for impacts on jurisdictional wetland waters. Requirements of the CDFG and RWQCB usually coincide with those of the ACOE. Specific</p>	Design Phase	RCTD-Environmental	RCTD - Project Management	
	BIO-2.		Design Phase	RCTD-Environmental	RCTD - Project Management	

**CLINTON STREET/MILES AVENUE WIDENING AND BRIDGE PROJECT
MITIGATION MONITORING AND REPORTING PROGRAM**

Environmental Issue	Measure Number	Mitigation Measures	Time Frame for Implementation	Responsibility for Implementation	Oversight for Implementation	Verification
		replacement ratios and other mitigation measures will be developed by the RCTD in consultation with the regulatory agencies during the permitting process.				
Archaeological Resources						
Archaeological Resources	AR-1.	If human remains are found at the project site during excavation for the project, work shall be suspended in the immediate area of the find and the Riverside County Coroner's Office shall be notified. Standard guidelines set by California law for the treatment of human remains shall be followed (Public Resources Code Section 5097.98 et seq., Health and Safety Code Section 7050.5, and others). Procedures for the treatment of Native Americans shall be followed as specified in "A Professional Guide for the Preservation and Protection of Native American Human Remains and Associated Grave Goods," published by the California Native American Heritage Commission.	Construction Phase	Project Contractor	RCTD – Environmental	
Paleontological Resources						
Paleontological Resources	PR-1.	During trenching/excavation activities in the river a qualified paleontologist shall be on-site to monitor excavated materials in an effort to ensure that any paleontological resources encountered are collected, documented and properly preserved with the appropriate historical institution.	Construction Phase	Project Contractor	RCTD – Environmental	
Geology and Soils						
Geology and Soils	GS-1.	Adherence to the current seismic design criteria of the State Department of Transportation and applicable local standards are required. Furthermore, prior to final plan approval, a site-specific geotechnical study shall be undertaken. The geotechnical report shall be prepared by a registered civil engineer or certified engineering geologist, who has competence in the field of seismic hazard evaluation and mitigation. The geotechnical report shall contain site-specific evaluations of the seismic hazards affecting the project site, and shall identify portions of the project site containing seismic hazards. The report shall also identify any known off-site seismic hazards that could adversely affect the site in the event of an earthquake.	Design Phase; Construction Phase	RCTD – Project Design; Project Contractor	RCTD – Project Management	

**CLINTON STREET/MILES AVENUE WIDENING AND BRIDGE PROJECT
MITIGATION MONITORING AND REPORTING PROGRAM**

Environmental Issue	Measure Number	Mitigation Measures	Time Frame for Implementation	Responsibility for Implementation	Oversight for Implementation	Verification
	GS-2.	<p>A SWPPP shall be prepared prior to grading. The SWPPP shall outline methods that shall be implemented to control erosion from graded or cleared portions of the site, including but not limited to:</p> <ul style="list-style-type: none"> ▪ Minimizing the length of time that soils lie exposed. ▪ Revegetating (landscaping, hydro seeding or any other method of providing vegetative cover) graded areas and/or chemical soil binders, in a manner approved by the County if determined to be required for erosion control in areas not planned for development until subsequent phases. Landscaping and hydro seeding shall be under the direction of a licensed landscape architect and approved by the County. 	Design Phase; Construction Phase	RCTD – Project Design; Project Contractor	RCTD – Project Management	

**CLINTON STREET/MILES AVENUE WIDENING AND BRIDGE PROJECT
MITIGATION MONITORING AND REPORTING PROGRAM**

Environmental Issue	Measure Number	Mitigation Measures	Time Frame for Implementation	Responsibility for Implementation	Oversight for Implementation	Verification
Hazards and Hazardous Materials						
Hazards and Hazardous Materials	HZ-1.	<p>The following mitigation measures are recommended:</p> <ul style="list-style-type: none"> ▪ Should construction require dewatering activities or if groundwater is expected to be encountered, a qualified hazardous materials consultant with Phase II and Phase III experience should review groundwater documents regarding site characterization and/or closure status for the two properties that have leaking underground storage tanks on-site. ▪ Should construction activities result in the removal of yellow paint or thermoplastic traffic stripes, the generated wastes must be disposed of to an appropriate permitted disposal facility. ▪ It is recommended that the landfill operator be contacted in advance to determine any specific requirements they may have regarding the disposal of lead-based paint materials. ▪ Any demolition of existing buildings must comply with State law, which requires a contractor, where there is asbestos-related work involving 9.3 square m (100 square ft) or more of ACMs, to be certified and that certain procedures regarding the removal of asbestos be followed. 	Construction Phase	Project Contractor	RCTD – Construction Inspection	
	HZ-2.	<p>If unknown wastes or materials are discovered during construction/demolition by the project contractor that he/she believes may involve hazardous waste/materials, the contractor shall:</p> <ul style="list-style-type: none"> ▪ Immediately stop work in the vicinity of the suspected contaminant, removing workers and the public from the area; ▪ Notify the project Engineer of the implementing Agency; ▪ Secure the area as directed by the project Engineer; and ▪ Notify the implementing agency's Hazardous Waste/Materials Coordination. 	Construction Phase	Project Contractor	RCTD – Construction Inspection	
Hydrology and Water Quality						
Hydrology and Water Quality	WQ-1.	<p>Contractor shall fully conform to the requirements of the RCTD's NPDES Storm Water Permit No. CAS617002, in addition to the development, implementation, and maintenance of a SWPPP. The SWPPP shall emphasize structural and non-structural BMPs in compliance with the RCTD's NPDES requirements. A copy of the Notice of Intent (NOI), SWPPP, and monitoring plan shall be submitted to the County Engineer a minimum of thirty days prior to the commencement of construction.</p>	Design Phase; Construction Phase	Project Contractor	RCTD – Construction Inspection	

**CLINTON STREET/MILES AVENUE WIDENING AND BRIDGE PROJECT
MITIGATION MONITORING AND REPORTING PROGRAM**

Environmental Issue	Measure Number	Mitigation Measures	Time Frame for Implementation	Responsibility for Implementation	Oversight for Implementation	Verification
Noise						
Noise	N-1.	<p>The following mitigation measures are recommended:</p> <ul style="list-style-type: none"> ▪ The City of Indio has adopted a Noise Ordinance that excludes control of construction activities during the hours between 7:00 a.m. and 8:00 p.m. Monday through Saturday. All construction activities will be limited to these hours and prohibited on Sunday and Federal holidays. ▪ Adherence to County noise standards related to construction activities. 	Construction Phase	Project Contractor	RCTD – Construction Inspection	
Population and Housing						
Population and Housing	PH-1.	<p>For any residents to be displaced, the RCTD will provide relocation advisory assistance in accordance with the Uniform Relocation Assistance and Real Property Policies Act of 1970, as amended. The RCTD will assist displaced in obtaining replacement housing by providing current and continuing information on the availability and proves of single-family residences that are comparable, "decent, safe, and sanitary." Residential replacement dwellings will be in equal or better neighborhoods, at prices within the financial means of the individuals and families displaced, and reasonably accessible to their places of employment. Prior to displacement, comparable replacement dwellings will be offered to displacees regardless of race, color, religion, sex, national origin, and consistent with the requirements of Title VIII of the Civil Rights Act of 1968. This assistance will also include the supplying of information concerning Federal- or State-assisted housing programs, and any other known services being offered by public and private agencies in the area.</p>	Design Phase	RCTD – Project Management	RCTD – Project Management	
Transportation/Traffic						
Transportation/Traffic	T-1.	<p>Short-term mitigation for roadways shall be mitigated by a Traffic Management Plan (TMP) to be established by the County prior to construction of any facilities. This Plan shall consist of prior notices, adequate sign-posting, detours, phased construction and temporary driveways where necessary. The Plan shall specify implementation timing of each plan element (prior notices, sign-posting, detours, etc.) as determined appropriate by the County. Adequate access to and from residential areas shall be provided at all times. Proper detours and warning signs shall be established to ensure public safety. The TMP shall be devised so that construction shall not interfere with any emergency response or evacuation plans. Construction activities shall proceed in a timely manner in an effort to reduce impacts.</p>	Design Phase; Construction Phase	Project Contractor	RCTD – Construction Inspection	
	T-2.	<p>The contractor, subject to City and County approval, shall deploy appropriate temporary signage and identify a detour route for the Whitewater River crossing at Miles Avenue during project construction.</p>	Design Phase; Construction Phase	Project Contractor	RCTD – Construction Inspection	

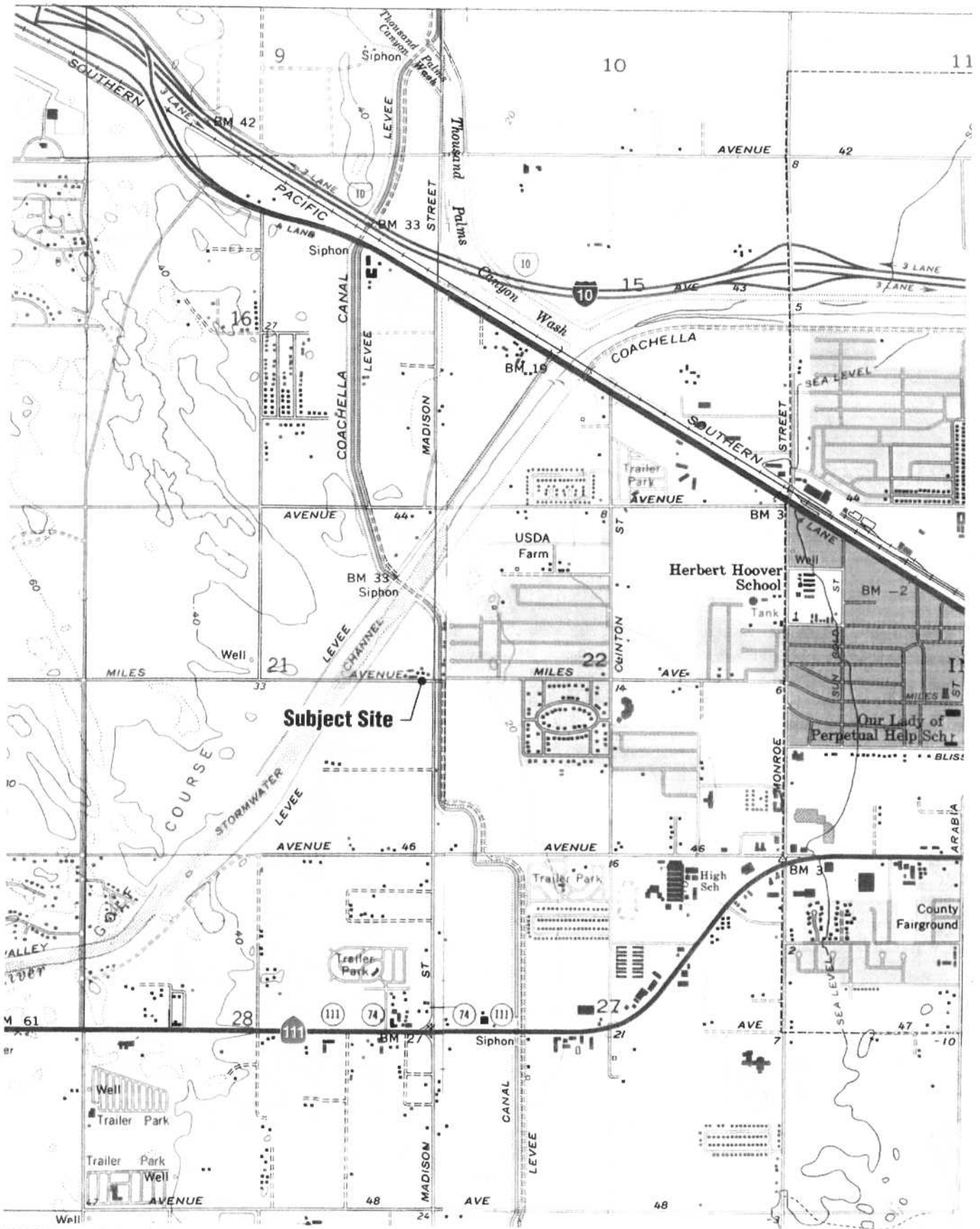

USGS Topo, La Quinta, Calif., rev. 1980
 and Indio, Calif., rev. 1972



11/15/02 JN 20-100220-9876

MILES AVENUE / CLINTON STREET • DELINEATION

Subject Site

Exhibit 2