

SUBMITTAL TO THE BOARD OF SUPERVISORS  
COUNTY OF RIVERSIDE, STATE OF CALIFORNIA

228 B



FROM: TLMA – Transportation Dept.

SUBMITTAL DATE:  
August 21, 2006

SUBJECT: **PARCEL MAP 31196**

A Schedule "E" Subdivision in the Lake Mathews Area

**ONE YEAR GUARANTEE AND MAINTENANCE AGREEMENTS**

**RECOMMENDED MOTION:** That the Board approve the attached One Year Guarantee and Maintenance Agreements as approved by County Counsel and authorize the Chairman to sign these agreements for Parcel Map 31196.

**BACKGROUND:** Improvements have been completed on this project. The developer desires to enter into Maintenance Agreements to guarantee a one year maintenance of the improvements and has submitted agreements and securities which have been approved by County Counsel.

REVIEWED BY EXECUTIVE OFFICE

DATE 8/22/06 TMS

Departmental Concurrence

HS:lf

Submittals: Vicinity Map  
Road/Drainage Maint Agrmts  
Water System Maint Agrmts  
Sewer System Maint Agrmts  
Survey Monument Agreements

George A. Johnson  
Director of Transportation

- Consent
- Policy
- Consent
- Policy

Dep't Recomm.:  
Per Exec. Ofc.:

Prev. Agn. Ref.: 03/23/04 – 2.8

District: 1

Agenda Number:

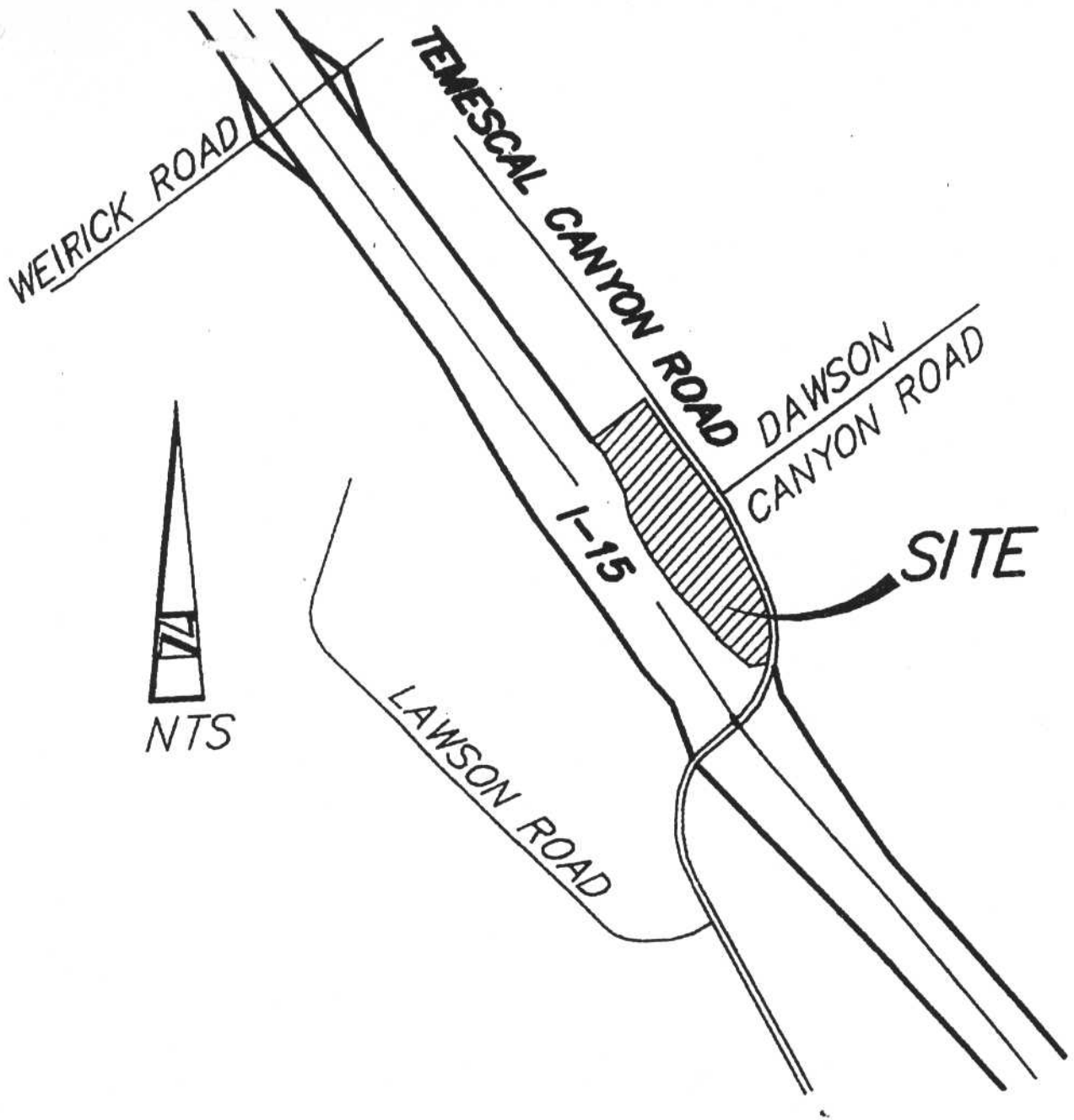

**VICINITY MAP**

**PM 31196**

**SEC. 34 TWP. 4S RNG. 6W**