

2 ORDINANCE NO. 452.223

3 AN ORDINANCE OF THE COUNTY OF RIVERSIDE
4 AMENDING ORDINANCE NO. 452
5 RELATING TO PRIMA FACIE SPEED LIMITS

6 The Board of Supervisors of the County of Riverside do ordain as follows:

7 Section 1. Section 2.2 (Thirty miles per hour) is amended to include the
8 following:

- 9 19. On Agate Street between Jurupa Road and 54th Street, a total distance
10 of approximately .72 mile, in the Glen Avon area.

11 Section 2. Section 2.3 (Thirty-five miles per hour) is amended to include the
12 following:

- 13 87. On the westerly half of Cat Canyon Road between Cahuilla Way and
14 Cholla Way, a total distance of approximately 0.25 mile, in the Palm
15 Desert area.

- 16 88. On Cholla Way between Cat Canyon Road and 0.5 miles westerly, a
17 total distance of approximately 0.5 mile, in the Palm Desert area.

18 Section 3. Section 2.4 (Forty miles per hour) is amended to include the
19 following:

- 20 86. On Porras Road between La Estrella and Baxter Road, a total distance
21 of approximately 0.5 mile, in the Wildomar area.

- 22 87. On Soboba Street between Stetson Avenue and Florida Avenue, a total
23 distance of approximately 1.2 miles, in the Hemet area.
24
25

1 88. On the entire northerly half, and on the County portions of the southerly
2 half of Brookside Avenue between Union Street and Highland Springs
3 Avenue, a distance of approximately 3.12 miles, in the Cherry Valley
4 area.

5 89. On 54th Street between Pedley Road and Sunset Ridge Drive, a total
6 distance of approximately .57 mile, in the Glen Avon area.

7
8 Section 4. Section 2.5 (Forty-five miles per hour) is amended to include the
9 following:

10 117. On Knabe Road between Hunt Road and Clay Canyon Drive, a total
11 distance of approximately 0.66 mile, in the El Cerrito area.

12 Section 5. Section 2.6 (Fifty miles per hour) is amended to include the
13 following:

14 51. On the northerly half of Mission Lakes Boulevard between Indian
15 Avenue and Little Morongo Road, a total distance of approximately 1.0
16 mile, in the Desert Hot Springs area.

17 52. On the entire northerly half, and on the County portions of the southerly
18 half of Brookside Avenue between I-10 and Union Street, a total
19 distance of approximately 1.33 miles, in the Cherry Valley area.

20
21 Section 6. Subsection 70 of Section 2.3 (35 miles per hour) on Cat Canyon
22 Road between Cholla Way and 0.5 mile westerly; Subsection 71 of Section 2.3
23 (35 miles per hour) on Cholla Way between Cat Canyon Road and Cahuilla Way, both
24 of which were adopted on August 26, 2003, per Ordinance 452.216; Subsection 37 of
25 Section 2.4 (Forty miles per hour) on Brookside Avenue on the south side between a

1 point 3,000 feet east of the centerline of Cherry Avenue (City of Beaumont city limit)
2 and the centerline of Highland Springs Avenue, on the north side between the centerline
3 of Beaumont Avenue and the centerline of Highland Springs Avenue, and on the south
4 side between the centerline of Noble Street and the centerline of Cherry Avenue; and
5 Subsection 7 of Section 2.5 (Forty-five miles per hour) on Soboba Street between State
6 Highway 74 (Florida Avenue) and Stetson Avenue, both of which were adopted on
7 February 4, 2003, per Ordinance 452.214, are hereby repealed.
8

9 Section 7. This ordinance shall take effect 30 days after its adoption.

10 BOARD OF SUPERVISORS OF THE COUNTY
11 OF RIVERSIDE, STATE OF CALIFORNIA

12 BY _____
13 Chairman

13 NANCY ROMERO
14 Clerk of the Board of Supervisors

15 By _____
16 Deputy

FORM APPROVED
COUNTY COUNSEL

SEP 13 2006

18 BY Gordon V. Ubo

16 RH:bjl
September 8, 2006
17 F:\PCDATA\Traffic\ORDINANC\Ordinances\Ord 452.223.doc

LEGEND:

- ////// CITY/COUNTY LIMITS
- ▬ RADAR ZONE
- - - - RADAR SURVEY STATION
- ▬ OTHER STREET OR ROAD



NO SCALE

AGATE STREET
(# 1434)

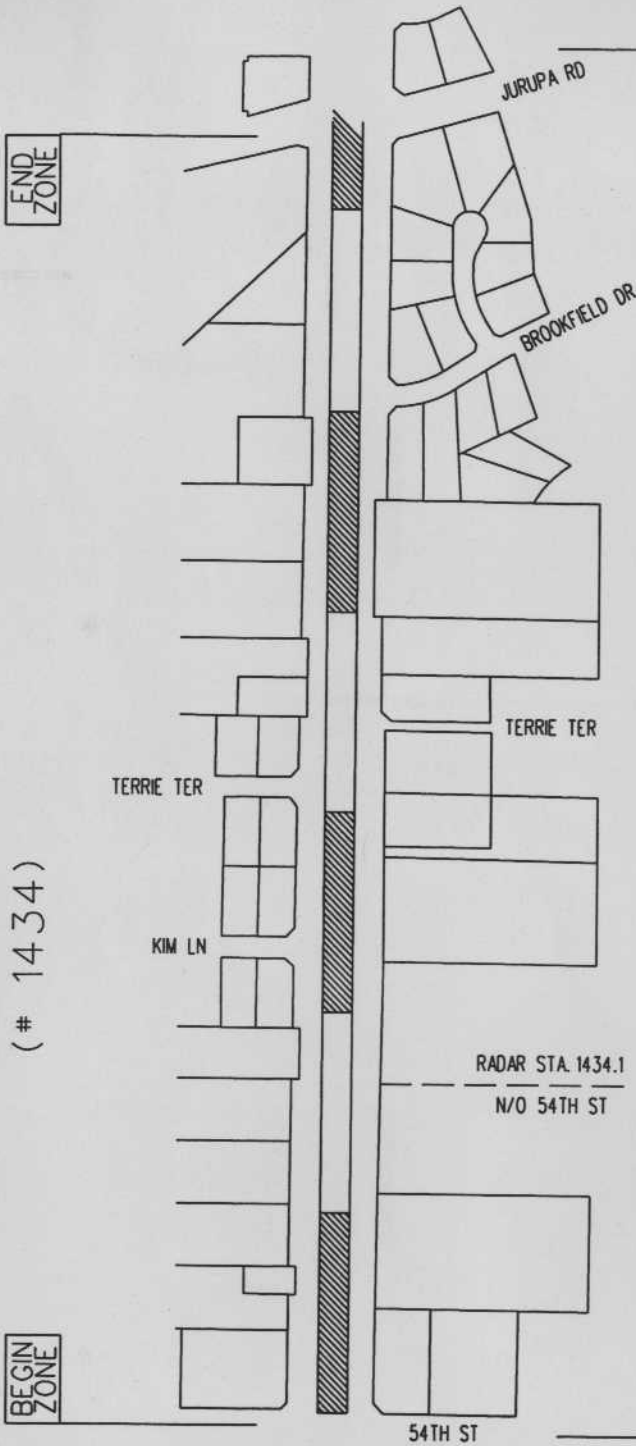

RECOMMENDED SPEED LIMIT	RESIDENTIAL, NO SIDEWALK, EQUESTRIAN
PREVAILING SPEED (85%)	30 MPH
VEHICLES IN 24 HR (2 WAY)	37 MPH
SEGMENT LENGTH	882
ALL ACCIDENTS IN 2 YRS.	.72 MI
ACCIDENT RATE ☆	4
EXISTING SPEED LIMIT	8.62 MVM
	NOT POSTED

☆ RATE = $\frac{\text{ACCIDENT} \times 1,000,000}{\text{VEH} \times 365 \times 2 \times \text{MILE}}$

COUNTY AREA: GLEN AVON
 COUNTY MAP: 9
 SUPERVISOR DISTRICT 2

SURVEY DATE: JUN 22, 2006
 MAP DATE: AUG 15, 2006
 DRAWN BY: N AHMAD
 CAD FILE: AGATE.DGN

APPROVED BY: *Lawrence T. Tai*
 DATE: 8/21/2006
 LAWRENCE T. TAI, P.E.
 COUNTY TRAFFIC ENGINEER

LEGEND:

- ////// CITY LIMITS
- ▬ RADAR ZONE
- - - - RADAR SURVEY STATION
- ==== OTHER STREET OR ROAD



NO SCALE

BROOKSIDE AVENUE
(#1308)

RADAR STA 1308.2
100' E/O WINE SAP AVE

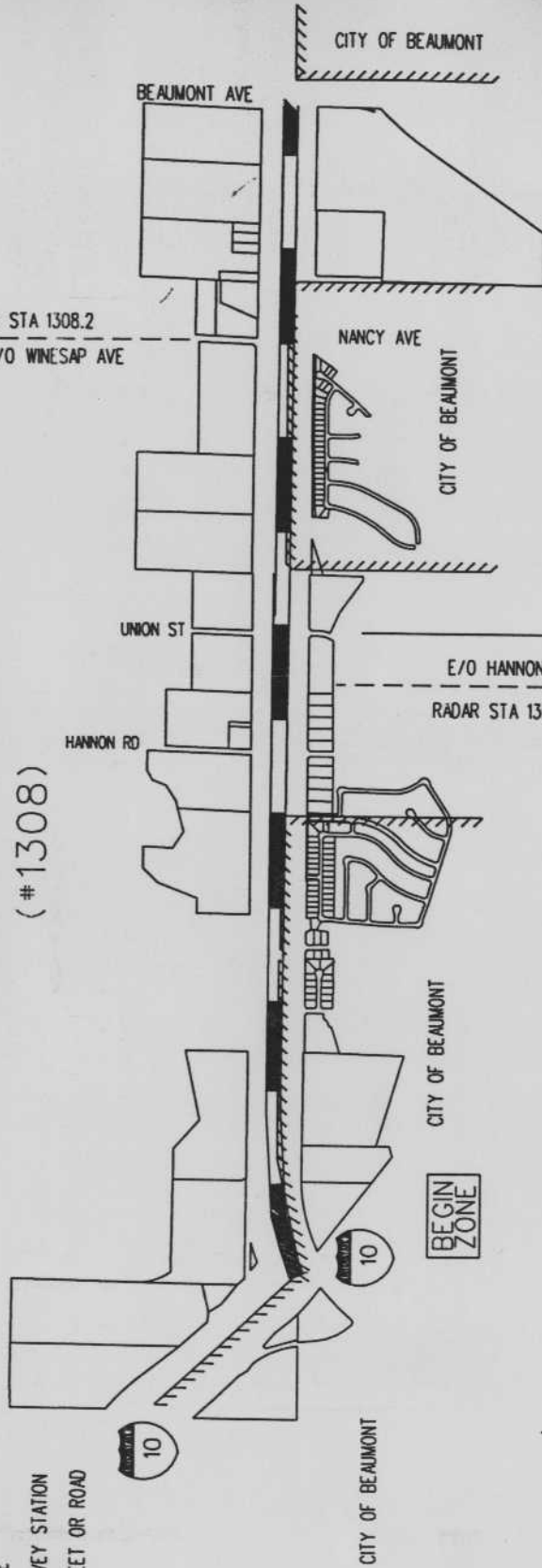





RECOMMENDED SPEED LIMIT	50 MPH	NO SHOULDERS, NO SIDEWALKS, HIGH ACCIDENT RATE REDUCE SPEED LIMIT TO 40 MPH
PREVAILING SPEED (85%)	52.3 MPH	40 MPH
VEHICLES IN 24 HR (2 WAY)	2,200	44.8 MPH
SEGMENT LENGTH	1.33 MI	2,100
ALL ACCIDENTS IN 2 YRS.	1	1.36 MI
ACCIDENT RATE ☆	.47 MVM	7
EXISTING SPEED LIMIT	NOT POSTED	2.88 MVM

☆ RATE: ACCIDENT x 1,000,000
VEH x 365 x 2 x MILE

COUNTY AREA: CHERRY VALLEY COUNTY MAP: 90, 91 SUPERVISOR DISTRICT: 5		APPROVED BY: <i>Lawrence T. Tai</i> DATE: 7/24/06 LAWRENCE T. TAI, P.E. COUNTY TRAFFIC ENGINEER	COUNTY OF RIVERSIDE TRANSPORTATION DEPARTMENT TRAFFIC ENGINEERING DIVISION ENGINEERING AND TRAFFIC SURVEY AT BROOKSIDE AVE	PAGE 1 OF 2
SURVEY DATE: APR 13 2006 MAP DATE: JUL 20 2006 DRAWN BY: N AHMAD CAD FILE: BROOKSIDE.DGN				

LEGEND:

-  CITY LIMITS
-  RADAR ZONE
-  RADAR SURVEY STATION
-  OTHER STREET OR ROAD



NO SCALE

BROOKSIDE AVENUE (#1308)

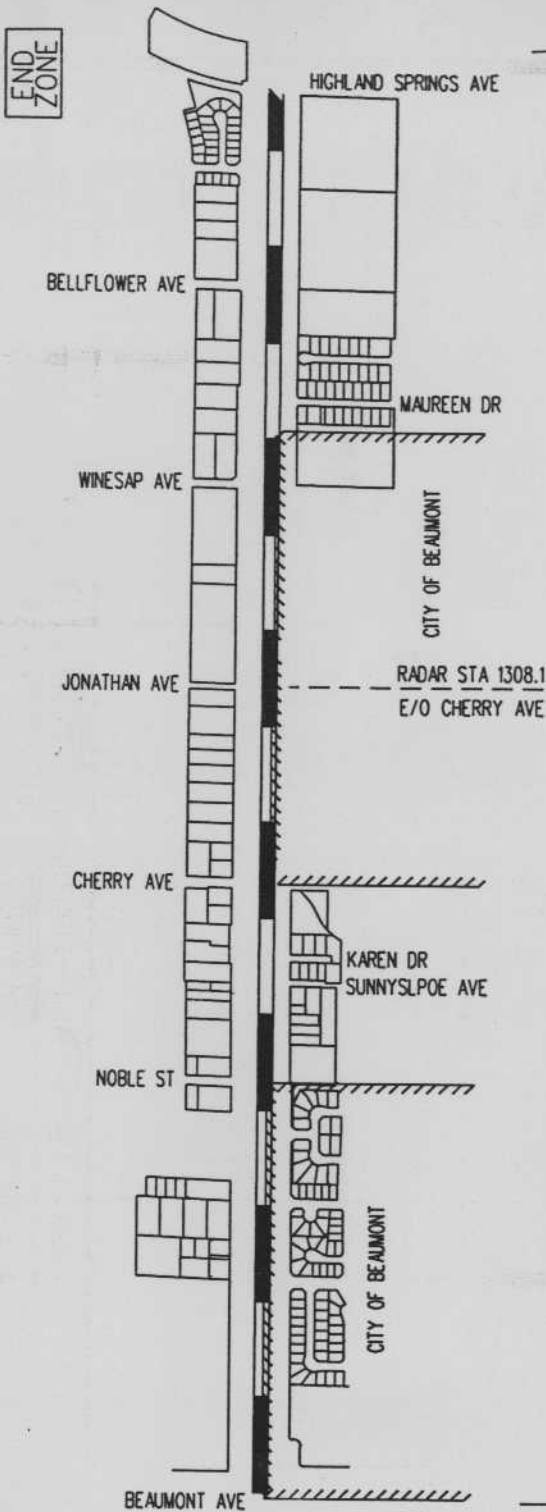

NO SHOULDERS, NO SIDEWALKS, REDUCE SPEED LIMIT TO 40 MPH

RECOMMENDED SPEED LIMIT	40 MPH
PREVAILING SPEED (85%)	44 MPH
VEHICLES IN 24 HR (2 WAY)	5,000
SEGMENT LENGTH	1.76 MI
ALL ACCIDENTS IN 2 YRS.	13
ACCIDENT RATE ★	2.02 MVM
EXISTING SPEED LIMIT	40 MPH

★ RATE = $\frac{\text{ACCIDENT} \times 1,000,000}{\text{VEH} \times 365 \times 2 \times \text{MILE}}$

<p>COUNTY AREA: CHERRY VALLEY</p> <p>COUNTY MAP: 90, 91</p> <p>SUPERVISOR DISTRICT: 5</p>	<p>SURVEY DATE: APR 13 2006</p> <p>MAP DATE: JUL 20 2006</p> <p>DRAWN BY: N AHMAD</p> <p>CAD FILE: BROOKSIDE.DGN</p>	<p>APPROVED BY: <i>Lawrence T. Tai</i></p> <p>DATE: 7/24/2006</p> <p>LAWRENCE T. TAI, P.E. COUNTY TRAFFIC ENGINEER</p>
<p>COUNTY OF RIVERSIDE TRANSPORTATION DEPARTMENT TRAFFIC ENGINEERING DIVISION</p>		<p>ENGINEERING AND TRAFFIC SURVEY AT BROOKSIDE AVE</p>
		<p>PAGE 2 OF 2</p>

LEGEND:

- ////// CITY LIMITS
- ▬ RADAR ZONE
- - - - RADAR SURVEY STATION
- ▬▬▬ OTHER STREET OR ROAD

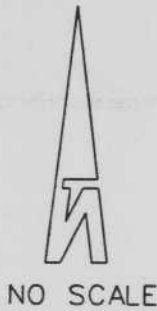

CAT CANYON RD
(#1387)

CHOLLA WAY

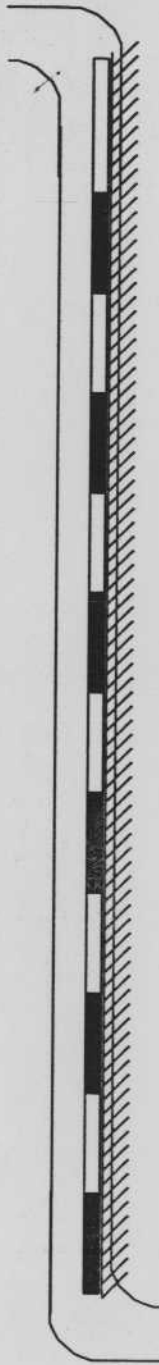

CITY OF PALM DESERT

CAHUILLA WAY

BEGIN ZONE

END ZONE

SURVEY SPEED LIMIT	35 MPH
PREVAILING SPEED (85%)	36.8 MPH
VEHICLES IN 24 HR (2 WAY)	800
SEGMENT LENGTH	0.25 MILE
SPEED ACCIDENTS IN 2 YRS.	0
ACCIDENT RATE ☆	0.00 MVM
PRIOR POSTED LIMIT	35 MPH

☆ RATE: $\frac{\text{ACCIDENT} \times 1,000,000}{\text{VEH} \times 365 \times 2 \times \text{MILE}}$

SURVEY DATE:	4/3/2003	APPROVED BY:	<i>Lawrence T. Tai</i>
MAP DATE:	8/11/2006	DATE:	8/11/2006
DRAWN BY:	N AHMAD		LAWRENCE T. TAI, P.E. COUNTY TRAFFIC ENGINEER
CAD FILE:	CATCANYON.DGN		

COUNTY AREA: PALM DESERT
COUNTY MAP: 191
SUPERVISOR DISTRICT: 4

LEGEND:

- ////// CITY LIMITS
- ▬ RADAR ZONE
- - - - RADAR SURVEY STATION
- ==== OTHER STREET OR ROAD



NO SCALE

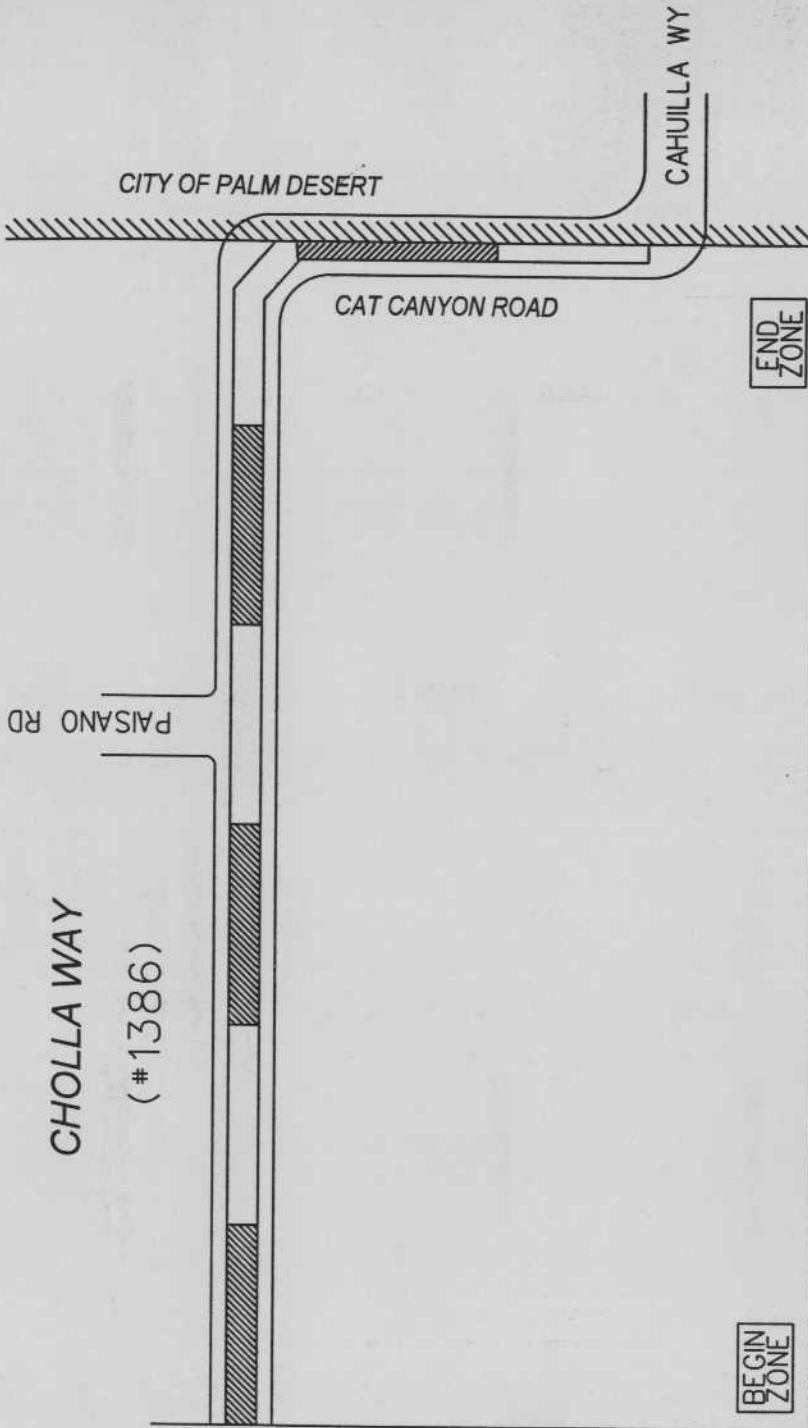

SURVEY SPEED LIMIT	35 MPH
PREVAILING SPEED (85%)	36.8 MPH
VEHICLES IN 24 HR (2 WAY)	800
SEGMENT LENGTH	0.5 MILE
SPEED ACCIDENTS IN 2 YRS.	0
ACCIDENT RATE ☆	0.00 MVM
PRIOR POSTED LIMIT	35 MPH

☆ RATE: ACCIDENT x 1,000,000
VEH x 365 x 2 x MILE





COUNTY AREA: PALM DESERT
COUNTY MAP: 191
SUPERVISOR DISTRICT: 4

SURVEY DATE: 4/3/2003
MAP DATE: 8/1/2006
DRAWN BY: N AHMAD
CAD FILE: CHOLLAWAY.DGN

APPROVED BY: *Lawrence T. Tai*
DATE: 8/1/2006
LAWRENCE T. TAI, P.E.
COUNTY TRAFFIC ENGINEER

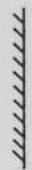
COUNTY OF RIVERSIDE
TRANSPORTATION DEPARTMENT
TRAFFIC ENGINEERING DIVISION
ENGINEERING AND TRAFFIC SURVEY
AT
CHOLLA WAY
PAGE 1 OF 1

LEGEND:

-  CITY LIMITS
-  RADAR ZONE
-  SURVEY STATION
-  OTHER STREET OR ROAD
-  CENTERLINE



KNABE ROAD
(#1276)

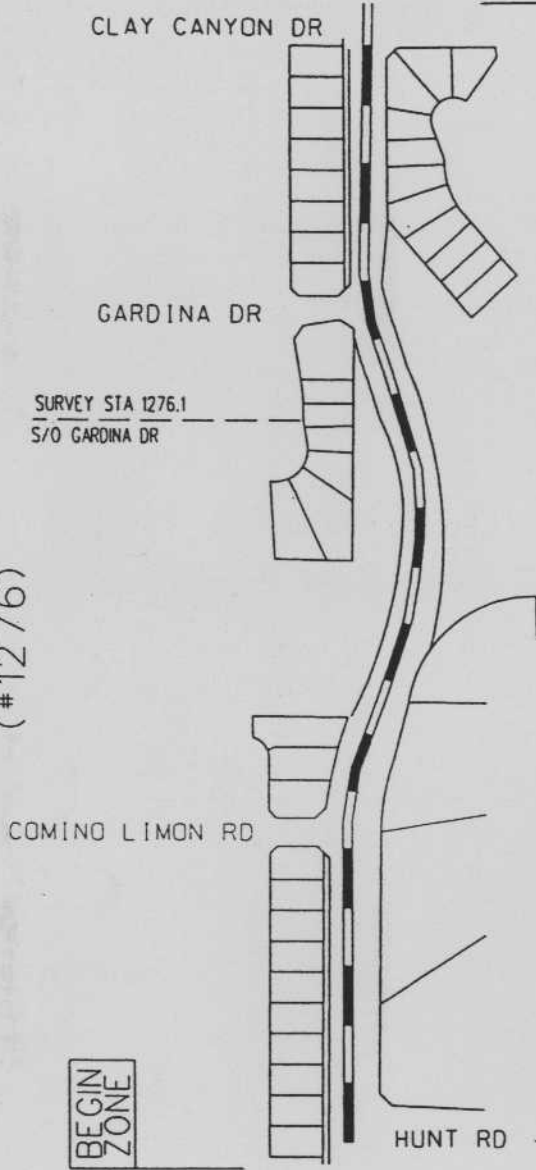

SEE PAGE 2

ROADWAY NARROWS W/O SIDEWALKS, RESIDENTIAL, ROADWAY ALIGNMENT,
CONSISTENT W/ PROPOSED SPEED LIMIT ON TRILOGOY PKWY.

RECOMMENDED SPEED LIMIT	45 MPH
PREVAILING SPEED (85%)	49 MPH
VEHICLES IN 24 HR (2 WAY)	4453
SEGMENT LENGTH	0.66 MILE
ALL ACCIDENTS IN 2 YRS.	1
ACCIDENT RATE ☆	0.47 MVM
EXISTING SPEED LIMIT	NOT POSTED

☆ RATE: $\frac{\text{ACCIDENT} \times 1,000,000}{\text{VEH} \times 365 \times 2 \times \text{MILE}}$

APPROVED BY: *Lawrence T. Tai, P.E.*
DATE: 7/18/2006
LAWRENCE T. TAI, P.E.
COUNTY TRAFFIC ENGINEER

SURVEY DATE: FEB 7 2006
MAP DATE: JUL 10 2006
DRAWN BY: N AHMAD
CAD FILE: KNABE.DGN

COUNTY AREA: EL CERRITO
COUNTY MAP PAGE: 33, 33A
SUPERVISOR DISTRICT: 1

COUNTY OF RIVERSIDE
TRANSPORTATION DEPARTMENT
TRAFFIC ENGINEERING SECTION
ENGINEERING AND TRAFFIC SURVEY
AT
KNABE ROAD

PAGE 1 OF 3

LEGEND:

- ////// CITY LIMITS
- ▬ RADAR ZONE
- - - - RADAR SURVEY STATION
- ==== OTHER STREET OR ROAD



NO SCALE

MISSION LAKES
(# 1432)

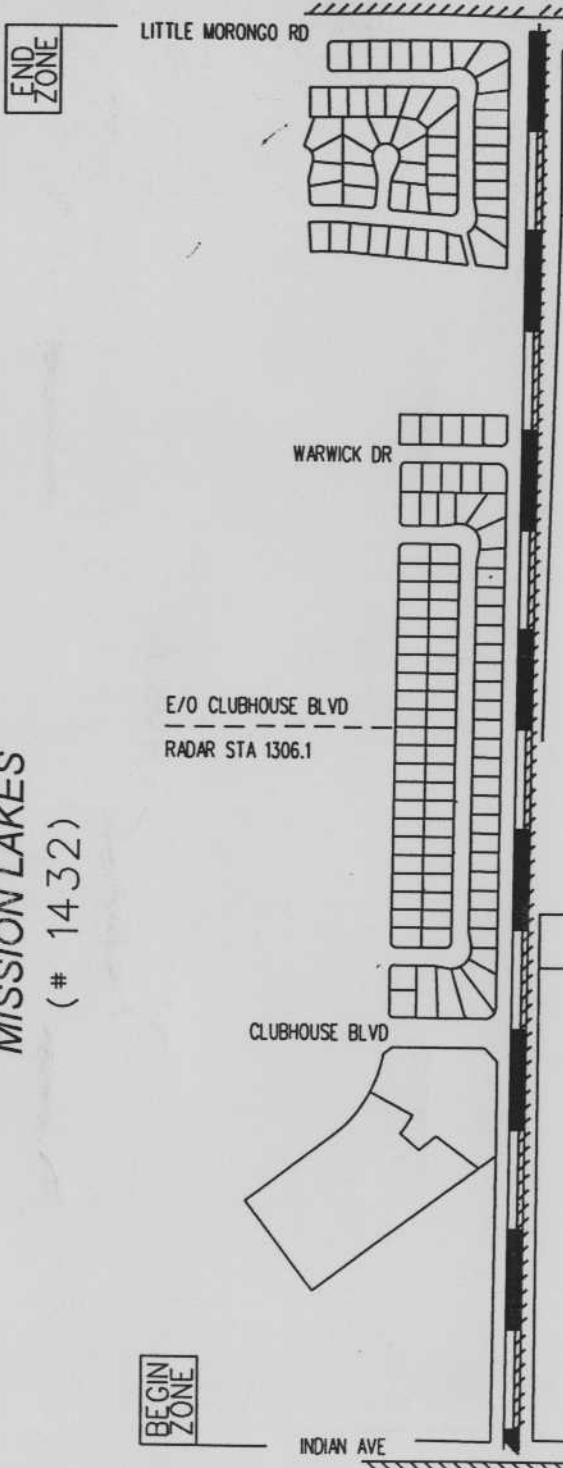





RECOMMENDED SPEED LIMIT	RESIDENTIAL
PREVAILING SPEED (85%)	50 MPH (CITY OF DESERT HOT SPRINGS CONCURRED W/ RECOMMENDED SPEED LIMIT)
VEHICLES IN 24 HR (2 WAY)	54 MPH (PER 2004 STUDY)
SEGMENT LENGTH	2480
ALL ACCIDENTS IN 2 YRS.	1.0 MI
ACCIDENT RATE ☆	1
EXISTING SPEED LIMIT	0.55 MVM
	NOT POSTED

☆ RATE: ACCIDENT x 1,000,000
VEH x 365 x 2YR x MILE

		COUNTY OF RIVERSIDE TRANSPORTATION DEPARTMENT TRAFFIC ENGINEERING SECTION	ENGINEERING AND TRAFFIC SURVEY AT MISSION LAKES	PAGE 1 OF 1
SURVEY DATE: MAR 3 2004 MAP DATE: JUL 11 2006 DRAWN BY: N AHMAD CAD FILE: MISSIONLAKES.DGN		APPROVED BY: DATE: 7/18/2006		LAWRENCE T. TAI, P.E. COUNTY TRAFFIC ENGINEER
COUNTY AREA: DESERT HOT SPRINGS COUNTY MAP: 167A SUPERVISOR DISTRICT: 5				

LEGEND:

-  CITY LIMITS
-  RADAR ZONE
-  RADAR SURVEY STATION
-  OTHER STREET OR ROAD



NO SCALE

PORRAS ROAD
(# 1431)

BEGIN ZONE

RADAR STA. 1431.1
800' N/O BRILLANTE DR

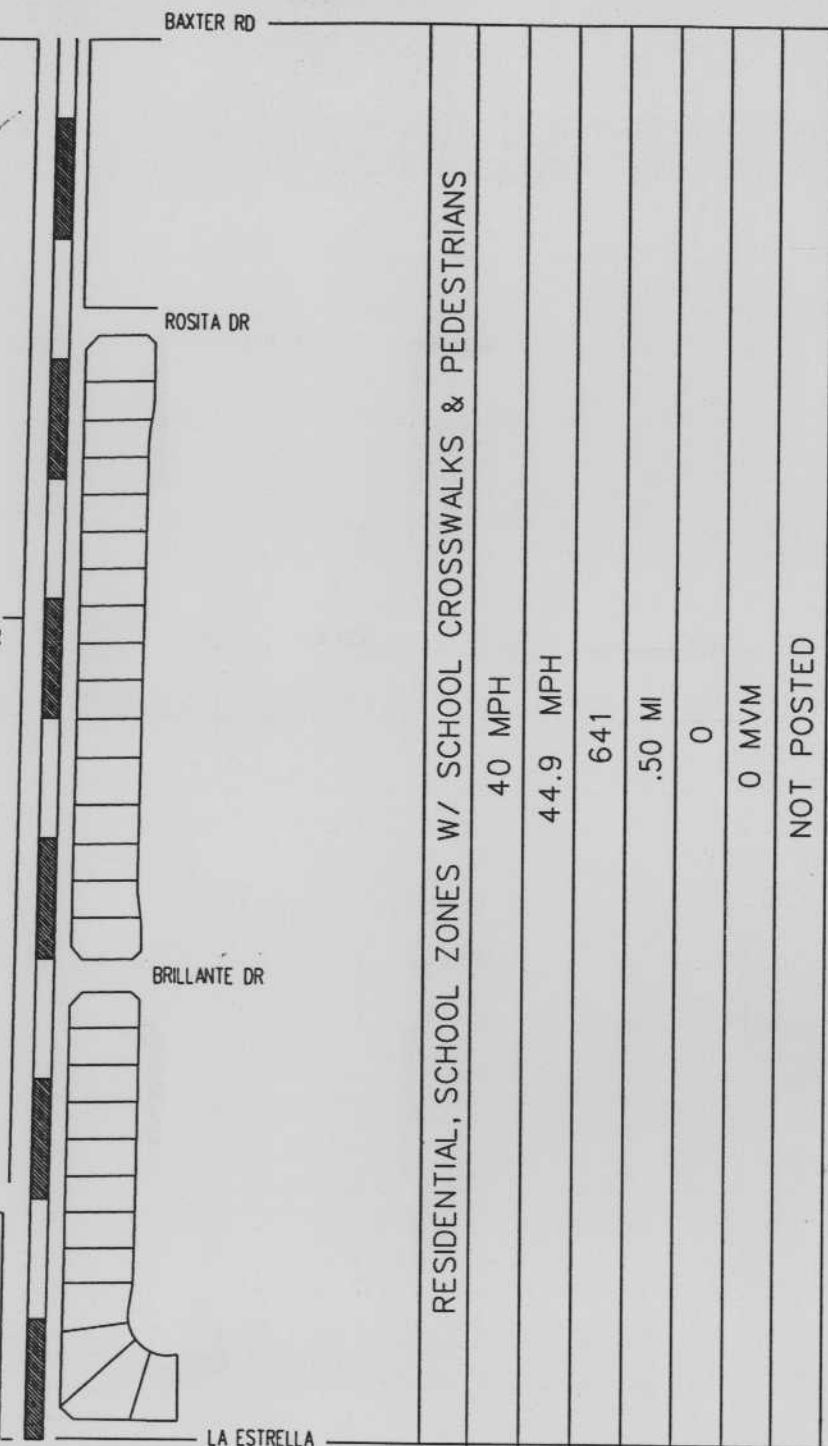
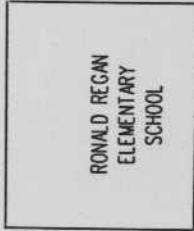

RESIDENTIAL, SCHOOL ZONES W/ SCHOOL CROSSWALKS & PEDESTRIANS

RECOMMENDED SPEED LIMIT	40 MPH
PREVAILING SPEED (85%)	44.9 MPH
VEHICLES IN 24 HR (2 WAY)	641
SEGMENT LENGTH	.50 MI
ALL ACCIDENTS IN 2 YRS.	0
ACCIDENT RATE ☆	0 MVM
EXISTING SPEED LIMIT	NOT POSTED

☆ RATE: ACCIDENT x 1000 000
VEH x 365 x 2YR x MI

		COUNTY OF RIVERSIDE TRANSPORTATION DEPARTMENT TRAFFIC ENGINEERING SECTION		PAGE 1 OF 1
SURVEY DATE: 18 APRIL 06		APPROVED BY: <i>Lawrence T. Tai</i>		ENGINEERING AND TRAFFIC SURVEY AT PORRAS ROAD
MAP DATE: JUNE 20 2006		DATE: 7/18/2006		
DRAWN BY: N. AHMAD		LAWRENCE T. TAI, P.E. COUNTY TRAFFIC ENGINEER		
CAD FILE: PORRAS.DGN				
COUNTY AREA: WILDOMAR				
COUNTY MAP: 78				
SUPERVISOR DISTRICT 1				

LEGEND:

- ////// CITY LIMITS
- ▬ RADAR ZONE
- - - - RADAR SURVEY STATION
- ▬▬▬ OTHER STREET OR ROAD



NO SCALE

SOBOBA STREET
(#1024)

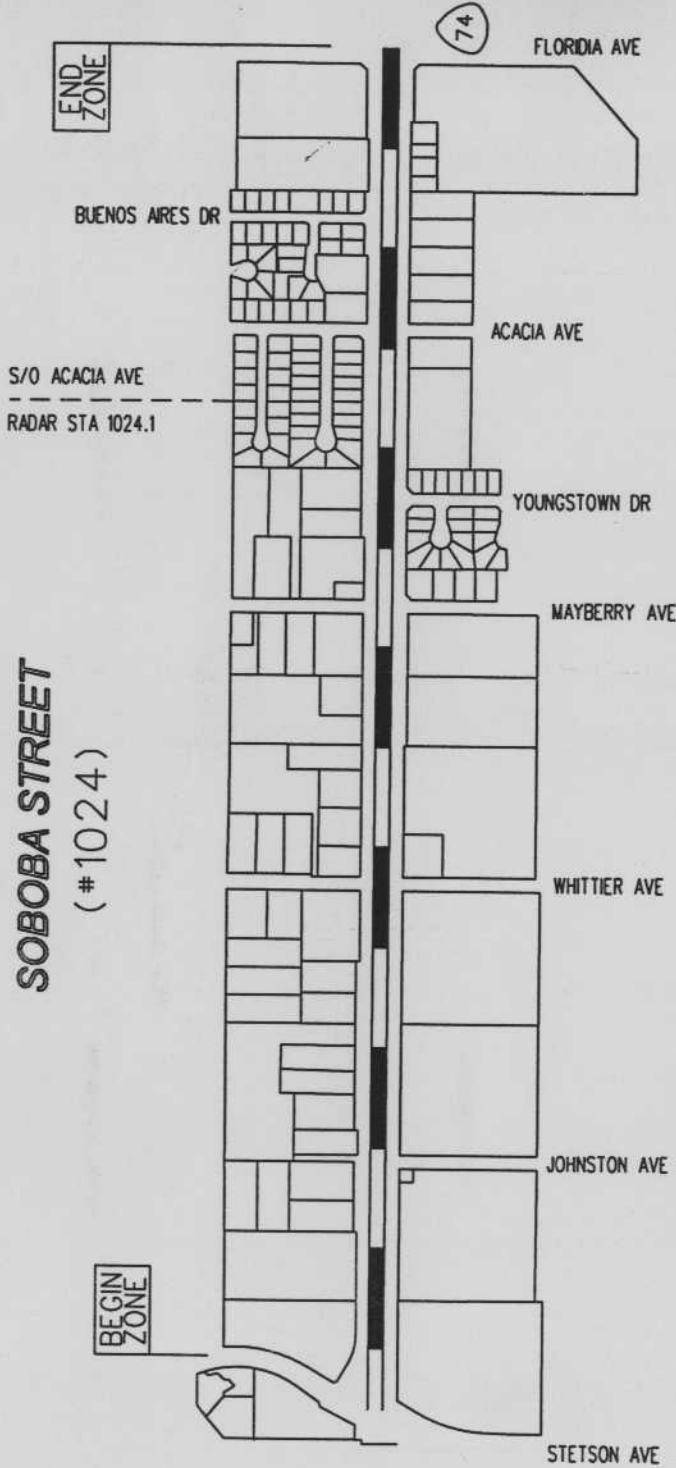

RECOMMENDED SPEED LIMIT	HIGH ACCIDENT RATE
PREVAILING SPEED (85%)	40 MPH
VEHICLES IN 24 HR (2 WAY)	43.5 MPH
SEGMENT LENGTH	5760
ALL ACCIDENTS IN 2 YRS.	1.2 MI
ACCIDENT RATE ☆	17
EXISTING SPEED LIMIT	3.37 MVM
	45 MPH

☆ RATE = $\frac{\text{ACCIDENT} \times 1000000}{\text{VEH} \times 365 \times 2 \times \text{MILE}}$

COUNTY AREA: HEMET

COUNTY MAP: 112

SUPERVISOR DISTRICT: 3

APPROVED BY:

Lawrence T. Tai
DATE: 7/18/2006

LAWRENCE T. TAI, P.E.
COUNTY TRAFFIC ENGINEER

SURVEY DATE: JUN 6 2006

MAP DATE: JUN 20 2006

DRAWN BY: N AHMAD

CAD FILE: SOBOBA.DGN

COUNTY OF RIVERSIDE
TRANSPORTATION DEPARTMENT
TRAFFIC AND SAFETY SECTION

ENGINEERING AND TRAFFIC SURVEY
AT

SOBOBA STREET



LEGEND:

- ////// CITY/COUNTY LIMITS
- ▬ RADAR ZONE
- - - - RADAR SURVEY STATION
- ==== OTHER STREET OR ROAD

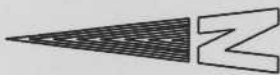

NO SCALE

54TH STREET
(# 1433)

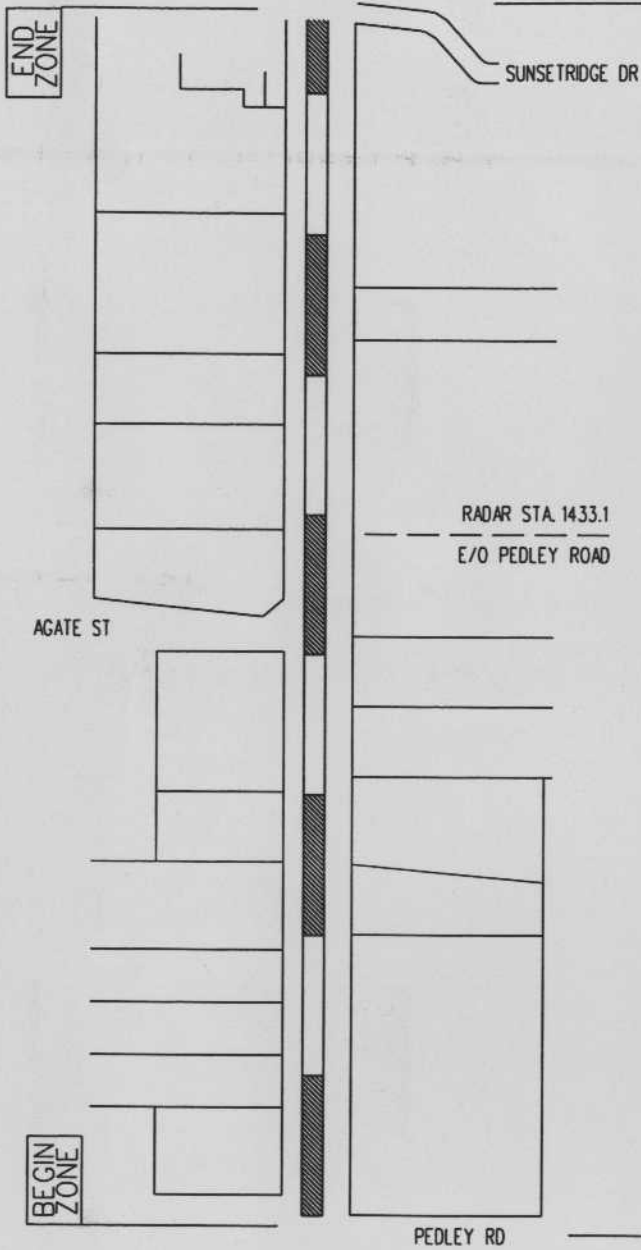

RECOMMENDED SPEED LIMIT	RESIDENTIAL AREA	40 MPH
PREVAILING SPEED (85%)		45 MPH
VEHICLES IN 24 HR (2 WAY)		895
SEGMENT LENGTH		.57 MI
ALL ACCIDENTS IN 2 YRS.		0
ACCIDENT RATE ☆		0 MVM
EXISTING SPEED LIMIT		NOT POSTED

☆ RATE: $\frac{\text{ACCIDENT} \times 1,000,000}{\text{VEH} \times 365 \times 2 \times \text{MILE}}$

COUNTY AREA: GLEN AVON
 COUNTY MAP: 9
 SUPERVISOR DISTRICT 2

SURVEY DATE: MAY 31, 2006
 MAP DATE: AUG 14, 2006
 DRAWN BY: N AHMAD
 CAD FILE: 54TH.DGN

APPROVED BY: *Lawrence T. Tai*
 DATE: 8/21/2006
 LAWRENCE T. TAI, P.E.
 COUNTY TRAFFIC ENGINEER

COUNTY OF RIVERSIDE
 TRANSPORTATION DEPARTMENT
 TRAFFIC ENGINEERING SECTION
 ENGINEERING AND TRAFFIC SURVEY
 AT
 54TH STREET

SUBMITTAL TO THE BOARD OF SUPERVISORS
COUNTY OF RIVERSIDE, STATE OF CALIFORNIA

209



FROM: TLMA - Transportation Department

SUBMITTAL DATE:
September 25, 2006

SUBJECT: Ordinance No. 452.223 to establish speed zones enforceable by radar speed detection equipment – El Cerrito, Wildomar, Glen Avon, Hemet, Palm Desert, Desert Hot Springs, and Cherry Valley areas

RECOMMENDED MOTION: That the Board introduce Ordinance No. 452.223, amending Ordinance No. 452 relating to prima facie speed limits to establish various speed zones in the above-referenced areas of Riverside County.

BACKGROUND: Transportation Department staff has conducted Engineering and Traffic Surveys (E&TS) for various roads in the subject areas, as required by the California Vehicle Code.

Based upon the results of the E&TS for these roads, the radar-enforceable speed limits recommended by the Department are summarized in the attached tables.

It is recommended that the Board adopt this amendment at the next regularly scheduled meeting.

County Counsel has approved the ordinance amendment.

Transportation Department staff has contacted the Riverside, Temecula, Indio, and San Geronio Pass Area offices of the California Highway Patrol regarding the proposed speed zones.

LTT:bjl
attachments

cc: County Counsel
Lawrence Tai

REVIEWED BY EXECUTIVE OFFICE
Nancy M. Chubb
DATE 9/25/06

George A. Johnson
Director of Transportation

MINUTES OF THE BOARD OF SUPERVISORS

On motion of Supervisor Buster, seconded by Supervisor Wilson and duly carried by unanimous vote, IT WAS ORDERED that the above ordinance is approved as introduced with waiver of reading.

Ayes: Buster, Tavaglione, Stone, Wilson and Ashley
Nays: None
Absent: None
Date: October 3, 2006
xc: Transp., COB

Nancy Romero
Clerk of the Board
By:
Deputy

Dep't Recomm.: Consent Policy
Per Exec. Ofc.: Consent Policy

Prev. Agn. Ref.:

District: ALL

Agenda Number:

3.25

**LIST OF SPEED ZONE SUBMITTALS
SUPERVISORIAL DISTRICT NO. 1**

AREA	ROAD NAME/ LIMITS	EXISTING SPEED LIMIT	PROPOSED SPEED LIMIT	NOTES
El Cerrito	Knabe Road Hunt Road to Clay Canyon Drive	Not Posted	45 mph	Allowable maximum speed limit is 65 mph (multi-lane highways)
Wildomar	Porras Road La Estrella to Baxter Road	Not Posted	40 mph	Allowable maximum speed limit is 55 mph (2-lane undivided roadways).

**LIST OF SPEED ZONE SUBMITTALS
SUPERVISORIAL DISTRICT NO. 2**

AREA	ROAD NAME/ LIMITS	EXISTING SPEED LIMIT	PROPOSED SPEED LIMIT	NOTES
Glen Avon	Agate Street Jurupa Road to 54 th Street	Not Posted	30	Allowable maximum speed limit is 55 mph (2-lane undivided roadways).
Glen Avon	54 th Street Pedley Road to Sunset Ridge Drive	Not Posted	40 mph	Allowable maximum speed limit is 55 mph (2-lane undivided roadways).

**LIST OF SPEED ZONE SUBMITTALS
SUPERVISORIAL DISTRICT NO. 3**

AREA	ROAD NAME/ LIMITS	EXISTING SPEED LIMIT	PROPOSED SPEED LIMIT	NOTES
Hemet	Soboba Street Stetson Avenue to Florida Avenue	45 mph	40 mph	Allowable maximum speed limit is 55 mph (2-lane undivided roadways).

F:\PCDATA\Traffic\ORDINANCE\PREVIEWS\223.doc
9/18/2006

**LIST OF SPEED ZONE SUBMITTALS
SUPERVISORIAL DISTRICT NO. 4**

AREA	ROAD NAME/ LIMITS	EXISTING SPEED LIMIT	PROPOSED SPEED LIMIT	NOTES
Palm Desert	Cat Canyon Road Cahuilla Way to Cholla Way	35 mph	35 mph	Correct discrepancies in existing records.
Palm Desert	Cholla Way Cat Canyon Road to .5 miles westerly	35 mph	35 mph	Correct discrepancies in existing records

F:\PCDATA\Traffic\ORDINANCE\PREVIEWS\223.doc
9/18/2006

**LIST OF SPEED ZONE SUBMITTALS
SUPERVISORIAL DISTRICT NO. 5**

AREA	ROAD NAME/ LIMITS	EXISTING SPEED LIMIT	PROPOSED SPEED LIMIT	NOTES
Desert Hot Springs	Mission Lakes Boulevard Indian Avenue to Little Morongo Road	Not Posted	50 mph	Allowable maximum speed limit is 55 mph (2-lane undivided roadways).
Cherry Valley	Brookside Avenue I-10 to Union Street	Not Posted	50 mph	Allowable maximum speed limit is 55 mph (2-lane undivided roadways).
Cherry Valley	Brookside Avenue Union Street to Highland Springs Avenue	40 mph	40 mph	Change in Speed Zone Boundary