

SUBMITTAL TO THE BOARD OF SUPERVISORS
COUNTY OF RIVERSIDE, STATE OF CALIFORNIA

111 B



FROM: TLMA – Transportation Dept.

SUBMITTAL DATE:
January 12, 2007

SUBJECT: Plot Plan 20103

A Subdivision in the Perris Area

SUBDIVISION IMPROVEMENT AGREEMENTS

RECOMMENDED MOTION: That the Board approve the attached Subdivision Improvement Agreements as approved by County Council.

BACKGROUND: The developer desires to enter into Improvement Agreements to guarantee the construction of the required improvements and has submitted Improvement Agreements and Securities which have been approved by County Council.

REVIEWED BY EXECUTIVE OFFICE

DATE 1/16/07 JMS

Departmental Concurrence

Juan C. Perez
Deputy Director of Transportation

George A. Johnson
Director of Transportation

HS:lf

Submittals: Vicinity Map
Road/Drainage Imprvmt Agrmts
Water System Imprvmt Agrmts
Sewer System Imprvmt Agrmts

- Consent
- Policy
- Consent
- Policy

Dept't Recomm.:

Per Exec. Ofc.:

Prev. Agn. Ref.:

District: 1

Agenda Number:



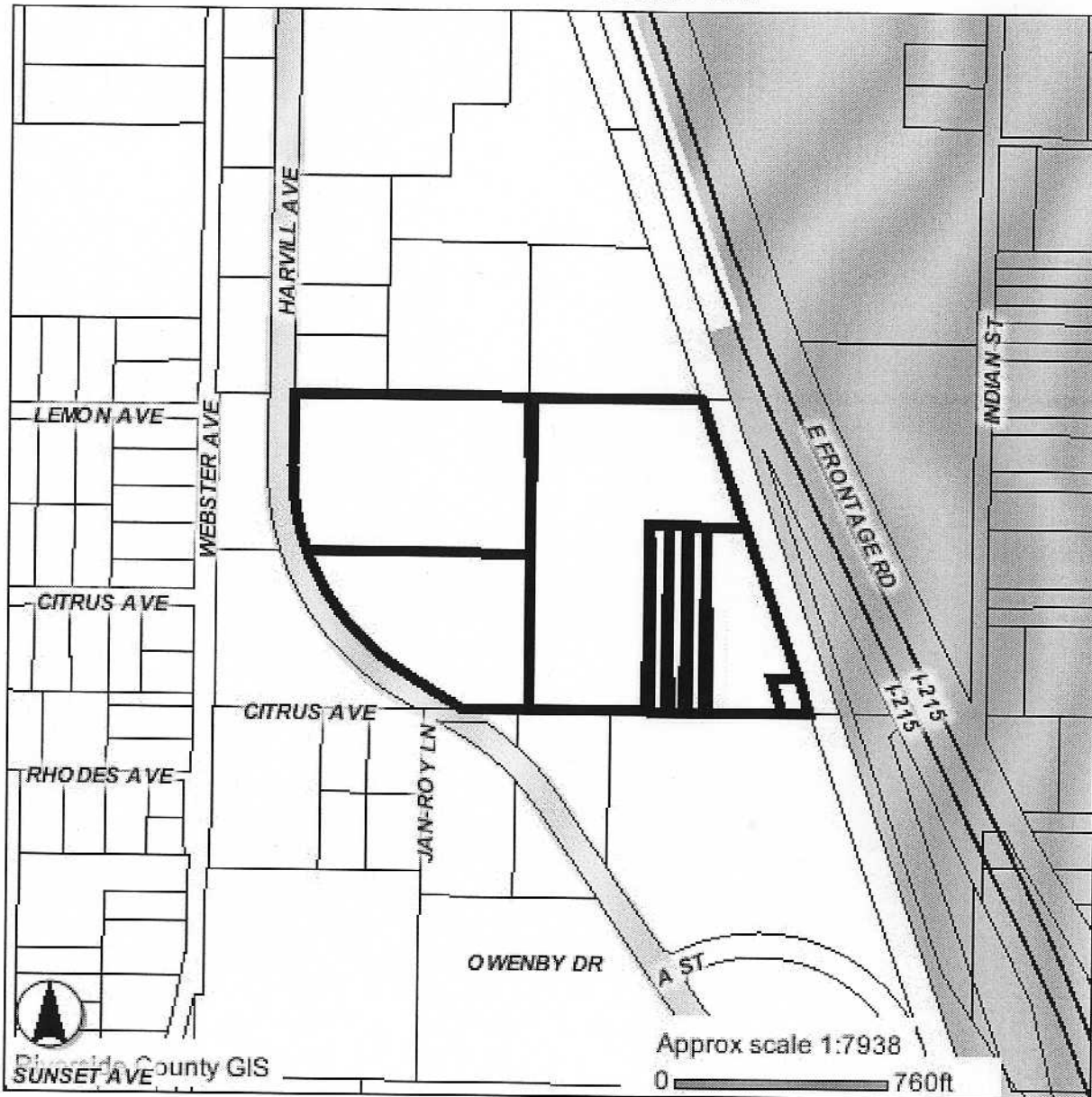

5083 744 18 AM 8:33
COUNTY OF RIVERSIDE
CLERK OF THE BOARD

PLOT PLAN 20103 - VICINITY MAP



Selected parcel(s):
 305-170-004 305-170-005 305-170-006 305-170-007 305-170-008 305-170-026 305-170-027
 305-170-028

LEGEND

-  SELECTED PARCEL
-  HIGHWAYS
-  PARCELS
-  CIRCULATION ELEMENT
ULTIMATE RIGHT-OF-WAY
(APPROX)
-  CITIES

IMPORTANT
 This information is made available through the Riverside County Geographic Information System. The information is for reference purposes only. It is intended to be used as base level information only and is not intended to replace any recorded documents or other public records. Contact appropriate County Department or Agency if necessary. Reference to recorded documents and public records may be necessary and is advisable.

MAP PRINTED ON...12/28/2006