

**SUBMITTAL TO THE BOARD OF SUPERVISORS  
COUNTY OF RIVERSIDE, STATE OF CALIFORNIA**

484A



**FROM:** TLMA - Transportation Dept.

**SUBMITTAL DATE:**  
February 16, 2007

**SUBJECT:** Construction of Traffic Signal and Lighting, Cajalco Road and Harley John Road / Smith Road, and Widening and Reconstruction of Cajalco Road, from Harley John Road to 1,650 Feet East of Gustin Road, Lake Mathews area

**RECOMMENDED MOTION:** That the Board accept the low bid of Beador Construction Company, Inc. of Corona, CA in the amount of \$1,380,186. Award the contract to that firm and authorize the Chairman of the Board to execute the contract documents. Amend the Transportation Improvement Program's project budget as proposed on Attachment "A".

**BACKGROUND:** By Minute Order dated December 12, 2006 (agenda item 3.31) the Board authorized the Clerk of the Board to advertise for the construction of the widening and reconstruction of Cajalco Road, from Harley John Road to 1,650 feet East of Gustin Road, as a combined project with the traffic signal and lighting to be constructed at the intersection of Cajalco Road and Harley John Road, in the Lake Mathews area of Riverside County.

*George A. Johnson*

George A. Johnson  
Director of Transportation

GAJ:sd

(Continued On Attached Page)

<b>FINANCIAL DATA</b>	Current F.Y. Total Cost:	\$ 1,380,186	In Current Year Budget:	Yes
	Current F.Y. Net County Cost:	\$ 0.00	Budget Adjustment:	No
	Annual Net County Cost:	\$ 0.00	For Fiscal Year:	2006/2007
<b>SOURCE OF FUNDS:</b> Gas Tax, West County DIF Signal Mitigation Fund, Measure A, Western Municipal Water District				Positions To Be Deleted Per A-30 <input type="checkbox"/>
				Requires 4/5 Vote <input type="checkbox"/>

**C.E.O. RECOMMENDATION:** **APPROVE**

**County Executive Office Signature**

*Steve Quade*

Policy

Policy

Consent

Consent

Dep't Recomm.:

Per Exec. Ofc.:

Prev. Agn. Ref. 12/12/2006 (3.31)

District: 1

Agenda Number:

ATTACHMENTS FILED

WITH THE CLERK OF THE BOARD

3.80

The Honorable Board of Supervisors

RE: Construction of Traffic Signal and Lighting, Cajalco Road and Harley John Road / Smith Road, and Widening and Reconstruction of Cajalco Road, from Harley John Road to 1,650 Feet East of Gustin Road, Lake Mathews area

February 16, 2007

Page 2 of 2

The project provides for the reconstruction and widening of Cajalco Road, from Harley John Road to 1,650 feet East of Gustin Road. Within the project limits, which is a curved section of Cajalco Road, there are side streets, a fire station and commercial businesses which generate significant turning movements. The project includes the installation of a two-way turn lane as a safety improvement for left turning vehicles.

The project also provides for the construction of a traffic signal, lighting and associated intersection widening at the intersection of Cajalco Road and Harley John Road / Smith Road. The location meets the established warrants for the installation of a traffic signal, which will improve intersection operation and safety. The traffic signal will replace existing four-way stop control.

The bid documents included an alternate bid schedule for the relocation of conflicting utilities that are owned by the Western Municipal Water District. The water district has provided their concurrence to award their items of work, for which they will be financially responsible on a deposit basis. Construction of the utility relocation by the County's contractor will improve construction coordination and potentially reduce the inconvenience to the public.

Bids for the project were opened in the office of the Director of Transportation at 2:00 pm, Wednesday, January 3, 2007. Two responsive bids were received. The lowest and best bid was submitted by Beador Construction Company, Inc. in the amount of \$1,380,186 for all schedules of work. The bid is \$28,104 (2.0%) less than the Engineer's Estimate. The contractor is qualified.

Project nos. A9-0570 and B4-0520.

# Attachment "A"

Riverside County Transportation Department

Project: **Cajalco Road and Harley John/Smith Road (TRAFFIC SIGNAL AND LIGHTING PROJECT)**

Project No.(s): **B4-0520**

### Project Costs and Budget

Activity	Incurred Costs	Projected Costs	Total Costs	Existing Budget	Proposed Budget
Preliminary Survey	2,463	537	3,000	2,000	3,000
Environmental	20,608	392	21,000	20,000	21,000
Design	44,414	586	45,000	36,000	45,000
Right-of-way	1,352	648	2,000	10,000	2,000
Utilities	6,315	685	7,000	15,000	7,000
Construction		353,786	353,786		
Construction Contingency 10.0%		35,379	35,379	350,000	389,000
Signal Pole Equipment	34,806		28,092		28,092
Construction Engineering & Inspection 10.0%	7,933	27,446	35,379	35,000	35,000
Construction Survey 5.0%		17,689	17,689	10,000	18,000
<b>Totals:</b>	<b>117,891</b>	<b>437,148</b>	<b>548,325</b>	<b>478,000</b>	<b>548,092</b>

### Project Funding

Code	Name	Existing Budget	Proposed Budget
369	West County DIF Signal Mitigation Fund	478,000	548,092
844	Western Municipal Water District		8,930
<b>Totals</b>		<b>478,000</b>	<b>557,022</b>

### Comments

# Attachment "A"

Riverside County Transportation Department

Project: **Cajalco Road: Harley John/Smith to 1650' east of Gustin Road**

Project No.(s): **A9-0570**

### Project Costs and Budget

Activity	Incurred Costs	Projected Costs	Total Costs	Existing Budget	Proposed Budget
Preliminary Survey	58,430		58,430	55,000	58,000
Environmental	13,262		13,262	15,000	13,000
Design	142,605		142,605	122,000	143,000
Right-of-way	4,292		4,292	13,000	4,000
Utilities	5,322		5,322	3,000	5,000
Construction	1,782	1,026,400	1,028,182	1,131,100	1,131,000
Construction Contingency	10.0%	102,640	102,640		
Construction Engineering & Inspection	14.0%	2,388	141,308	50,000	144,000
Construction Survey	7.0%	2,710	69,138	21,000	72,000
<b>Totals:</b>		<b>230,791</b>	<b>1,339,486</b>	<b>1,570,277</b>	<b>1,410,100</b>

### Project Funding

Code	Name	Existing Budget	Proposed Budget
201	Proposition 111 (gas tax)	150,000	150,000
300	Measure A/ Western	1,260,000	1,420,000
<b>Totals</b>		<b>1,410,000</b>	<b>1,570,000</b>

### Comments

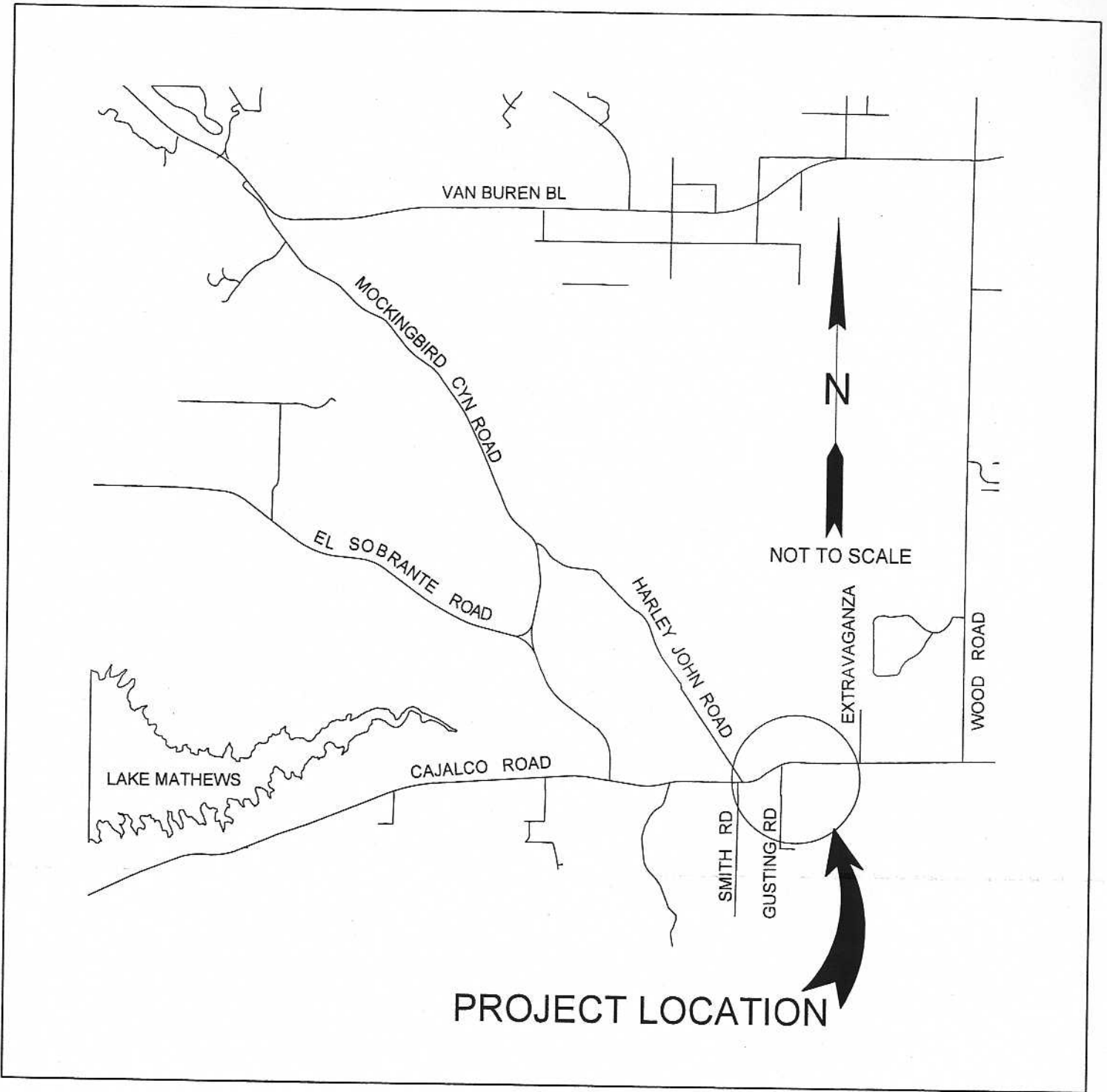

VICINITY MAP

T.4 S., R.5 W., SEC 12

**EL SOBRANTE AREA**