

SUBMITTAL TO THE BOARD OF SUPERVISORS  
COUNTY OF RIVERSIDE, STATE OF CALIFORNIA

644 B



FROM: TLMA – Transportation Dept.

SUBMITTAL DATE:  
MARCH 05, 2007

SUBJECT: Approval of **PARCEL MAP 31081**  
A Schedule "E" Subdivision in the Glen Avon Area

**RECOMMENDED MOTION:** That the Board approve the Improvement Agreements and Securities as approved by County Counsel, approve the final map and authorize the Chairman to sign the Improvement Agreements and map for Parcel Map 31081.

**BACKGROUND:** This map complies in all respects with the provisions of Division 3 of Title 15 of the Government Code and applicable local ordinances. The developer desires to enter into Improvement Agreements to guarantee the construction of the required improvements and has submitted Improvement Agreements and Securities which have been approved by County Counsel.

REVIEWED BY EXECUTIVE OFFICE

DATE 3/9/07 gmy

Departmental Concurrence

HS:lf  
Submittals: Final Map  
Road/Drainage Imprvmt Agrmts  
Water System Imprvmt Agrmts  
Sewer System Imprvmt Agrmts  
Survey Monument Agreements

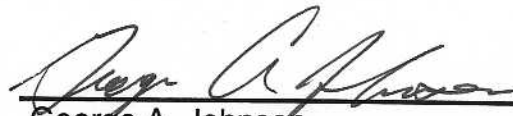
  
George A. Johnson  
Director of Transportation

Consent     Policy  
 Consent     Policy

Dept's Recomm.:  
Per Exec. Ofc.:

Prev. Agn. Ref.:

District: 2

Agenda Number:

ATTACHMENTS FILED  
WITH THE CLERK OF THE BOARD

2.38

# VICINITY MAP

## PM 31081

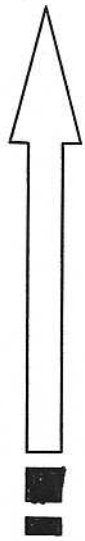

**N**  
N.T.S

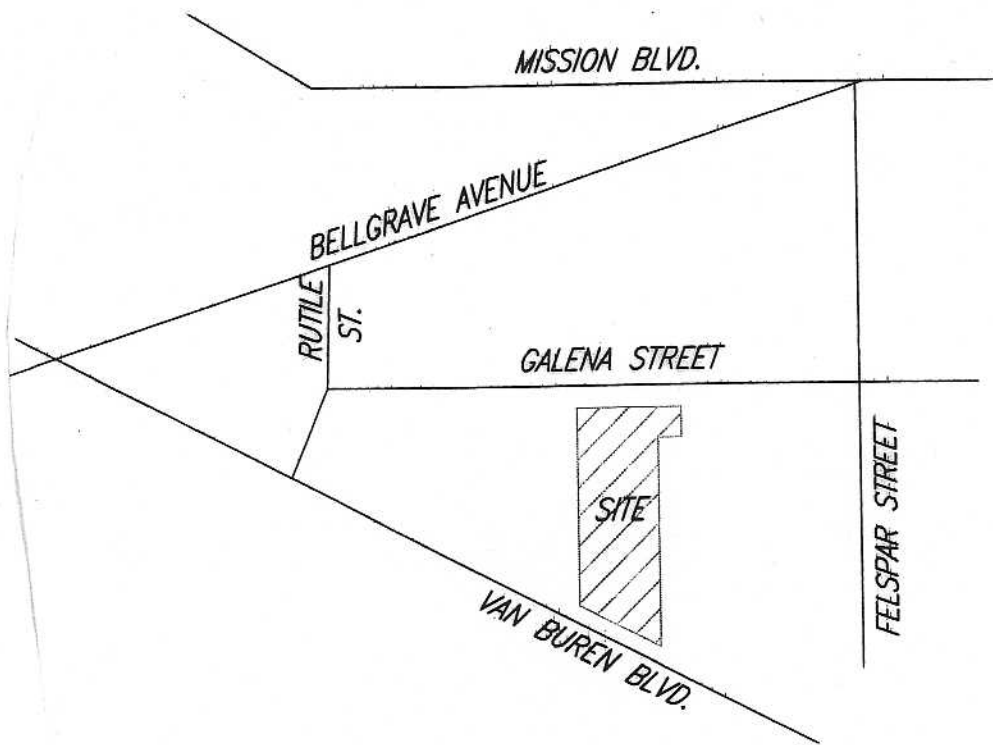

VICINITY MAP  
NTS