

**SUBMITTAL TO THE BOARD OF SUPERVISORS
COUNTY OF RIVERSIDE, STATE OF CALIFORNIA**

739 A



FROM: TLMA - Transportation Dept.

SUBMITTAL DATE:
July 9, 2007

SUBJECT: Construction of Median Island Hard-scape Using River Rock, Limonite Avenue, Baldwin Avenue to 510 Feet East of Clay Street, Indian Hills area

RECOMMENDED MOTION: That the Board of Supervisors approve the plans and specifications for the construction of median island hard-scape using river rock on Limonite Avenue, from Baldwin Avenue to 510 feet east of Clay Street in the Indian Hills area of Riverside County. Authorize the Clerk to advertise for bids to be received in the office of the Director of Transportation up to the hour of 2:00 pm, Wednesday, August 8, 2007, at which time bids will be opened.

BACKGROUND: The Limonite Avenue median within the subject limits was improved with landscaping and hard-scaping under a contract administered by the Economic Development Agency in 2000. The improvements are maintained under Landscaping and Lighting Maintenance District No. 89-1-Consolidated, Zone 4. The Transportation Department has been requested by EDA to administer the construction of hard-scape modifications of the median between Baldwin Avenue and 510 feet easterly of Clay Street to replace large areas of decomposed granite with river rock hard-scaping in order to control

Juan C. Perez
Deputy Director of Transportation

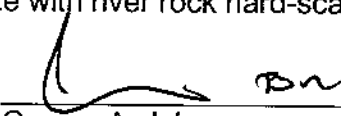
George A. Johnson
Director of Transportation

GAJ:sd

(Continued On Attached Page)

FINANCIAL DATA	Current F.Y. Total Cost:	\$ 300,000	In Current Year Budget:	Yes
	Current F.Y. Net County Cost:	\$ 0	Budget Adjustment:	No
	Annual Net County Cost:	\$ 0	For Fiscal Year:	2007/2008
SOURCE OF FUNDS: EDA (100%)				Positions To Be Deleted Per A-30 <input type="checkbox"/>
				Requires 4/5 Vote <input type="checkbox"/>

C.E.O. RECOMMENDATION:

APPROVE

BY 
Tina Grande

County Executive Office Signature

Policy Policy

Consent Consent

Dep't Recomm.:
Per Exec. Ofc.:

Prev. Agn. Ref.

District: 2

Agenda Number:

**ATTACHMENTS FILED
WITH THE CLERK OF THE BOARD**

3.109

COUNTY COUNSEL

JUL 10 2007
BY 
Marsha L. Victor
Departmental Concurrence

The Honorable Board of Supervisors

RE: Construction of Median Island Hard-scape Using River Rock, Limonite Avenue, Baldwin Avenue to 510 Feet East of Clay Street, Indian Hills area

July 9, 2007

Page 2 of 2

erosion and to provide visual consistency with existing median island treatment east of Camino Real.

The submitted plans and specifications have been approved as to form by County Counsel. Environmental clearance is complete.

Project No. ZEDA0001



Limonite Median - River Rock Project
Baldwin Ave to Camino Real
Phases 1, 2 & 3



A KESIDE DR

BALDWIN AVE

LIMONITE AV

CLAY ST

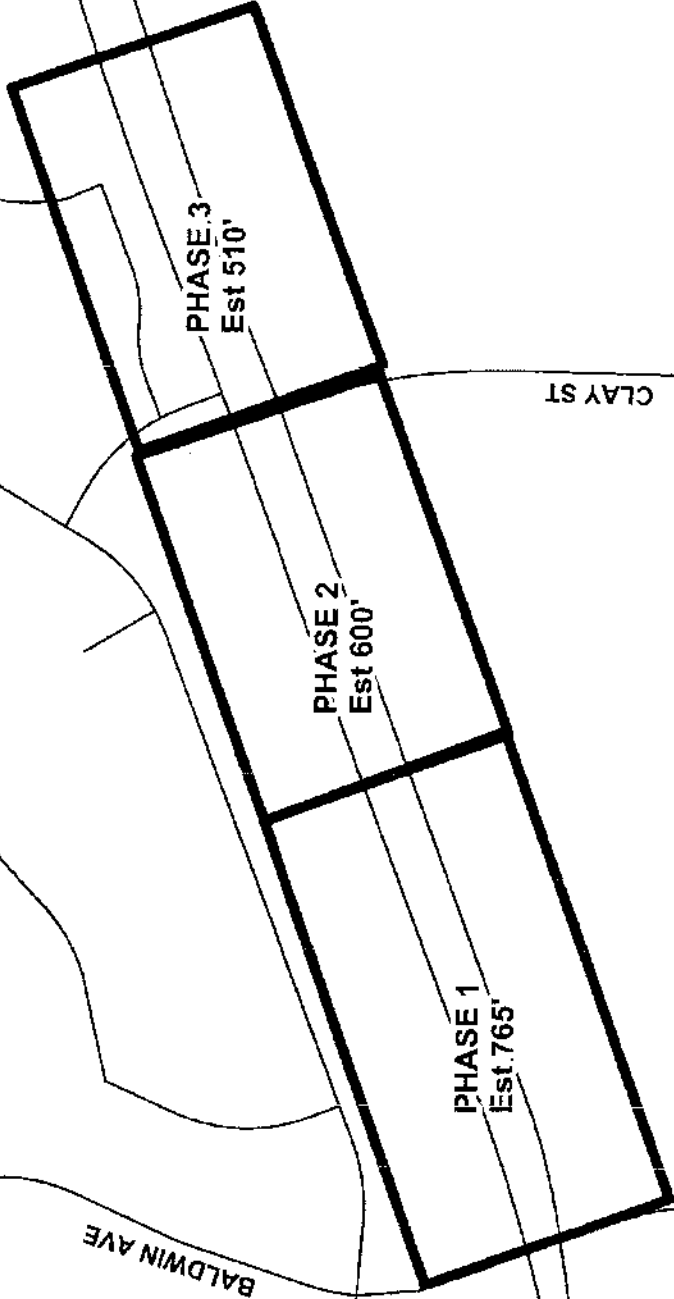

The County of Riverside assumes no warranty or legal responsibility for the information contained on this map. Data and information represented on this map is subject to updates, modifications and may not be complete or appropriate for all purposes. County GIS and other sources should be queried for the most current information. Do not copy or resell this map.