

**SUBMITTAL TO THE BOARD OF SUPERVISORS  
COUNTY OF RIVERSIDE, STATE OF CALIFORNIA**

871A



**FROM:** TLMA - Transportation Dept.

**SUBMITTAL DATE:**  
July 24, 2007

**SUBJECT:** Landscaping and Lighting Maintenance District No. 89-1-Consolidated,  
Annexation of Zone 90

**RECOMMENDED MOTION:** That the Board:

1. Adopt resolution No. 2007-372, Resolution of the County of Riverside confirming the diagram and assessment of Zone 90 of Landscaping and Lighting Maintenance District No. 89-1-Consolidated, and levying assessments on all assessable lots and parcels of land therein for fiscal year 2007/08.
2. Direct the Auditor-Controller's office to establish an interest-bearing sub-fund 20300 to receive deposits and interest thereon from Zone 90 of Landscaping and Lighting Maintenance District No. 89-1-Consolidated; in accordance with Section 22655-22656 of the Streets and Highways Code.

FORM APPROVED  
COUNTY COUNSEL

JUL 24 2007

Departmental Concurrence

Dale A. Gardner

*George A. Johnson*

George A. Johnson  
Director of Transportation

JW:jp

(continued on next page)

<b>FINANCIAL DATA</b>	Current F.Y. Total Cost:	\$0.00	In Current Year Budget:	No
	Current F.Y. Net County Cost:	\$0.00	Budget Adjustment:	No
	Annual Net County Cost:	\$0.00	For Fiscal Year:	2007-08
<b>SOURCE OF FUNDS:</b>	Landscaping and Lighting Maintenance District No. 89-1-Consolidated – 100%			Positions To Be Deleted Per A-30 <input type="checkbox"/>
				Requires 4/5 Vote <input type="checkbox"/>

**C.E.O. RECOMMENDATION:**

**APPROVE**

BY *Tina Grande*  
Tina Grande

County Executive Office Signature

Policy

Consent

Dep't Recomm.:  
Per Exec. Ofc.:

Prev. Agn. Ref.

District: 1

Agenda Number:

**3.134**

The Honorable Board of Supervisors

RE: Landscaping and Lighting Maintenance District No. 89-1-Consolidated, Annexation  
of Zone 90

July 24, 2007

Page 2 of 2

**BACKGROUND:** On July 17, 2007, a public hearing was held to receive all testimony regarding the annexation of Zone 90 to Landscaping and Lighting Maintenance District No. 89-1-Consolidated (L&LMD No. 89-1-C"). After closing the public hearing, the Board directed the Director of Transportation, or his/her designee, to tally the assessment ballots that had been received prior to the close of the hearing. The assessment ballots were to be tabulated on July 18, 2007 at 10:00 a.m. in Conference Room B on the 8<sup>th</sup> Floor of the County Administrative Center. The tabulation shows that votes representing 101 parcels out of a possible 101 were cast, and that 101 votes (or 100%) were cast in favor of the annexation of Zone 90 to L&LMD No. 89-1-C and the levy and enrollment of the special assessment.

The proposed budget for fiscal year 2007/08 for Zone 90 is \$27,598.00 that will result in an assessment for fiscal year 2007/08 within Zone 90 of \$273.24 per parcel. Zone 90 includes 101 single-family residential lots. The annual assessment will be adjusted annually by the greater of 2% or the cumulative percentage increase in the CPI-U, if any, as it stands as of March of each year over the base index for March of 2007.

Adoption of Resolution No. 2007-372 confirms the assessment levy as indicated in the Engineer's Report for fiscal year 2007/08 for Zone 90 of L&LMD No. 89-1-C and orders the placement of the annual assessment on the County's Assessment Roll for fiscal year 2007/08.

2 RESOLUTION NO. 2007-372

3  
4 **RESOLUTION OF THE BOARD OF SUPERVISORS OF THE COUNTY OF RIVERSIDE ORDERING**  
5 **THE ANNEXATION OF ZONE 90 TO LANDSCAPING AND LIGHTING MAINTENANCE DISTRICT**  
6 **NO. 89-1-CONSOLIDATED OF THE COUNTY OF RIVERSIDE AND CONFIRMING THE DIAGRAM**  
7 **AND ASSESSMENT FOR ZONE 90 OF LANDSCAPING AND LIGHTING MAINTENANCE**  
8 **DISTRICT NO. 89-1-CONSOLIDATED AND LEVYING ASSESSMENTS ON ALL ASSESSABLE**  
9 **LOTS AND PARCELS OF LAND THEREIN FOR THE FISCAL YEAR 2007/08**

10 **WHEREAS**, on May 15, 2007 the Board of Supervisors (hereinafter the "Board of Supervisors")  
11 of the County of Riverside (hereinafter the "County") adopted Resolution No. 2007-215, pursuant to  
12 Section 22608 and Section 22585 et seq. of the Streets and Highways Code, declaring the intention of  
13 the Board of Supervisors to order the annexation of Zone 90 to Landscaping and Lighting  
14 Maintenance District No. 89-1-Consolidated (hereinafter "L&LMD No. 89-1-C") of the County pursuant  
15 to the Landscaping and Lighting Act of 1972, being Part 2 (commencing with Section 22500) of  
16 Division 15 of the Streets and Highways Code, and giving notice of and setting a public hearing for  
17 9:30 a.m. on July 17, 2007 at the meeting room of the Board of Supervisors and requiring that the  
18 notice of the public hearing and assessment ballots be mailed to all owners of property within Zone 90  
19 as shown on the equalized tax roll; and

20 **WHEREAS**, notice of said public hearing was duly published and mailed as required by  
21 Resolution No. 2007-215, Section 22626 of the Streets and Highways Code and Sections 53753 and  
22 54954.6 of the Government Code and the assessment ballots were timely mailed to all owners of  
23 property within said Zone 90 as shown on the equalized tax roll; and

24 **WHEREAS**, at 9:30 a.m. on July 17, 2007, as set forth in Resolution No. 2007-215, the Board  
25 of Supervisors held a public hearing and afforded all interested persons an opportunity to be heard,  
26 and considered all oral statements and all written protest or communications made or filed by any  
interested persons, closed the public hearing and directed the Director of Transportation, or his  
designee, as an impartial person having no vested interest in the annexation of Zone 90 to L&LMD No.

1 89-1-C as required by Section 53753(e) of the Government Code to tally the assessment ballots that  
2 had been received prior to the close of the public hearing; and

3 **WHEREAS**, the tally of the assessment ballots show that assessment ballots were timely  
4 received from the owner of 101 parcels out of a possible 101 parcels and that 101 parcels (100  
5 percent of the assessment ballots received) voted in favor of annexation of Zone 90 to L&LMD No.  
6 89-1-C and the levy of an annual assessment in said Zone 90 beginning fiscal year 2007/08; and

7 **WHEREAS**, the Board of Supervisors may proceed, pursuant to Section 22631 of the Streets  
8 and Highways Code, to adopt a resolution confirming the diagram and assessment, either as originally  
9 proposed, or as changed by the Board of Supervisors, and the adoption of such a resolution shall  
10 constitute the levy of an assessment on all assessable lots and parcels of land within Zone 90 of  
11 L&LMD No. 89-1-C beginning fiscal year 2007/08.

12 **NOW, THEREFOR, BE IT RESOLVED, FOUND, DETERMINED AND ORDERED** by the  
13 Board of Supervisors of the County in regular session on July 31, 2007 as follows:

14 **Section 1. Findings.** The Board of Supervisors finds:

- 15 (a) the proceeding recitals are correct;
- 16 (b) compliance has been had with all the requirements of the Landscaping and  
17 Lighting Act of 1972, being Part 2 (commencing with Section 22500) of Division  
18 15 of the Streets and Highways Code, and Sections 53753 and 54954.6 of the  
19 Government Code;
- 20 (c) a majority protest to the annexation of and annual assessment of Zone 90 of  
21 L&LMD No. 89-1-C has not been filed;
- 22 (d) the tally of the assessment ballots timely received was 100 percent voted in  
23 favor of the annexation of Zone 90 to L&LMD No. 89-1-C and the levy of an  
24 annual assessment beginning fiscal year 2007/08, and 0 percent voted no;
- 25 (e) the Board of Supervisors may proceed to adopt a resolution ordering the  
26 annexation of Zone 90 to L&LMD No. 89-1-C;

- 1 (f) the Board of Supervisors may proceed to adopt a resolution confirming the  
2 diagram and assessment for Zone 90 of L&LMD No. 89-1-C either as originally  
3 proposed or as changed by it; and
- 4 (g) the assessments to be levied on the assessable lots and parcels of land within  
5 Zone 90 of L&LMD No. 89-1-C for the installation, maintenance and servicing of  
6 landscaping, fencing, multi-purpose trail, and graffiti abatement improvements in  
7 said Zone 90 during the fiscal year 2007/08 as contained in the report of the  
8 Director of Transportation which is on file with the Clerk of the Board of  
9 Supervisors (hereinafter the "Report") are based on benefits derived by such  
10 lots and parcels from the availability of such landscaping, fencing, multi-purpose  
11 trail, and graffiti abatement improvements, and are not based upon the  
12 ownership of such lots and parcels.

13 **Section 2. Annexation.** Zone 90, as proposed to be annexed to L&LMD No.  
14 89-1-C, includes all the property subject to Tract Map No. 25122 in the County of Riverside, State of  
15 California as described in Exhibit "A" attached hereto, shall be and is annexed into L&LMD No. 89-1-C.

16 **Section 3. Improvements.** The improvements authorized for Zone 90 of L&LMD  
17 No. 89-1-C are:

- 18 (a) The maintenance and servicing of landscaping and multi-purpose trails within  
19 the public right-of-way including the trimming, fertilizing, weeding and replanting  
20 of trees, shrubs, grass, and other ornamental vegetation; and
- 21 (b) The maintenance and servicing of irrigation and electrical facilities associated  
22 with the landscaping, including but not limited to electricity for operation of the  
23 irrigation system and water for irrigation; and
- 24 (c) Providing graffiti abatement services to walls and structures with the public right-  
25 of-way including incidental costs and expenses.
- 26



**EXHIBIT "A"**

**DESCRIPTION OF BOUNDARIES**

The boundaries of Zone 90 to be annexed into Landscaping and Lighting Maintenance District No. 89-1-Consolidated, of the County of Riverside are coterminous with the boundaries of 101 parcel(s) as shown on Tract Map No. 25122 in the County of Riverside, State of California for fiscal year 2007/08.

1  
2  
3  
4  
5  
6  
7  
8  
9  
10  
11  
12  
13  
14  
15  
16  
17  
18  
19  
20  
21  
22  
23  
24

LANDSCAPING AND LIGHTING MAINTENANCE DISTRICT NO. 89-1-CONSOLIDATED  
**ZONE 90**

PORTION OF SECTION 2, T.7S., R.4W.  
TRACT MAP NO. 25122 - 101 PARCELS

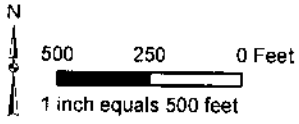



The County of Riverside assumes no warranty or legal responsibility for the information contained on this map. Data and information represented on this map is subject to updates, modifications and may not be complete or appropriate for all purposes. County GIS and other sources should be queried for the most current information. Do not copy or resell this map.

Printed by jpickeri on 5/30/07

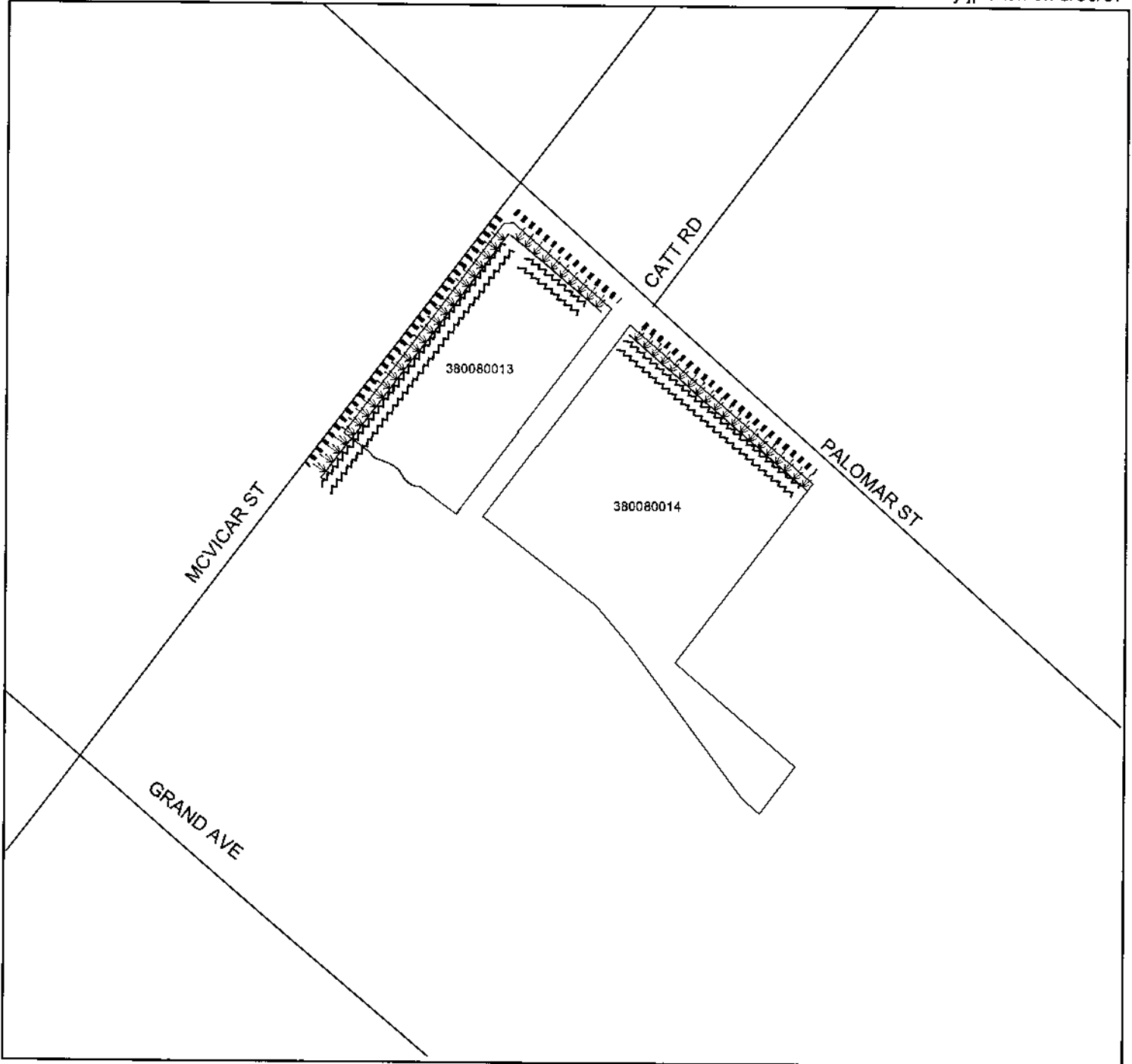
# ASSESSMENT DIAGRAM



-  DENOTES LANDSCAPED AND MAINTAINED PARKWAY
-  DENOTES MAINTAINED MULTI-PURPOSE TRAIL AND FENCE
-  DENOTES MAINTAINED GRAFFITI ABATEMENT