

**SUBMITTAL TO THE BOARD OF SUPERVISORS
COUNTY OF RIVERSIDE, STATE OF CALIFORNIA**

225B



FROM: TLMA - Planning Department

SUBMITTAL DATE:
September 10, 2007

SUBJECT: Adoption of Resolution No. 2007-333 – Diminishment of Eagle Valley Agricultural Preserve No. 1 – Agricultural Preserve Case and Map No. 984 – Applicant: Eagle Valley Development Co. and Arciero and Sons, Inc. – First Supervisorial District – Eagle Valley Zoning Area – Temescal Canyon Area Plan – 85.28 Acres (Gross)

RECOMMENDED MOTION: Adoption of Resolution No. 2007-333 for the diminishment of Eagle Valley Agricultural Preserve No. 1, Map No. 984, based upon the hereinafter listed findings and conclusions:

FINDINGS:

1. The 85.28-acre site is comprised of three (3) parcels which are located northerly of Cajalco Road, southerly of City limits of Riverside, east of City limits of Corona and westerly of Lakepointe Drive in the Temescal Canyon area of western Riverside County, California.
2. William T. Dinsmore, Jr., Clinton F. Loyd, and Helen D. Loyd entered into a land conservation contract with the County of Riverside for land within Eagle Valley Agricultural Preserve No. 1. The contract is dated January 1, 1971, and was recorded on February 26, 1971, as Instrument No. 19424 in the Office of the County Recorder of Riverside County, California.
3. Pursuant to the Land Conservation Act of 1965, Donald T. Dinsmore, Clinton F. Loyd, and Helen D. Loyd, the property owners of Assessor's Parcel No. (APN)140-050-002, 140-060-002 and 140-080-001, filed a notice of non-

Ron Goldman
 Ron Goldman (Damian Meins, Asst. Planning Director)
 Planning Director

RG:kb

(Continued On Attached Page)

REVIEWED BY EXECUTIVE OFFICE

DATE 9/15/07
 Tina Grande
 Departmental Concurrence

FORM APPROVED COUNTY COUNSEL
 BY: Michelle Clack DATE 9/15/07
 MICHELLE CLACK

Dep't Recomm.: Consent
 Per Exec. Ofc.: Consent
 Policy
 Policy

Prev. Agn. Ref. | District: First | Agenda Number:

RECEIVED RIVERSIDE COUNTY
 03 SEP 15 11:41 AM '07

3.63

renewal on September 7, 1982, which notice was recorded on September 14, 1982, as Instrument No. 158741, and, as a consequence, the land conservation contract as it applies to the subject parcels expired on January 1, 1992.

4. Under both the County's Rules and Regulations Governing Agricultural Preserves and the Comprehensive General Plan's Williamson Act Program (i.e., Land Conservation Act of 1965), a landowner may apply to have property removed from the boundaries of an agricultural preserve, once the contract has expired.
5. The land conservation contract having expired, Eagle Valley Development Company, the current property owner of APN 140-050-002 and 140-060-002, and Arciero and Sons Inc., the current property owner of APN 140-080-001, have now applied to have the property removed from the boundaries of the agricultural preserve.

CONCLUSION:

1. The diminishment of Eagle Valley Agricultural Preserve No. 1, Map No. 984, is consistent with the provisions of the Land Conservation Act of 1965 and the Rules and Regulations Governing Agricultural Preserves in Riverside County as adopted by the Board of Supervisors.
2. The diminishment of Eagle Valley Agricultural Preserve No. 1, Map No. 984, is consistent with the Riverside County General Plan.

RESOLUTION NO. 2007-333

DIMINISHMENT OF EAGLE VALLEY

AGRICULTURAL PRESERVE NO. 1

PURSUANT TO NOTICE OF NONRENEWAL

WHEREAS, William T. Dinsmore, Jr., Clinton F. Loyd and Helen D. Loyd entered into a Land Conservation Contract with the County of Riverside pursuant to the California Land Conservation Act of 1965 (Government Code Section 51200 et seq.), which contract is dated January 1, 1971, and was recorded February 26, 1971, as Instrument No. 19424, in the Office of the County Recorder of Riverside County, California; and

WHEREAS, Donald T. Dinsmore, as Trustee of the Dinsmore Family Trust, Clinton F. Loyd and Helen D. Loyd filed a Notice of Nonrenewal on September 7, 1982, which notice was recorded on September 14, 1982, as Instrument No. 158741, in the Office of the County Recorder of Riverside County, California;

WHEREAS, the filing of said Notice of Nonrenewal resulted in the expiration of the contract as it applies to the subject property on January 1, 1992, pursuant to Government Code Section 51245 and 51246;

BE IT RESOLVED, FOUND, DETERMINED AND ORDERED by the Board of Supervisors of the County of Riverside, State of California, in regular session assembled on September 18, 2007, that the Clerk of this Board shall file and record copies of this resolution, map and boundary description, in the Office of the County Recorder of Riverside County, California, with the Director of Conservation, State of California, and with the Office of the Assessor of Riverside County, California, and that:

1. Eagle Valley Agricultural Preserve No. 1, Map No. 14, dated February 10, 1969, and on file in the Office of the Clerk of this Board, is further amended by deleting therefrom the area shown on the map entitled "AGRICULTURAL PRESERVE MAP NO. 984: AMENDMENT NO. 2 (DIMINISHMENT) OF EAGLE VALLEY

1 AGRICULTURAL PRESERVE NO. 1" and described by boundary description
2 thereof, as fully set forth in the attached document entitled "EXHIBIT A, EAGLE
3 VALLEY AGRICULTURAL PRESERVE NO. 1, MAP NO. 984
4 (DIMINISHMENT)," said map and description both being on file in the Office of the
5 Clerk of the Board.

- 6 2. The Land Conservation Contract between William T. Dinsmore, Jr., Clinton F. Loyd,
7 Helen D. Loyd and the County of Riverside, dated January 1, 1971, and recorded on
8 February 26, 1971, as Instrument No. 19424, in the Office of the County Recorder of
9 Riverside County, California, and as said contract applies to the subject property, has
10 expired, removing from the effect of said contract the real property in the County of
11 Riverside, State of California, described in the attached document entitled "EXHIBIT
12 A, EAGLE VALLY AGRICULTURAL PRESERVE NO. 1, MAP NO. 984
13 (DIMINISHMENT)," which is made a part of this resolution.

14 BE IT FURTHER RESOLVED that the Clerk of this Board shall file and record copies of
15 this resolution, map and boundary description in the Office of the County Recorder of Riverside
16 County, California, with the Director of Conservation of the State of California, and with the Office
17 of the Assessor of Riverside County, California.

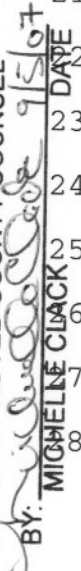
18
19
20
21
22
23
24
25
26
27
28
FORM APPROVED COUNTY COUNSEL
BY:  9/5/07
MICHIELLE CLACK
DATE

**EXHIBIT A
EAGLE VALLEY AGRICULTURAL PRESERVE NO. 1
MAP NO. 984
(DIMINISHMENT)**

The following described Real Property of Riverside County, State of California, described as follows:

Description:

Those portions of Sections 35 and 36 in Township 3 South, Range 6 West, as shown by Sectionized Survey of the Rancho El Sobrante de San Jacinto on file in Book 1 page 8 of Maps, San Bernardino County Records, more particularly described as follows:

Beginning at the East quarter section corner of said Section 35; thence North 00° 26' 45" West along the East line of said Section 35, 658.88 feet to the Northeast corner of Parcel 1, as shown on Record of Survey on file in Book 30 page 88 of Records of Survey, Riverside County Records, said point also being the Northeast corner of the South 400 acres of said Section 35; thence North 89° 53' 58" West along the North line of said Parcel 1 and along the North line of said South 400 acres, 1325.19 feet to the Northeast corner of Parcel 2, as shown by Record of Survey on file in Book 32 page 27 of Records of Survey, Riverside County Records; thence South 02° 18' West, 818.79 feet; thence South 43° 59' West, 676.87 feet; thence South 19° 21' 15" West, 273.36 feet; then South 45° 32' 30" West, 243.26 feet to Point "A" of this description; the last four courses and distances follow along the Easterly boundary line of said Parcel 2; thence North 75° 42' 45" East, 321.58 feet; thence South 86° 41' 00" East, 169.75 feet; thence South 70° 35' 15" East, 477.90 feet; thence South 87° 18' 45" East, 1203.72 feet; thence North 56° 02' 15" East, 990.35 feet thence North 00° 00' 45" West, 665.81 feet to a point on the East-West quarter Section line of said Section 36, said point also being on the North line of Parcel 2 as shown by Map on file in Book 30 page 88 of Records of Survey, Riverside county Records; thence South 89° 55' 45" West along said East-West quarter Section line and along the North line of said last mentioned Parcel 2, 858.03 feet to the point of beginning;

Excepting therefrom an easement for road purposes, 30 feet in width, lying adjacent to and Northerly of the following described line: Beginning at Point "A" of the here in above described parcel; thence North 75° 42' 45" East. 321.58 feet; thence South 86° 41' 00" East, 169.75 feet; thence South 70° 35' 15" East 477.90 feet; the Northerly line of said 30 foot easement shall be lengthened or shortened so as to terminate in the boundary lines of the hereinabove described parcel.

Assessor Parcel No.	Acres (net)	Owners
140-050-002	20.04	EAGLE VALLEY DEVELOPMENT CO
140-060-002	46.58	EAGLE VALLEY DEVELOPMENT CO
140-080-001	18.66	ARCIERO & SONS INC.
TOTAL	85.28	

~~918~~
984

MAP NO. 14 EAGLE VALLEY AGRICULTURAL PRESERVE NO. 1

AMENDED BY MAP NO. 918

T. 3S., R. 6W. S.B.B. & M.

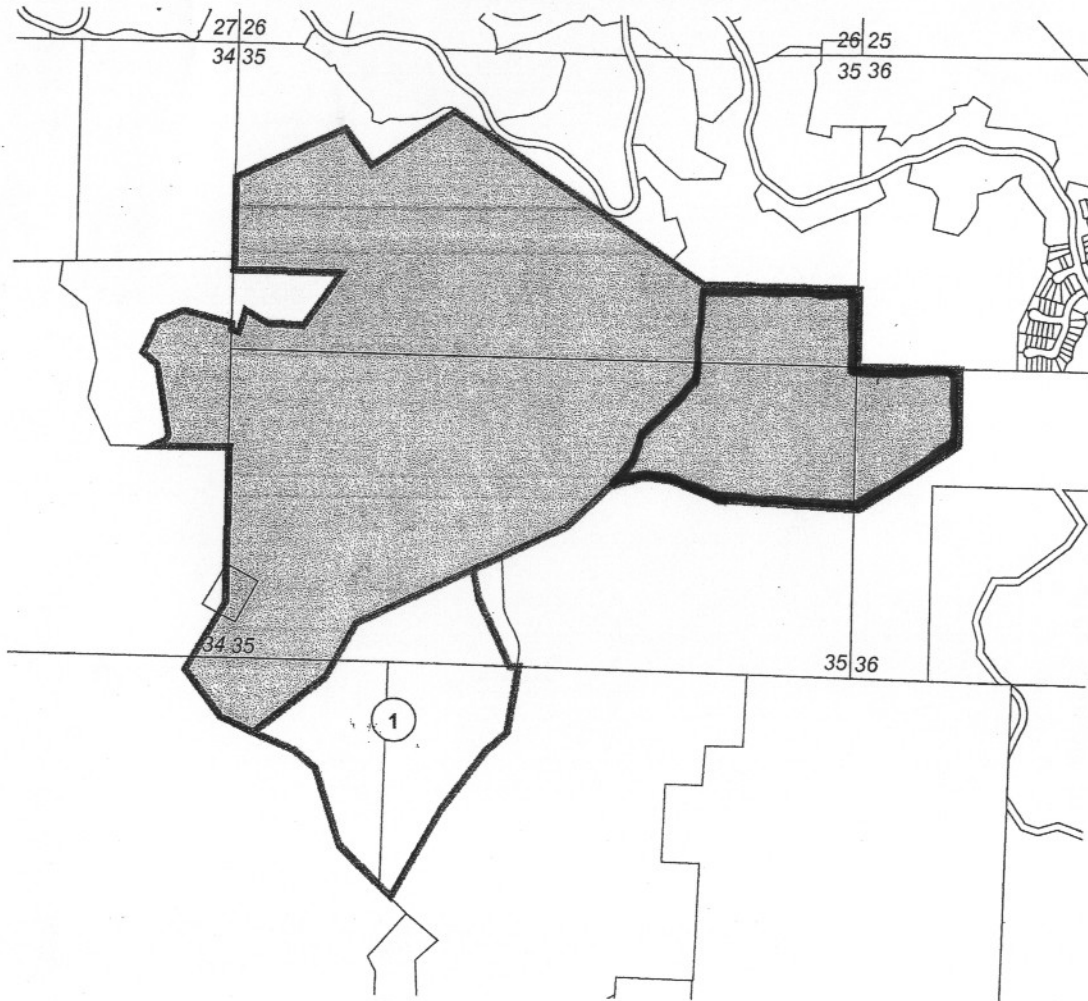

AMENDMENTS:

NO. 1, (DIMINISHMENT), MAY 10, 2004, MAP NO. 918

NO 2, DIMINISHMENT

MAP NO. 984

ADOPTED ON FEBRUARY 10, 1969
BY THE BOARD OF SUPERVISORS
OF THE COUNTY OF RIVERSIDE,
STATE OF CALIFORNIA.

