

SUBMITTAL TO THE BOARD OF SUPERVISORS  
COUNTY OF RIVERSIDE, STATE OF CALIFORNIA

304B



FROM: TLMA - Planning Department

SUBMITTAL DATE:  
September 12, 2007

SUBJECT: Ordinance No. 348.4521 to adopt SP Zone requirements and Standards for Specific Plan No. 229; First Supervisorial District; Mead Valley Zoning District – Mathews / Woodcrest Area Plan.

BACKGROUND: Specific Plan No. 229, Substantial Conformance No. 1/Change of Zone No. 7301/Tentative Tract Nos. 31607, 31608, 31609, 31610, 31611 & 31612 were tentatively approved by the Board of Supervisors on January 9, 2007.

RECOMMENDED MOTION:

ADOPTION of Ordinance No. 348.4521, An Ordinance of the County of Riverside Amending Ordinance No. 348 Relating to Zoning.

Departmental Concurrence

REVIEWED BY EXECUTIVE OFFICE

DATE 9/24/07  
Tina Grande

  
Ron Goldman  
Planning Director

Damian Meins  
Assistant Planning Director

RG:cv

Policy

Consent

Dep't Recomm.:  
Per Exec. Ofc.:

SEP 12 2007 5:12

Prev. Agn. Ref. 16.5 (1/9/07)

District: First

Agenda Number:

2.23



1 square feet. The minimum lot area shall be determined by  
2 excluding that portion of a lot that is used solely for access  
3 to the portion of a lot used as a building site.

4 (3) Except as provided above, all other zoning requirements shall be the same as  
5 those requirements identified in Article VI of Ordinance No. 348.

6 c. Planning Areas 3, 7, and 8.

7 (1) The uses permitted in Planning Areas 3, 7, and 8 of Specific Plan No. 229  
8 shall be the same as those uses permitted in Article VI, Section 6.1 of Ordinance No. 348,  
9 except that the uses permitted pursuant to Section 6.1 of Ordinance No. 348, except that  
10 the uses permitted pursuant to Section 6.1.a.(2) and (3); and b.(3), (5), (7) and 8 shall not  
11 be permitted.

12 (2) The development standards for Planning Areas 3, 7, and 8 of Specific Plan  
13 No. 229 shall be the same as those standards identified in Article VI, Section 6.2 of  
14 Ordinance No. 348, except that the development standard set forth in Section 6.2.b. shall  
15 be deleted and replaced by the following:

16 A. The minimum lot size shall be twelve thousand (12,000) square  
17 feet. The minimum lot area shall be determined by excluding that  
18 portion of a lot that is used solely for access to the portion of a lot  
19 used as a building site.

20 (3) Except as provided above, all other zoning requirements shall be the same as  
21 those requirements identified in Article VI of Ordinance No. 348.

22 d. Planning Area 4.

23 (1) The uses permitted in Planning Area 4 of Specific Plan No. 229 shall be  
24 the same as those uses permitted in Article VIIIe, Section 8.100 of Ordinance No. 348,  
25 except that the uses permitted pursuant to Sections 8.100.a.(1), and b.(1) shall not be  
26 permitted. In addition, the permitted uses identified under Section 8.100.a. shall include  
27 public schools.

28 (2) The development standards for Planning Area 4 of Specific Plan No. 229

1 shall be the same as those standards identified in Article VIIIe, Section 8.101 of  
2 Ordinance No. 348.

3 (3) Except as provided above, all other zoning requirements shall be the same as  
4 those requirements identified in Article VIIIe of Ordinance No. 348.

5 e. Planning Areas 6, 8A, 8B, 10, 13A, 13B and 13C.

6 (1) The uses permitted in Planning Areas 6, 8A, 8B, 10, 13A, 13B and 13C of  
7 Specific Plan No. 229 shall be the same as those uses permitted in Article VIIIe, Section  
8 8.100 of Ordinance No. 348, except that uses permitted pursuant to Sections 8.100.a.(1),  
9 (2), (3), (4), (5), (6),(7) and (8) shall not be permitted. In addition, the permitted uses  
10 identified under Section 8.100.a. shall also include open space and trails.

11 (2) The development standards for Planning Areas 6, 8A, 8B, 10, 13A, 13B and  
12 13C of Specific Plan No. 229 shall be the same as those standards identified in Article  
13 VIIIe, Section 8.101 of Ordinance No. 348.

14 (3) Except as provided above, all other requirements shall be the same as those  
15 requirements identified in Article VIIIe of Ordinance No. 348.

16 f. Planning Areas 11 and 12.

17 (1) The uses permitted in Planning Areas 11 and 12 of Specific Plan No. 229  
18 shall be the same as those uses permitted in Article VIIIe, Section 8.100 of Ordinance  
19 No. 348, except that the uses permitted pursuant to Section 8.100.a. (1), (6) and (8); b.(1)  
20 shall not be permitted.

21 (2) The development standards for Planning Areas 11 and 12 of Specific Plan  
22 No. 229 shall be the same as those standards identified in Article VIII.e., Section 8.101 of  
23 Ordinance No. 348.

24 (3) Except as provided above, all other zoning requirements shall be the same  
25 as those requirements identified in Article VIII.e. of Ordinance No. 348.

26 ///

27 ///

28 ///



**SUBMITTAL TO THE BOARD OF SUPERVISORS  
COUNTY OF RIVERSIDE, STATE OF CALIFORNIA**

317B



**FROM:** TLMA - Transportation Dept.

**SUBMITTAL DATE:** September 24, 2007

**SUBJECT:** Summarily vacating an un-named road in the Menifee area, Third Supervisorial District.

**RECOMMENDED MOTION:** Adopt Resolution No. 2007-319, summarily vacating an un-named road.

**BACKGROUND:** The property owner has requested that this un-named road be vacated. This roadway is 30.00 feet in width and does not exist currently. Due to the development of Tract No. 32277 lying northerly of said roadway; no additional right of way dedication will be required. As a condition of approval, Tract No. 32277 is required to vacate this existing 30' dedication. The adjacent property owner has been notified and has no objections to the vacation. No access will be eliminated from any parcels.

REVIEWED BY EXECUTIVE OFFICE

DATE 9/25/07  
Tina Grande  
Tina Grande

Departmental Concurrence

AM

Attachments: Resolution No. 2007-319  
Exhibits "A" & "B"

George A. Johnson  
George A. Johnson  
Director of Transportation

Dep't Recomm.:  Consent  Policy  
Per Exec. Ofc.:  Consent  Policy

Prev. Agn. Ref.:

District: 3

Agenda Number:

2.24

2  
3 **RESOLUTION NO. 2007-319**

4 **SUMMARILY VACATING AN UN-NAMED ROAD**

5 **IN THE MENIFEE AREA**

6 (AB 07010)

7 (Third Supervisorial District)

8  
9 **WHEREAS**, the hereinafter-described un-named road was dedicated for public  
10 road and utility purposes per Instrument No.23657 recorded February 9, 1982, on file  
11 in the Office of the Recorder of Riverside County, California;

12  
13 **WHEREAS**, the hereinafter-described un-named road is not necessary and is  
14 excess Right of Way, and not required for public street or highway purposes, now,  
15 therefore;

16  
17 **BE IT RESOLVED, DETERMINED AND ORDERED** by the Board of  
18 Supervisors of the County of Riverside, State of California, in regular session  
19 assembled on October 2, 2007, as follows:

- 20  
21 1. Pursuant to Section 8334(a) of the Streets and Highways Code that the  
22 hereinafter-described un-named road is excess Right of Way and is no longer  
23 required for public street and highway purposes and is hereby summarily  
24 vacated.

1 Resolution No. 2007-319

2

3

SEE LEGAL DESCRIPTION AND PLAT ATTACHED HERETO

4

AS EXHIBITS "A" AND "B" AND MADE A PART HEREOF

5

6

**EXCEPTING AND RESERVING** from the vacation an easement for any existing public utilities and public service facilities, together with the right to maintain, operate, replace, remove, or renew such facilities, pursuant to section 8340 of the Streets and Highways Code.

10

11

**BE IT FURTHER RESOLVED, DETERMINED AND ORDERED** that the Clerk of the Board is directed to cause a certified copy of this resolution to be recorded in the office of the Recorder of the County of Riverside, California.

12

13

14

15

16

17

18

19

20

AM

21

W.O. # AB 07010

FORM APPROVED COUNTY COUNSEL

BY: Gordon V. Woo 8/21/07  
GORDON V. WOO DATE

**EXHIBIT "A"**  
**VACATION**

LYING IN THE UNINCORPORATED TERRITORY OF RIVERSIDE COUNTY, STATE OF CALIFORNIA, WITHIN SECTION 12, TOWNSHIP 6 SOUTH, RANGE 3 WEST, SAN BERNARDINO MERIDIAN, BEING ALL OF PARCEL 1 OF THAT CERTAIN "EASEMENT" RECORDED FEBRUARY 9, 1982 AS INSTRUMENT NO. 23657 OF OFFICIAL RECORDS OF SAID COUNTY, LYING WITHIN PARCEL 1 OF PARCEL MAP 17009 AS PER MAP RECORDED IN PARCEL MAP BOOK 89, PAGE 30 OF PARCEL MAPS IN THE OFFICE OD THE COUNTY RECORDER OF SAID COUNTY.

THE HEREIN ABOVE DESCRIBED PARCEL CONTAINS 0.857 ACRES OF LAND AND IS SHOWN ON EXHIBIT "B" ATTACHED HERETO AND BY REFERENCE PART HEREOF.

W.J. MCKEEVER INC.  
CIVIL ENGINEERING



*Larry L. Walker* 6/7/07  
LARRY L. WALKER LS 4463  
LICENSE EXPIRES 09-30-07

THIS DOCUMENT REVIEWED BY  
RIVERSIDE COUNTY SURVEYOR.  
BY: *Robert S. Robinson*  
DATE: *05/20/07*

TR 32277

APN 372-080-24

N 89° 55' 06" E 1231.13

N 89° 55' 06" E 1193.11

PARCEL 1 INST NO. 23657 O.R. (2-9-1982)  
(UNNAMED ROAD)

APN 372-090-18

SE 1/4 SECT 12  
T65 R3W SBM

APN 372-090-17

PARCEL 1  
P.M. 17009  
P.M.B. 89/30

LINE DATA

LINE NO.	BEARING	LENGTH
1	N 00° 21' 04" E	44.89
2	N 45° 08' 05" E	21.13
3	N 42° 31' 15" W	34.08
4	N 00° 17' 37" E	55.15

THIS DOCUMENT REVIEWED BY  
RIVERSIDE COUNTY SURVEYOR.  
BY: *Robert S. Robinson*  
DATE: *08/20/07*

LEGEND:

- BOUNDARY LINE
- - - CENTERLINE
- - - LOT LINE
- ▬▬▬ INDICATES ROAD VACATION

Scale: 1" = 200'

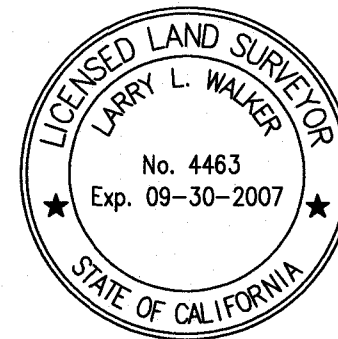
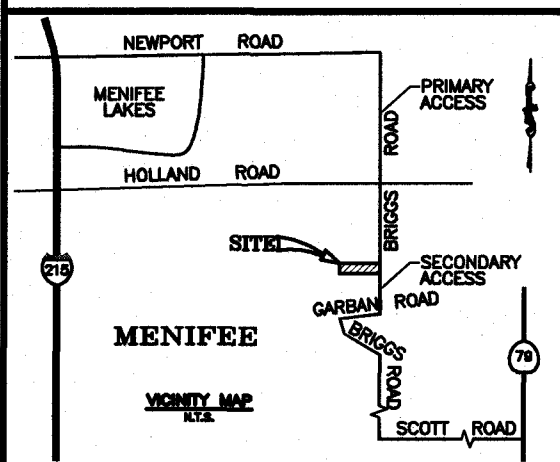

EXHIBIT "B"  
VACATION



**W.J. McKEEVER, INC.**  
CIVIL ENGINEERING  
847 NORTH MAIN STREET, SUITE 2A  
RIVERSIDE, CALIFORNIA 92501  
PH: (951) 841-3700  
FAX: (951) 841-3740

*Larry L. Walker* 6/7/07  
LARRY L. WALKER, L.S. 4463 DATE

**SUBMITTAL TO THE BOARD OF SUPERVISORS  
COUNTY OF RIVERSIDE, STATE OF CALIFORNIA**

316B



**FROM:** TLMA - Transportation Dept.

**SUBMITTAL DATE:** September 24, 2007

**SUBJECT:** Summarily vacating the right to accept the dedication of Bunny Trail in the Wildomar area, First Supervisorial District.

**RECOMMENDED MOTION:** Adopt Resolution No. 2007-045, summarily vacating the right to accept the dedication of Bunny Trail.

**BACKGROUND:** The property owners have requested that Bunny Trail be vacated. Bunny Trail is not an existing travel way and not needed for circulation. Bunny Trail has not been accepted for public use. The adjacent property owners have been notified and they have no objections of the proposed vacation. Access will not be eliminated to any parcel.

REVIEWED BY EXECUTIVE OFFICE

DATE 9/25/07 Tina Grande  
Tina Grande

Is Departmental Concurrence

AM

Attachments: Resolution No. 2007-045

George A. Johnson  
George A. Johnson  
Director of Transportation

Dep't Recomm.:  Consent  Policy  
Per Exec. Ofc.:  Consent  Policy

Prev. Agn. Ref.:

District: 1

Agenda Number:

2.25

2  
3 **RESOLUTION NO. 2007-045**

4 **SUMMARILY VACATING THE RIGHT TO ACCEPT THE DEDICATION**  
5 **OF BUNNY TRAIL IN THE WILDOMAR AREA**

6 (AB 06028)

7 (First Supervisorial District)

8  
9 **WHEREAS**, the hereinafter-described Bunny Trail was dedicated on Parcel  
10 Map 9637, recorded in Parcel Map Book 58, Pages 1 through 5, inclusive, of Parcel  
11 Maps on file in the Office of the Recorder of Riverside County, California;

12  
13 **WHEREAS**, the offer of dedication of Bunny Trail has not been accepted by the  
14 County of Riverside: and,

15  
16 **WHEREAS**, the hereinafter-described Bunny Trail is not necessary and is  
17 excess Right of Way, and not required for public street or highway purposes, now,  
18 therefore;

19  
20 **BE IT RESOLVED, DETERMINED AND ORDERED** by the Board of  
21 Supervisors of the County of Riverside, State of California, in regular session  
22 assembled on October 2, 2007, as follows:

1 **RESOLUTION NO. 2007-045**

2  
3  
4  
5  
6  
7  
8  
9  
10  
11  
12  
13  
14  
15  
16  
17  
18  
19  
20  
21  
22  
23  
24

1. Pursuant to Section 8334(a) of the Streets and Highways Code that the hereinafter-described Bunny Trail is excess Right of Way and is no longer required for public street and highway purposes and is hereby summarily vacated.

SEE LEGAL DESCRIPTION AND PLAT ATTACHED HERETO AS EXHIBITS "A" AND "B" AND MADE A PART HEREOF

**EXCEPTING AND RESERVING** from the vacation an easement for any existing public utilities and public service facilities, together with the right to maintain, operate, replace, remove, or renew such facilities, pursuant to section 8340 of the Streets and Highways Code.

2. That the herein-described of Bunny Trail is unnecessary for present or prospective public use, including use as a non-motorized transportation facility.

**BE IT FURTHER RESOLVED, DETERMINED AND ORDERED** that the Clerk of the Board is directed to cause a certified copy of this resolution to be recorded in the office of the Recorder of the County of Riverside, California.

AM  
W.O. # AB 06-028

FORM APPROVED COUNTY COUNSEL  
BY: Gordon V. Woo 8/20/07  
GORDON V. WOO DATE

THIS DOCUMENT REVIEWED BY  
RIVERSIDE COUNTY SURVEYOR.  
BY: Robert S. Robinson  
DATE: 8/14/07

EXHIBIT "A"

VACATION OF THE RIGHT TO ACCEPT BUNNY TRAIL

Those portions of Parcels 3 through 5 inclusive, as shown on Parcel Map 9637 on file in Book 58 of Parcel Maps at pages 1 through 5 inclusive, thereof, Records of Riverside County, California, lying in Section 6, Township 7 South, Range 3 West S.B.M., more particularly described as follows:

**BEGINNING** at the northwesterly corner of a road easement as shown on said parcel map, said easement being on the south side of said Parcel 5;

Thence South  $46^{\circ}29'56''$  East, a distance of 21.28 feet to a point on a line parallel with and distant northerly 30.00 feet, as measured at a right angle, from the southerly line of said Parcel;

Thence North  $88^{\circ}19'54''$  East along said parallel line, a distance of 1266.34 feet to an angle point herein;

Thence North  $43^{\circ}29'15''$  East, a distance of 21.16 feet to a point on a line parallel with and distant westerly 30.00 feet, as measured at a right angle, from the centerline of Elizabeth lane as shown on said parcel map;

Thence South  $01^{\circ}21'23''$  East along said parallel line, a distance of 90.00 feet;

Thence North  $46^{\circ}30'45''$  West, a distance of 21.26 feet to a point on a line parallel with and distant southerly 30.00 feet, as measured at a right angle, from the northerly line of said Parcel 4;

Thence South  $88^{\circ}19'54''$  West along said parallel line, a distance of 1266.40 feet;

Thence South  $43^{\circ}30'04''$  West, a distance of 21.15 feet to a point on the westerly line of said Parcel 3, said point also being on the easterly road easement line of Yamas Drive (60.00 feet wide) as shown on said Parcel Map;

Thence North  $01^{\circ}19'46''$  West along said westerly line and said road easement line, a distance of 90.00 feet to the **POINT OF BEGINNING**;

Containing 1.80 acres more or less.

See Exhibit "B" attached hereto and made apart hereof.

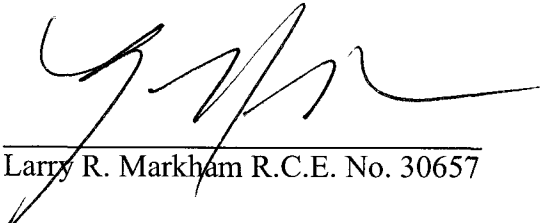

  
Larry R. Markham R.C.E. No. 30657

8.3.07  
Date

# EXHIBIT "B"



C/L YAMAS DRIVE

C/L ELIZABETH LANE

PARCEL MAP NO. 9637  
PM 58/1-5  
PARCEL 5

P.O.B.

S 46°29'56" E  
21.28'

C/L BUNNY TRAIL

N 43°29'15" E  
21.16'

N 88°19'54" E 1266.34'

648.28'

S 88°19'54" W 1266.40'

618.12'

S 43°30'04" W  
21.15'

AREA = 1.80 ACRES

N 46°30'45" W  
21.26'

N 01°19'46" W 90.00'

S 01°21'23" E 90.00'

PARCEL 3

PARCEL 4

THIS DOCUMENT REVIEWED BY  
RIVERSIDE COUNTY SURVEYOR.  
BY: *Robert S. Robinson*  
DATE: *8/14/07*



## M-D-MG

MARKHAM DEVELOPMENT MANAGEMENT GROUP, INC.

41635 Enterprise Circle N. - Suite B  
Temecula, California 92590

(951)296-3476 FAX (951)296-3466 TEL

## RIVERSIDE COUNTY, CALIFORNIA

THIS PLAT IS SOLELY AN AID IN LOCATING THE PARCEL(S) DESCRIBED IN THE ATTACHED DOCUMENT.

SHEET 1 OF 1

SCALE = 200"

SEC. 6, T.7S., R.3W S.B.M.

DATE 9/14/06

DRWN BY \_\_\_\_\_ DATE \_\_\_\_\_  
CHKD BY \_\_\_\_\_ DATE \_\_\_\_\_

PUBLIC RIGHT OF WAY VACATION.

VICINITY MAP  
 REMOVE PRIOR TO  
 RECORDATION

M-12  
 S-1,3

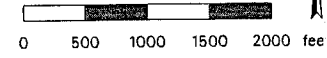
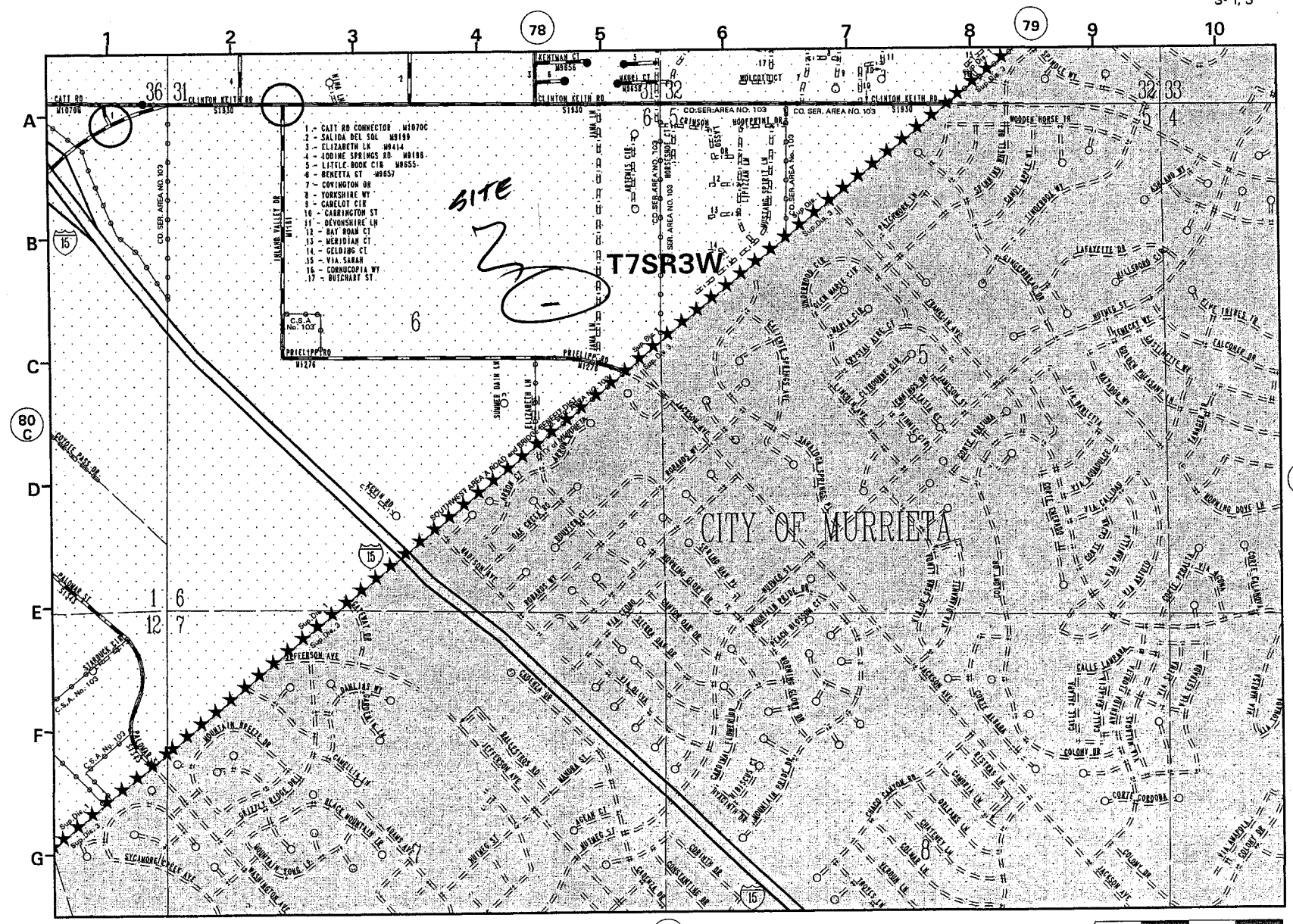

**SUBMITTAL TO THE BOARD OF SUPERVISORS  
COUNTY OF RIVERSIDE, STATE OF CALIFORNIA**

315 B



**FROM:** TLMA - Transportation Department

**SUBMITTAL DATE:**  
September 24, 2007

**SUBJECT:** Conditional Use Permit 3503  
A Schedule Subdivision in the Lake Elsinore Area  
**Subdivision Improvement Agreements**

**RECOMMENDED MOTION:** That the Board approve the attached Subdivision Improvement Agreements as approved by County Counsel.

**BACKGROUND:** The developer desires to enter into Improvement Agreements to guarantee the construction of the required improvements and has submitted Improvement Agreements and Securities which have been approved by County Counsel.

REVIEWED BY EXECUTIVE OFFICE

DATE 9/25/07  
Tina Grande

Departmental Concurrence

  
George A. Johnson  
Director of Transportation

HS:lf  
Submittals: Vicinity Map  
Road/Drainage Agrmts.

Policy

Consent

Dep't Recomm.:  
Per Exec. Ofc.:

Prev. Agn. Ref.

District: 1

Agenda Number:

2.26

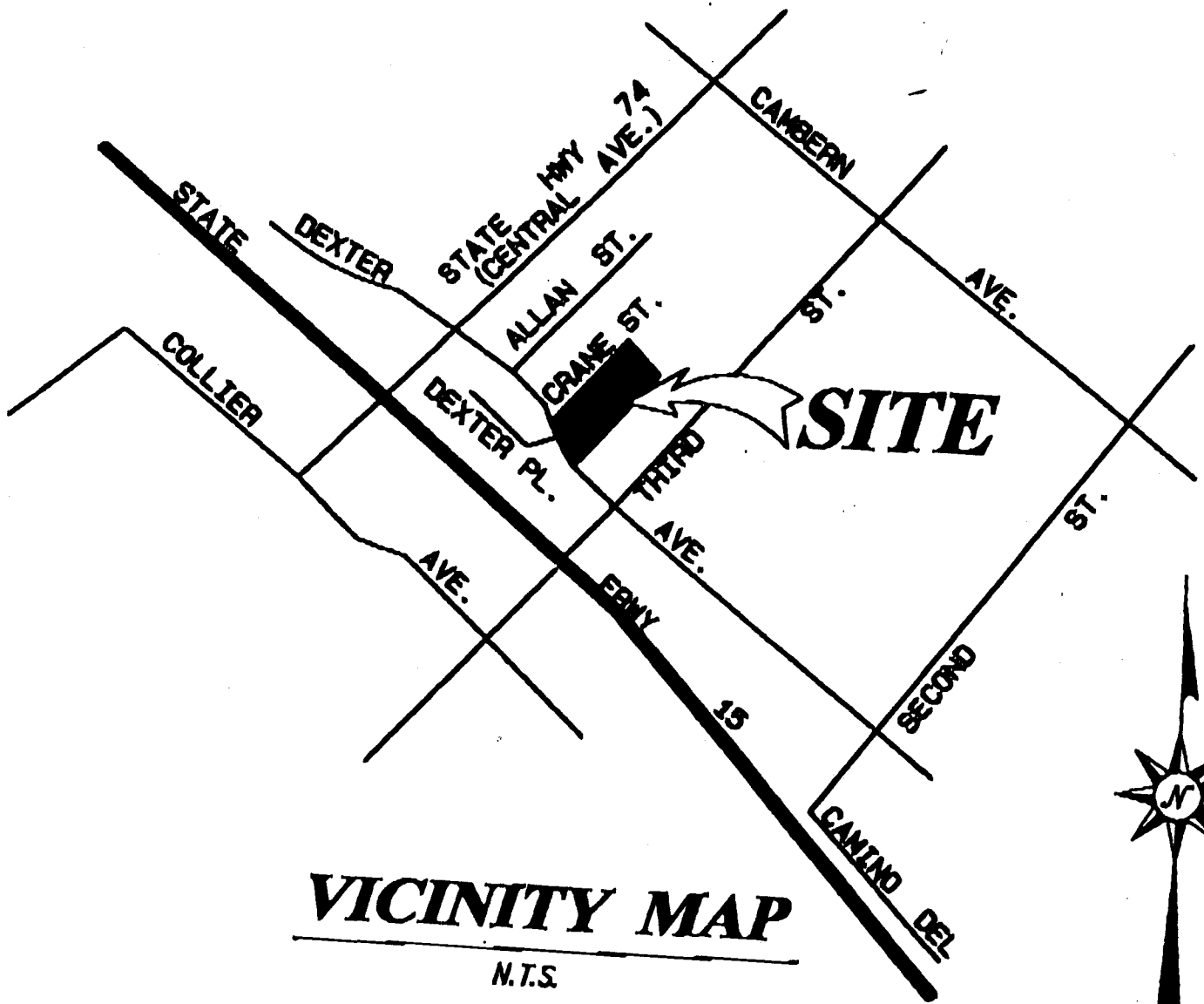

**VICINITY MAP**

N.T.S.

**SUBMITTAL TO THE BOARD OF SUPERVISORS  
COUNTY OF RIVERSIDE, STATE OF CALIFORNIA**



320B

**FROM:** TLMA - Transportation Department

**SUBMITTAL DATE:**  
October 5, 2007

**SUBJECT:** Tract 28753-6  
A Schedule "A" Subdivision in the Rancho California Area  
**ONE YEAR GUARANTEE AND MAINTENANCE AGREEMENTS**

**RECOMMENDED MOTION:** That the Board approve the attached One Year Guarantee and Maintenance Agreements as approved by County Counsel and authorize the Chairman to sign these agreements for Tract 28753-6.

**BACKGROUND:** Improvements were completed for this project on August 6, 2007. The developer desires to enter into Maintenance Agreements to guarantee a one year maintenance of the improvements and has submitted agreements and securities which have been approved by County Counsel.

Departmental Concurrence

REVIEWED BY EXECUTIVE OFFICE

DATE 9/25/07  
Tina Grande  
Tina Grande

George A. Johnson  
Director of Transportation

HS:lf  
Submittals: Vicinity Map  
Road/Drainage Maint Agrmnts  
Water System Maint Agrmnts  
Sewer System Maint Agrmnts  
Monumentation Agreements

Policy  
 Policy

Consent  
 Consent

Dept't Recomm.:  
Per Exec. Ofc.:

Prev. Agn. Ref. 04/16/02 - 2.7 | District: 3 | Agenda Number:

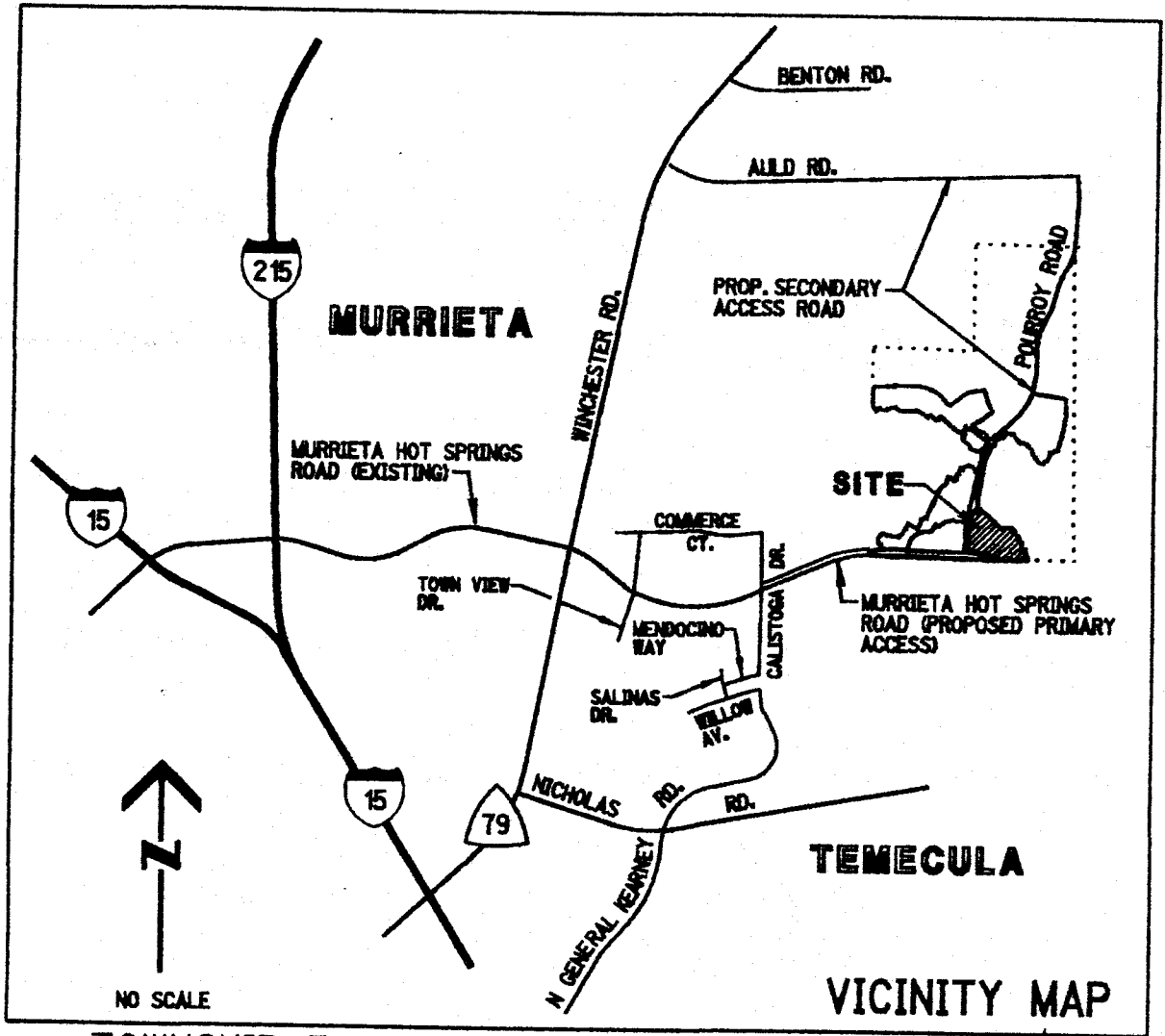

TOWNSHIP 7 SOUTH, RANGE 2 WEST, SECTION 17

VICINITY MAP

**SUBMITTAL TO THE BOARD OF SUPERVISORS  
COUNTY OF RIVERSIDE, STATE OF CALIFORNIA**

324 B



**FROM:** TLMA - Transportation Department

**SUBMITTAL DATE:**  
October 5, 2007

**SUBJECT:** Tracts 28815 and 28816 (MS 3816)  
Schedule "A" Subdivisions in the Lake Mathews Area  
**Extension of Time Agreements**

**RECOMMENDED MOTION:** That the Board approve the attached agreements (which grant an extension of time for twelve months to complete improvements).

**BACKGROUND:** On November 23, 2004, the Board entered into agreements with Lake Hills - Riverside, LP for the improvement of streets and the installation of a water and sewer system within the above referenced subdivision. Accompanying these agreements were faithful performance securities posted by Arch Insurance Co as follows:

- \$5,279,500 - Bond #SU5005149 for the completion of street improvements
- \$1,205,500 - Bond #SU5005150 for the completion of the water system
- \$1,183,500 - Bond #SU5005148 for the completion of the sewer system

REVIEWED BY EXECUTIVE OFFICE

DATE: 10/23/07

Tina Glante

Departmental Concurrence

  
 \_\_\_\_\_  
 George A. Johnson  
 Director of Transportation

HS:lf  
 Submittals: Vicinity Map  
 Road/Drainage Agrmts.  
 Water System Agrmts.  
 Sewer System Agrmts.

Policy

Policy

Consent

Consent

Dep't Recomm.:

Per Exec. Ofc.:

Prev. Agn. Ref. 11/23/04 - 2.13 | District: 1 | Agenda Number:

324 B 10/17/07

The Honorable Board of Supervisors  
RE: Tracts 28815 and 28816 (MS 3816)  
October 5, 2007  
Page 2 of 2

The developer requests an extension of time for the completion of Tracts 28815 and 28816 (MS 3816). Our records indicate that this project is approximately 61% completed for street and utility work. The agreements for the extension of time have been approved by County Counsel.

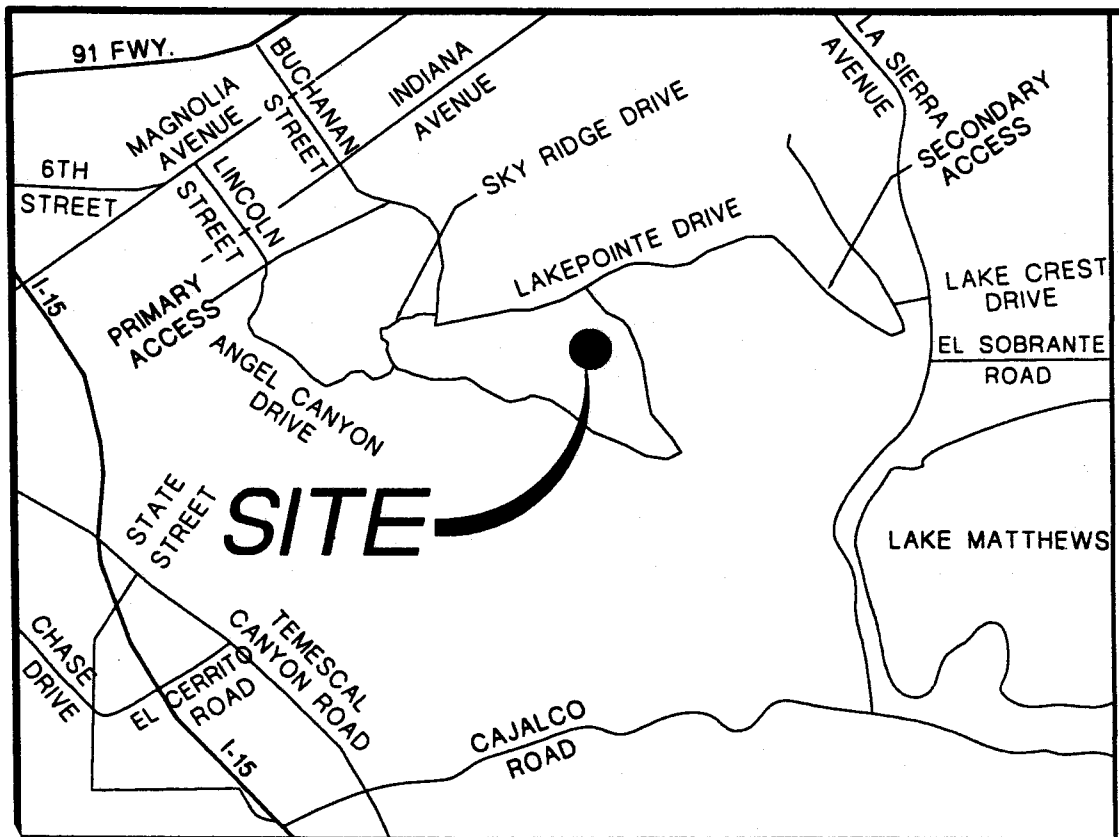

## VICINITY MAP

N.T.S.

**SUBMITTAL TO THE BOARD OF SUPERVISORS  
COUNTY OF RIVERSIDE, STATE OF CALIFORNIA**

325 B



**FROM:** TLMA - Transportation Department

**SUBMITTAL DATE:**  
October 5, 2007

**SUBJECT:** Tract 28816  
A Schedule "A" Subdivision in the Lake Mathews Area  
**Extension of Time Agreements**

**RECOMMENDED MOTION:** That the Board approve the attached agreements (which grant an extension of time for twelve months to complete improvements).

**BACKGROUND:** On November 23, 2004, the Board entered into agreements with Lake Hills - Riverside, LP for the improvement of streets and the installation of a water and sewer system within the above referenced subdivision. Accompanying these agreements were faithful performance securities posted by Arch Insurance Company as follows:

- \$3,589,000 - Bond #SU5005140 for the completion of street improvements
- \$486,500 - Bond #SU5005141 for the completion of the water system
- \$536,500 - Bond #SU5005142 for the completion of the sewer system
- \$245,000 - Bond #SU5005143 for the completion of the monumentation

REVIEWED BY EXECUTIVE OFFICE

DATE 01/25/07

Tina Grande

Departmental Concurrence

  
George A. Johnson  
Director of Transportation

HS:lf  
Submittals: Vicinity Map  
Road/Drainage Agrmts.  
Water System Agrmts.  
Sewer System Agrmts.  
Monumentation Agrmts

Dep't Recomm.:  Policy

Per Exec. Ofc.:  Policy

Consent

Consent

Prev. Agn. Ref. 11/23/04 - 2.15 | District: 1 | Agenda Number:

2.29

The Honorable Board of Supervisors  
RE: Tract 28816  
October 5, 2007  
Page 2 of 2

The developer requests an extension of time for the completion of Tract 28816. Our records indicate that this project is approximately 35% completed for street and utility work. The agreements for the extension of time have been approved by County Counsel.

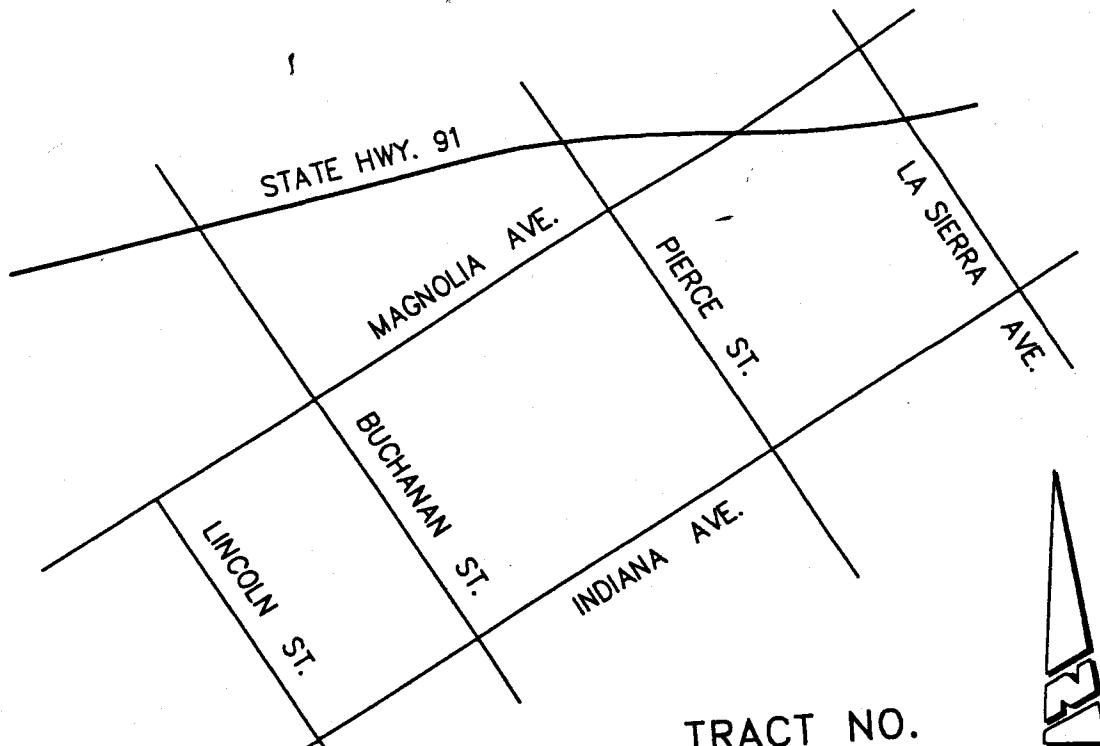

TRACT NO.  
28816

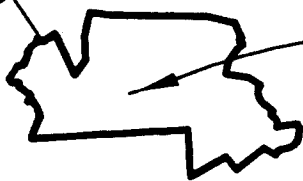

VICINITY MAP  
NO SCALE

**VICINITY MAP**

**TR 28816**

SUBMITTAL TO THE BOARD OF SUPERVISORS  
COUNTY OF RIVERSIDE, STATE OF CALIFORNIA

312B

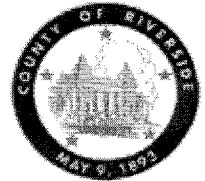

SUBMITTAL DATE:  
September 24, 2007

FROM: TLMA – Transportation Dept.

SUBJECT: TRACT 28880-2

A Schedule "A" Subdivision in the Eastvale Area  
**EXTENSION OF TIME AGREEMENTS**

**RECOMMENDED MOTION:** That the Board approve the attached agreements (which grant an extension of time for twelve months to complete improvements).

**BACKGROUND:** On August 29, 2006, the Board entered into agreements with Standard Pacific Corp. for the improvement of streets and the installation of a water and sewer system within the above referenced subdivision. Accompanying these agreements were faithful performance securities posted by Continental Insurance Company as follows:

- \$471,000 - Bond #929303261 for the completion of street improvements
- \$108,000 - Bond #929303261 for the completion of the water system
- \$160,000 - Bond #929303261 for the completion of the sewer system **(Continued)**

Departmental Concurrence

HS:lf  
Submittals: Vicinity Map  
Road/Drainage Improvement Agrmts  
Water Improvement Agreements  
Sewer Improvement Agreements

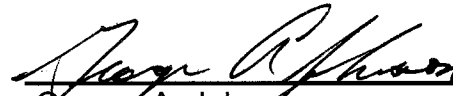
  
George A. Johnson  
Director of Transportation

REVIEWED BY EXECUTIVE OFFICE

DATE 9/25/07

Tina Grande

- Consent
- Policy
- Consent
- Policy

Dept' Recomm.:  
Per Exec. Ofc.:

Prev. Agn. Ref.: 08/29/06 - 2.23 | District: 2 | Agenda Number:

The Honorable Board of Supervisors

RE: TRACT 28880-2

September 24, 2007

Page 2 of 2

The developer requests an extension of time for the completion of Tract 28880-2. Our records indicate that this project is approximately 90% completed for street and utility work. The agreements for the extension of time have been approved by County Counsel.

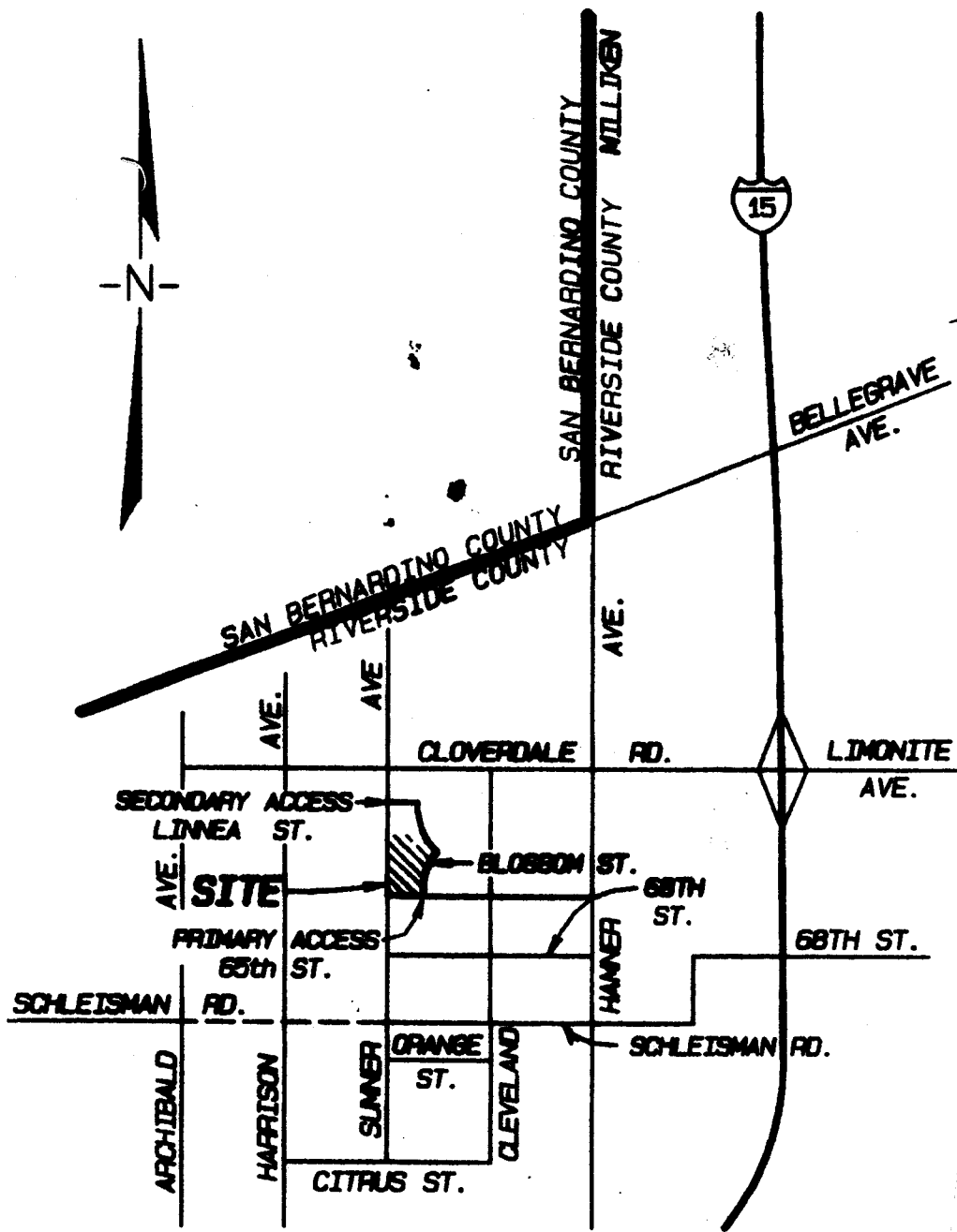

# VICINITY MAP

NOT TO SCALE

SUBMITTAL TO THE BOARD OF SUPERVISORS  
COUNTY OF RIVERSIDE, STATE OF CALIFORNIA

323 B

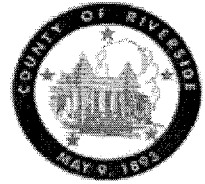

FROM: TLMA - Transportation Department

SUBMITTAL DATE:  
October 5, 2007

SUBJECT: Tract 29214  
A Schedule "A" Subdivision in the Lake Skinner Area  
**Extension of Time Agreements**

**RECOMMENDED MOTION:** That the Board approve the attached agreements (which grant an extension of time for twelve months to complete improvements).

**BACKGROUND:** On April 26, 2005, the Board entered into agreements with Shea Homes Limited Partnership for the improvement of streets and the installation of a water and sewer system within the above referenced subdivision. Accompanying these agreements were faithful performance securities posted by Arch Insurance Company as follows:

- \$10,861,000 - Bond #SU5012798 for the completion of street improvements
- \$1,269,500 - Bond #SU5012800 for the completion of the water system
- \$1,540,500 - Bond #SU5012799 for the completion of the sewer system
- \$244,600 - Bond #SU5012801 for the completion of the monumentation

REVIEWED BY EXECUTIVE OFFICE

DATE *10/5/07*

Tina Grande

Departmental Concurrence

*elation*

*George A. Johnson*

---

George A. Johnson  
Director of Transportation

HS:lf  
Submittals: Vicinity Map  
Road/Drainage Agrmts.  
Water System Agrmts.  
Sewer System Agrmts.  
Monumentation Agrmts

Dept't Recomm.:  Consent

Per Exec. Ofc.:  Consent

Policy

Policy

Prev. Agn. Ref. 04/26/05 - 2.9 | District: 3 | Agenda Number:

The Honorable Board of Supervisors

RE: Tract 29214

October 5, 2007

Page 2 of 2

The developer requests an extension of time for the completion of Tracts 29214. Our records indicate that this project is approximately 62% completed for street and utility work. The agreements for the extension of time have been approved by County Counsel.

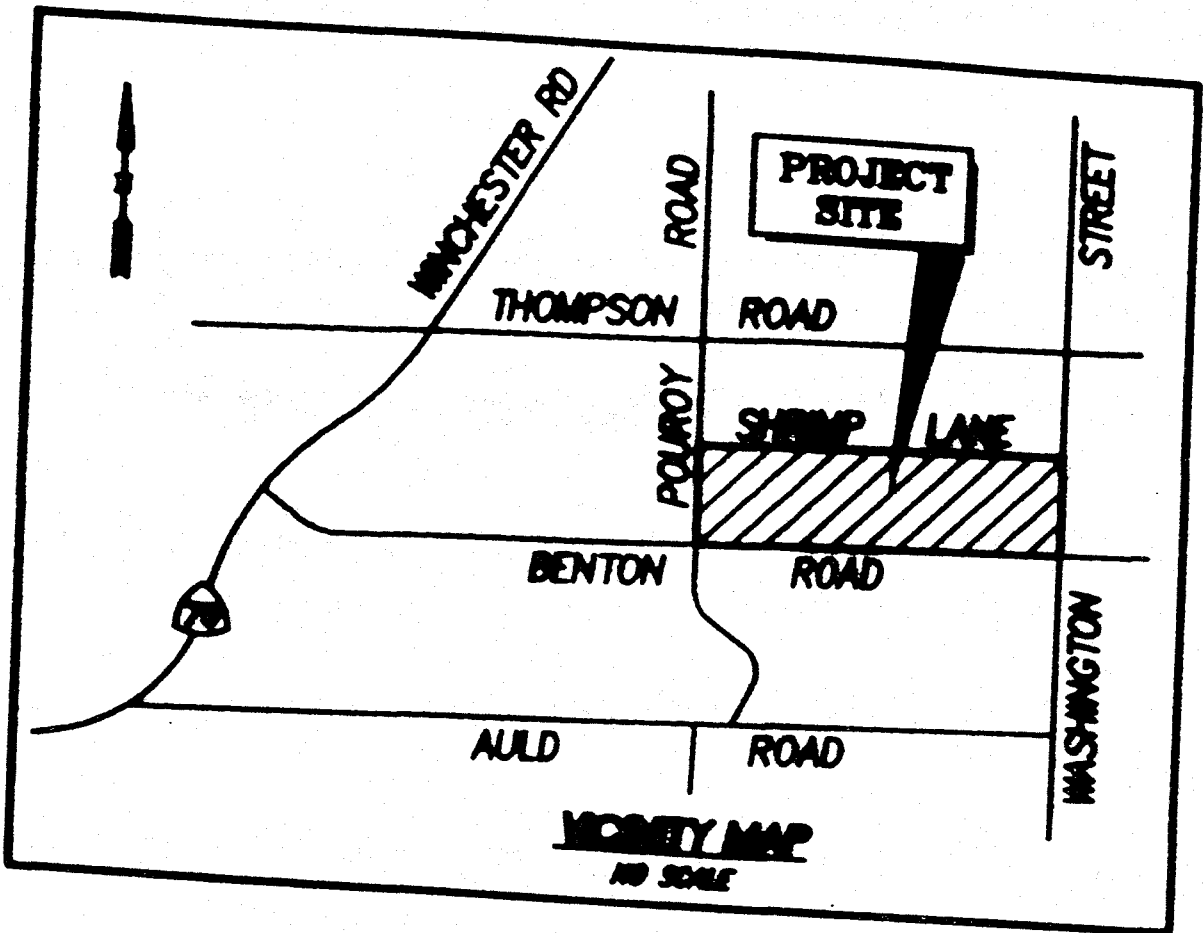

**SUBMITTAL TO THE BOARD OF SUPERVISORS  
COUNTY OF RIVERSIDE, STATE OF CALIFORNIA**

321 B



**FROM:** TLMA - Transportation Department

**SUBMITTAL DATE:**  
October 5, 2007

**SUBJECT:** Tract 29442-1 (Onsite Improvements)  
A Schedule "A" Subdivision in the French Valley Area  
**Extension of Time Agreements**

**RECOMMENDED MOTION:** That the Board approve the attached agreements (which grant an extension of time for twelve months to complete improvements).

**BACKGROUND:** On November 14, 2000, the Board entered into agreements with Beazer Homes Holdings Corp for the improvement of streets and the installation of a water and sewer system within the above referenced subdivision. Accompanying these agreements were faithful performance securities posted by American Home Assurance Company as follows:

- \$2,413,000 - Bond #195571 for the completion of street improvements
- \$326,500 - Bond #195569 for the completion of the water system
- \$561,000 - Bond #195570 for the completion of the sewer system

REVIEWED BY EXECUTIVE OFFICE

DATE: 9/25/07

Tina Grande

Departmental Concurrence

  
George A. Johnson  
Director of Transportation

HS:lf  
Submittals: Vicinity Map  
Road/Drainage Agrmts.  
Water System Agrmts.  
Sewer System Agrmts.

Dept't Recomm.:  Consent

Per Exec. Ofc.:  Consent

Policy

Policy

Prev. Agn. Ref. 11/14/00 - 2.12 | District: 3 | Agenda Number:

The Honorable Board of Supervisors  
RE: Tract 29442-1 (Onsite Improvements)  
October 5, 2007  
Page 2 of 2

The developer requests an extension of time for the completion of Tract 29442-1 (Onsite Improvements). Our records indicate that this project is approximately 88% completed for street and utility work. The agreements for the extension of time have been approved by County Counsel.

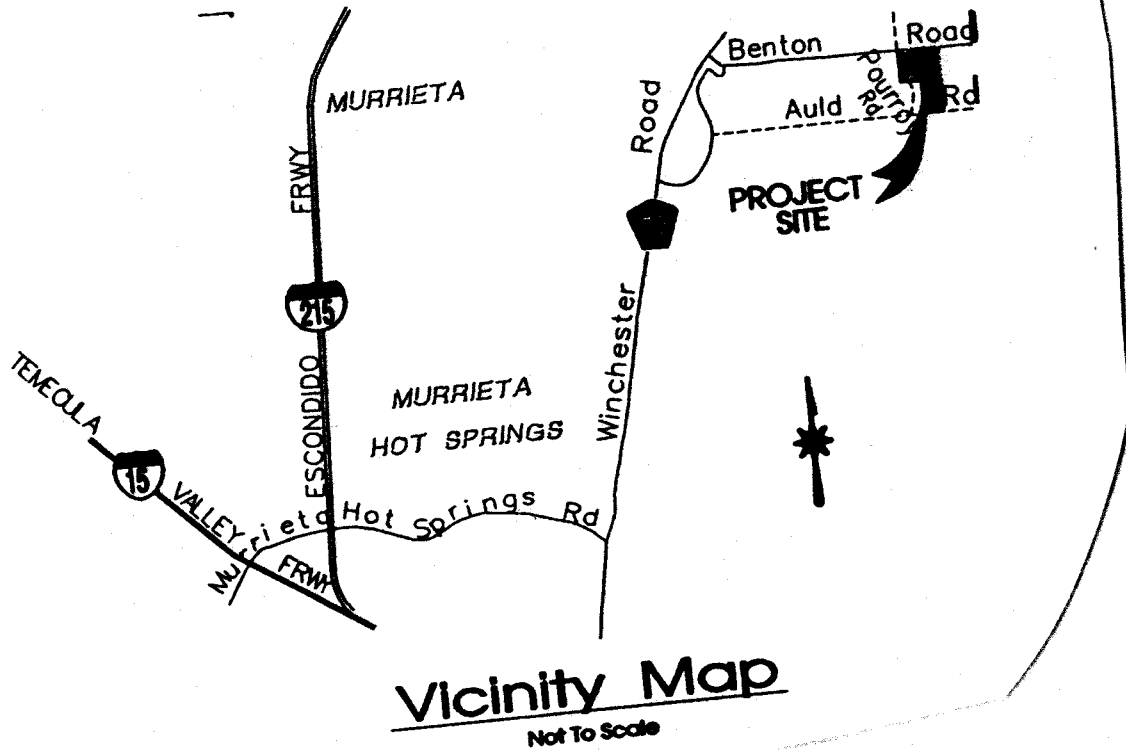

**Vicinity Map**  
Not To Scale

**SUBMITTAL TO THE BOARD OF SUPERVISORS  
COUNTY OF RIVERSIDE, STATE OF CALIFORNIA**

327B



**FROM:** TLMA - Transportation Department

**SUBMITTAL DATE:**  
October 5, 2007

**SUBJECT:** Tract 29952  
A Schedule "A" Subdivision in the French Valley Area  
**ONE YEAR GUARANTEE AND MAINTENANCE AGREEMENTS**

**RECOMMENDED MOTION:** That the Board approve the attached One Year Guarantee and Maintenance Agreements as approved by County Counsel and authorize the Chairman to sign these agreements for Tract 29952.

**BACKGROUND:** Improvements were completed for this project on May 31, 2007. The developer desires to enter into Maintenance Agreements to guarantee a one year maintenance of the improvements and has submitted agreements and securities which have been approved by County Counsel.

Departmental Concurrence

REVIEWED BY EXECUTIVE OFFICE

DATE 10/25/07  
Tina Grande

  
George A. Johnson  
Director of Transportation

HS:lf  
Submittals: Vicinity Map  
Road/Drainage Maint Agrmts  
Water System Maint Agrmts  
Sewer System Maint Agrmts

Policy

Consent  Consent

Dept't Recomm.:  
Per Exec. Ofc.:

Prev. Agn. Ref. 11/14/06 - 2.26

District: 3

Agenda Number:

10/25/07 5:51

2.33

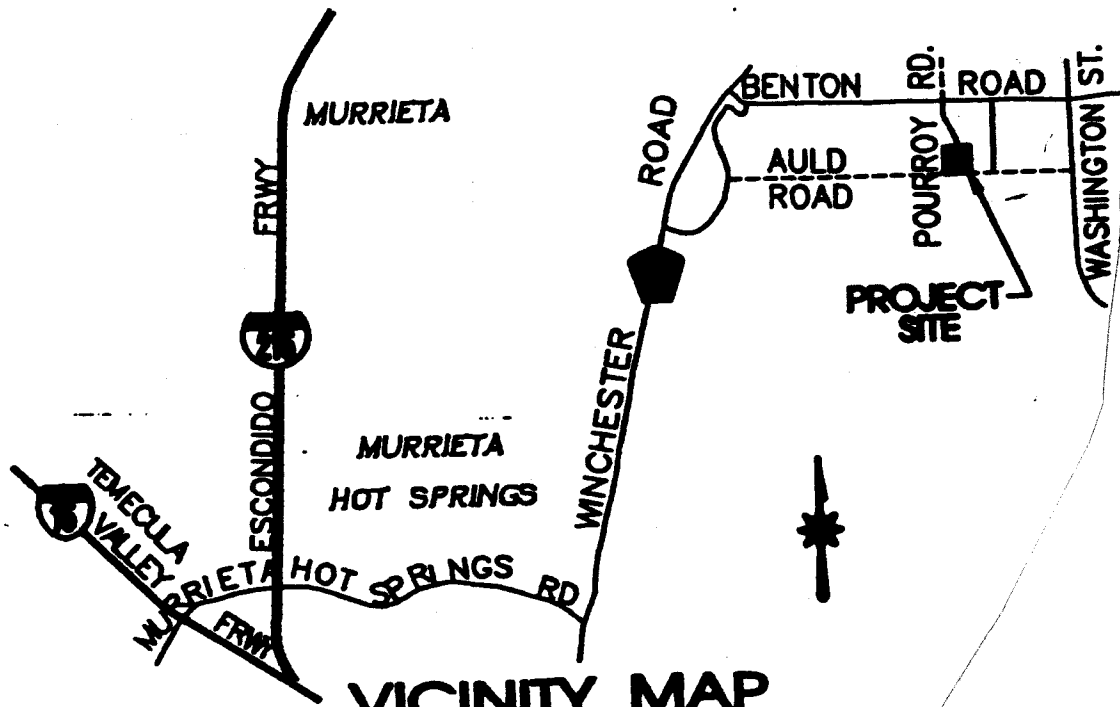

**VICINITY MAP**

**Not To Scale**

**SUBMITTAL TO THE BOARD OF SUPERVISORS  
COUNTY OF RIVERSIDE, STATE OF CALIFORNIA**

322 B



**FROM:** TLMA - Transportation Department

**SUBMITTAL DATE:**  
October 5, 2007

**SUBJECT:** Tract 30040-4  
A Schedule "A" Subdivision in the Sun City Area  
**Extension of Time Agreements**

**RECOMMENDED MOTION:** That the Board approve the attached agreements (which grant an extension of time for twelve months to complete improvements).

**BACKGROUND:** On June 21, 2005, the Board entered into agreements with Lennar Homes of California, Inc. for the improvement of streets and the installation of a water and sewer system within the above referenced subdivision. Accompanying these agreements were faithful performance securities posted by Hartford Fire Insurance Company as follows:

- \$890,000 - Bond #72BSBDJ4769 for the completion of street improvements
- \$173,500 - Bond #72BSBDJ4769 for the completion of the water system
- \$226,500 - Bond #72BSBDJ4769 for the completion of the sewer system
- \$22,650 - Bond #72BSBDJ4770 for the completion of the monumentation

REVIEWED BY EXECUTIVE OFFICE  
DATE 10/5/07  
Tina Grande  
Departmental Concurrence

  
George A. Johnson  
Director of Transportation

HS:lf  
Submittals: Vicinity Map  
Road/Drainage Agrmts.  
Water System Agrmts.  
Sewer System Agrmts.  
Monumentation Agrmts

Dept't Recomm.:	<input checked="" type="checkbox"/> Consent	<input type="checkbox"/> Policy
Per Exec. Ofc.:	<input checked="" type="checkbox"/> Consent	<input type="checkbox"/> Policy

Prev. Agn. Ref. 06/21/05 - 2.21 | District: 3 | Agenda Number:

**ATTACHMENTS FILED  
WITH THE CLERK OF THE BOARD**

2.34

The Honorable Board of Supervisors

RE: Tract 30040-4

October 5, 2007

Page 2 of 2

The developer requests an extension of time for the completion of Tracts 30040-4. Our records indicate that this project is approximately 90% completed for street and utility work. The agreements for the extension of time have been approved by County Counsel.

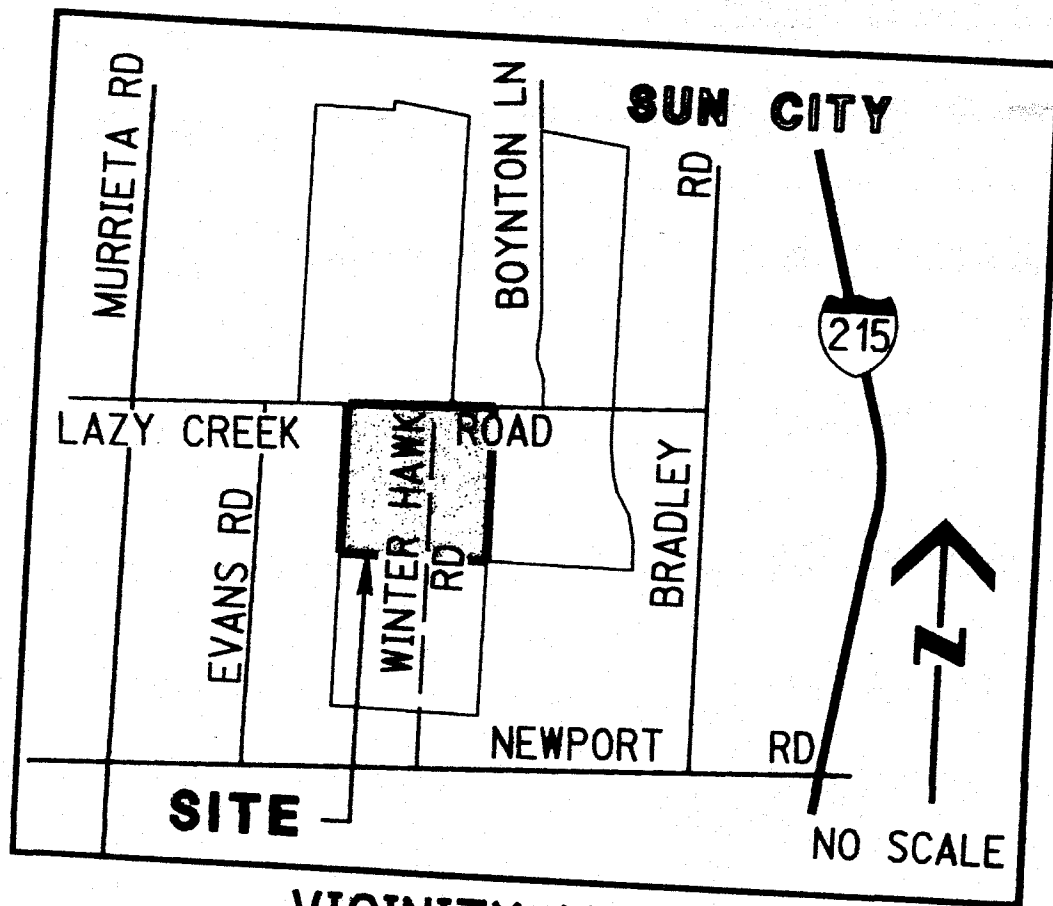

VICINITY MAP

**SUBMITTAL TO THE BOARD OF SUPERVISORS  
COUNTY OF RIVERSIDE, STATE OF CALIFORNIA**

326 B

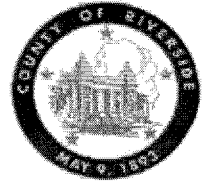

**FROM:** TLMA - Transportation Department

**SUBMITTAL DATE:**  
October 5, 2007

**SUBJECT:** Tract 30441  
A Schedule "A" Subdivision in the French Valley Area  
**ONE YEAR GUARANTEE AND MAINTENANCE AGREEMENTS**

**RECOMMENDED MOTION:** That the Board approve the attached One Year Guarantee and Maintenance Agreements as approved by County Counsel and authorize the Chairman to sign these agreements for Tract 30441.

**BACKGROUND:** Improvements were completed for this project on May 31, 2007. The developer desires to enter into Maintenance Agreements to guarantee a one year maintenance of the improvements and has submitted agreements and securities which have been approved by County Counsel.

REVIEWED BY EXECUTIVE OFFICE

DATE: *10/5/07*  
Tina Grande  
Departmental Concurrence

*George A. Johnson*  
George A. Johnson  
Director of Transportation

HS:lf  
Submittals: Vicinity Map  
Road/Drainage Maint Agrmts  
Water System Maint Agrmts  
Sewer System Maint Agrmts

Policy  
 Policy

Consent  
 Consent

Dept's Recomm.:  
Per Exec. Ofc.:

Prev. Agn. Ref. 11/14/06 - 2.27

District: 3

Agenda Number: *644-55*

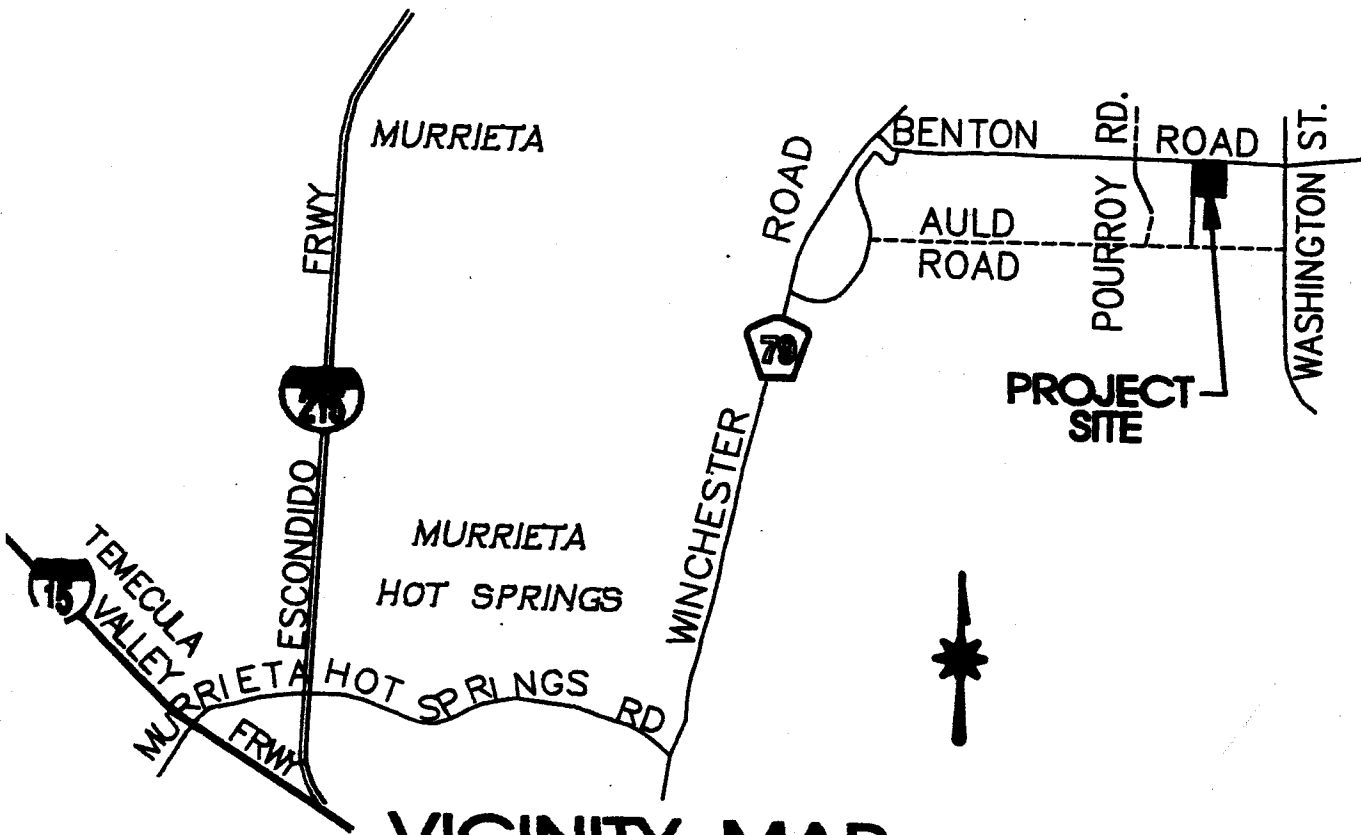

**VICINITY MAP**

**Not To Scale**

SUBMITTAL TO THE BOARD OF SUPERVISORS  
COUNTY OF RIVERSIDE, STATE OF CALIFORNIA

319B



FROM: TLMA - Transportation Department

SUBMITTAL DATE:  
October 5, 2007

SUBJECT: Tract 30656  
A Schedule "A" Subdivision in the Murrieta Area  
**Extension of Time Agreements**

RECOMMENDED MOTION: That the Board approve the attached agreements (which grant an extension of time for twelve months to complete improvements).

BACKGROUND: On July 26, 2005, the Board entered into agreements with Beazer Homes Holdings Corporation for the improvement of streets and the installation of a water and sewer system within the above referenced subdivision. Accompanying these agreements were faithful performance securities posted by Arch Insurance Company as follows:

- \$1,518,000 - Bond #SU5010780 for the completion of street improvements
- \$329,000 - Bond #SU5010780 for the completion of the water system
- \$244,500 - Bond #SU5010780 for the completion of the sewer system
- \$73,700 - Bond #SU5010781 for the completion of the monumentation

Departmental Concurrence

REVIEWED BY EXECUTIVE OFFICE

DATE: 9/25/07  
Tina Grande  
Tina Grande

George A. Johnson  
Director of Transportation

HS:lf  
Submittals: Vicinity Map  
Road/Drainage Agrmts.  
Water System Agrmts.  
Sewer System Agrmts.  
Survey Monument Agrmts.

Policy  
 Policy

Consent  
 Consent

Dept's Recomm.:  
Per Exec. Ofc.:

Prev. Agn. Ref. 07/26/05 - 2.27 | District: 3 | Agenda Number:

ATTACHMENTS FILED  
WITH THE CLERK OF THE BOARD

2.36

The Honorable Board of Supervisors

RE: Tract 30656

October 5, 2007

Page 2 of 2

The developer requests an extension of time for the completion of Tract 30656. Our records indicate that this project is approximately 71% completed for street and utility work. The agreements for the extension of time have been approved by County Counsel.

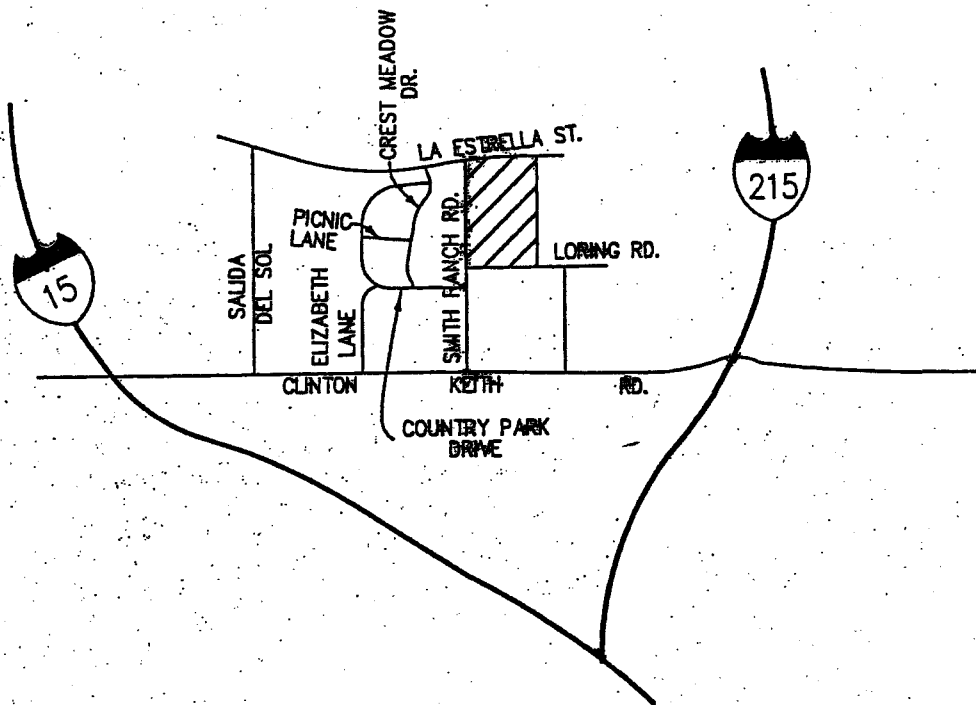

**VICINITY MAP** N.T.S.

**SEC 32 OF T.6S, R.3W**

SUBMITTAL TO THE BOARD OF SUPERVISORS  
COUNTY OF RIVERSIDE, STATE OF CALIFORNIA

310 B



FROM: TLMA - Transportation Department

SUBMITTAL DATE:  
September 24, 2007

SUBJECT: Tract 31019  
A Schedule "A" Subdivision in the Bermuda Dunes Area  
**Extension of Time Agreements**

**RECOMMENDED MOTION:** That the Board approve the attached agreements (which grant an extension of time for twelve months to complete improvements).

**BACKGROUND:** On January 11, 2005, the Board entered into agreements with GHA Paloma Group LLC for the improvement of streets and the installation of a water and sewer system within the above referenced subdivision. Accompanying these agreements were faithful performance securities posted by Insurance Company of the West as follows:

- \$1,155,500 - Bond #2136578 for the completion of street improvements
- \$307,500 - Bond #2136578 for the completion of the water system
- \$370,000 - Bond #2136578 for the completion of the sewer system
- \$67,000 - Bond #2136579 for the completion of the monumentation

Departmental Concurrence

REVIEWED BY EXECUTIVE OFFICE

DATE 9/25/07  
Ina Grande

  
George A. Johnson  
Director of Transportation

HS:lf  
Submittals: Final Map  
Road/Drainage Agrmts.  
Water System Agrmts.  
Sewer System Agrmts.  
Survey Monument Agrmts.

Policy  
 Policy

Consent  
 Consent

Dept't Recomm.:  
Per Exec. Ofc.:

Prev. Agn. Ref. 01/11/05 - 2.15 | District: 4 | Agenda Number:

ATTACHMENTS FILED  
WITH THE CLERK OF THE BOARD

2.37

The Honorable Board of Supervisors

RE: Tract 31019

September 24, 2007

Page 2 of 2

The developer requests an extension of time for the completion of Tract 31019. Our records indicate that this project is approximately 49% completed for street and utility work. The agreements for the extension of time have been approved by County Counsel.

# MOINITY MAP

N.T.S.

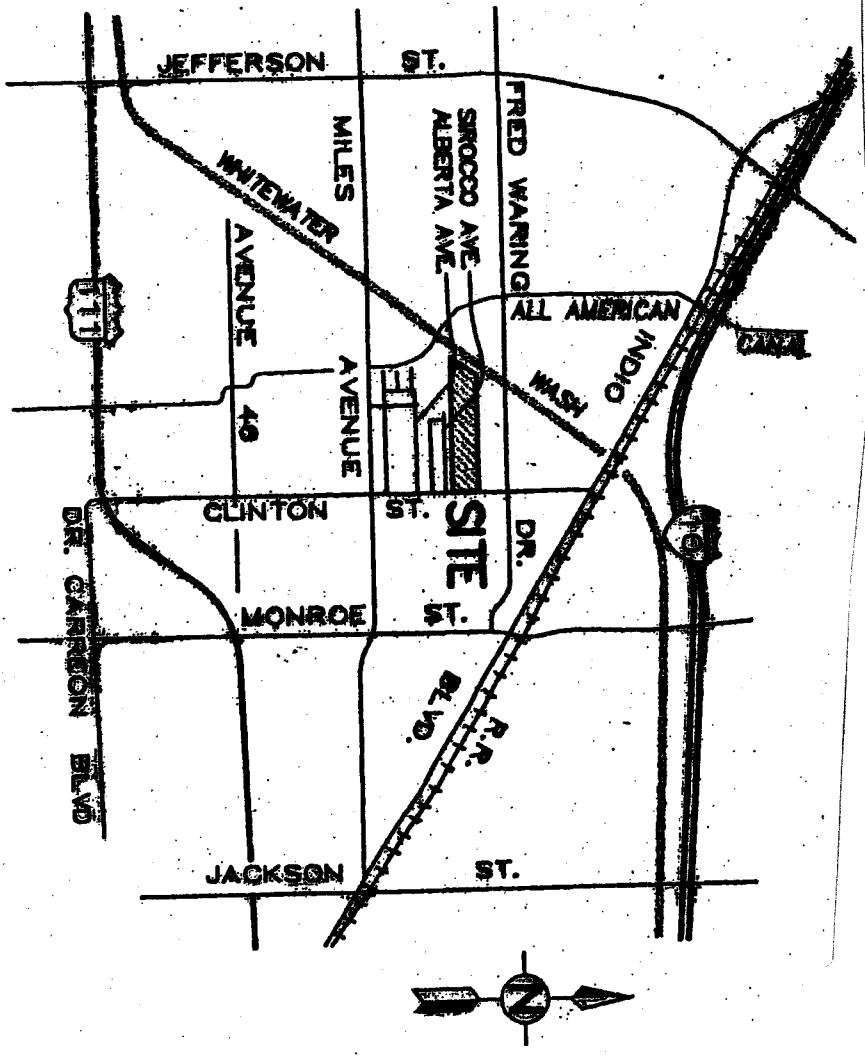

**SUBMITTAL TO THE BOARD OF SUPERVISORS  
COUNTY OF RIVERSIDE, STATE OF CALIFORNIA**

311 B

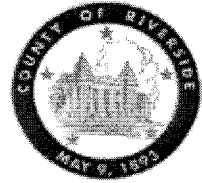

**FROM:** TLMA - Transportation Department

**SUBMITTAL DATE:**  
September 24, 2007

**SUBJECT:** Tract 31405  
A Schedule "A" Subdivision in the Eastvale Area  
**Extension of Time Agreements**

**RECOMMENDED MOTION:** That the Board approve the attached agreements (which grant an extension of time for twelve months to complete improvements).

**BACKGROUND:** On November 29, 2005, the Board entered into agreements with Lennar Homes of California, Inc. for the improvement of streets and the installation of a water and sewer system within the above referenced subdivision. Accompanying these agreements were faithful performance securities posted by Safeco Insurance Company of America as follows:

- \$1,574,500 - Bond #6349133 for the completion of street improvements
- \$170,000 - Bond #6349133 for the completion of the water system
- \$143,000 - Bond #6349133 for the completion of the sewer system
- \$43,500 - Bond #6349132 for the completion of the monumentation

Departmental Concurrence

REVIEWED BY EXECUTIVE OFFICE

DATE 9/25/07  
Tina Grande

George A. Johnson  
Director of Transportation

HS:lf  
Submittals: Final Map  
Road/Drainage Agrmts.  
Water System Agrmts.  
Sewer System Agrmts.  
Survey Monument Agrmts.

Policy  
 Policy

Consent  
 Consent

Dept't Recomm.:  
Per Exec. Ofc.:

Prev. Agn. Ref. 11/29/05 -2.7 | District: 2 | Agenda Number:

**ATTACHMENTS FILED  
WITH THE CLERK OF THE BOARD**

**2.38**

The Honorable Board of Supervisors

RE: Tract 31405

September 24, 2007

Page 2 of 2

The developer requests an extension of time for the completion of Tract 31405. Our records indicate that this project is approximately 90% completed for street and utility work. The agreements for the extension of time have been approved by County Counsel.

PROPOSED...  
...  
...



N  
N.T.S

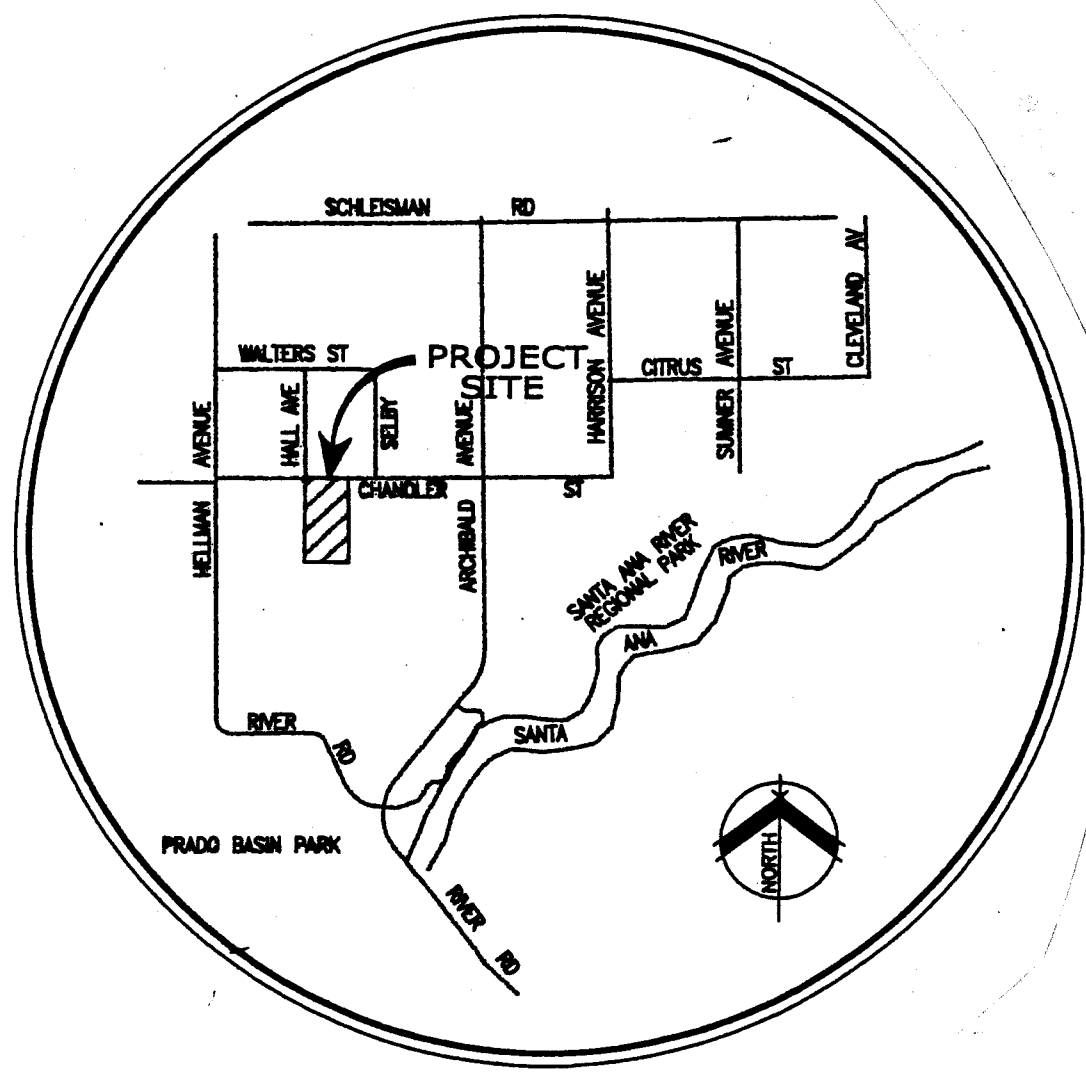

SUBMITTAL TO THE BOARD OF SUPERVISORS  
COUNTY OF RIVERSIDE, STATE OF CALIFORNIA

314 B



FROM: TLMA - Transportation Department

SUBMITTAL DATE:  
September 24, 2007

SUBJECT: Tract 31496  
A Schedule "A" Subdivision in the Eastvale Area  
**Extension of Time Agreements/Reduction of Securities**

RECOMMENDED MOTION: That the Board approve the attached agreements (which grant an extension of time for twelve months to complete improvements).

BACKGROUND: On June 7, 2005, the Board entered into agreements with DPDG Fund IX, LLC for the improvement of streets and the installation of a water and sewer system within the above referenced subdivision. Accompanying these agreements were faithful performance securities posted by Arch Insurance Company as follows:

- \$1,478,000 - Bond #SU5012142 for the completion of street improvements
- \$477,500 - Bond #SU5012142 for the completion of the water system
- \$295,500 - Bond #SU5012142 for the completion of the sewer system
- \$59,800 - Bond #SU5012143 for the completion of the monumentation (Continued)

Departmental Concurrence

REVIEWED BY EXECUTIVE OFFICE

DATE 9/25/07  
Tina Grande

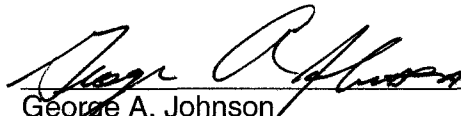
  
George A. Johnson  
Director of Transportation

HS:lf  
Submittals: Final Map  
Road/Drainage Agrmts.  
Water System Agrmts.  
Sewer System Agrmts.  
Survey Monument Agrmts.

Policy  
 Policy

Consent  
 Consent

Dep't Recomm.:  
Per Exec. Ofc.:

Prev. Agn. Ref. 06/07/05 - 2.30 | District: 2 | Agenda Number:

The Honorable Board of Supervisors

RE: Tract 31496

September 24, 2007

Page 2 of 2

The improvements for this project have been partially completed. The bond amounts have been recalculated to reflect current construction costs and are now posted as follows, by Arch Insurance Company:

\$300,000 - Bond #SU5012142 for the completion of street improvements

\$95,500 - Bond #SU5012142 for the completion of the water system

\$59,100 - Bond #SU5012142 for the completion of the sewer system

\$59,800 - Bond #SU5012143 for the completion of the monumentation

The developer requests an extension of time for the completion of Tract 31496. The agreements and reduced securities for the extension of time have been approved by County Counsel.

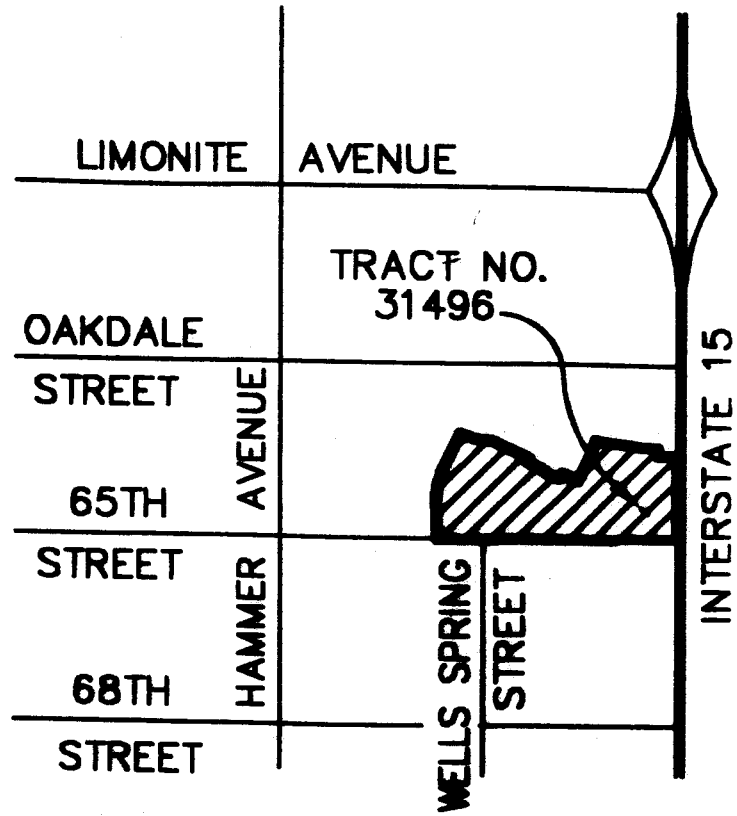

# VICINITY MAP

NO SCALE

SUBMITTAL TO THE BOARD OF SUPERVISORS  
COUNTY OF RIVERSIDE, STATE OF CALIFORNIA

3138

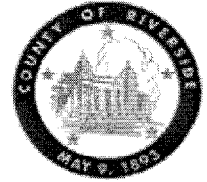

FROM: TLMA - Transportation Department

SUBMITTAL DATE:  
September 24, 2007

SUBJECT: Tract 31496-2  
A Schedule "A" Subdivision in the Eastvale Area  
**Extension of Time Agreements/Reduction of Securities**

**RECOMMENDED MOTION:** That the Board approve the attached agreements (which grant an extension of time for twelve months to complete improvements).

**BACKGROUND:** On June 7, 2005, the Board entered into agreements with DPDG Fund IX, LLC for the improvement of streets and the installation of a water and sewer system within the above referenced subdivision. Accompanying these agreements were faithful performance securities posted by Arch Insurance Company as follows:

- \$1,366,000 - Bond #SU5012146 for the completion of street improvements
- \$553,000 - Bond #SU5012146 for the completion of the water system
- \$586,000 - Bond #SU5012146 for the completion of the sewer system
- \$59,800 - Bond #SU5012147 for the completion of the monumentation **(Continued)**

Departmental Concurrence

REVIEWED BY EXECUTIVE OFFICE

DATE 9/25/07  
Tina Grande

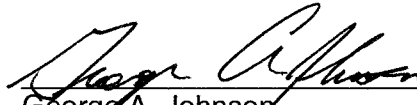
  
George A. Johnson  
Director of Transportation

HS:lf  
Submittals: Final Map  
Road/Drainage Agrmts.  
Water System Agrmts.  
Sewer System Agrmts.  
Survey Monument Agrmts.

Policy  
 Policy

Consent  
 Consent

Dep't Recomm.:  
Per Exec. Ofc.:

Prev. Agn. Ref. 06/07/05 - 2.32 | District: 2 | Agenda Number:

ATTACHMENTS FILED  
WITH THE CLERK OF THE BOARD

2.40

The Honorable Board of Supervisors  
RE: Tract 31496-2  
September 24, 2007  
Page 2 of 2

The improvements for this project have been partially completed. The bond amounts have been recalculated to reflect current construction costs and are now posted as follows, by Arch Insurance Company:

\$300,000 - Bond #SU5012146 for the completion of street improvements  
\$110,600 - Bond #SU5012146 for the completion of the water system  
\$117,200 - Bond #SU5012146 for the completion of the sewer system  
\$59,800 - Bond #SU5012147 for the completion of the monumentation

The developer requests an extension of time for the completion of Tract 31496-2. The agreements and reduced securities for the extension of time have been approved by County Counsel.



VICINITY MAP

NO SCALE

330A

**SUBMITTAL TO THE BOARD OF SUPERVISORS  
COUNTY OF RIVERSIDE, STATE OF CALIFORNIA**

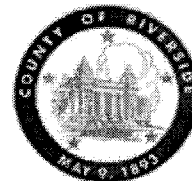

**FROM:** Treasurer-Tax Collector

**SUBMITTAL DATE:**  
September 10, 2007

**SUBJECT:** Treasurer: Monthly Disclosure Report on Investments

**RECOMMENDED MOTION:** That the Board of Supervisors receives and files the Treasurer's "Monthly Disclosure Report on Investments" dated August, 2007.

**BACKGROUND:** The County Treasurer and Tax Collector is submitting the above noted report to the County Board of Supervisors in keeping with Section 53607 of the California Government Code, which requires a quarterly report on the status of investments. The practice has been to provide the Board with a monthly report. The report gives the various statistics on the portfolio as to overall composition, liquidity structure, credit quality on the various securities, and provides several trends on earning performance, average weighted maturity, and the portfolio's "paper loss or gain".

Departmental Concurrence

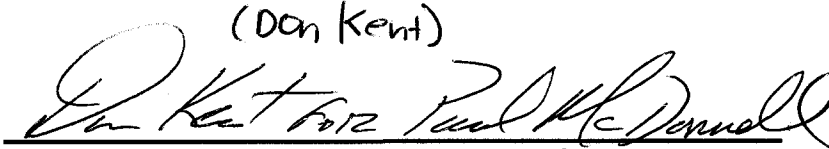
(Don Kent)  
  
Paul McDonnell, Treasurer-Tax Collector

<b>FINANCIAL DATA</b>	Current F.Y. Total Cost:	\$ 0	In Current Year Budget:	N/A
	Current F.Y. Net County Cost:	\$ 0	Budget Adjustment:	
	Annual Net County Cost:	\$ 0	For Fiscal Year:	2007-2008

<b>SOURCE OF FUNDS:</b>	Positions To Be Deleted Per A-30	<input type="checkbox"/>
	Requires 4/5 Vote	<input type="checkbox"/>

**C.E.O. RECOMMENDATION:**

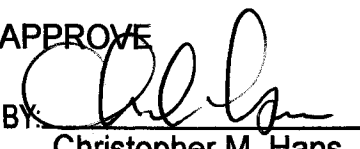
APPROVE  
  
BY: Christopher M. Hans

County Executive Office Signature

- Dept't Recomm.:  Consent  Policy
- Per Exec. Ofc.:  Consent  Policy

Prev. Agn. Ref.: | District: | Agenda Number:

2.41

ATTACHMENTS FILED  
WITH THE CLERK OF THE BOARD



COUNTY OF RIVERSIDE

**TREASURER'S POOLED INVESTMENT FUND**  
**MONTHLY REPORT**  
**AUGUST 2007**

**Investment Objectives**

**SAFETY OF  
 PRINCIPAL  
 PUBLIC TRUST  
 MAXIMUM RATE  
 OF RETURN**



**Capital Markets**

**Paul McDonnell**  
*Treasurer-Tax Collector*

**Don Kent**  
*Assistant Treasurer-Tax Collector*

**Jon Christensen**  
*Chief Deputy Treasurer*

**Giovane Pizano**  
*Investment Manager*

**Economic Indicators of Importance**

24-Aug	Durable Goods Orders (5.9% actual vs. 1% survey)
30-Aug	Gross Domestic Product (4% actual vs. 4% survey)
28-Aug	Consumer Confidence (105 actual vs. 105 survey)
31-Aug	Factory Orders (3.7% actual vs. 3.2% survey)
07-Sep	Unemployment Situation Rate (4.6% actual vs. 4.7% survey) Payroll change (-4000 actual vs. 100000 survey)
15-Aug	Consumer Price Index CPI (0.1% actual vs. 0.1% survey) Core CPI (0.2% actual vs. 0.2% survey)

**"A Subprime Meltdown, Part II"**

Just like nuclear fallout spreading with the wind, permeating and contaminating all it touches, so too has the lingering mortgage & housing market meltdown. Heavy declines in home sales due to rising interest rates and a shutdown of the easy money spigot has some debt investors reducing their holdings in what they perceive as riskier, speculative "subprime" investments. These investments can be somewhat illiquid in the best of times and when uncertainty occurs, can be very difficult to price. Case in point, during the height of pressure this month on Countrywide Corp., the nation's largest lender, we witnessed yields on their paper exceeding 18%!



This has caused investors to seek the usual flight to quality response with interest rates increasing on mortgage based investments while dropping dramatically on Treasuries. Moreover, this dislocation has spread to debt and equities alike, causing some of the greatest carnage in the asset-backed commercial paper markets.

The FED itself has acknowledged this problem and injected the market with liquidity, to the tune of tens of billions of dollars, as well as reducing the *discount rate* by 50 bps. on August 17<sup>th</sup>. Econ 101 - this rate cut was directed squarely at banks and other financial institutions in an attempt to stabilize and remind us all that they are there as the lender of last resort. This represents a major shift in the FED's policy to one of concern that the economy is slowing enough to warrant intervention; it wasn't long ago, fighting inflationary pressures was still on their minds.

We're not declaring that the sky is falling, but, it will take time for this story to play out. The economy is slowing, foreclosures are on the rise and consumers are not feeling as generous as they had earlier in the year. Let's hope that we're not on the verge of stagflation, as the FED is not equipped to fight that enemy. We expect the FOMC to cut the benchmark *FED funds* rate on September 18<sup>th</sup>.

**Paul McDonnell**  
 Treasurer-Tax Collector

**Portfolio Statistics**

	Month End Market Value*	Month End Book Value	Paper Gain or Loss (\$)	Paper Gain or Loss (%)	Book Yield	WAM (Yrs.)	Modified Duration
August	4,817,223,051.06	4,813,876,982.02	3,346,069.04	0.07%	5.19	1.06	0.98
July	4,762,169,767.44	4,766,207,466.04	(4,037,698.60)	-0.08%	5.17	1.13	1.04
June	4,752,010,568.00	4,757,119,372.00	(5,108,804.00)	-0.11%	5.16	1.14	1.06
May	4,993,963,302.00	4,999,179,741.00	(5,216,439.00)	-0.10%	5.16	1.07	0.99
April	5,483,370,456.00	5,484,286,694.00	(916,238.00)	-0.02%	5.13	0.99	0.91
March	4,697,880,401.00	4,700,110,339.00	(2,229,938.00)	-0.05%	5.09	0.96	0.88

\*Market values do not include accrued interest

RIVERSIDE COUNTY TREASURER'S POOLED INVESTMENT FUND IS CURRENTLY RATED:  
 Aaa/MRI BY MOODY'S INVESTOR SERVICES      AAA/VI+ BY FITCH RATINGS

### Market Snapshot

At month's end, the Fed Funds rate remained at 5.25%, with an inflation risk bias. The 2 year T-Note was yielding 4.15% (down 41 bps.) while the 10 year T-Note was yielding 4.54% (down 24 bps.) For August the Pool had an increase of 2 bps. in the average monthly yield.

### U.S. Government

5						
4.5						
4						
3.5						
3						
2.5						
2						
1.5						
1						
	3MO	6MO	2YR	5YR	10YR	30YR
	3 Mo US Treasury Bill	4.01	(0.95)			
	6 Mo US Treasury Bill	4.21	(0.78)			
	2 Yr US Treasury Note	4.15	(0.41)			
	5 Yr US Treasury Note	4.25	(0.35)			
	10 Yr US Treasury Note	4.54	(0.24)			
	FED Fund Rate	5.25	-			

### Other Markets

Crude Oil (barrel)	74.04	(4.17)
Gold (Ounce)	668.80	1.90

### Major Indices

DJIA	13,357.70	145.70
S&P 500	1,473.99	18.72
NASDAQ	2,596.36	50.09

### Portfolio Characteristics

#### Sector breakdown

	Market Value	WAM	Book Yield
Federal Agency	2,730,555,718	1.69	5.13
Cash Equivalent & MMF	281,000,000	0.08	5.19
Commercial Paper	907,426,083	0.12	5.33
Negotiable CDs	550,003,853	0.15	5.29
Medium Term Notes	284,522,953	0.71	5.28
Municipal Bonds	37,19,444	148	5.21
Certificates of Deposit	20,000,000	0.15	5.29
Local Agency Obligation	6,595,000	2.62	5.43
<b>TOTAL</b>	<b>4,817,223,051</b>	<b>1.06</b>	<b>5.19</b>

#### Maturity Distribution

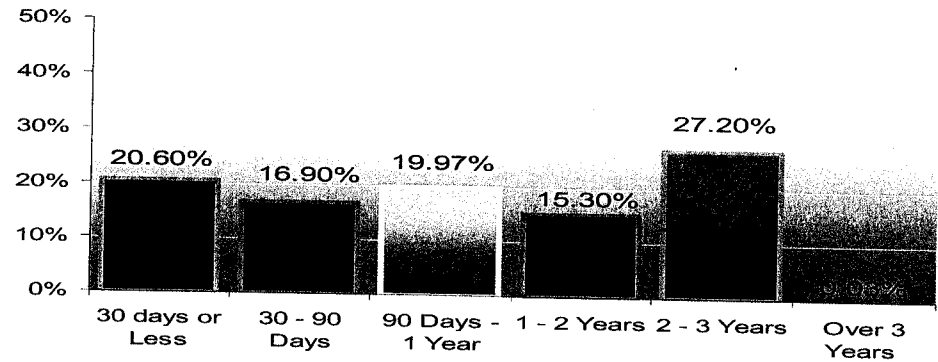

#### Credit Quality

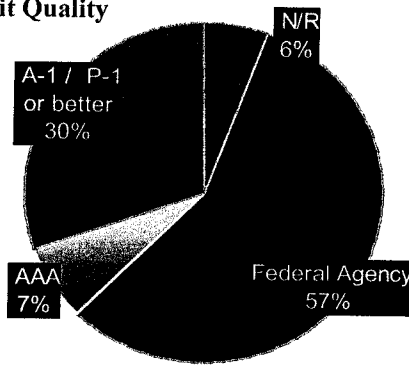

#### 12 Month Gross Yield Trends<sup>1</sup>

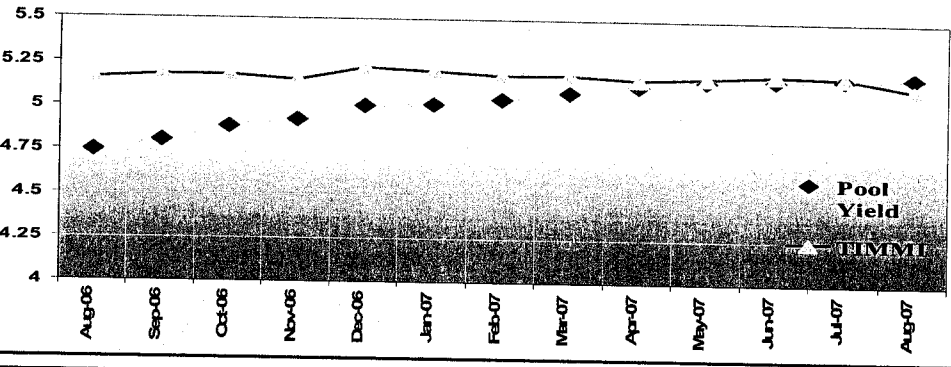

#### Cash Flows<sup>2</sup>

Month	Monthly Receipts	Monthly Disbmts	Difference	Required Mat. Invest	Balance	Actual Inv. Maturities	Avail. To Invest (> 1 Yr.)
09/2007				91.8	37.2		
09/2007	542.1	671.1	(129.0)			997.0	
10/2007	831.4	795.4	36.0		36.0	591.0	
11/2007	740.5	694.1	46.4		82.4	280.0	
12/2007	1,491.6	719.7	771.9		854.3	99.0	
01/2008	717.7	1,406.1	(688.4)		165.9	206.0	
02/2008	836.6	787.9	48.7		214.6	139.5	
03/2008	730.2	812.9	(82.7)		131.9	57.5	
04/2008	1,503.0	884.9	618.1		750.0	37.8	
05/2008	609.0	1,367.9	(758.9)		-	178.2	
06/2008	737.2	948.2	(211.0)		-	55.0	
07/2008	762.8	951.9	(189.1)		-	75.0	
08/2008	883.7	754.8	128.9		-	67.6	
<b>TOTALS</b>	<b>10,385.8</b>	<b>10,794.9</b>	<b>(409.1)</b>	<b>91.8</b>	<b>-</b>	<b>2,783.6</b>	<b>4,722.1</b>
				<b>1.91%</b>		<b>57.82%</b>	<b>98.09%</b>

<sup>1</sup> Treasurer's Institutional Money Market Index (TIMMI) is compiled and reported by the Riverside County Treasurer's Capital Markets division. It is a composite index derived from the average of three multi-billion dollar AAA rated Prime funds that invest in a diversified portfolio of U.S. dollar denominated money market instruments including U.S. Treasuries, government agencies, bankers' acceptances, commercial paper, certificates of deposits, repurchase agreements, etc.) portfolios that the Treasurer tracks. Further details available upon request.

<sup>2</sup> The Pooled Investment Fund cash flow requirements are based upon a 12 month historical cash flow model. Based upon projected cash receipts and maturing investments, there are sufficient funds to meet future cash flow disbursements over the next 12 months.

Microsoft Excel 2003

CUSIP	PAR	DESCRIPTION	COUPON	MATURITY	BOOK VALUE 1	PRICE	M. VALUE1	GAIN/LOSS	YLD MAT1	M DUR.4	AVG. LIFE2
<b>CASH - UBOC DEPOSIT ACCOUNT</b>											
	207,000,000.00	UBOC MANAGED RATE ACCOUNT	5.57	09/30/07	207,000,000.00	100.00	207,000,000.00	-	5.17	0.08	0.08
	207,000,000.00				207,000,000.00		207,000,000.00	-	5.17	0.08	0.08
<b>CLTR - CALTRUST SHORT TERM FUND</b>											
	54,000,000.00	CALTRUST SHORT TERM FUND	5.25	09/30/07	54,000,000.00	100.00	54,000,000.00	-	5.25	0.08	0.08
	54,000,000.00				54,000,000.00		54,000,000.00	-	5.25	0.08	0.08
<b>CPD - COMMERCIAL PAPER - DISCOUNT</b>											
78009BW40	50,000,000.00	ROYALBANK OF CANADA A1+/P1	5.23	09/04/07	49,302,666.67	98.61	49,302,666.67	-	5.30	0.01	0.01
4497W1W69	11,000,000.00	ING A1+/P1	5.18	09/06/07	10,762,583.33	97.84	10,762,583.33	-	5.29	0.01	0.02
74977LWH6	27,000,000.00	RABOBANK USA A1+/P1	5.28	09/17/07	26,877,356.25	99.55	26,877,356.25	-	5.30	0.04	0.05
9497F1WH9	50,000,000.00	WELLS FARGO A1+/P1	5.34	09/17/07	49,807,166.67	99.61	49,807,166.67	-	5.36	0.04	0.05
17307SWM0	50,000,000.00	CITIGROUP A1+/P1	5.23	09/21/07	49,462,472.22	98.92	49,462,472.22	-	5.29	0.05	0.06
4497W1WQ5	18,000,000.00	ING US FUNDING A1+/P1	5.40	09/24/07	17,924,400.00	99.58	17,924,400.00	-	5.42	0.06	0.07
78009BWQ1	25,000,000.00	ROYAL BANK OF CANADA A1+/P1	5.15	09/24/07	24,459,440.97	97.84	24,459,440.97	-	5.27	0.06	0.07
0556N1WS8	40,000,000.00	BNP PARIBAS A1+/P1	5.17	09/26/07	39,121,950.00	97.80	39,121,950.00	-	5.28	0.07	0.07
90282DWU5	50,000,000.00	UBS FINANCE A1+/P1	5.57	09/28/07	49,775,652.78	99.55	49,775,652.78	-	5.60	0.07	0.08
74977LWU7	50,000,000.00	RABOBANK A1+/P1	5.14	09/28/07	48,786,388.89	97.57	48,786,388.89	-	5.27	0.07	0.08
59018KX14	50,000,000.00	MERRILL LYNCH A1+/P1	5.20	10/01/07	49,111,666.67	98.22	49,111,666.67	-	5.29	0.08	0.08
06737JX18	50,000,000.00	BARCLAYS A1+/P1	5.36	10/01/07	49,650,111.11	99.30	49,650,111.11	-	5.40	0.08	0.08
89233HX17	50,000,000.00	TOYOTA MOTOR A1+/P1	5.25	10/01/07	49,664,583.33	99.33	49,664,583.33	-	5.29	0.08	0.08
40410TXA9	50,000,000.00	HBOS TSY SERVICE A1+/P1	5.15	10/10/07	48,705,347.22	97.41	48,705,347.22	-	5.29	0.11	0.11
40427SXR5	50,000,000.00	HSBC USA INC A1+/P1	5.16	10/25/07	48,696,930.56	97.39	48,696,930.56	-	5.29	0.15	0.15
0660P1XV8	50,000,000.00	BANK OF AMERICA A1+/P1	5.30	10/29/07	49,484,722.22	98.97	49,484,722.22	-	5.36	0.16	0.16
36959JXX6	50,000,000.00	GE CAPITAL A1+/P1	5.23	10/31/07	49,549,638.89	99.10	49,549,638.89	-	5.28	0.16	0.17
89233HXX7	30,000,000.00	TOYOTA A1+/P1	5.16	10/31/07	29,132,175.00	97.11	29,132,175.00	-	5.28	0.16	0.17
17307SY71	50,000,000.00	CITIGROUP A1+/P1	5.21	11/07/07	49,124,430.56	98.25	49,124,430.56	-	5.30	0.18	0.19
0660P1YW5	50,000,000.00	BANK OF AMERICA A1+/P1	5.35	11/30/07	49,256,944.44	98.71	49,353,500.00	96,555.56	5.43	0.24	0.25
89233HZU1	20,000,000.00	TOYOTA A1+/P1	5.22	12/28/07	19,652,000.00	98.30	19,659,400.00	7,400.00	5.31	0.32	0.33
36959HAG2	50,000,000.00	GE CAPITAL A1+/P1	5.15	01/16/08	49,005,763.89	98.03	49,013,500.00	7,736.11	5.25	0.37	0.38
	921,000,000.00				907,314,391.67		907,426,083.34	111,691.67	5.33	0.12	0.12
<b>FFCB - FED FARM CREDIT BANK</b>											
31331SSV6	10,000,000.00	FED FARM CREDIT BANK2.5YrNc3M	4.20	09/24/07	10,000,000.00	100.00	10,000,000.00	-	4.20	0.06	0.07
31331SMN0	5,000,000.00	FED FARM CREDIT BANK2.75YrNc3M	3.70	11/09/07	5,000,000.00	100.00	5,000,000.00	-	3.70	0.19	0.19
31331XGV8	10,000,000.00	FED FARM CREDIT BANK 1YrNc	4.88	12/11/07	9,978,800.00	99.88	9,987,500.00	8,700.00	5.10	0.27	0.28
31331XLZ3	5,000,000.00	FED FARM CREDIT BANK 1YrNc	5.13	01/18/08	4,997,200.00	99.94	4,996,900.00	(300.00)	5.18	0.37	0.38
31331SRM7	6,885,000.00	FED FARM CREDIT BANK2.92YrNc3M	4.13	02/14/08	6,885,000.00	99.50	6,850,575.00	(34,425.00)	4.13	0.44	0.46
31331VAE6	7,500,000.00	FED FARM CREDIT BANK2.5YrNc3Mo	4.54	03/27/08	7,495,312.50	99.66	7,474,200.00	(21,112.50)	4.57	0.55	0.57
31331SWM1	5,000,000.00	FED FARM CREDIT BANK3YrNc1Yr	4.23	05/09/08	5,000,000.00	99.44	4,971,900.00	(28,100.00)	4.23	0.66	0.69
31331SXB4	5,000,000.00	FED FARM CREDIT BANK3YrNc3Mo	4.34	05/19/08	5,000,000.00	99.47	4,973,450.00	(26,550.00)	4.34	0.69	0.72
31331VLG9	5,000,000.00	FED FARM CREDIT BANK2.4Nc	4.70	05/23/08	5,000,000.00	99.72	4,985,950.00	(14,050.00)	4.70	0.70	0.73
31331VLG9	8,000,000.00	FED FARM CREDIT BANK 2.4-NC	4.70	05/23/08	7,996,250.00	99.72	7,977,520.00	(18,730.00)	4.72	0.70	0.73
31331SD42	5,000,000.00	FED FARM CREDIT BANK3YrNc1Yr1X	4.13	06/30/08	5,000,000.00	99.28	4,964,050.00	(35,950.00)	4.13	0.81	0.83
31331SR39	10,000,000.00	FED FARM CREDIT BANK3YrNc6Mo	4.44	07/18/08	10,000,000.00	99.47	9,946,900.00	(53,100.00)	4.44	0.85	0.88
31331SQ63	10,000,000.00	FED FARM CREDIT BANK3YrNc3Mo	4.48	07/21/08	9,993,750.00	99.53	9,953,100.00	(40,650.00)	4.50	0.86	0.89
31331S263	10,000,000.00	FED FARM CREDIT BANK3YrNc1Yr	4.55	08/04/08	9,987,500.00	99.56	9,956,300.00	(31,200.00)	4.60	0.89	0.93
31331SAV2	5,000,000.00	FED FARM CREDIT BANK3YrNc1Yr1X	4.62	09/09/08	4,998,437.50	99.63	4,981,250.00	(17,187.50)	4.63	0.96	1.02
31331SAV2	5,000,000.00	FED FARM CREDIT BANK3YrNc1Yr1X	4.62	09/08/08	5,000,000.00	99.63	4,981,250.00	(18,750.00)	4.62	0.96	1.02
31331V6V3	10,000,000.00	FED FARM CREDIT BANK 2YrNc1Yr	5.13	10/10/08	9,997,100.00	99.97	9,996,900.00	(200.00)	5.14	1.04	1.11
31331V6V3	10,000,000.00	FED FARM CREDIT BANK 2YrNc1Yr	5.10	11/28/08	7,000,000.00	99.94	6,995,660.00	(4,340.00)	5.10	1.17	1.25
31331XES7	7,000,000.00	FED FARM CREDIT BANK 2YrNc1Yr	5.35	05/06/09	4,998,800.00	100.00	5,000,000.00	1,200.00	5.36	1.56	1.68
31331XCL4	5,000,000.00	FED FARM CREDIT BANK2.5YrNc3Mo	5.25	05/07/09	7,466,012.40	100.00	7,469,000.00	2,987.60	5.27	1.57	1.68
31331XXT4	7,469,000.00	FED FARM CREDIT BANK 2YrNc3Mo	5.25	05/07/09	4,997,150.00	100.06	5,003,150.00	6,000.00	5.17	1.61	1.73
31331XZC9	5,000,000.00	FED FARM CREDIT BANK 2YrNc1Yr	5.14	05/22/09	10,000,000.00	100.06	10,006,300.00	6,300.00	5.14	1.61	1.73
31331XZC9	10,000,000.00	FED FARM CREDIT BANK 2YrNc1Yr	5.14	05/22/09	10,000,000.00	100.06	10,006,300.00	6,300.00	5.14	1.61	1.73
31331XCZ3	5,000,000.00	FED FARM CREDIT BANK3YrNc1Yr1X	5.25	11/13/09	5,000,000.00	100.09	5,004,700.00	4,700.00	5.25	2.02	2.21
31331XMB5	5,000,000.00	FED FARM CREDIT BANK 3YrNc1Yr1X	5.25	01/25/10	5,000,000.00	100.16	5,007,800.00	7,800.00	5.25	2.22	2.41
31331XUB6	10,000,000.00	FED FARM CREDIT BANK 3YrNc1Yr	5.15	04/09/10	10,000,000.00	100.00	10,000,000.00	-	5.15	2.36	2.61
31331XUB6	5,000,000.00	FED FARM CREDIT BANK 3YrNc1Yr	5.15	04/09/10	5,000,000.00	100.00	5,000,000.00	-	5.15	2.36	2.61
31331XVL3	10,000,000.00	FED FARM CREDIT BANK 3YrNc1Yr	5.20	04/16/10	9,991,800.00	100.09	10,009,400.00	17,600.00	5.23	2.38	2.63
31331XVL3	5,000,000.00	FED FARM CREDIT BANK 3YrNc1Yr	5.20	04/16/10	4,995,150.00	100.09	5,004,700.00	9,550.00	5.24	2.38	2.63
31331XVL3	5,000,000.00	FED FARM CREDIT BANK 3YrNc1Yr	5.20	04/16/10	5,000,000.00	100.09	5,004,700.00	4,700.00	5.20	2.38	2.63
31331XW6	10,000,000.00	FED FARM CREDIT BANK 3YrNc1Yr	5.20	04/30/10	10,000,000.00	100.06	10,006,300.00	6,300.00	5.20	2.42	2.67
31331XZU9	5,000,000.00	FED FARM CREDIT BANK 3YrNc1Yr	5.24	06/04/10	5,000,000.00	100.16	5,007,800.00	7,800.00	5.24	2.51	2.76
31331XK43	5,000,000.00	FED FARM CREDIT BANK 3YrNc1Yr1X	5.45	07/09/10	5,000,000.00	100.47	5,023,450.00	23,450.00	5.45	2.59	2.86
31331XK43	5,000,000.00	FED FARM CREDIT BANK 3YrNc1Yr1X	5.45	07/09/10	4,993,000.00	100.47	5,023,450.00	30,450.00	5.50	2.59	2.86
31331XN73	5,000,000.00	FED FARM CREDIT BANK 3YrNc1Yr1X	5.45	07/30/10	5,000,000.00	100.56	5,028,150.00	28,150.00	5.50	2.65	2.92
31331XN73	5,000,000.00	FED FARM CREDIT BANK 3YrNc1Yr1X	5.45	07/30/10	5,000,000.00	100.56	5,028,150.00	28,150.00	5.50	2.65	2.92
31331XZN1	5,000,000.00	FED FARM CREDIT BANK3Nc3MoCONT	5.44	08/30/10	4,999,600.00	100.13	5,006,250.00	6,650.00	5.44	2.73	3.00
	236,854,000.00				236,770,862.40		236,598,555.00	(172,307.40)	4.89	1.37	1.49
<b>FHLB - FED HOME LOAN BANK</b>											
3133XCVT7	5,000,000.00	FED HOME LOAN BANK2YrNc3Mo	4.25	09/06/07	5,000,000.00	100.00	5,000,000.00	-	4.25	0.01	0.02
3133XERL5	5,000,000.00	FED HOME LOAN BANK1.5YrNc3Mo	5.04	09/06/07	5,000,000.00	100.00	5,000,000.00	-	5.04	0.01	0.02
3133XCY31	5,000,000.00	FED HOME LOAN BANK2YrNc1Yr1X	4.38	09/14/07	5,000,000.00	100.00	5,000,000.00	-	4.38	0.04	0.04
3133XAY27	10,000,000.00	FED HOME LOAN BANK2.5YrNc1Yr	4.00	09/24/07	10,000,000.00	100.00	10,000,000.00	-	4.00	0.06	0.07
3133XDBD2	5,000,000.00	FED HOME LOAN BANK2YrNc1Yr1X	4.25	09/26/07	4,988,281.25	99.77	4,988,281.25	-	4.37	0.07	0.07
3133XD6G1	5,000,000.00	FED HOME LOAN BANK2YrNc1Mo	4.35	09/28/07	5,000,000.00	100.00	5,000,000.00	-			

Treasurer's Pooled Investment Fund

AUGUST 31, 2007

CUSIP	PAR	DESCRIPTION	COUPON	MATURITY	BOOK VALUE 1	PRICE	M. VALUE1	GAIN/LOSS	YLD MAT1	M DUR.4	AVG. LIFE2
3133XDGC9	5,000,000.00	FED HOME LOAN BANK2YrNc1Yr1X	4.50	10/12/07							
3133XDGC9	5,000,000.00	FED HOME LOAN BANK2YrNc1Yr1X	4.50	10/12/07	5,000,000.00	100.00	5,000,000.00		4.50	0.11	0.12
3133XBFK6	5,000,000.00	FED HOME LOAN BANK2.5YrNc6Mo	4.50	10/19/07	5,000,000.00	100.00	5,000,000.00		4.50	0.11	0.12
3133XDGB1	1,000,000.00	FED HOME LOAN BANK2YrNc1Mo	4.63	10/25/07	5,000,000.00	100.00	5,000,000.00		4.50	0.13	0.13
3133XBMM4	5,000,000.00	FED HOME LOAN BANK 2.5YrNc3Mo	4.35	10/29/07	1,000,000.00	100.00	1,000,000.00		4.63	0.15	0.15
3133XCJS3	5,000,000.00	FED HOME LOAN BANK 2.25Nc6Mo	4.30	11/09/07	5,000,000.00	100.00	5,000,000.00		4.35	0.16	0.16
3133X9AM2	5,000,000.00	FED HOME LOAN BANK 3YrNc6Mo	3.40	11/09/07	5,000,000.00	100.00	5,000,000.00		4.30	0.18	0.19
3133XD2D2	5,000,000.00	FED HOME LOAN BANK2.25Nc3Mo	4.42	11/16/07	5,000,000.00	100.00	5,000,000.00		3.40	0.19	0.19
3133X96N5	5,000,000.00	FED HOME LOAN BANK 3YrNc1Mo	3.50	11/16/07	4,996,875.00	99.94	4,996,875.00		4.45	0.20	0.21
3134A4VF8	5,000,000.00	FED HOME LOAN BANK 1YrNc	4.38	11/16/07	5,000,000.00	100.00	5,000,000.00		3.50	0.20	0.21
3133XAPC5	10,000,000.00	FED HOME LOAN BANK 2.75YrNc1Mo	4.00	12/04/07	4,989,950.00	99.80	4,989,950.00		4.48	0.20	0.21
3133XBVA0	5,000,000.00	FED HOME LOAN BANK 2.5YrNc6Mo	4.26	12/07/07	9,997,500.00	99.69	9,968,800.00	(28,700.00)	4.01	0.25	0.26
3133XBYQ2	5,000,000.00	FED HOME LOAN BANK 2.5YrNc6Mo	4.19	12/14/07	5,000,000.00	99.75	4,987,500.00	(12,500.00)	4.26	0.26	0.27
3133XAYA9	10,000,000.00	FED HOME LOAN BANK 2.75 YrNc1Y	4.05	12/24/07	5,000,000.00	99.69	4,984,400.00	(15,600.00)	4.19	0.28	0.29
3133XDB75	5,000,000.00	FED HOME LOAN BANK2.25YrNc1Yr1	4.27	12/28/07	10,000,000.00	99.63	9,962,500.00	(37,500.00)	4.05	0.31	0.32
3133X9TN0	5,000,000.00	FED HOME LOAN BANK 3YrNc1Mo	4.00	12/28/07	4,991,406.25	99.72	4,985,950.00	(5,456.25)	4.05	0.31	0.32
3133XJKP2	10,000,000.00	FED HOME LOAN BANK 1YrNc6Mo1X	5.25	01/11/08	5,000,000.00	99.59	4,979,700.00	(20,300.00)	4.35	0.32	0.33
3133XJMP0	13,000,000.00	FED HOME LOAN BANK 1YrNc	5.13	01/16/08	10,000,000.00	100.00	10,000,000.00		4.00	0.32	0.33
3133XBN43	5,000,000.00	FED HOME LOAN BANK 2.5YrNc3Mo	4.43	01/29/08	12,996,100.00	99.94	12,991,940.00	(4,160.00)	5.25	0.35	0.36
3133XAE86	10,000,000.00	FED HOME LOAN BANK 3YrNc3Mo	4.00	02/04/08	4,999,218.75	99.69	4,984,400.00	(14,818.75)	4.44	0.40	0.41
3133XAE86	10,000,000.00	FED HOME LOAN BANK3YrNc3Mo	4.00	02/04/08	10,000,000.00	99.69	9,946,900.00	(53,100.00)	4.00	0.42	0.43
3133XDVA6	5,000,000.00	FED HOME LOAN BANK2.25YrNc3Mo	5.00	02/28/08	10,000,000.00	99.47	9,946,900.00	(53,100.00)	4.00	0.42	0.43
3133XAT56	10,000,000.00	FED HOME LOAN BANK3YrNc1Yr1X	4.00	03/10/08	5,000,000.00	99.84	4,992,200.00	(7,800.00)	5.00	0.48	0.50
3133XASMO	10,000,000.00	FED HOME LOAN BANK3YrNc3Mo	4.02	03/14/08	10,000,000.00	99.34	9,934,400.00	(65,600.00)	4.00	0.51	0.53
3133XHAQ5	6,465,000.00	FED HOME LOAN BANK 1.5YrNc3Mo	5.32	04/10/08	10,000,000.00	100.00	9,934,400.00	(65,600.00)	4.02	0.52	0.54
3133XBGRO	5,000,000.00	FED HOME LOAN BANK 3YrNc1Yr1X	4.60	04/11/08	4,969,306.66	99.63	4,981,250.00	11,943.34	5.03	0.58	0.61
3133XGRV8	5,000,000.00	FED HOME LOAN BANK1.75YrNc1Yr1X	5.35	05/30/08	5,000,000.00	99.91	4,995,300.00	(4,700.00)	5.00	0.72	0.75
3133XJBE3	10,000,000.00	FED HOME LOAN BANK1.5YrNc1MBerm	5.38	06/13/08	5,000,000.00	100.00	5,000,000.00		5.35	0.75	0.79
3133XC225	5,000,000.00	FED HOME LOAN BANK 2YrNc1Yr	4.00	06/30/08	9,998,500.00	100.00	9,998,500.00		5.39	0.76	0.80
3133XC7D9	5,000,000.00	FED HOME LOAN BANK3YrNc1Mo	4.45	07/08/08	5,000,000.00	99.13	4,956,250.00	(43,750.00)	4.00	0.81	0.83
3133XCBF9	5,000,000.00	FED HOME LOAN BANK3YrNc6Mo	4.38	07/11/08	5,000,000.00	99.50	4,975,000.00	(25,000.00)	4.45	0.82	0.85
3133XLPU1	5,000,000.00	FED HOME LOAN BANK 1YrNc6Mo1X	5.33	07/23/08	5,000,000.00	99.44	4,971,900.00	(28,100.00)	4.38	0.83	0.86
3133XEEH8	10,000,000.00	FED HOME LOAN BANK2.5YrNc1Yr1X	4.90	07/24/08	5,000,000.00	100.09	5,004,700.00	4,700.00	5.33	0.86	0.90
3133XCK36	5,000,000.00	FED HOME LOAN BANK3YrNc3Mo	4.52	07/29/08	9,912,000.00	99.91	9,990,600.00	78,600.00	5.37	0.86	0.90
3133XCJ46	5,000,000.00	FED HOME LOAN BANK3YrNc1Yr1X	4.40	07/29/08	5,000,000.00	99.56	4,978,150.00	(21,850.00)	4.52	0.88	0.91
3133XCJ20	5,000,000.00	FED HOME LOAN BANK3YrNc6Mo	4.45	08/01/08	5,000,000.00	99.47	4,973,450.00	(26,550.00)	4.40	0.88	0.91
3133XJRT7	2,500,000.00	FED HOME LOAN BANK 1.5YrNc3Mo	5.33	08/08/08	5,000,000.00	99.50	4,975,000.00	(25,000.00)	4.45	0.89	0.92
3133XCS61	5,000,000.00	FED HOME LOAN BANK3YrNc6Mo	4.75	08/15/08	2,500,000.00	100.03	2,500,775.00	775.00	5.33	0.90	0.94
3133xjq5	10,000,000.00	FED HOME LOAN BANK 1.5YrNc3Mo	5.30	08/15/08	4,997,500.00	99.69	4,984,400.00	(13,100.00)	4.77	0.92	0.96
3133xjq5	5,000,000.00	FED HOME LOAN BANK 1.5YrNc3Mo	5.30	08/15/08	10,000,000.00	100.03	10,003,100.00	3,100.00	5.30	0.92	0.96
3133XCUH4	5,000,000.00	FED HOME LOAN BANK3Nc6Mo	4.75	09/02/08	5,000,000.00	99.75	5,001,550.00	1,550.00	5.30	0.92	0.96
3133XCXYK3	5,000,000.00	FED HOME LOAN BANK3YrNc6Mo	4.69	09/09/08	5,000,000.00	99.75	4,987,500.00	(12,500.00)	4.75	0.95	1.01
3133XGTT1	5,000,000.00	FED HOME LOAN BANK 2YrNc1Yr1X	5.40	09/18/08	4,998,437.50	99.72	4,985,950.00	(12,487.50)	4.70	0.97	1.03
3133XGUJ1	5,000,000.00	FED HOME LOAN BANK 2YrNc6Mo	5.35	09/26/08	5,000,000.00	100.03	5,001,550.00	1,550.00	5.40	0.97	1.03
3133XJS25	5,000,000.00	FED HOME LOAN BANK 1.75-nc3berm	5.30	11/07/08	4,999,050.00	100.00	5,000,000.00	950.00	5.36	1.00	1.05
3133XBX77	5,000,000.00	FED HOME LOAN BANK 3.5YrNc1Yr	4.25	12/01/08	5,000,000.00	100.03	5,001,550.00	1,550.00	5.30	1.12	1.19
3133XEBO1	5,000,000.00	FED HOME LOAN BANK3YrNc1Yr	5.09	01/12/09	5,000,000.00	99.94	4,959,400.00	(40,600.00)	4.25	1.19	1.25
3133XJNJ3	5,000,000.00	FED HOME LOAN BANK 2YrNc3Mo	5.50	01/23/09	5,000,000.00	100.09	4,996,900.00	(3,100.00)	5.09	1.29	1.37
3133XJP77	5,000,000.00	FED HOME LOAN BANK2-NC6Mo	5.27	02/02/09	5,000,000.00	100.09	5,004,700.00	4,700.00	5.50	1.32	1.40
3133XJPV4	5,000,000.00	FED HOME LOAN BANK 3YrNc1Yr1X	5.30	02/05/09	4,997,656.25	100.00	5,000,000.00	2,343.75	5.29	1.35	1.43
3133XJZF8	9,000,000.00	FED HOME LOAN BANK 2YrNc1Yr1X	5.25	02/27/09	5,000,000.00	100.13	5,006,250.00	6,250.00	5.30	1.35	1.44
3133XKA47	5,000,000.00	FED HOME LOAN BANK 2YrNc3Mo	5.38	03/19/09	9,000,000.00	100.09	9,008,460.00	8,460.00	5.24	1.41	1.50
3133XKEY7	15,000,000.00	FED HOME LOAN BANK 2YrNc1Mo	5.50	04/17/09	5,000,000.00	100.03	5,001,550.00	1,550.00	5.38	1.43	1.55
3133XKVD4	10,000,000.00	FED HOME LOAN BANK 2YrNc1Mo	5.50	05/21/09	15,000,000.00	100.03	15,004,650.00	4,650.00	5.50	1.51	1.63
3133XKTZ8	5,000,000.00	FED HOME LOAN BANK 2YrNc6Mo1X	5.30	05/26/09	10,000,000.00	100.03	10,003,100.00	3,100.00	5.50	1.60	1.72
3133XKZQ1	15,000,000.00	FED HOME LOAN BANK 2YrNc1Yr1X	5.25	06/11/09	4,999,500.00	100.09	5,004,700.00	5,200.00	5.31	1.62	1.74
3133XLDP5	10,000,000.00	FED HOME LOAN BANK 2YrNc1Yr1X	5.45	06/12/09	15,000,000.00	100.22	15,032,850.00	32,850.00	5.25	1.66	1.78
3133XLBV8	5,000,000.00	FED HOME LOAN BANK 2YrNc1Yr1X	5.38	06/18/09	10,000,000.00	100.41	10,040,600.00	40,600.00	5.44	1.66	1.78
3133XFSN7	10,000,000.00	FED HOME LOAN BANK3YrNc2Yr1X	5.42	06/30/09	4,998,500.00	100.34	5,017,200.00	17,700.00	5.38	1.68	1.80
3133XFZY5	10,000,000.00	FED HOME LOAN BANK3YrNc2Yr1X	5.59	07/14/09	10,000,000.00	100.41	10,040,600.00	40,600.00	5.42	1.71	1.83
3133XGBF0	5,000,000.00	FED HOME LOAN BANK 3-NC2 1X	5.63	07/21/09	10,000,000.00	100.59	10,059,400.00	59,400.00	5.59	1.74	1.87
3133XGBF0	5,000,000.00	FED HOME LOAN BANK 3-NC2 1X	5.63	07/21/09	5,000,000.00	100.66	5,032,800.00	32,800.00	5.63	1.76	1.89
3133XHDJ8	30,000,000.00	FED HOME LOAN BANK2.75YrNc3Mo	5.40	07/24/09	5,000,000.00	100.66	5,032,800.00	32,800.00	5.63	1.76	1.89
3133XJXN3	10,000,000.00	FED HOME LOAN BANK 2.5YrNc6Mo	5.37	08/28/09	30,000,000.00	100.09	30,028,200.00	28,200.00	5.40	1.77	1.90
3133XJYC6	5,000,000.00	FED HOME LOAN BANK 2.5YrN6Berm	5.50	09/04/09	10,000,000.00	100.00	10,000,000.00		5.37	1.86	1.99
3133XGNF7	10,000,000.00	FED HOME LOAN BANK3YrNc2Yr1X	5.33	09/08/09	5,000,000.00	100.00	5,000,000.00		5.50	1.83	2.01
3133XGSL9	10,000,000.00	FED HOME LOAN BANK3YrNc2Yr1X	5.26	09/09/09	10,000,000.00	100.47	10,046,900.00	46,900.00	5.33	1.84	2.02
3133XH2L5	10,000,000.00	FED HOME LOAN BANK3YrNc1.5Yr1X	5.28	09/24/09	10,000,000.00	100.41	10,040,600.00	40,600.00	5.26	1.85	2.03
3133XH3F7	5,000,000.00	FED HOME LOAN BANK3YrNc1.5Yr1X	5.32	09/28/09	9,997,656.25	100.25	10,025,000.00	27,343.75	5.29	1.89	2.07
3133XH2M3	10,000,000.00	FED HOME LOAN BANK 3YrNc1.5Yr1X	5.30	09/28/09	5,000,000.00	100.25	5,012,500.00	12,500.00	5.32	1.90	2.08
3133XH2M3	5,000,000.00	FED HOME LOAN BANK3YrNc1.5Yr1X	5.30	09/28/09	10,000,000.00	100.25	10,025,000.00	25,000.00	5.30	1.90	2.08
3133XH3P5	5,000,000.00	FED HOME LOAN BANK 3YrNc2Yr1X	5.26	09/29/09	5,000,000.00	100.25	5,012,500.00	12,500.00	5.30	1.90	2.08
3133XKE35	5,000,000.00	FED HOME LOAN BANK 2YrNc3Mo	5.50	10/05/09	5,000,000.00	100.41	5,020,300.00	20,300.00	5.26	1.90	2.08
3133XHF45	10,000,000.00	FED HOME LOAN BANK 3YrNc2Yr1X	5.00	10/16/09	5,000,000.00	100.06	5,003,150.00	3,150.00	5.50	1.91	2.08
3133XHF45	5,000,000.00	FED HOME LOAN BANK 3YrNc2Yr1X	5.00	10/16/09	9,990,400.00	100.09	10,009,400.00	19,400.00	5.04	1.96	2.13
3133XHF45	5,000,000.00	FED HOME LOAN BANK 3YrNc2Yr1X	5.00	10/16/09	5,000,000.00	100.09	5,004,700.00	4,700.00	5.00	1.96	2.13

Treasurer's Pooled Investment Fund

CUSIP	PAR	DESCRIPTION	COUPON	MATURITY	BOOK VALUE 1	PRICE	M. VALUE1	GAIN/LOSS	YLD MAT1	M DUR.4	AVG. LIFE2
3133XHFA5	5,000,000.00	FED HOME LOAN BANK 3YrNc2Yr1X	5.00	10/16/09	5,000,000.00	100.09	5,004,700.00	4,700.00	5.00	1.96	2.13
3133XHFA5	5,000,000.00	FED HOME LOAN BANK 3YrNc2Yr21X	5.00	10/16/09	5,000,000.00	100.09	5,004,700.00	4,700.00	5.00	1.96	2.13
3133XHEK4	10,000,000.00	FED HOME LOAN BANK3YrNc1.5Yr1X	5.10	10/16/09	10,000,000.00	100.09	10,009,400.00	9,400.00	5.10	1.95	2.13
3133XHFA5	5,000,000.00	FED HOME LOAN BANK 3YrNc2Yr1X	5.00	10/16/09	4,988,300.00	100.09	5,004,700.00	16,400.00	5.09	1.96	2.13
3133XKHQ1	30,000,000.00	FED HOME LOAN BANK 2YrNc3Mo	5.50	10/16/09	30,000,000.00	100.09	30,028,200.00	28,200.00	5.50	1.94	2.13
3133XHFB0	10,000,000.00	FED HOME LOAN BANK3YrNc1YrBERM	5.05	10/23/09	10,000,000.00	100.06	10,006,300.00	6,300.00	5.05	1.97	2.15
3133XHMV1	5,000,000.00	FED HOME LOAN BANK3YrNc2Yr1X	5.20	10/30/09	5,000,000.00	100.38	5,018,750.00	18,750.00	5.20	1.99	2.17
3133XHL4	10,000,000.00	FED HOME LOAN BANK3YrNc1.5Yr1X	5.25	11/02/09	10,000,000.00	100.25	10,025,000.00	25,000.00	5.25	1.99	2.18
3133XHL2	5,000,000.00	FED HOME LOAN BANK3YrNc2Yr1X	5.25	11/03/09	5,000,000.00	100.44	5,021,900.00	21,900.00	5.25	2.00	2.18
3133XH97	5,000,000.00	FED HOME LOAN BANK3YrNc6Mo	5.50	11/03/09	4,998,750.00	100.00	5,000,000.00	1,250.00	5.51	1.99	2.18
3133XHHN5	5,000,000.00	FED HOME LOAN BANK3YrNc6Mo	5.50	11/03/09	4,999,218.75	100.09	5,004,700.00	5,481.25	5.51	1.99	2.18
3133XHS94	5,000,000.00	FED HOME LOAN BANK3YrNc1Yr1X	5.25	11/13/09	4,995,000.00	100.09	5,004,700.00	9,700.00	5.29	2.02	2.21
3133XHXE7	10,000,000.00	FED HOME LOAN BANK3YrNc3MoBerm	5.50	12/08/09	10,000,000.00	100.00	10,000,000.00	-	5.50	2.08	2.27
3133XJ2E7	30,000,000.00	FED HOME LOAN BANK 3YrNc1Mo	5.32	12/22/09	30,000,000.00	100.03	30,009,300.00	9,300.00	5.32	2.13	2.31
3133XJD47	10,000,000.00	FED HOME LOAN BANK3YrNc1.5YrBerm	5.08	12/30/09	10,000,000.00	100.03	10,003,100.00	3,100.00	5.08	2.16	2.33
3133XJHL5	15,000,000.00	FED HOME LOAN BANK 3YrNc3Mo	5.50	01/26/10	15,000,000.00	100.09	15,014,100.00	14,100.00	5.50	2.21	2.41
3133XJPS1	5,000,000.00	FED HOME LOAN BANK 3YrNc1Yr	5.32	02/05/10	4,994,500.00	100.13	5,008,250.00	11,750.00	5.36	2.24	2.44
3133XK4F9	15,000,000.00	FED HOME LOAN BANK 3YrNc1Mo	5.50	03/05/10	15,000,000.00	100.00	15,000,000.00	-	5.50	2.26	2.51
3133XJXG8	5,000,000.00	FED HOME LOAN BANK 3YrNc3Mo	5.50	03/08/10	5,000,000.00	100.00	5,000,000.00	-	5.50	2.26	2.52
3133XJYE2	10,000,000.00	FED HOME LOAN BANK 3YrNc6Mo	5.50	03/12/10	10,000,000.00	100.00	10,000,000.00	-	5.50	2.27	2.53
3133XKG90	50,000,000.00	FED HOME LOAN BANK 3YrNc1Mo	5.50	04/09/10	50,000,000.00	100.00	50,000,000.00	-	5.50	2.35	2.61
3133XKGU3	5,000,000.00	FED HOME LOAN BANK 3YrNc2Yr1X	5.03	04/16/10	5,000,000.00	100.25	5,012,500.00	12,500.00	5.03	2.39	2.63
3133XKG76	10,000,000.00	FED HOME LOAN BANK 3YrNc3Mo	5.55	04/19/10	10,000,000.00	100.09	10,009,400.00	9,400.00	5.55	2.37	2.64
3133XKLV5	15,000,000.00	FED HOME LOAN BANK 3YrNc6Mo	5.10	04/30/10	15,000,000.00	100.13	15,018,750.00	18,750.00	5.10	2.42	2.67
3133XKQL2	12,000,000.00	FED HOME LOAN BANK 3YrNc1.5Yr1X	5.08	05/07/10	12,000,000.00	100.19	12,022,560.00	22,560.00	5.08	2.44	2.68
3133XKNB7	5,000,000.00	FED HOME LOAN BANK 3YrNc1Yr1X	5.25	05/07/10	4,999,218.75	100.22	5,010,950.00	11,731.25	5.26	2.43	2.68
3133XKSZ9	4,235,000.00	FED HOME LOAN BANK 3-Nc2 1Y	5.00	05/11/10	4,235,000.00	100.19	4,242,961.80	7,961.80	5.00	2.46	2.70
3133XL4P5	5,000,000.00	FED HOME LOAN BANK 3YrNc1Yr1X	5.30	06/04/10	5,000,000.00	100.28	5,014,050.00	14,050.00	5.30	2.50	2.76
3133XKY82	10,000,000.00	FED HOME LOAN BANK3YrNc1.5Yr1X	5.15	06/11/10	10,000,000.00	100.31	10,031,300.00	31,300.00	5.15	2.53	2.78
3133XL7H0	5,000,000.00	FED HOME LOAN BANK 3YrNc2Yr1X	5.28	06/11/10	5,000,000.00	100.75	5,037,500.00	37,500.00	5.28	2.52	2.78
3133XLB79	15,000,000.00	FED HOME LOAN BANK 3YrNc2Yr1X	5.35	06/25/10	15,000,000.00	100.91	15,135,900.00	135,900.00	5.35	2.56	2.82
3133XLFZ1	5,000,000.00	FED HOME LOAN BANK 3YrNc2Yr	5.50	06/29/10	5,000,000.00	101.19	5,059,400.00	59,400.00	5.50	2.56	2.83
3133XM2U4	5,000,000.00	FED HOME LOAN BANK 3YrNc3Mo	5.75	08/20/10	5,000,000.00	100.22	5,010,950.00	10,950.00	5.75	2.69	2.97
	928,200,000.00				927,989,519.16		928,550,396.80	560,877.64	5.07	1.46	1.59
<b>FHLC - FHLL - MORTG. CERT.</b>											
3128X35Z2	10,000,000.00	FHLL - MORTG. CERT.2.5YrNc6Mo	4.00	09/24/07	10,000,000.00	100.00	10,000,000.00	-	4.00	0.06	0.07
3128X4KE0	5,000,000.00	FHLL - MORTG. CERT.2YrNc6Mo	4.75	09/27/07	5,000,000.00	100.00	5,000,000.00	-	4.00	0.07	0.07
3128X4PX3	5,000,000.00	FHLL - MORTG. CERT.2YrNc1Yr1X	4.50	10/11/07	5,000,000.00	100.00	5,000,000.00	-	4.74	0.11	0.11
3128X4RL7	5,000,000.00	FHLL - MORTG. CERT.2YrNc6Mo1X	4.71	10/11/07	5,000,000.00	100.00	5,000,000.00	-	4.71	0.11	0.11
3128X4PX3	5,000,000.00	FHLL - MORTG. CERT.2YrNc1Yr1X	4.50	10/11/07	5,000,000.00	100.00	5,000,000.00	-	4.74	0.11	0.11
3128X4PK1	5,000,000.00	FHLL - MORTG. CERT.2Nc6Mo	5.00	10/19/07	5,000,000.00	100.00	5,000,000.00	-	4.60	0.13	0.13
3128X4AL5	5,000,000.00	FHLL - MORTG. CERT.2.5YrNc6Mo	4.20	11/09/07	5,000,000.00	100.00	5,000,000.00	-	4.20	0.19	0.19
3128X4UK5	5,000,000.00	FHLL - MORTG. CERT.2YrNc6Mo	4.50	12/05/07	5,000,000.00	99.92	4,995,950.00	(4,050.00)	5.00	0.25	0.26
3128X4XN6	10,000,000.00	FHLL - MORTG. CERT.2YrNc1Yr1X	4.82	01/11/08	10,000,000.00	99.84	9,983,800.00	(16,200.00)	4.82	0.35	0.36
3128X4XW6	10,000,000.00	FHLL - MORTG. CERT.2YrNc6Mo1X	5.00	01/18/08	10,000,000.00	99.90	9,989,600.00	(10,400.00)	5.00	0.37	0.38
3128X4YF2	5,000,000.00	FHLL - MORTG. CERT.2YrNc6Mo	5.00	01/28/08	5,000,000.00	99.88	4,994,000.00	(6,000.00)	5.00	0.40	0.41
3128X4Y88	5,000,000.00	FHLL - MORTG. CERT.1.75-NC3MO	5.30	01/31/08	5,000,000.00	99.99	4,999,700.00	(300.00)	5.30	0.41	0.42
3128X4Y88	15,000,000.00	FHLL - MORTG. CERT.1.75-NC3MO	5.30	01/31/08	15,000,000.00	99.99	14,999,100.00	(900.00)	5.30	0.41	0.42
3128X4QC61	10,000,000.00	FHLL - MORTG. CERT.2-NC1 BERM	5.13	03/17/08	10,000,000.00	99.91	9,991,200.00	(8,800.00)	5.13	0.52	0.55
3128X36H1	10,000,000.00	FHLL - MORTG. CERT.3YrNc6Mo	4.18	03/28/08	10,000,000.00	99.40	9,940,200.00	(59,800.00)	4.18	0.55	0.58
3128X4AS0	5,000,000.00	FHLL - MORTG. CERT.3YrNc1Yr	4.30	05/05/08	5,000,000.00	99.42	4,971,100.00	(28,900.00)	4.30	0.65	0.68
3128X42D2	10,000,000.00	FHLL - MORTG. CERT.2.1YrNc6Mo	5.34	05/07/08	10,000,000.00	100.00	10,000,000.00	-	5.34	0.65	0.68
3128X42E0	10,000,000.00	FHLL - MORTG. CERT.2.1YrNc6Mo	5.35	05/22/08	10,000,000.00	100.00	10,000,100.00	100.00	5.35	0.69	0.73
3128X4VS7	10,000,000.00	FHLL - MORTG. CERT.2.5YrNc6Mo1	5.00	06/16/08	10,000,000.00	99.93	9,992,500.00	(7,500.00)	5.00	0.76	0.79
3128X4VQ1	10,000,000.00	FHLL - MORTG. CERT.2.5YrNc1Yr	4.98	06/27/08	10,000,000.00	99.92	9,992,400.00	(7,600.00)	4.98	0.79	0.82
3128X4DW8	5,000,000.00	FHLL - MORTG. CERT.3YrNc6MoSte	5.00	07/11/08	5,000,000.00	99.91	4,995,600.00	(4,400.00)	4.50	0.83	0.86
3128X4FF3	10,000,000.00	FHLL - MORTG. CERT.3YrNc1Yr1X	4.50	08/04/08	10,000,000.00	99.56	9,956,200.00	(43,800.00)	4.50	0.89	0.93
3128X4HK0	5,000,000.00	FHLL - MORTG. CERT.3YrNc1Yr1X	4.63	08/15/08	5,000,000.00	99.69	4,984,300.00	(15,700.00)	4.63	0.92	0.96
3128X4HK0	5,000,000.00	FHLL - MORTG. CERT.3YrNc1Yr1X	4.63	08/15/08	4,939,200.00	99.69	4,984,300.00	45,100.00	5.28	0.92	0.96
3128X4MQ1	5,000,000.00	FHLL - MORTG. CERT.	4.48	09/19/08	4,961,250.00	99.53	4,876,600.00	(84,650.00)	5.08	0.99	1.05
3128X4NG2	5,000,000.00	FHLL - MORTG. CERT.3YrNc6Mo	4.75	09/29/08	5,000,000.00	99.76	4,987,850.00	(12,150.00)	4.67	1.02	1.08
3128X5MP0	10,000,000.00	FHLL - MORTG. CERT. 2YrNc1Yr1X	5.25	11/07/08	10,000,000.00	100.04	10,003,700.00	3,700.00	5.25	1.12	1.19
3128X6FK7	5,000,000.00	FHLL - MORTG. CERT. 1.5YrNc3Mo	5.45	01/09/09	5,000,000.00	100.06	5,002,800.00	2,800.00	5.45	1.28	1.36
3128X4G70	10,000,000.00	FHLL - MORTG. CERT.3YrNc2Yr1X	5.02	02/27/09	10,000,000.00	99.95	9,995,400.00	(4,600.00)	5.02	1.42	1.50
3128X5J90	5,000,000.00	FHLL - MORTG. CERT. 2YrNc3Mo	5.50	03/05/09	5,000,000.00	100.00	5,000,000.00	-	5.50	1.39	1.51
3128X5J90	5,000,000.00	FHLL - MORTG. CERT. 2YrNc3Mo	5.50	03/05/09	5,000,000.00	100.00	5,000,000.00	-	5.50	1.39	1.51
3128X5U49	5,000,000.00	FHLL - MORTG. CERT. 2YrNc3Mo	5.25	05/07/09	4,998,950.00	100.06	5,002,850.00	3,900.00	5.26	1.57	1.68
3128X5U49	5,000,000.00	FHLL - MORTG. CERT. 2YrNc3Mo	5.25	05/07/09	5,000,000.00	100.06	5,002,850.00	2,850.00	5.25	1.57	1.68
3128X6BA3	20,000,000.00	FHLL - MORTG. CERT.2YrNc1Yr1X	5.25	06/04/09	20,000,000.00	100.25	20,049,400.00	49,400.00	5.25	1.64	1.76
3128X6CH7	15,000,000.00	FHLL - MORTG. CERT.2YrNc1Yr1X	5.31	06/25/09	15,000,000.00	100.34	15,050,400				

Treasurer's Pooled Investment Fund

CUSIP	PAR	DESCRIPTION	COUPON	MATURITY	BOOK VALUE 1	PRICE	M. VALUE1	GAIN/LOSS	YLD MAT1	M DUR.4	AVG. LIFE2
3128X6GW0	5,000,000.00	FHLB - MORTG. CERT. 2YrNc1Yr1X	5.40	07/16/09	5,000,000.00	100.46	5,023,000.00	23,000.00	5.40	1.75	1.88
3136F8QA6	10,000,000.00	FHLB - MORTG. CERT. 2YrNc1Yr1X	5.30	07/16/09	10,000,000.00	100.38	10,037,500.00	37,500.00	5.30	1.75	1.88
3128X6GQ3	5,000,000.00	FHLB - MORTG. CERT. 2YrNc6Mo	5.50	07/16/09	5,000,000.00	100.24	5,011,850.00	11,850.00	5.50	1.75	1.88
3128X5C30	5,000,000.00	FHLB - MORTG. CERT. 2.5YrNc1Yr1X	5.30	08/13/09	5,000,000.00	100.21	5,010,450.00	10,450.00	5.30	1.83	1.95
3128X6JU1	5,000,000.00	FHLB - MORTG. CERT. 2YrNc3Mo	5.50	08/13/09	5,000,000.00	100.14	5,006,950.00	6,950.00	5.50	1.82	1.95
3128X5HN1	10,000,000.00	FHLB - MORTG. CERT. 3YrNc2X	5.41	08/28/09	10,000,000.00	100.54	10,053,600.00	53,600.00	5.41	1.86	1.99
3128X5MS4	10,000,000.00	FHLB - MORTG. CERT. 3YrNc2Yr1X	5.11	11/03/09	10,000,000.00	100.29	10,028,500.00	28,500.00	5.11	2.00	2.18
3128X57D4	10,000,000.00	FHLB - MORTG. CERT. 2YrNc6MoBerm	5.38	11/23/09	9,996,875.00	100.10	10,009,800.00	12,925.00	5.39	2.05	2.23
3128X5QD3	10,000,000.00	FHLB - MORTG. CERT. 3YrNc6MoBerm	5.40	11/24/09	10,000,000.00	100.11	10,010,800.00	10,800.00	5.40	2.05	2.24
3128X5TU2	10,000,000.00	FHLB - MORTG. CERT. 3YrNc1.5Yr1X	5.05	12/18/09	10,000,000.00	100.07	10,007,200.00	7,200.00	5.05	2.12	2.30
3128X5TU2	5,000,000.00	FHLB - MORTG. CERT. 3YrNc1.5Yr1X	5.05	12/18/09	5,000,000.00	100.07	5,003,600.00	3,600.00	5.05	2.12	2.30
3128X5V7	10,000,000.00	FHLB - MORTG. CERT. 3NC-2Yr	5.04	01/05/10	10,000,000.00	100.21	10,022,100.00	22,100.00	5.05	2.15	2.33
3128X5V7	10,000,000.00	FHLB - MORTG. CERT. 3YrNc1Yr1	5.05	12/29/09	10,000,000.00	100.22	10,020,800.00	20,800.00	5.04	2.17	2.35
3128X5V2	10,000,000.00	FHLB - MORTG. CERT. 3YrNc2Yr	5.04	01/08/10	15,000,000.00	100.11	15,016,950.00	16,950.00	5.00	2.18	2.36
3128X5VG0	15,000,000.00	FHLB - MORTG. CERT. 3YrNc2Yr	5.07	01/11/10	10,000,000.00	100.11	10,010,500.00	10,500.00	5.07	2.19	2.37
3128X5UB2	10,000,000.00	FHLB - MORTG. CERT. 3YrNc1.5Yr1X	5.25	01/11/10	2,616,442.50	100.14	2,626,593.51	10,151.01	5.36	2.18	2.37
3128X5XA1	2,623,000.00	FHLB - MORTG. CERT. 3YrNc6Mo1X	5.00	01/12/10	10,000,000.00	100.11	10,011,400.00	11,400.00	5.00	2.19	2.37
3128X5VH8	10,000,000.00	FHLB - MORTG. CERT. 3YrNc2Yr	5.52	01/12/10	20,000,000.00	100.00	20,000,400.00	400.00	5.52	2.17	2.37
3128X5VX3	20,000,000.00	FHLB - MORTG. CERT. 3YrNc3Mo	5.52	01/12/10	20,000,000.00	100.10	15,014,250.00	14,250.00	5.50	2.21	2.41
3128X5YJ1	15,000,000.00	FHLB - MORTG. CERT. 3YrNc3Mo	5.50	01/26/10	15,000,000.00	100.10	10,009,500.00	9,500.00	5.50	2.21	2.41
3128X5V5	10,000,000.00	FHLB - MORTG. CERT. 3YrNc3Mo	5.55	02/08/10	10,000,000.00	100.13	10,013,000.00	13,000.00	5.55	2.24	2.44
3128X5B64	10,000,000.00	FHLB - MORTG. CERT. 3YrNc6Mo	5.50	03/05/10	5,000,000.00	100.00	5,000,100.00	100.00	5.50	2.26	2.51
3128X5C55	5,000,000.00	FHLB - MORTG. CERT. 3YrNc6Mo	5.50	03/05/10	5,000,000.00	100.10	10,010,200.00	10,200.00	5.05	2.32	2.56
3128X5T40	10,000,000.00	FHLB - MORTG. CERT. 3YrNc1.5Yr1X	5.05	03/22/10	10,000,000.00	100.10	10,010,200.00	10,200.00	5.05	2.32	2.56
3128X5T40	10,000,000.00	FHLB - MORTG. CERT. 3YrNc1.5Yr1X	5.05	03/22/10	10,000,000.00	100.11	5,005,500.00	5,500.00	5.13	2.33	2.57
3128X5T40	5,000,000.00	FHLB - MORTG. CERT. 3YrNc1Yr1X	5.13	03/26/10	5,000,000.00	100.11	15,050,400.00	50,400.00	5.07	2.41	2.66
3128X5X45	15,000,000.00	FHLB - MORTG. CERT. 3NC2IX	5.07	04/27/10	15,000,000.00	100.34	15,050,400.00	50,400.00	5.07	2.41	2.66
3128X5J44	5,000,000.00	FHLB - MORTG. CERT. 3YrNc2Yr1X	5.00	05/28/10	4,995,882.90	100.22	5,011,150.00	15,267.10	5.03	2.50	2.74
3128X56P8	5,000,000.00	FHLB - MORTG. CERT. 3YrNc2Yr1X	5.25	06/04/10	20,000,000.00	100.70	20,139,000.00	139,000.00	5.25	2.51	2.76
3128X6BN5	20,000,000.00	FHLB - MORTG. CERT. 3YrNc2Yr1X	5.40	06/15/10	10,000,000.00	100.99	10,099,000.00	99,000.00	5.40	2.53	2.79
3128X6CX2	10,000,000.00	FHLB - MORTG. CERT. 3YrNc2Yr1X	5.40	06/15/10	4,997,500.00	100.99	5,049,500.00	52,000.00	5.42	2.53	2.79
3128X6CX2	5,000,000.00	FHLB - MORTG. CERT. 3YrNc2Yr1X	5.40	06/15/10	592,506,100.40		593,271,393.51	765,293.11	5.12	1.53	1.65
	592,623,000.00										
<b>FNMA - FED NAT MORTG ASSOC.</b>											
31359MZB2	5,000,000.00	FED NAT MORTG ASSOC. 2YrNc1Yr1X	4.38	09/07/07	4,997,600.00	99.95	4,997,600.00	-	4.40	0.02	0.02
31359MK51	5,000,000.00	FED NAT MORTG ASSOC. 1.5YrNc6Mo	5.20	09/28/07	5,000,000.00	100.00	5,000,000.00	-	5.20	0.07	0.08
31359MK51	5,000,000.00	FED NAT MORTG ASSOC. 1.5YrNc6Mo	5.20	09/28/07	4,999,250.00	99.99	4,999,250.00	-	5.21	0.07	0.08
3136F7LT2	5,000,000.00	FED NAT MORTG ASSOC. 2YrNc3Mo	4.75	10/25/07	5,000,000.00	100.00	5,000,000.00	-	4.75	0.15	0.15
31359M2H5	10,000,000.00	FED NAT MORTG ASSOC. 1YrNc	5.15	11/21/07	10,006,400.00	100.06	10,006,400.00	-	5.08	0.22	0.22
31359M2H5	10,000,000.00	FED NAT MORTG ASSOC. 1YrNc	5.15	11/21/07	9,990,900.00	99.91	9,990,900.00	-	5.25	0.22	0.22
31359MZK2	5,000,000.00	FED NAT MORTG ASSOC. 2YrNc1Yr1X	4.90	11/28/07	5,000,000.00	100.00	5,000,000.00	-	4.90	0.24	0.24
31359MZK2	5,000,000.00	FED NAT MORTG ASSOC. 2YrNc1Yr1X	4.90	11/28/07	5,000,000.00	100.00	5,000,000.00	-	4.90	0.24	0.24
31359MP56	5,000,000.00	FED NAT MORTG ASSOC. 1.5YrNc	5.25	12/03/07	4,996,250.00	99.97	4,998,450.00	2,200.00	5.30	0.25	0.26
3136F7KR7	9,000,000.00	FED NAT MORTG ASSOC. 2.25YrNc3M	4.40	12/28/07	8,997,187.50	99.72	8,974,710.00	(22,477.50)	4.42	0.32	0.33
3136F7PE1	5,000,000.00	FED NAT MORTG ASSOC. 2YrNc1Yr1X	4.88	12/28/07	5,000,000.00	99.88	4,993,750.00	(6,250.00)	4.88	0.32	0.33
3136F7PE1	5,000,000.00	FED NAT MORTG ASSOC. 2YrNc1Yr1X	4.88	12/28/07	5,000,000.00	99.88	4,993,750.00	(6,250.00)	4.88	0.32	0.33
3136F7PE1	5,000,000.00	FED NAT MORTG ASSOC. 2YrNc1Yr1X	4.88	12/28/07	5,000,000.00	99.88	4,992,200.00	(7,800.00)	4.88	0.35	0.36
31359ME66	5,000,000.00	FED NAT MORTG ASSOC. 2YrNc1Yr1X	4.88	01/11/08	5,000,000.00	99.84	4,992,200.00	(7,800.00)	4.88	0.37	0.38
31359ME66	8,000,000.00	FED NAT MORTG ASSOC. 2YrNc6Mo	5.00	01/18/08	8,000,000.00	99.88	7,990,000.00	(10,000.00)	5.00	0.40	0.41
3136F7QAM2	8,000,000.00	FED NAT MORTG ASSOC. 2YrNc6Mo	5.00	01/18/08	10,000,000.00	99.63	9,982,500.00	(17,500.00)	4.30	0.40	0.41
3136F7FE2	10,000,000.00	FED NAT MORTG ASSOC. 2.5YrNc1Yr	4.30	01/28/08	4,995,250.00	99.78	4,989,050.00	(6,200.00)	4.80	0.41	0.42
31359MF65	5,000,000.00	FED NAT MORTG ASSOC. 2YrNc1Yr1X	4.75	02/01/08	4,995,250.00	99.78	4,989,050.00	(6,200.00)	4.80	0.41	0.42
31359MF65	5,000,000.00	FED NAT MORTG ASSOC. 2YrNc1Yr1X	4.75	02/01/08	5,000,000.00	99.78	4,989,050.00	(10,950.00)	4.75	0.41	0.42
31359MF65	5,000,000.00	FED NAT MORTG ASSOC. 2YrNc1Yr1X	4.75	02/01/08	4,995,286.18	99.78	4,989,050.00	(6,236.18)	4.80	0.41	0.42
31359MU92	5,000,000.00	FED NAT MORTG ASSOC. 1.5YrNc	5.40	02/01/08	5,021,900.00	100.06	5,003,150.00	(18,750.00)	5.05	0.41	0.42
31359MXT5	5,000,000.00	FED NAT MORTG ASSOC. 3YrNc1Yr1X	3.86	02/22/08	4,904,508.06	99.34	4,967,200.00	62,691.94	5.20	0.46	0.48
31359MG49	10,000,000.00	FED NAT MORTG ASSOC. 2YrNc1Yr1X	5.00	02/27/08	10,000,000.00	99.84	9,984,400.00	(15,600.00)	5.00	0.48	0.49
31359MJ38	5,000,000.00	FED NAT MORTG ASSOC. 2YrNc1Yr1X	5.13	02/28/08	4,988,250.00	99.91	4,995,300.00	7,050.00	5.29	0.48	0.50
31359MB93	7,995,000.00	FED NAT MORTG ASSOC. 1.5YrNc	4.30	05/05/08	7,907,859.04	99.44	7,950,068.10	42,209.06	5.07	0.65	0.68
3136F7TC1	10,000,000.00	FED NAT MORTG ASSOC. 2.25YrNc6M	4.92	05/16/08	10,000,000.00	99.84	9,984,400.00	(15,600.00)	4.92	0.68	0.71
3136F7XR3	20,000,000.00	FED NAT MORTG ASSOC. 2YrNc6Mo	5.29	05/30/08	19,996,875.00	100.00	20,000,000.00	3,125.00	5.30	0.72	0.75
31359M2L6	5,000,000.00	FED NAT MORT ASSOC. 1.5YrNc6MoBerm	5.25	06/11/08	5,000,000.00	100.00	5,000,000.00	-	5.25	0.75	0.78
3136F3XS0	5,000,000.00	FED NAT MORT ASSOC. 5YrNc6MoBerm	3.00	06/12/08	4,857,650.00	98.47	4,923,450.00	65,800.00	5.00	0.75	0.78
3136F7RV1	5,000,000.00	FED NAT MORT ASSOC. 2YrNc1Yr1X	5.00	08/15/08	4,970,050.00	99.97	4,998,450.00	28,400.00	5.32	0.92	0.96
31359M2G7	5,000,000.00	FED NAT MORTG ASSOC. 2YrNc1Yr1X	5.25	11/20/08	5,001,900.00	100.06	5,003,150.00	1,250.00	5.21	1.15	1.22
31359M2G7	5,000,000.00	FED NAT MORTG ASSOC. 2YrNc1Yr1X	5.45	01/23/09	5,000,000.00	100.09	5,004,700.00	4,700.00	5.45	1.32	1.40
3136F8DX0	5,000,000.00	FED NAT MORTG ASSOC. 2YrNc3Mo	5.40	01/26/09	10,000,000.00	100.06	10,008,300.00	8,300.00	5.40	1.33	1.41
31359M4F7	10,000,000.00	FED NAT MORTG ASSOC. 2YrNc3Mo	5.08	01/27/09	4,997,250.00	100.00	5,000,000.00	2,750.00	5.10	1.33	1.41
31359MF24	5,000,000.00	FED NAT MORTG ASSOC. 3YrNc6Mo	5.25	01/29/09	4,998,100.00	100.13	5,006,250.00	8,150.00	5.27</		

CUSIP	PAR	DESCRIPTION	COUPON	MATURITY	BOOK VALUE 1	PRICE	M. VALUE1	GAIN/LOSS	YLD MAT1	M DUR.4	AVG. LIFE2
3136F8NQ4	15,000,000.00	FED NAT MORTG ASSOC 2YrNc1Yr1X	5.30	06/18/09	15,000,000.00	100.34	15,051,600.00	51,600.00	5.30	1.68	1.80
31398ADS8	5,000,000.00	FED NAT MORTG ASSOC 2YrNc1Yr1X	5.38	06/19/09	4,984,850.00	100.41	5,020,300.00	25,450.00	5.43	1.68	1.80
31398ADS8	10,000,000.00	FED NAT MORTG ASSOC 2YrNc1Yr1X	5.38	06/19/09	10,000,000.00	100.41	10,040,600.00	40,600.00	5.37	1.68	1.80
3136F7J40	10,000,000.00	FED NAT MORTG ASSOC 3YrNc2Yr1X	5.50	06/30/09	10,000,000.00	100.53	10,053,100.00	53,100.00	5.50	1.71	1.83
3136F8PP4	5,000,000.00	FED NAT MORTG ASSOC 2YrNc1Yr1X	5.38	07/02/09	5,000,000.00	100.34	5,017,200.00	17,200.00	5.38	1.71	1.83
3136F8PG4	5,000,000.00	FED NAT MORTG ASSOC 2YrNc1Yr1X	5.50	07/02/09	5,000,000.00	100.22	5,010,950.00	10,950.00	5.50	1.71	1.84
3136F8QG3	5,000,000.00	FED NAT MORTG ASSOC 2YrNc1Yr1X	5.40	07/23/09	5,000,000.00	100.50	5,025,000.00	25,000.00	5.40	1.77	1.90
3136F8QG3	5,000,000.00	FED NAT MORTG ASSOC 2YrNc1Yr1X	5.40	07/23/09	5,000,000.00	100.50	5,025,000.00	25,000.00	5.40	1.77	1.90
3136F8QC2	15,000,000.00	FED NAT MORTG ASSOC 2YrNc1Yr1X	5.34	07/23/09	15,000,000.00	100.44	15,065,700.00	65,700.00	5.34	1.77	1.90
3136F7S99	6,805,000.00	FED NAT MORTG ASSOC 3YrNc2Yr1X	5.40	08/26/09	6,805,000.00	100.53	6,841,134.55	36,134.55	5.40	1.86	1.99
3136F7S99	15,000,000.00	FED NAT MORTG ASSOC 3YrNc2Yr1X	5.40	08/26/09	15,000,000.00	100.53	15,079,650.00	79,650.00	5.40	1.86	1.99
3136F7ZR7	10,000,000.00	FED NAT MORTG ASSOC 3YrNc2Yr1X	5.25	09/29/09	10,000,000.00	100.38	10,037,500.00	37,500.00	5.25	1.90	2.08
3136F7ZR7	5,000,000.00	FED NAT MORTG ASSOC 3YrNc2Yr1X	5.25	09/29/09	5,000,000.00	100.38	5,018,750.00	18,750.00	5.25	1.90	2.08
3136F75H6	30,000,000.00	FED NAT MORTG ASSOC 3YrNc7Mo	5.50	10/27/09	29,991,000.00	100.03	30,009,300.00	18,300.00	5.51	1.97	2.16
3136F75D5	15,000,000.00	FED NAT MORTG ASSOC 3YrNc2Yr1X	5.15	10/30/09	15,000,000.00	100.34	15,051,600.00	51,600.00	5.15	1.99	2.17
31359M2A0	5,000,000.00	FED NAT MORT ASSOC 3YrNc1.5Yr1X	5.20	11/20/09	5,000,000.00	100.25	5,012,500.00	12,500.00	5.20	2.04	2.22
31359M2A0	15,000,000.00	FED NAT MORT ASSOC 3YrNc1.5Yr1X	5.20	11/20/09	14,995,650.00	100.25	15,037,500.00	41,850.00	5.20	2.04	2.22
3136F77F8	5,000,000.00	FED NAT MORTG ASSOC 3YrNc3Mo	5.50	12/01/09	5,000,000.00	100.16	5,007,800.00	7,800.00	5.50	2.06	2.25
3136F77B7	10,000,000.00	FED NAT MORT ASSOC 3YrNc1.5Yr1X	5.10	12/04/09	10,000,000.00	100.13	10,012,500.00	12,500.00	5.10	2.08	2.25
3136F8AB1	5,000,000.00	FED NAT MORT ASSOC 3YrNc1YrBerm	5.25	12/11/09	5,000,000.00	100.06	5,003,150.00	3,150.00	5.25	2.10	2.28
3136F8AR6	15,000,000.00	FED NAT MORTG ASSOC 3YrNc1YrQ	5.17	12/14/09	15,000,000.00	100.03	15,004,650.00	4,650.00	5.17	2.11	2.29
3133XJBM9	10,000,000.00	FED NAT MORT ASSOC 3YrNc1.5Yr1X	5.00	12/18/09	10,000,000.00	100.00	10,000,000.00	-	5.00	2.13	2.30
3136F8BS3	10,000,000.00	FED NAT MORTG ASSOC 3YrNc1.5Yr	5.00	12/18/09	9,997,200.00	99.97	9,996,900.00	(300.00)	5.01	2.12	2.30
31359M2M4	5,000,000.00	FED NAT MORTG ASSOC 3YrNc1Yr1X	5.13	12/18/09	4,999,218.75	100.06	5,003,150.00	3,931.25	5.13	2.12	2.30
3136F8BB0	10,000,000.00	FED NAT MORTG ASSOC 3YrNc1Yr	5.11	12/18/09	9,998,437.50	100.00	10,000,000.00	1,562.50	5.12	2.12	2.30
3136F8BG9	5,000,000.00	FED NAT MORTG ASSOC 3YrNc1YrBe	5.15	12/21/09	4,999,218.75	100.00	5,000,000.00	781.25	5.16	2.13	2.31
3136F8CJ2	5,000,000.00	FED NAT MORTG ASSOC 3YrNc3Mo	5.50	12/28/09	5,000,000.00	100.00	5,000,000.00	-	5.50	2.14	2.33
31359M2U6	5,000,000.00	FED NAT MORTG ASSOC 3YrNc1Yr1X	5.25	12/28/09	5,000,000.00	100.13	5,006,250.00	6,250.00	5.25	2.14	2.33
3136F8BZ7	5,000,000.00	FED NAT MORTG ASSOC 3YrNc1YrBerm	5.25	12/28/09	5,000,000.00	100.06	5,003,150.00	3,150.00	5.25	2.14	2.33
3136F8BZ7	5,000,000.00	FED NAT MORTG ASSOC 3YrNc1YrBerm	5.25	12/28/09	5,000,000.00	100.06	5,003,150.00	3,150.00	5.25	2.14	2.33
31359m2u6	5,000,000.00	FED NAT MORTG ASSOC 3YrNc1Yr1X	5.25	12/28/09	5,000,000.00	100.06	5,003,150.00	3,150.00	5.25	2.14	2.33
3136F8CJ2	6,285,000.00	FED NAT MORTG ASSOC 3YrNc3Mo	5.50	12/28/09	4,995,850.00	100.13	5,006,250.00	10,400.00	5.28	2.14	2.33
3136F8DF9	10,000,000.00	FED NAT MORTG ASSOC 3YrNc1X	5.05	01/08/10	6,284,937.15	100.00	6,285,000.00	62.85	5.50	2.14	2.33
3136F8DF9	10,000,000.00	FED NAT MORTG ASSOC 3YrNc2Yr1X	5.05	01/08/10	10,000,000.00	100.25	10,025,000.00	25,000.00	5.05	2.18	2.36
31359M3X9	5,000,000.00	FED NAT MORTG ASSOC 3YrNc1Yr1X	5.25	01/11/10	4,998,437.50	100.13	5,006,250.00	7,812.50	5.26	2.18	2.37
31359M4L4	5,000,000.00	FED NAT MORTG ASSOC 3YrNc1.5Yr1X	5.25	01/22/10	5,000,000.00	100.31	5,015,650.00	15,650.00	5.25	2.21	2.40
31359M4L4	10,000,000.00	FED NAT MORTG ASSOC 3YrNc1.5Yr1X	5.25	01/22/10	10,000,000.00	100.31	10,031,300.00	31,300.00	5.25	2.21	2.40
31359M4X8	5,000,000.00	FED NAT MORTG ASSOC 3YrNc2Yr1X	5.23	01/29/10	5,000,000.00	100.50	5,025,000.00	25,000.00	5.23	2.23	2.40
3136F8EH4	10,000,000.00	FED NAT MORTG ASSOC 3YrNc1.5Yr	5.18	01/29/10	10,000,000.00	100.19	10,018,800.00	18,800.00	5.18	2.23	2.42
31359M4W0	35,000,000.00	FED NAT MORTG ASSOC 3YrNc6Mo1X	5.33	01/29/10	35,000,000.00	100.38	35,131,250.00	131,250.00	5.33	2.23	2.42
31359M4Q3	5,000,000.00	FED NAT MORTG ASSOC 3YrNc1Yr1X	5.38	02/01/10	5,000,000.00	100.22	5,010,950.00	10,950.00	5.38	2.23	2.42
3136F8FAB	10,000,000.00	FED NAT MORT ASSOC 3YrNc1.5Yr1X	5.25	02/22/10	10,000,000.00	100.34	10,034,400.00	34,400.00	5.25	2.29	2.48
31359M5N9	5,000,000.00	FED NAT MORTG ASSOC 3YrNc1Yr1X	5.30	02/26/10	5,000,000.00	100.19	5,009,400.00	9,400.00	5.30	2.30	2.49
31359M5N9	5,000,000.00	FED NAT MORTG ASSOC 3YrNc1Yr1X	5.30	02/26/10	4,998,750.00	100.19	5,009,400.00	9,400.00	5.30	2.30	2.49
3136F8JG1	15,000,000.00	FED NAT MORTG ASSOC 3YrNc3Mo	5.50	03/22/10	15,000,000.00	100.03	15,004,650.00	4,650.00	5.50	2.30	2.49
3136F8JG1	35,000,000.00	FED NAT MORTG ASSOC 3YrNc3Mo	5.50	03/22/10	35,000,000.00	100.03	35,010,850.00	10,850.00	5.50	2.30	2.56
31359M6B4	10,000,000.00	FED NAT MORTG ASSOC 3YrNc1Yr1X	5.20	03/26/10	10,000,000.00	100.28	10,028,100.00	28,100.00	5.20	2.33	2.57
31359M6B4	10,000,000.00	FED NAT MORTG ASSOC 3YrNc1Yr1X	5.20	03/26/10	9,994,220.00	100.28	10,028,100.00	33,880.00	5.22	2.32	2.57
31359M6B4	5,000,000.00	FED NAT MORTG ASSOC 3YrNc1Yr1X	5.20	03/26/10	5,000,000.00	100.28	5,014,050.00	14,050.00	5.20	2.33	2.57
31359M6B4	5,000,000.00	FED NAT MORTG ASSOC 3YrNc1Yr1X	5.20	03/26/10	5,000,000.00	100.28	5,014,050.00	14,050.00	5.20	2.33	2.57
31359M6G3	5,000,000.00	FED NAT MORTG ASSOC 3YrNc1Yr1X	5.20	03/26/10	5,000,000.00	100.28	5,014,050.00	14,050.00	5.20	2.33	2.57
31359M6G3	5,000,000.00	FED NAT MORTG ASSOC 3YrNc1Yr1X	5.25	03/26/10	5,000,000.00	100.22	5,010,950.00	10,950.00	5.25	2.32	2.57
31359M6B4	13,000,000.00	FED NAT MORTG ASSOC 3YrNc1Yr1X	5.20	03/26/10	5,000,000.00	100.22	5,010,950.00	10,950.00	5.24	2.32	2.57
31359M6G3	10,000,000.00	FED NAT MORTG ASSOC 3YrNc1Yr1X	5.25	03/26/10	12,992,200.00	100.28	13,036,530.00	44,330.00	5.22	2.32	2.57
3136F8JS5	5,000,000.00	FED NAT MORTG ASSOC 3YrNc6Mo	5.35	04/12/10	10,000,000.00	100.22	10,021,900.00	21,900.00	5.25	2.32	2.57
3136F8JS5	5,000,000.00	FED NAT MORTG ASSOC 3YrNc6Mo	5.35	04/12/10	4,997,500.00	100.06	5,003,150.00	5,650.00	5.37	2.36	2.62
31359M7T4	15,000,000.00	FED NAT MORTG ASSOC 3YrNc1Yr1X	5.30	04/16/10	4,999,218.75	100.06	5,003,150.00	3,931.25	5.36	2.36	2.62
31359M7T4	5,000,000.00	FED NAT MORTG ASSOC 3YrNc1Yr1X	5.30	04/16/10	15,000,000.00	100.25	15,037,500.00	37,500.00	5.30	2.37	2.63
31359M7T4	10,000,000.00	FED NAT MORTG ASSOC 3YrNc1Yr1X	5.30	04/16/10	5,000,000.00	100.25	5,012,500.00	12,500.00	5.30	2.37	2.63
31359M7T4	10,000,000.00	FED NAT MORTG ASSOC 3YrNc1Yr1X	5.30	04/16/10	10,000,000.00	100.25	10,025,000.00	25,000.00	5.30	2.37	2.63
3136F8KS3	30,000,000.00	FED NAT MORTG ASSOC 3YrNc3Mo	5.40	04/19/10	10,000,000.00	100.25	10,025,000.00	25,000.00	5.30	2.37	2.63
3136F8LB9	30,000,000.00	FED NAT MORTG ASSOC 3YrNc3Mo	5.50	04/26/10	30,000,000.00	100.06	30,018,900.00	18,900.00	5.40	2.38	2.64
3136F8LB9	30,000,000.00	FED NAT MORTG ASSOC 3YrNc3Mo	5.40	04/26/10	30,000,000.00	100.06	30,018,900.00	18,900.00	5.40	2.38	2.64
3136F8LGB	10,000,000.00	FED NAT MORTG ASSOC 3YrNc1Yr1X	5.30	04/30/10	10,000,000.00	100.25	10,025,000.00	25,000.00	5.30	2.39	2.65
31398ACF7	5,000,000.00	FED NAT MORTG ASSOC 3YrNc3Mo	5.55	06/04/10	4,998,437.50	100.16	5,007,800.00	9,362.50	5.56	2.49	2.76
3136F8AM7	2,950,000.00	FED NAT MORT ASSOC 3YrNc9MBar	5.30	06/14/10	2,950,000.00	100.00	2,950,000.00	-	5.30	2.53	2.79
	971,035,000.00				970,594,566.68		972,135,372.65	1,540,805.97	5.25	1.72	1.87
<b>LAO - LOCAL AGENCY OBLIGATIONS</b>											
	5,000,000.00	CORAL CANS Srs 2006	5.34								

CUSIP	PAR	DESCRIPTION	COUPON	MATURITY	BOOK VALUE 1	PRICE	M. VALUE1	GAIN/LOSS	YLD MAT1	M DUR.4	AVG. LIFE2
<b>MTNQ - MED TERM NOTES</b>											
89233PZV1	15,000,000.00	TOYOTA MTR CREDIT Aaa/AAA/AAA	5.25	11/14/07	15,000,000.00	100.00	15,000,000.00	-	5.25	0.20	0.21
36962GZZ0	5,000,000.00	GE CAP CORP Aaa/AAA/AAA	4.25	01/15/08	4,951,800.00	99.50	4,975,100.00	23,300.00	4.77	0.36	0.38
36962GZZ0	5,000,000.00	GE CAP CORP Aaa/AAA/AAA	4.25	01/15/08	4,954,550.00	99.50	4,975,100.00	20,550.00	4.74	0.36	0.38
742651CS9	10,000,000.00	PRIVATE EXPT FDG Aaa/AAA/AAA	5.75	01/15/08	10,053,300.00	100.16	10,015,600.00	(37,700.00)	5.19	0.36	0.38
5526E0AK9	7,478,000.00	MBNA AMER BK NA Aaa/AA+	5.38	01/15/08	7,479,046.92	99.85	7,467,007.34	(12,039.58)	5.34	0.36	0.38
5526E0AK9	13,500,000.00	MBNA AMER BK NA Aaa/AA+	5.38	01/15/08	13,500,000.00	99.85	13,480,155.00	(19,845.00)	5.36	0.36	0.38
40411A6Y7	15,000,000.00	HBOS TSY SVCS NY Aa2/AA	5.38	01/30/08	15,008,203.13	100.05	15,008,205.00	1.87	5.32	0.41	0.42
89233PC20	15,000,000.00	TOYOTA MTR CREDIT Aaa/AAA/AAA	5.35	02/01/08	15,000,000.00	99.82	14,972,850.00	(27,150.00)	5.35	0.41	0.42
90261XCX8	15,000,000.00	UBS AG STAMFORD Aa+/Aa2	5.40	02/01/08	15,000,000.00	99.77	14,965,200.00	(34,800.00)	5.40	0.41	0.42
172967BS9	9,200,000.00	CITIGROUP INC Aaa/AAA/AAA	3.50	02/01/08	9,054,916.00	99.17	9,123,272.00	68,356.00	5.26	0.41	0.42
172967BS9	5,000,000.00	CITIGROUP INC Aaa/AAA/AAA	3.50	02/01/08	4,934,000.00	99.17	4,958,300.00	24,300.00	5.30	0.41	0.42
172967BS9	15,000,000.00	CITIGROUP INC Aa1/AA/AA+	3.50	02/01/08	14,789,550.00	99.17	14,874,900.00	85,350.00	5.31	0.41	0.42
339030AG3	8,401,000.00	BANK OF AMERICA Aa1/AA/AA	3.85	02/15/08	8,308,992.25	99.15	8,329,843.53	20,851.28	5.36	0.44	0.46
949746JQ5	10,000,000.00	WELLS FARGO Aa+/Aa1	4.13	03/10/08	9,905,400.00	99.08	9,908,200.00	2,800.00	5.17	0.50	0.53
949746EX5	14,647,000.00	WELLS FARGO CO Aa1/AA+	3.50	04/04/08	14,423,633.25	98.68	14,454,099.01	30,465.76	5.32	0.57	0.59
949746EX5	1,698,000.00	WELLS FARGOCO Aaa/AAA/AAA	3.50	04/04/08	1,672,648.86	98.68	1,675,637.34	2,988.48	5.45	0.57	0.59
55266LEJ1	10,000,000.00	MBIA GLOBAL FDG Aaa/AAA/AAA	5.30	04/23/08	10,000,000.00	99.46	9,945,900.00	(54,100.00)	5.30	0.62	0.65
74977ENS8	10,000,000.00	RABOBANK Aaa/AAA/AAA	5.26	05/06/08	10,000,000.00	99.74	9,974,100.00	(25,900.00)	5.26	0.65	0.68
74977ENS8	5,000,000.00	RABOBANK Aaa/AAA/AAA	5.26	05/06/08	5,000,000.00	99.74	4,987,050.00	(12,950.00)	5.26	0.65	0.68
026874AR8	17,168,000.00	AMERICAN INTL GROUP Aa2/AA/AA	2.88	05/15/08	16,777,084.64	97.97	16,818,974.56	41,889.92	5.25	0.88	0.71
084664AC5	10,000,000.00	BERKSHIRE HATH Aaa/AAA/AAA	3.38	10/15/08	9,701,200.00	98.00	9,799,800.00	98,600.00	5.21	1.07	1.13
084664AC5	19,525,000.00	BERKSHIRE HATHAWAY Aaa/AAA/AAA	3.38	10/15/08	19,017,154.75	98.00	19,134,109.50	116,954.75	5.44	1.07	1.13
55266LEE2	10,000,000.00	MBIA GLOBAL FDG Aaa/AAA/AAA	5.35	10/16/08	10,000,000.00	99.27	9,926,900.00	(73,100.00)	5.35	1.06	1.13
36962GN34	5,000,000.00	GE CAP CORP Aaa/AAA/AAA	3.77	10/30/08	4,857,500.00	98.24	4,912,000.00	54,500.00	5.29	1.11	1.17
55266LEU6	5,000,000.00	MBIA GLOBAL FDG Aaa/AAA/AAA	5.30	12/12/08	5,000,000.00	99.25	4,962,650.00	(37,350.00)	5.30	1.21	1.28
55266LFC5	5,000,000.00	MBIA GLOBAL FDG Aaa/AAA/AAA	5.34	01/23/09	5,000,000.00	99.38	4,969,200.00	(30,800.00)	5.34	1.32	1.40
36962GH49	10,000,000.00	GENERAL ELECTRIC Aaa/AAA/AAA	3.13	04/01/09	9,643,300.00	97.63	9,762,700.00	119,400.00	5.05	1.50	1.59
74977EPQ0	15,000,000.00	RABOBANK NED NY Aaa/AAA/AAA	5.30	05/31/09	15,000,000.00	100.97	15,146,100.00	146,100.00	5.30	1.63	1.75
	286,617,000.00				284,032,279.80		284,522,953.28	490,673.48	5.28	0.67	0.71
<b>MUNI - MUNICIPAL BONDS</b>											
672240PZ5	15,000,000.00	OAKLAND B TRANS TXB A+/A1	5.38	07/11/08	15,000,000.00	100.24	15,035,850.00	35,850.00	5.38	0.83	0.86
544587MS4	3,115,000.00	LOS ANGELES IMP Aaa/AAA/AAA	5.08	08/01/08	3,115,000.00	100.00	3,115,121.49	121.48	5.08	0.88	0.92
587672AJ5	1,000,000.00	MERCED PENSION-TAXBLE Aaa/AAA	5.90	08/15/08	1,011,740.00	100.79	1,007,890.00	(3,850.00)	5.00	0.92	0.96
797398BJ2	1,000,000.00	SAN DIEGO PENSION Aaa/AAA	3.88	08/15/08	988,870.00	98.89	988,860.00	0.00	5.04	0.92	0.96
54438EGP7	1,500,000.00	LA REDEV TXB B Aaa/AAA/AAA	3.98	12/01/08	1,474,365.00	98.55	1,478,220.00	3,855.00	5.15	1.19	1.25
130795AB3	1,200,000.00	CA DEV TXB A1 PEN Aaa/AAA/AAA	5.06	06/01/09	1,200,000.00	99.96	1,199,508.00	(492.00)	5.06	1.64	1.75
553751JN9	1,855,000.00	MSR PWR TXB SUB Aaa/AAA/AAA	3.45	07/01/09	1,796,326.35	97.16	1,802,280.90	5,954.55	5.04	1.74	1.84
5446443A3	2,200,000.00	LA USD TXB 2005 D Aaa/AAA/AAA	5.06	07/01/09	2,200,308.00	100.01	2,200,217.80	(90.20)	5.05	1.72	1.84
544587MT2	3,270,000.00	LOS ANGELES IMP Aaa/AAA/AAA	5.17	08/01/09	3,270,000.00	100.05	3,271,599.03	1,599.03	5.17	1.80	1.92
456567VJ2	3,625,000.00	INDSTRY IRB TXB 1A Aaa/AAA/AAA	4.50	05/01/10	3,572,800.00	98.52	3,571,386.25	(1,413.75)	5.03	2.44	2.67
544587MU9	3,445,000.00	LOS ANGELES IMP Aaa/AAA/AAA	5.20	08/01/10	3,445,000.00	100.10	3,448,510.46	3,510.46	5.20	2.66	2.92
	37,210,000.00				37,070,409.35		37,119,443.92	49,034.57	5.21	1.39	1.48
<b>NCD - NEGOTIABLE CD</b>											
1730D0YL4	50,000,000.00	CITIGROUP A1+/P1/F1+	5.31	09/04/07	50,000,000.00	100.00	50,000,000.00	-	5.31	0.01	0.01
90263KXP8	50,000,000.00	UBS AG STAMFORD A1+/P1/F1+	5.29	09/10/07	50,000,372.05	100.00	50,000,372.05	-	5.29	0.02	0.03
8911A2XY5	50,000,000.00	TORONTO DOMINION A1+/P1	5.29	09/12/07	50,001,052.45	100.00	50,001,052.45	-	5.28	0.03	0.03
9497P6CK2	50,000,000.00	WELLS FARGO A1+/P1/F1+	5.36	09/18/07	50,000,000.00	100.00	50,000,000.00	-	5.36	0.05	0.05
13170E5M4	50,000,000.00	CALYON NY A1+/P1	5.29	09/26/07	50,000,000.00	100.00	50,000,000.00	-	5.29	0.07	0.07
25213EB73	50,000,000.00	DEXIA A1+/P1/F1+	5.29	10/05/07	50,000,576.25	100.00	50,000,576.25	-	5.25	0.09	0.10
40411JFL6	50,000,000.00	HBOS TREAS SRVCS A1+/P1/F1+	5.31	10/15/07	50,001,851.81	100.00	50,001,851.81	-	5.30	0.12	0.12
0673P13C6	50,000,000.00	BARCLAYS CAPITAL A1+/P1/F1+	5.29	10/24/07	50,000,000.00	100.00	50,000,000.00	-	5.29	0.14	0.15
06050YKS9	50,000,000.00	BANK OF AMERICA A1+/P1	5.32	11/01/07	50,000,000.00	100.00	50,000,000.00	-	5.32	0.16	0.17
8336P1L65	50,000,000.00	SOCIETE GENERALE A1+/P1/F1+	5.30	11/07/07	50,000,000.00	100.00	50,000,000.00	-	5.30	0.18	0.19
74977FLE8	30,000,000.00	RABOBANK A1+/P1/F1+	5.30	05/07/08	30,000,000.00	100.00	30,000,000.00	-	5.30	0.65	0.68
7497T14T1	20,000,000.00	RABOBANK A1+/P1/F1+	5.22	05/21/08	20,000,000.00	100.00	20,000,000.00	-	5.22	0.69	0.72
	550,000,000.00				550,003,852.56		550,003,852.56	-	5.29	0.14	0.15
<b>TCD - TIME DEPOSITS</b>											
	10,000,000.00	CITIZENS BUSINESS BANK	5.21	09/12/07	10,000,000.00	100.00	10,000,000.00	-	5.21	0.03	0.03
	10,000,000.00	CITIZENS BUSINESS BANK	5.15	10/01/07	10,000,000.00	100.00	10,000,000.00	-	5.15	0.08	0.08
	20,000,000.00				20,000,000.00		20,000,000.00	-	5.18	0.06	0.06
<b>TOTAL</b>	<b>4,831,134,000.00</b>				<b>4,813,876,982.02</b>		<b>4,817,223,051.06</b>	<b>3,346,069.04</b>	<b>5.20</b>	<b>0.98</b>	<b>1.06</b>

1. The market value and yield of short-term money market securities are based on purchase price.  
 2. Average life is the number of years until principal is returned at maturity, weighted by market value.  
 3. Local Agency Obligations have variable rate coupons, spread to Pool.  
 4. Modified Duration. The percentage price change of a security for a given change.  
 The higher the modified duration of a security, the higher the risk.

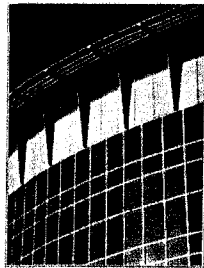

The Treasurer's Pooled Investment Fund was in **FULL COMPLIANCE** with the Treasurer's Statement of Investment Policy. The County's Investment Policy is more restrictive than the California Government Code. This policy is reviewed annually by the County's Investment Oversight Committee and approved by the County Board of Supervisors.

Government Code	County Investment Policy
-----------------	--------------------------

Investment Category	Maximum Maturity	Authorized % Limit	Quality S&P/ Moody's	Maximum Maturity	Authorized % Limit	Quality S&P/ Moody's	Actual Riverside Portfolio %
CA AGENCY BONDS	5 YEARS	NO LIMIT		3 YEARS	15%/ \$150MM	A/A2/A	0.77%
U.S. TREASURY	5 YEARS	NO LIMIT	AAA	5 YEARS	100%	AAA	-
LOCAL AGENCY OBLIGATIONS	5 YEARS	NO LIMIT		3 YEARS	2.50%	GRADE	0.14%
FEDERAL AGENCIES	5 YEARS	NO LIMIT	AAA	5 YEARS	AAA	N/A	56.68%
BILLS OF EXCHANGE	270 DAYS	40% (1)		180 DAYS	30%	A1/P1/F1	-
COMMERCIAL PAPER	270 DAYS	40%	A1/P1	270 DAYS	40%	A1/P1/F1	18.84%
CERTIFICATE & TIME DEPOSITS	5 YEARS	30%		1 YEAR	25% MAX	A1/P1/F1	11.83%
REPURCHASE AGREEMENTS	1 YEAR	NO LIMIT		45 DAYS	40%/25% TERM MAX	A1/P1/F1	-
REVERSE REPOS	92 DAYS	20%		60 DAYS	10% MAX	N/A	-
MED. TERM NOTES	5 YEARS	30%	A	2 YEARS	20% MAX	AA/Aa2/AA	5.91%
CalTRUST SHORT TERM FUND	N/A	N/A	N/A	DAILY LIQUIDITY	1%	Board Approved AAA by 2 Of 3	1.12%
MUTUAL FUNDS	90 DAYS (2)	20%	AAA/Aaa (3)	DAILY LIQUIDITY	20%	RATINGS	-
SECURED BANK DEPOSITS	5 YEARS	NO LIMIT		1 YEAR	2%		-
MORTGAGE PASS- THROUGH SECURITIES	5 YEARS	20%	AA-SECURITY A-ISSUER	N/A	N/A		-
LOCAL AGENCY	N/A	NO LIMIT		3 YEARS	0% MAX		-
INVESTMENT FUNDS							
CASH/DEPOSIT ACCOUNT	N/A	N/A	N/A	N/A	N/A	N/A	4.71%

<sup>1</sup> No more than 30% of this category may be invested with any one commercial bank  
<sup>2</sup> Mutual Funds maturity may be interpreted as weighted average maturity not exceeding 90 days  
<sup>3</sup> Or must have an investment advisor with not less than 5 years experience and with assets under management of \$500,000,000.

THIS COMPLETES THE REPORT REQUIREMENTS OF CALIFORNIA GOVERNMENT CODE 53646



County Administrative Center  
4080 Lemon Street, 4th Floor - Capital Markets  
Riverside, CA 92502-2205  
[capitalmarkets@co.riverside.ca.us](mailto:capitalmarkets@co.riverside.ca.us)  
[www.countytreasurer.org](http://www.countytreasurer.org)