

**SUBMITTAL TO THE BOARD OF SUPERVISORS
COUNTY OF RIVERSIDE, STATE OF CALIFORNIA**

913A



FROM: TLMA - Transportation Dept.

SUBMITTAL DATE:
February 15, 2008

SUBJECT: Landscaping and Lighting Maintenance District No. 89-1-Consolidated,
Annexation of Zone 106 (Glen Avon).

RECOMMENDED MOTION: That the Board:

1. Adopt resolution No. 2008-068, Resolution of the County of Riverside confirming the diagram and assessment of Zone 106 of Landscaping and Lighting Maintenance District No. 89-1-Consolidated, and levying assessments on all assessable lots and parcels of land therein for fiscal year 2008-09.
2. Direct the Auditor-Controller's office to establish an interest-bearing sub-fund 20300 to receive deposits and interest thereon from Zone 106 of Landscaping and



George A. Johnson
Director of Transportation

JW:jp

FINANCIAL DATA	Current F.Y. Total Cost:	\$0	In Current Year Budget:	N/A
	Current F.Y. Net County Cost:	\$0	Budget Adjustment:	N/A
	Annual Net County Cost:	\$0	For Fiscal Year:	2007-08
SOURCE OF FUNDS: Landscaping and Lighting Maintenance District No. 89-1-Consolidated – 100%				Positions To Be Deleted Per A-30 <input type="checkbox"/>
				Requires 4/5 Vote <input type="checkbox"/>

C.E.O. RECOMMENDATION:

APPROVE

BY 
Tina Grande

County Executive Office Signature

FORM APPROVED COUNTY COUNSEL

BY  DALE A. GARDNER DATE 1/15/08

Departmental Concurrence

Dep't Recomm.: Consent Policy

Per Exec. Ofc.: Consent Policy

Prev. Agn. Ref.

District: 2

Agenda Number:

3.72

The Honorable Board of Supervisors

RE: Landscaping and Lighting Maintenance District No. 89-1-Consolidated, Annexation of Zone 106 (Glen Avon).

February 15, 2008

Page 2 of 2

Lighting Maintenance District No. 89-1-Consolidated; in accordance with Section 22655-22656 of the Streets and Highways Code.

BACKGROUND: On January 8, 2008, a public hearing was held to receive all testimony regarding the annexation of Zone 106 to Landscaping and Lighting Maintenance District No. 89-1-Consolidated (L&LMD No. 89-1-C"). After closing the public hearing, the Board directed the Director of Transportation, or his/her designee, to tally the assessment ballots that had been received prior to the close of the hearing. The assessment ballots were to be tabulated on January 9, 2008 at 10:00 a.m. in Conference Room B on the 8th Floor of the County Administrative Center. The tabulation shows that votes representing 1 parcel out of a possible 1 was cast, and that 1 vote (or 100%) was cast in favor of the annexation of Zone 106 to L&LMD No. 89-1-C and the levy and enrollment of the special assessment.

The proposed budget for fiscal year 2008-09 for Zone 106 is \$4,598.00 that will result in an assessment for fiscal year 2008-09 within Zone 106 of \$252.08 per acre. Zone 106 includes 1 commercial parcel, totaling 18.24 acre(s). The annual assessment will be adjusted annually by the greater of 2% or the cumulative percentage increase in the CPI-U, if any, as it stands as of March of each year over the base index for March of 2007.

Adoption of Resolution No. 2008-068 confirms the assessment levy as indicated in the Engineer's Report for fiscal year 2008-09 for Zone 106 of L&LMD No. 89-1-C and orders the placement of the annual assessment on the County's Assessment Roll for fiscal year 2008-09.

RESOLUTION NO. 2008-068

RESOLUTION OF THE BOARD OF SUPERVISORS OF THE COUNTY OF RIVERSIDE ORDERING THE ANNEXATION OF ZONE 106 TO LANDSCAPING AND LIGHTING MAINTENANCE DISTRICT NO. 89-1-CONSOLIDATED OF THE COUNTY OF RIVERSIDE AND CONFIRMING THE DIAGRAM AND ASSESSMENT FOR ZONE 106 OF LANDSCAPING AND LIGHTING MAINTENANCE DISTRICT NO. 89-1-CONSOLIDATED AND LEVYING ASSESSMENTS ON ALL ASSESSABLE LOTS AND PARCELS OF LAND THEREIN FOR THE FISCAL YEAR 2008-09

WHEREAS, on November 20, 2007 the Board of Supervisors (hereinafter the "Board of Supervisors") of the County of Riverside (hereinafter the "County") adopted Resolution No. 2007-471, pursuant to Section 22608 and Section 22585 et seq. of the Streets and Highways Code, declaring the intention of the Board of Supervisors to order the annexation of Zone 106 to Landscaping and Lighting Maintenance District No. 89-1-Consolidated (hereinafter "L&LMD No. 89-1-C") of the County pursuant to the Landscaping and Lighting Act of 1972, being Part 2 (commencing with Section 22500) of Division 15 of the Streets and Highways Code, and giving notice of and setting a public hearing for 9:30 a.m. on January 8, 2008 at the meeting room of the Board of Supervisors and requiring that the notice of the public hearing and assessment ballots be mailed to all owners of property within Zone 106 as shown on the equalized tax roll; and

WHEREAS, notice of said public hearing was duly published and mailed as required by Resolution No. 2007-471, Section 22626 of the Streets and Highways Code and Sections 53753 and 54954.6 of the Government Code and the assessment ballots were timely mailed to all owners of property within said Zone 106 as shown on the equalized tax roll; and

WHEREAS, at 9:30 a.m. on January 8, 2008, as set forth in Resolution No. 2007-471, the Board of Supervisors held a public hearing and afforded all interested persons an opportunity to be heard, and considered all oral statements and all written protest or communications made or filed by any interested persons, closed the public hearing and directed the Director of Transportation, or his designee, as an impartial person having no vested interest in the annexation of Zone 106 to L&LMD

1 No. 89-1-C as required by Section 53753(e) of the Government Code to tally the assessment ballots
2 that had been received prior to the close of the public hearing; and

3 **WHEREAS**, the tally of the assessment ballots show that assessment ballots were timely
4 received from the owner of 1 parcel out of a possible 1 parcel and that 1 parcel (100 percent of the
5 assessment ballots received) voted in favor of annexation of Zone 106 to L&LMD No. 89-1-C and the
6 levy of an annual assessment in said Zone 106 beginning fiscal year 2008-09; and

7 **WHEREAS**, the Board of Supervisors may proceed, pursuant to Section 22631 of the Streets
8 and Highways Code, to adopt a resolution confirming the diagram and assessment, either as originally
9 proposed, or as changed by the Board of Supervisors, and the adoption of such a resolution shall
10 constitute the levy of an assessment on all assessable lots and parcels of land within Zone 106 of
11 L&LMD No. 89-1-C beginning fiscal year 2008-09.

12 **NOW, THEREFOR, BE IT RESOLVED, FOUND, DETERMINED AND ORDERED** by the
13 Board of Supervisors of the County in regular session on February 26, 2008 as follows:

14 **Section 1. Findings.** The Board of Supervisors finds:

- 15 (a) the proceeding recitals are correct;
- 16 (b) compliance has been had with all the requirements of the Landscaping and
17 Lighting Act of 1972, being Part 2 (commencing with Section 22500) of Division
18 15 of the Streets and Highways Code, and Sections 53753 and 54954.6 of the
19 Government Code;
- 20 (c) a majority protest to the annexation of and annual assessment of Zone 106 of
21 L&LMD No. 89-1-C has not been filed;
- 22 (d) the tally of the assessment ballots timely received was 100 percent voted in
23 favor of the annexation of Zone 106 to L&LMD No. 89-1-C and the levy of an
24 annual assessment beginning fiscal year 2008-09, and 0 percent voted no;
- 25 (e) the Board of Supervisors may proceed to adopt a resolution ordering the
26 annexation of Zone 106 to L&LMD No. 89-1-C;

- 1 (f) the Board of Supervisors may proceed to adopt a resolution confirming the
2 diagram and assessment for Zone 106 of L&LMD No. 89-1-C either as originally
3 proposed or as changed by it; and
- 4 (g) the assessments to be levied on the assessable lots and parcels of land within
5 Zone 106 of L&LMD No. 89-1-C for the installation, maintenance and servicing
6 of traffic signal and streetlight improvements in said Zone 106 during the fiscal
7 year 2008-09 as contained in the report of the Director of Transportation which
8 is on file with the Clerk of the Board of Supervisors (hereinafter the "Report") are
9 based on benefits derived by such lots and parcels from the availability of such
10 traffic signal and streetlight improvements, and are not based upon the
11 ownership of such lots and parcels.

12 **Section 2. Annexation.** Zone 106, as proposed to be annexed to L&LMD No.
13 89-1-C, includes all the property subject to Plot Plan No. 18138 in the County of Riverside, State of
14 California as described in Exhibit "A" attached hereto, shall be and is annexed into L&LMD No. 89-1-C.

15 **Section 3. Improvements.** The improvements authorized for Zone 106 of L&LMD
16 No. 89-1-C are:

- 17 (a) Providing electricity to and the maintenance and servicing of traffic signals within
18 the public right-of-way including incidental costs and expenses; and
- 19 (b) Providing electricity to all streetlights within the public right-of-way including
20 incidental costs and expenses.

21 **Section 4. Confirmation of Report.** The Report and the assessment diagram and
22 the assessment of estimated costs for the installation, maintenance and servicing of traffic signal and
23 streetlight improvements in Zone 106 of L&LMD No. 89-1-C for fiscal year 2008-09 as contained in the
24 Report are confirmed.

25 **Section 5. Levy of Assessment.** Pursuant to Section 22631 of the Streets and
26 Highways Code the adoption of this resolution constitutes the levy of the assessment for the

1 installation, and maintenance or servicing of traffic signal and streetlight improvements in Zone 106 of
2 L&LMD No. 89-1-C during fiscal year 2008-09, as contained in the Report, and such assessment is
3 levied. The Clerk of the Board of Supervisors is directed to file a certified copy of this resolution,
4 together with the diagram and assessment contained in the Report with the County Auditor-Controller
5 of the County of Riverside, who, pursuant to Section 22645 of the Streets and Highways Code, shall
6 enter on the County Tax Roll opposite each lot or parcel of land the amount assessed thereupon, as
7 shown in said assessment.

8 **Section 6. Effective Date.** This Resolution shall take effect from and after its date
9 of adoption.

10
11
12
13
14 FORM APPROVED COUNTY COUNSEL
BY: DALE A. GARDNER 11/8/08
DATE

EXHIBIT "A"

DESCRIPTION OF BOUNDARIES

The boundaries of Zone 106 to be annexed into Landscaping and Lighting Maintenance District No. 89-1-Consolidated, of the County of Riverside are coterminous with the boundaries of APN 173-020-060 as shown on Assessment Roll in the County of Riverside, State of California in Fiscal Year 2008-09.

1
2
3
4
5
6
7
8
9
10
11
12
13
14
15
16
17
18
19
20
21
22
23
24

LANDSCAPING AND LIGHTING MAINTENANCE DISTRICT NO. 89-1-CONSOLIDATED
ZONE 106

PORTION OF SECTION 3, T.2S., R.6W.
PLOT PLAN NO. 18138 - 1 PARCEL

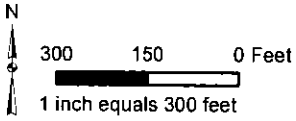



The County of Riverside assumes no warranty or legal responsibility for the information contained on this map. Data and information represented on this map is subject to updates, modifications and may not be complete or appropriate for all purposes. County GIS and other sources should be queried for the most current information. Do not copy or resell this map.

ASSESSMENT DIAGRAM

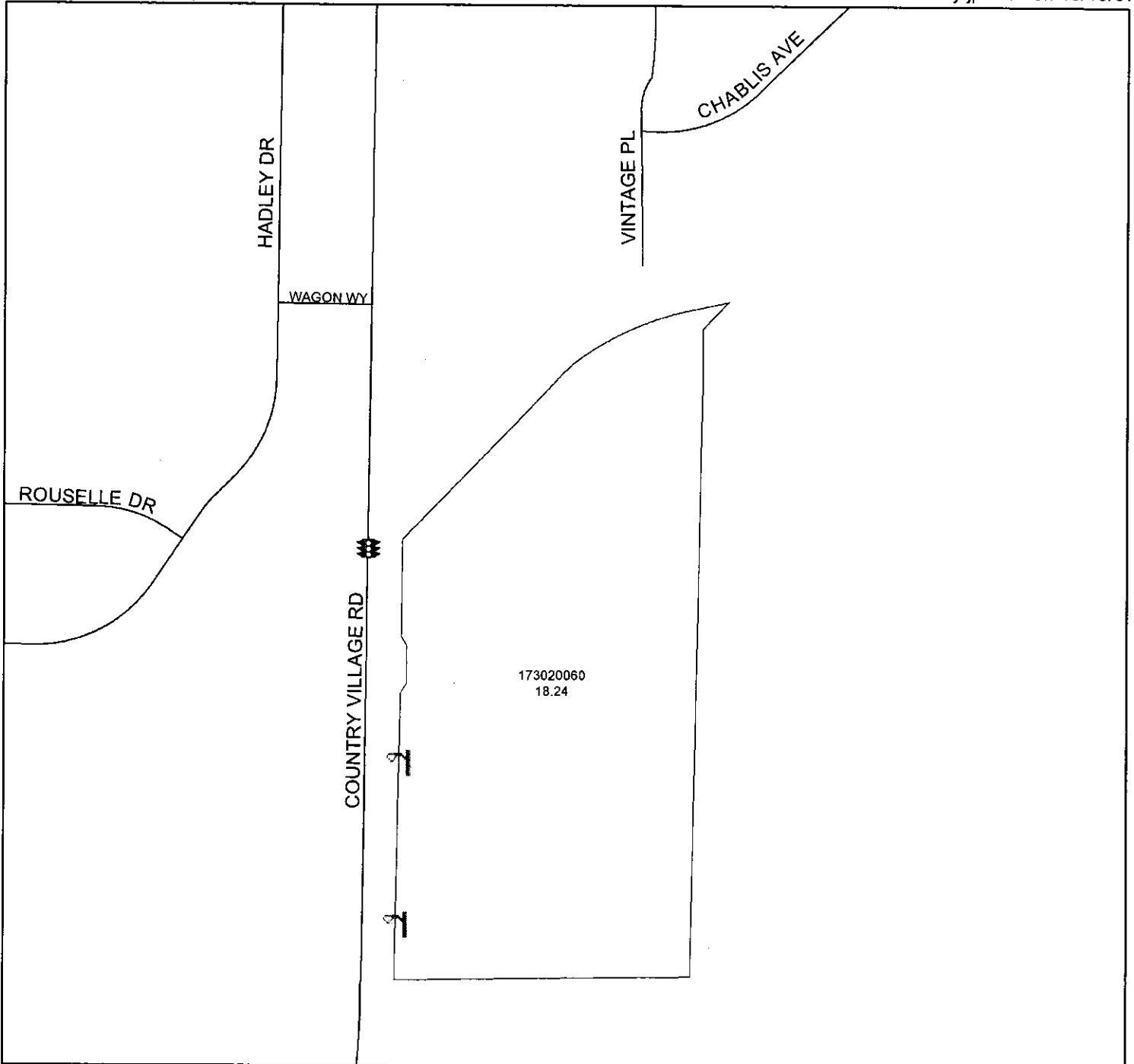
Printed by jpickeri on 10/19/07



-  DENOTES MAINTAINED STREETLIGHT
-  DENOTES MAINTAINED TRAFFIC SIGNAL