

**SUBMITTAL TO THE BOARD OF SUPERVISORS
COUNTY OF RIVERSIDE, STATE OF CALIFORNIA**

918A



FORM APPROVED COUNTY COUNSEL
BY: Marshall Victor 01/29/08
DATE

Department's Concurrence

FROM: TLMA - Transportation Dept.

SUBMITTAL DATE:
February 15, 2008

SUBJECT: Construction of Metal Beam Guard Railing, Shoulder Widening and Associated Improvements, Gilman Springs Road from 524 Feet Northwest of Sublette Road West to Sublette Road East in the San Jacinto Area, and Road Rehabilitation on Redlands Boulevard, Moreno Valley City Limits to San Timoteo Canyon Road, Moreno Valley area.

RECOMMENDED MOTION: That the Board of Supervisors approve the plans and specifications for the construction of metal beam guard railing, shoulder widening and associated improvements on Gilman Springs Road from 524 feet northwest of Sublette Road West to Sublette Road East in the San Jacinto area, and road rehabilitation on Redlands Boulevard from the Moreno Valley City Limits to San Timoteo Canyon Road in the Moreno Valley area of Riverside County. Authorize the Clerk to advertise for bids to be received in the office of the Director of Transportation up to the hour of 2:00 PM, Wednesday, March 19, 2008, at which time bids will be opened.

George A. Johnson
Director of Transportation

GAJ:sd
(Continued On Attached Page)

FINANCIAL DATA	Current F.Y. Total Cost:	\$ 1,850,000	In Current Year Budget:	Yes
	Current F.Y. Net County Cost:	\$ 0	Budget Adjustment:	No
	Annual Net County Cost:	\$ 0	For Fiscal Year:	2007/2008
SOURCE OF FUNDS: State Exchange Funds (6%), STP Formula (36%), HES (8%), Measure A/Western (50%)				Positions To Be Deleted Per A-30 <input type="checkbox"/>
				Requires 4/5 Vote <input type="checkbox"/>

C.E.O. RECOMMENDATION:

APPROVE

BY: Tina Grande

County Executive Office Signature

Dep't Recomm.: Policy
Per Exec. Ofc.: Policy

Prev. Agn. Ref. | District: 3,5 | Agenda Number:

ATTACHMENTS FILED
WITH THE CLERK OF THE BOARD

3.80

The Honorable Board of Supervisors

RE: Construction of Metal Beam Guard Railing, Shoulder Widening and Associated Improvements, Gilman Springs Road from 524 Feet Northwest of Sublette Road West to Sublette Road East in the San Jacinto Area, and Road Rehabilitation on Redlands Boulevard, Moreno Valley City Limits to San Timoteo Canyon Road, Moreno Valley area.

February 15, 2008

Page 2 of 2

BACKGROUND: The Transportation Improvement Program provides for the construction of the subject improvements. The submitted plans and specifications have been approved as to form by County Counsel. Environmental clearance is complete.

The metal beam guard railing project on Gilman Springs Road is being funded substantially from Federal Hazard Elimination Safety funds for which the Transportation Department successfully competed. The project is expected to improve roadway safety within the project limits by providing a paved shoulder and metal beam guard rail, which is a warranted improvement.

The road rehabilitation work on Redland Boulevard is necessary due to deteriorated pavement conditions.

Project Nos B6-0576 and B0-0736.

COUNTY OF RIVERSIDE

GILMAN SPRINGS ROAD

524.00' NW'LY OF SUBLETTE ROAD WEST TO SUBLETTE ROAD EAST
METAL BEAM GUARD RAIL INSTALLATION AND 4' SHOULDER WIDENING

WORK ORDER NO 88-0578
FEDERAL ID. NO. STPLH-5958(XXX)

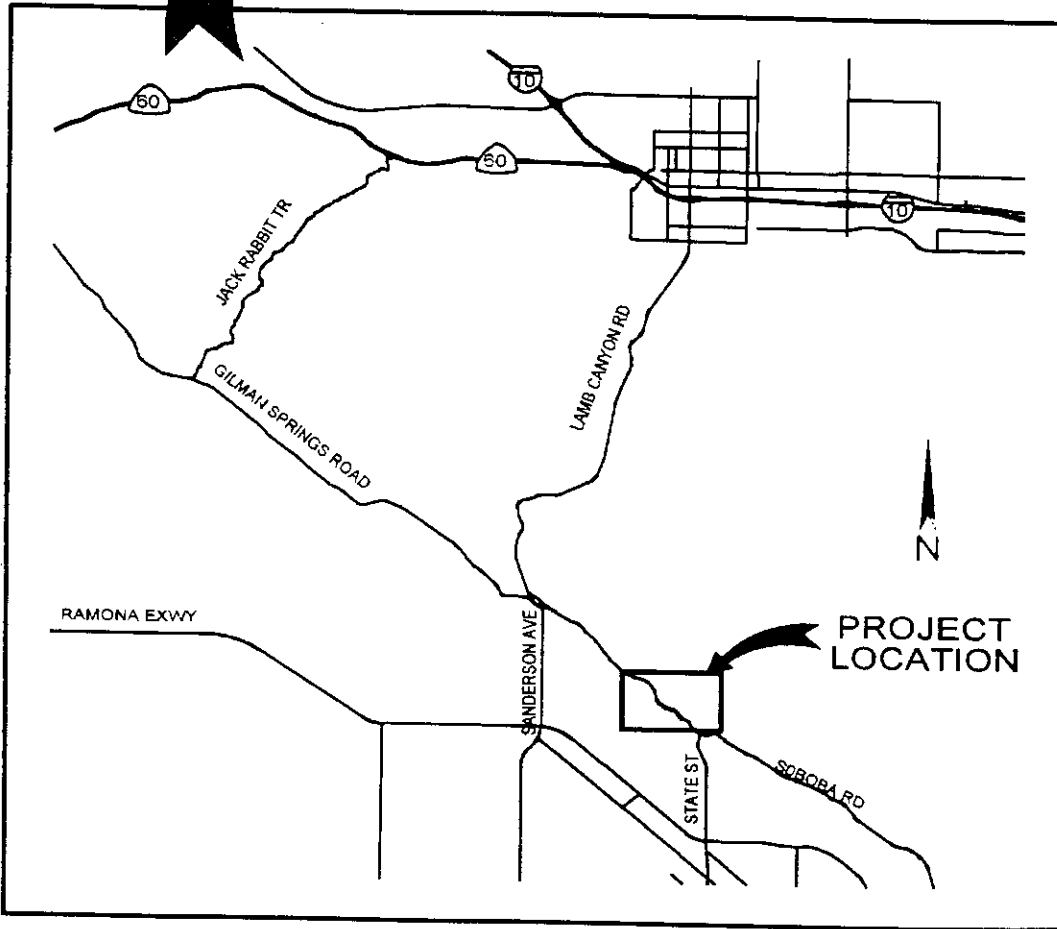
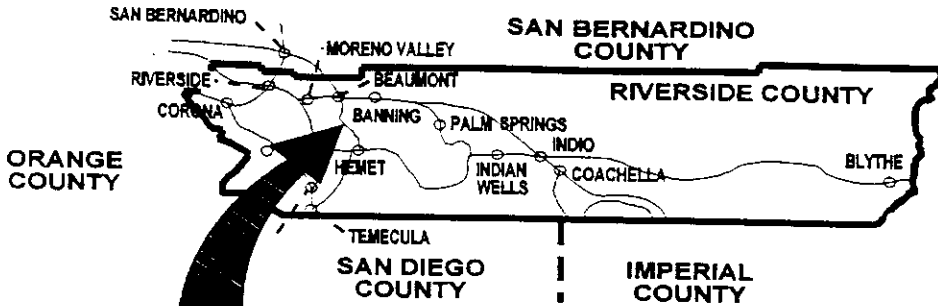

VICINITY MAP

T4SR1W, SECS 16,18
L = 0.5 MILES

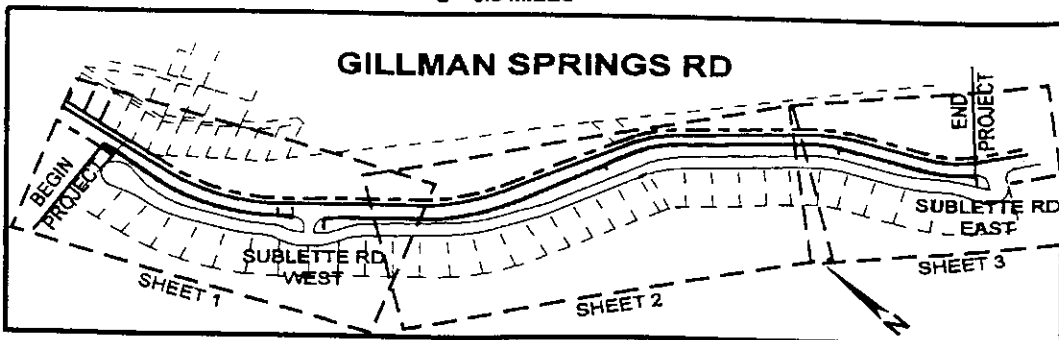

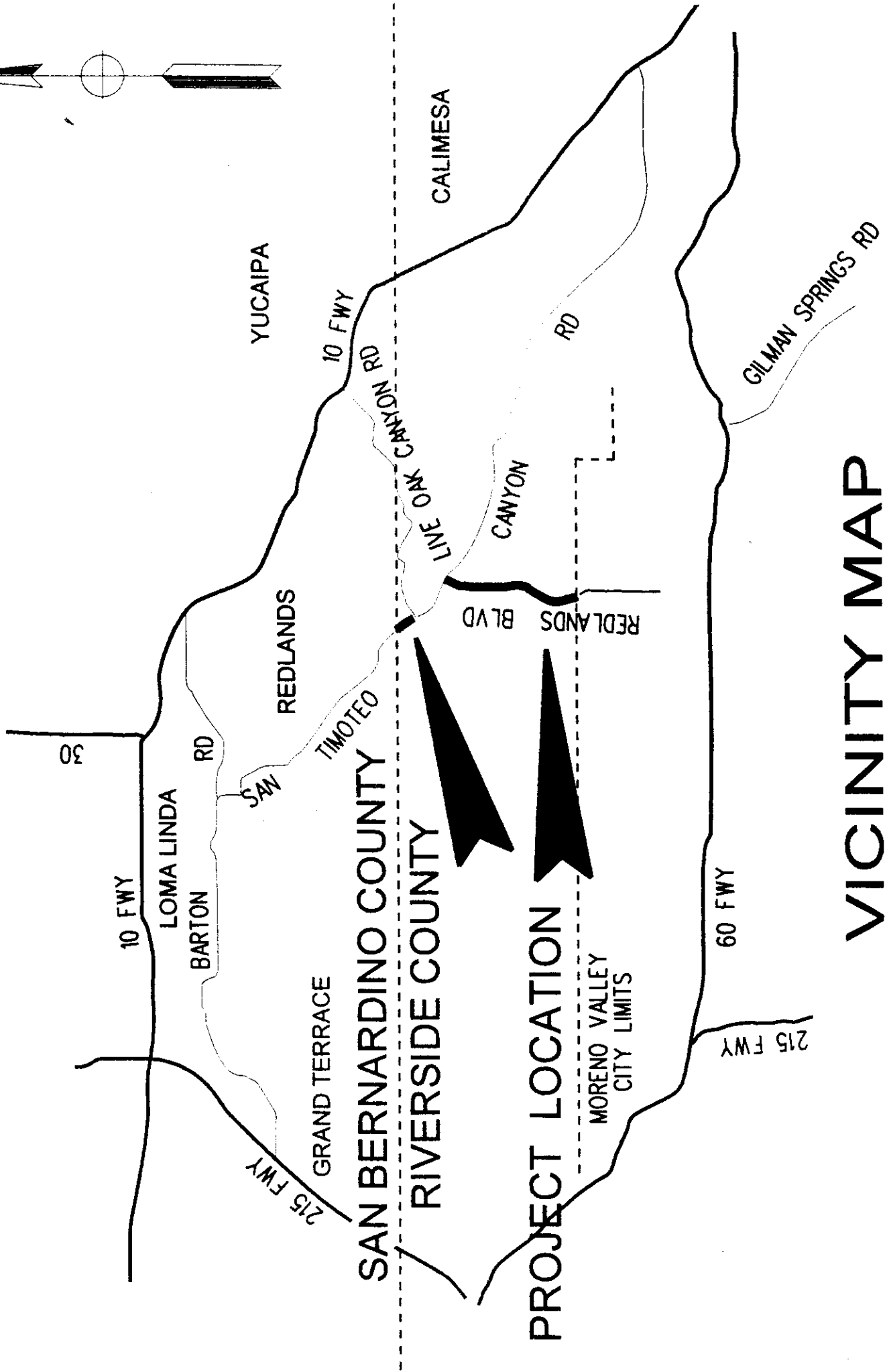
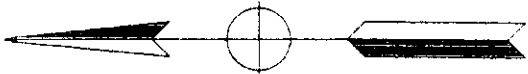

VICINITY MAP

NO SCALE