

**SUBMITTAL TO THE BOARD OF SUPERVISORS  
COUNTY OF RIVERSIDE, STATE OF CALIFORNIA**

*b12A*



**SUBMITTAL DATE:**  
March 31, 2008

**FROM:** TLMA - Transportation Dept.

**SUBJECT:** Construction of Sidewalk Improvements, Grand Avenue, Morrison Place to 650 feet Southeast of Stoneman Street and Drainage Improvements, Lake Elsinore Area.

**RECOMMENDED MOTION:** That the Board accept the low bid of Hillcrest Contracting, Inc. of Corona, CA in the amount of \$313,204. Award the contract to that firm and authorize the Chairman of the Board to execute the contract documents. Amend the Transportation Improvement Program's project budget as proposed on Attachment "A".

**BACKGROUND:** By Minute Order dated December 18, 2007 (agenda item 3.59) the Board authorized the Clerk of the Board to advertise for construction of sidewalk improvements, Grand Avenue, Morrison Place to 650 feet southeast of Stoneman Street and Drainage Improvements in the Lake Elsinore Area. Bids for the project were opened in the office of the Director of Transportation at 2:00 PM, Wednesday, January 16, 2008. Twelve bids were received. The lowest and best bid was submitted by Hillcrest Contracting, Inc. in the amount of \$313,204. The bid is \$14,561 (4.4%) less than the Engineer's Estimate. The contractor is qualified.

*George A. Johnson*  
George A. Johnson  
Director of Transportation

GAJ:jj  
(Continued On Attached Page)

<b>FINANCIAL DATA</b>	Current F.Y. Total Cost:	\$ 313,204	In Current Year Budget:	Yes
	Current F.Y. Net County Cost:	\$ 0	Budget Adjustment:	No
	Annual Net County Cost:	\$ 0	For Fiscal Year:	2007/2008

<b>SOURCE OF FUNDS:</b> Community Development Block Grant (10.2%), Measure A/Western (13.9%), (Redevelopment Agency (75.9%)	<b>Positions To Be Deleted Per A-30</b>	<input type="checkbox"/>
	<b>Requires 4/5 Vote</b>	<input type="checkbox"/>

**C.E.O. RECOMMENDATION:**

APPROVE  
*Tina Grande*  
BY: Tina Grande  
Tina Grande

County Executive Office Signature

FORM APPROVED COUNTY COUNSEL  
BY: *Marshall Victor*  
DATE: 03/15/08  
MARSHAL VICTOR  
Departmental Concurrent

Dep't Recomm.:  Consent  Policy  
Per Exec. Ofc.:  Consent  Policy

**Prev. Agn. Ref.** 12/18/2007 (3.59) | **District:** 1 | **Agenda Number:**

ATTACHMENTS FILED WITH THE CLERK OF THE BOARD  
**3.24**

The Honorable Board of Supervisors

RE: Construction of Sidewalk Improvements, Grand Avenue, Morrison Place to 650 feet  
Southeast of Stoneman Street and Drainage Improvements, Lake Elsinore Area.

March 31, 2008

Page 2 of 2

The Transportation Improvement Program provides for the construction of the subject improvements as a pedestrian safety project which connects a newly constructed asphalt concrete walkway on Grand Avenue to an existing sidewalk south of Stoneman Street.

The project includes the additional work of drainage improvements at the intersection of Fairmont Lane and Grand Avenue.

The submitted plans and specifications have been approved as to form by County Counsel.

Environmental clearance is complete.

Project No. B7-0769

# COUNTY OF RIVERSIDE

## GRAND AVENUE PROJECT SIDEWALK AND OTHERS

GREGORY PLACE TO 100' SOUTHERLY  
AND MORRISON PLACE TO 650' SOUTHERLY  
OF STONEMAN STREET  
DRAINAGE IMPROVEMENTS: AT FAIRMONT LANE

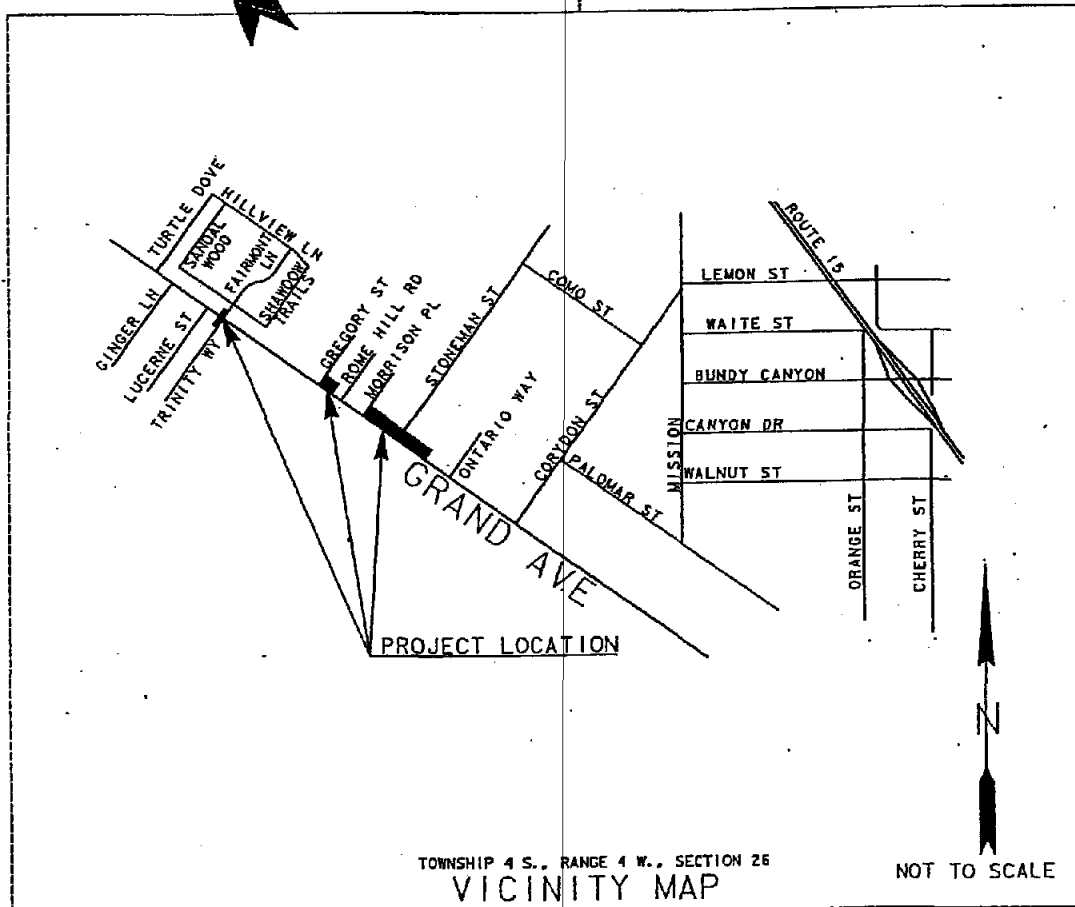
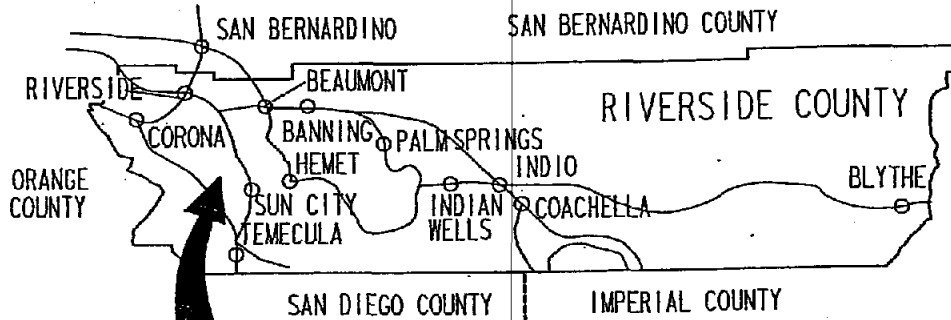

# Attachment "A"

Riverside County Transportation Department

Project: **GRAND AVENUE SIDEWALK (GREGORY PL. TO 100' S'LY & MORRISON PL. TO 650' S'LY OF STONEMAN ST. & DRAINAGE IMP. @ FAIRMONT).**

Project No.(s): **B7-0769**

Expenses as of: 9/27/07

## Project Costs and Budget

Activity	Incurred Costs	Projected Costs	Total Costs	Existing Budget	Proposed Budget
Preliminary Survey	26,909	0	26,909	29,000	26,900
Environmental	10,000	0	10,000	7,000	10,000
Design	75,000	0	75,000	75,000	75,000
Right-of-way	7,000	0	7,000	17,000	7,000
Utilities	0	2,000	2,000	2,000	2,000
Construction	0	313,204	313,204	250,000	344,500
Construction Contingency 10.0%	0	31,320	31,320		
Construction Engineering & Inspection	2,648	52,352	55,000	20,000	55,000
Construction Survey	0	0	20,000	10,000	20,000
<b>Totals:</b>	<b>121,557</b>	<b>398,876</b>	<b>540,433</b>	<b>410,000</b>	<b>540,400</b>

## Project Funding

Code	Name	Existing Budget	Proposed Budget
330	Community Development Block Grant (CDBG)		55,000
332	Redevelopment Agency	410,000	410,000
300	Measure A / Western		75,400
<b>Totals</b>		<b>410,000</b>	<b>540,400</b>

## Comments

--	--

**ENCUMBRANCE INFORMATION  
FOR BOARD OF SUPERVISORS APPROVED CONTRACTS  
COUNTY OF RIVERSIDE**

VENDOR NAME AND ADDRESS:

Hillcrest Contracting, Inc.  
1467 Circle City Drive  
Corona, CA 92879-1668  
(951) 273-9600

DEPT: **Transportation**

DATE: February 26, 2008

BUDGET F.Y.: 2007 / 2008

B-PO NO.: **B**

BOS APPROVAL DATE: \_\_\_\_\_

AGENDA NUMBER: \_\_\_\_\_

VENDOR  
CODE: \_\_\_\_\_

TRANS  
CODE: **PO**

TRANS  
DEPT: **3130500000**

DOCUMENT  
TOTAL: **\$313,204.40**

LINE NO.	FUND	DEPT	ORG.	SUB ORG.	APPR. CODE	OBJECT	ACTIVITY	JOB/PROJECT	LINE AMOUNT
	<b>20000</b>								

NOTE:

Fund 20000 is exempt from encumbering construction contracts per agreement with A-C General Accounting Division. (Contact: Bob Barton Ext. 5-3843)

Regular contract or  Blanket contract.  
If blanket:  Encumber,  
 Do not encumber.  
 Current year contract, or  
 Multi-year contract.

If multi-year contract,  
encumbrance amount for:  
First year \$ N/A  
Second year \$ \_\_\_\_\_  
Third year \$ \_\_\_\_\_

CONTRACT DESCRIPTION:

**Construction of Sidewalk Improvements; Grand Ave, Morrison  
Place to 650 feet Southeast of Stoneman Street  
Project No. B7-0769**

PREPARED BY: **Joel Jimenez**

DATE: **February 26, 2008**

APPROVED BY: \_\_\_\_\_

DATE: \_\_\_\_\_

PHONE: **(951) 955-1537**

PHONE: \_\_\_\_\_

A-C ENCUMBRANCE:

ENCUMBERED BY: \_\_\_\_\_



**Riverside County Transportation Department  
Summary of Bids**

Advertised: December 18, 2007 (Agenda item 3.59)  
Bids Open: 2:00 pm Date: Wednesday, January 16, 2008

**PROJECT: Grand Avenue Project**  
Sidewalk and Other: Gregory Place to 100' Southerly and Morrison Place to 650'  
Southerly of Stoneman Street Drainage Improvements at Fairmount Lane  
**PROJECT NOS. B7-0769**

Updated: 1/16/2008

Bid Schedule		COUNTY'S ESTIMATE		HILLCREST CONTRACTING Corona, CA 92878				
ITEM NO.	ITEM CODE	CONTRACT ITEM	UNITS	QUANTITY	UNIT PRICE	ENG ESTIMATE	BID UNIT PRICE	BID ESTIMATE
1	066102	DUST ABATEMENT	LS	1	2,000.00	2,000.00	2,000.00	2,000.00
2	074020	WATER POLLUTION CONTROL	LS	1	3,000.00	3,000.00	6,000.00	6,000.00
3	120100	TRAFFIC CONTROL SYSTEM [including Construction Project Funding (Identification Signs)]	LS	1	15,000.00	15,000.00	9,000.00	9,000.00
4	017314	MINOR CONCRETE PAVEMENT (DIP SECTION) (CRS 307)	SQFT	2,620	10.00	26,200.00	6.50	17,030.00
5	152370	RELOCATE MAILBOX	EA	10	150.00	1,500.00	120.00	1,200.00
6	152392	RELOCATE SIGN	EA	5	150.00	750.00	120.00	600.00
7	000003	HEADER CUT (COLD PLANE) ASPHALT CONCRETE PAVEMENT	SQYD	930	3.50	3,255.00	6.30	5,859.00
8	160101	CLEARING AND GRUBBING [including Minor Tree Trimming]	LS	1	3,000.00	3,000.00	3,000.00	3,000.00
9	160120	REMOVE TREE	EA	7	500.00	3,500.00	620.00	4,340.00
10	190101	ROADWAY EXCAVATION [including Earthwork, and Dirt Berm]	CY	1,150	18.00	20,700.00	18.00	20,700.00
11	220101	FINISHING ROADWAY	LS	1	2,000.00	2,000.00	11,000.00	11,000.00
12	260201	CLASS 2 AGGREGATE BASE [including Dip Section]	CY	1,120	45.00	50,400.00	32.00	35,840.00
13	390103	ASPHALT CONCRETE (TYPE B)	TON	820	75.00	61,500.00	73.50	60,270.00
14	394002	PLACE ASPHALT CONCRETE (MISCELLANEOUS AREA) [Aprons, Walkway Transitions, Pads, Pad Transitions, Miscellaneous Transitions, Dikes, and Dike Transitions]	LS	1	5,000.00	5,000.00	4,600.00	4,600.00
15	510501	MINOR CONCRETE [Concrete Collar- RCFC & WCD STD. DWG. 803]	EA	2	1,500.00	3,000.00	1,300.00	2,600.00
16	518201	MASONRY BLOCK WALL [Remove and Reconstruct]	LF	80	120.00	9,600.00	62.00	4,960.00
17	650018	18" REINFORCED CONCRETE PIPE [D 2000]	LF	182	100.00	19,200.00	163.00	31,296.00
18	-	DELETED BY ADDENDUM	-	-	0.00	0.00	0.00	0.00
19	720000	ROCK SLOPE PROTECTION (Facing- Method B) [Swale, Rip Rap, Fabric]	LS	1	1,000.00	1,000.00	2,600.00	2,600.00
20	017304	MINOR CONCRETE (CURB AND GUTTER) (CRS 200)	LF	1,140	18.00	20,520.00	16.00	18,240.00
21	017310	MINOR CONCRETE (DRIVEWAY APPROACH) (CRS 207)	EA	7	2,000.00	14,000.00	3,230.00	22,610.00
22	731521	MINOR CONCRETE (SIDEWALK) (CRS 401)	SQFT	6,400	5.00	32,000.00	3.40	21,760.00
23	017315	MINOR CONCRETE (CURB RAMP) (CRS 403 - CASE A)	EA	3	2,500.00	7,500.00	2,500.00	7,500.00
24	017316	MINOR CONCRETE (CURB RAMP) (CRS 403 - CASE B)	EA	1	2,500.00	2,500.00	2,400.00	2,400.00
25	869040	PULL BOX [Remove and Replace]	EA	3	300.00	900.00	230.00	690.00
26	999990	MOBILIZATION	LS	1	3,000.00	3,000.00	3,000.00	3,000.00
27	860811	DETECTOR LOOP [Install and stub outs (Type E)]	EA	8	450.00	3,600.00	310.00	2,480.00
28	152379	RELOCATE FENCE	LF	50	30.00	1,500.00	40.00	2,000.00
29	017305	MINOR CONCRETE (CURB AND GUTTER) (CRS 201)	LF	70	20.00	1,400.00	22.00	1,540.00
30	017007	CONCRETE DROP INLET [RCFC & WCD DWG. 08 110]	EA	1	3,500.00	3,500.00	3,100.00	3,100.00
31	000003	SLURRY BACKFILL	CY	30	150.00	4,500.00	148.00	4,440.00
32	840656	PAINT TRAFFIC STRIPE (2 COAT)	LF	820	2.00	1,640.00	0.52	426.40
33	840666	PAINT PAVEMENT MARKING (2 COAT)	SQFT	30	20.00	600.00	4.10	123.00
ITEMS 1-33						327,765.00		313,204.40

**Riverside County Transportation Department  
Summary of Bids**

Advertised: December 18, 2007 (Agenda item 3.59)  
Bids Open: 2:00 pm Date: Wednesday, January 16, 2008

**PROJECT: Grand Avenue Project**  
Sidewalk and Other: Gregory Place to 100' Southerly and Morrison Place to 650' Southerly of Stoneman Street Drainage Improvements at Fairmount Lane  
PROJECT NOS. B7-0769

Updated: 1/16/2008

Bid Schedule		LANDMARK SITE CONTRACTORS Perris, CA 92570		R.J. NOBLE COMPANY Orange, CA 92856				
ITEM NO.	ITEM CODE	CONTRACT ITEM	UNITS	QUANTITY	BID UNIT PRICE	BID ESTIMATE	BID UNIT PRICE	BID ESTIMATE
1	066102	DUST ABATEMENT	LS	1	2,800.00	2,800.00	2,800.00	2,800.00
2	074020	WATER POLLUTION CONTROL	LS	1	4,420.00	4,420.00	3,250.00	3,250.00
3	120100	TRAFFIC CONTROL SYSTEM [including Construction Project Funding Identification Signs]	LS	1	7,620.00	7,620.00	3,000.00	3,000.00
4	017314	MINOR CONCRETE PAVEMENT (DIP SECTION) (CRS 307)	SQFT	2,620	7.20	18,864.00	7.15	18,733.00
5	152370	RELOCATE MAILBOX	EA	10	110.00	1,100.00	150.00	1,500.00
6	152382	RELOCATE SIGN	EA	5	180.00	900.00	170.00	850.00
7	000003	HEADER CUT (COLD PLANE) ASPHALT CONCRETE PAVEMENT	SQYD	930	7.30	6,789.00	3.25	3,022.50
8	160101	CLEARING AND GRUBBING [including Minor Tree Trimming]	LS	1	6,040.00	6,040.00	3,750.00	3,750.00
9	160120	REMOVE TREE	EA	7	850.00	5,950.00	540.00	3,780.00
10	190101	ROADWAY EXCAVATION [including Earthwork, and Dirt Berm]	CY	1,150	23.80	27,370.00	27.60	31,740.00
11	220101	FINISHING ROADWAY	LS	1	12,200.00	12,200.00	11,400.00	11,400.00
12	260201	CLASS 2 AGGREGATE BASE [including Dip Section]	CY	1,120	37.20	41,664.00	29.30	32,816.00
13	390103	ASPHALT CONCRETE (TYPE B)	TON	820	89.40	73,308.00	73.00	59,860.00
14	394002	PLA ASPHALT CONCRETE (MISCELLANEOUS AREA) [Aprons, Walkway Transitions, Pads, Pad Transitions, Miscellaneous Transitions, Dikes, and Dike Transitions]	LS	1	5,085.00	5,085.00	5,000.00	5,000.00
15	510501	MINOR CONCRETE [Concrete Collar- RCFC & WCD STD. DWG. 803]	EA	2	990.00	1,980.00	625.00	1,250.00
16	518201	MASONRY BLOCK WALL [Remove and Reconstruct]	LF	80	72.00	5,760.00	190.00	15,200.00
17	650018	18" REINFORCED CONCRETE PIPE [D 2000]	LF	192	106.50	20,256.00	110.00	21,120.00
18		DELETED BY ADDENDUM			0.00	0.00	0.00	0.00
19	720000	ROCK SLOPE PROTECTION (Facing- Method B) [Swale, Rip Rap, Fabric]	LS	1	1,210.00	1,210.00	2,600.00	2,600.00
20	017304	MINOR CONCRETE (CURB AND GUTTER) (CRS 200)	LF	1,140	16.60	18,924.00	19.75	22,515.00
21	017310	MINOR CONCRETE (DRIVEWAY APPROACH) (CRS 207)	EA	7	955.00	6,685.00	800.00	5,600.00
22	731521	MINOR CONCRETE (SIDEWALK) (CRS 401)	SQFT	6,400	2.60	16,640.00	3.45	22,080.00
23	017315	MINOR CONCRETE (CURB RAMP) (CRS 403 - CASE A)	EA	3	1,710.00	5,130.00	3,350.00	10,050.00
24	017316	MINOR CONCRETE (CURB RAMP) (CRS 403 - CASE B)	EA	1	1,540.00	1,540.00	3,100.00	3,100.00
25	869040	PULL BOX [Remove and Replace]	EA	3	204.00	612.00	310.00	930.00
26	999990	MOBILIZATION	LS	1	7,400.00	7,400.00	18,500.00	18,500.00
27	860811	DETECTOR LOOP [Install and stub outs (Type E)]	EA	8	414.00	3,312.00	230.00	1,840.00
28	152379	RELOCATE FENCE	LF	50	28.50	1,425.00	64.00	3,200.00
29	017305	MINOR CONCRETE (CURB AND GUTTER) (CRS 201)	LF	70	31.50	2,205.00	20.50	1,435.00
30	017007	CONCRETE DROP INLET [RCFC & WCD DWG. CB 110]	EA	1	3,050.00	3,050.00	7,000.00	7,000.00
31	000003	SLURRY BACKFILL	CY	30	168.00	5,040.00	125.00	3,750.00
32	840556	PAINT TRAFFIC STRIPE (2 COAT)	LF	820	1.80	1,476.00	1.10	902.00
33	840666	PAINT PAVEMENT MARKING (2 COAT)	SQFT	30	6.00	180.00	13.00	390.00
ITEMS 1-33						316,936.00		322,963.50

**Riverside County Transportation Department  
Summary of Bids**

Advertised: December 18, 2007 (Agenda item 3.59)  
Bids Open: 2:00 pm Date: Wednesday, January 16, 2008

**PROJECT: Grand Avenue Project**

Sidewalk and Other: Gregory Place to 100' Southerly and Morrison Place to 650'  
Southerly of Stoneman Street Drainage Improvements at Fairmount Lane  
PROJECT NOS. B7-0769

Updated: 1/16/2008

**ROADWAY ENGINEERING  
AND CONTRACTING INC.  
Riverside, CA 92509**

**GRAND PACIFIC CONTRACTORS, IN  
Mira Loma, CA 91752**

Bid Schedule ITEM NO./ITEM CODE	CONTRACT ITEM	UNITS	QUANTITY	BID UNIT PRICE	BID ESTIMATE	BID UNIT PRICE	BID ESTIMATE
1 066102	DUST ABATEMENT	LS	1	1,000.00	1,000.00	5,000.00	5,000.00
2 074020	WATER POLLUTION CONTROL	LS	1	1,650.00	1,650.00	2,500.00	2,500.00
3 120100	TRAFFIC CONTROL SYSTEM [including Construction Project Funding Identification Signs]	LS	1	5,200.00	5,200.00	5,000.00	5,000.00
4 017314	MINOR CONCRETE PAVEMENT (DIP SECTION) (CRS 307)	SQFT	2,620	5.50	14,410.00	8.50	22,270.00
5 152370	RELOCATE MAILBOX	EA	10	80.00	800.00	250.00	2,500.00
6 152392	RELOCATE SIGN	EA	5	155.00	775.00	220.00	1,100.00
7 000003	HEADER CUT (COLD PLANE) ASPHALT CONCRETE PAVEMENT	SOYD	930	6.00	5,580.00	6.00	5,580.00
8 160101	CLEARING AND GRUBBING [including Minor Tree Trimming]	LS	1	3,000.00	3,000.00	5,000.00	5,000.00
9 160120	REMOVE TREE	EA	7	800.00	5,600.00	500.00	3,500.00
10 190101	ROADWAY EXCAVATION [including Earthwork, and Dirt Berm]	CY	1,150	41.00	47,150.00	14.00	16,100.00
11 220101	FINISHING ROADWAY	LS	1	7,000.00	7,000.00	3,500.00	3,500.00
12 260201	CLASS 2 AGGREGATE BASE [including Dip Section]	CY	1,120	30.00	33,600.00	32.00	35,840.00
13 390103	ASPHALT CONCRETE (TYPE B)	TON	820	74.20	60,844.00	75.60	61,992.00
14 394002	PLACE ASPHALT CONCRETE (MISCELLANEOUS AREA) [Aprons, Walkway Transitions, Pads, Pad Transitions, Miscellaneous Transitions, Dikes, and Dike Transitions]	LS	1	4,600.00	4,600.00	4,730.00	4,730.00
15 510501	MINOR CONCRETE [Concrete Collar- RCFC & WCD STD. DWG. 803]	EA	2	2,350.00	4,700.00	1,850.00	3,700.00
16 518201	MASONRY BLOCK WALL [Remove and Reconstruct]	LF	80	55.00	4,400.00	250.00	20,000.00
17 650018	18" REINFORCED CONCRETE PIPE [D 2000]	LF	192	92.00	17,664.00	110.00	21,120.00
18	DELETED BY ADDENDUM			0.00	0.00	0.00	0.00
19 720000	ROCK SLOPE PROTECTION (Facing- Method B) [Swale, Rip Rap, Fabric]	LS	1	1,250.00	1,250.00	2,500.00	2,500.00
20 017304	MINOR CONCRETE (CURB AND GUTTER) (CRS 200)	LF	1,140	25.00	28,500.00	28.00	31,920.00
21 017310	MINOR CONCRETE (DRIVEWAY APPROACH) (CRS 207)	EA	7	3,200.00	22,400.00	2,500.00	17,500.00
22 731521	MINOR CONCRETE (SIDEWALK) (CRS 401)	SQFT	6,400	3.80	24,320.00	4.95	31,680.00
23 017315	MINOR CONCRETE (CURB RAMP) (CRS 403 - CASE A)	EA	3	3,600.00	10,800.00	1,750.00	5,250.00
24 017316	MINOR CONCRETE (CURB RAMP) (CRS 403 - CASE B)	EA	1	3,600.00	3,600.00	1,500.00	1,500.00
25 869040	PULL BOX [Remove and Replace]	EA	3	125.00	375.00	850.00	2,550.00
26 999990	MOBILIZATION	LS	1	3,000.00	3,000.00	5,000.00	5,000.00
27 860811	DETECTOR LOOP [Install and stub outs (Type E)]	EA	8	480.00	3,840.00	425.00	3,400.00
28 152379	RELOCATE FENCE	LF	50	22.25	1,112.50	20.00	1,000.00
29 017305	MINOR CONCRETE (CURB AND GUTTER) (CRS 201)	LF	70	25.00	1,750.00	28.00	1,960.00
30 017007	CONCRETE DROP INLET [RCFC & WCD DWG. CB 110]	EA	1	4,000.00	4,000.00	3,500.00	3,500.00
31 000003	SLURRY BACKFILL	CY	30	160.00	4,800.00	80.00	2,400.00
32 840556	PAINT TRAFFIC STRIPE (2 COAT)	LF	820	1.08	885.60	0.55	451.00
33 840666	PAINT PAVEMENT MARKING (2 COAT)	SQFT	30	12.80	384.00	11.00	330.00
	<b>ITEMS 1-33</b>				<b>328,990.10</b>		<b>330,373.00</b>

**Riverside County Transportation Department  
Summary of Bids**

Advertised: December 18, 2007 (Agenda item 3.59)  
Bids Open: 2:00 pm Date: Wednesday, January 16, 2008

**PROJECT: Grand Avenue Project**  
Sidewalk and Other: Gregory Place to 100' Southerly and Morrison Place to 650'  
Southerly of Stoneman Street Drainage Improvements at Fairmount Lane  
PROJECT NOS. B7-0769  
Updated: 1/16/2008

Bid Schedule		S & S GRADING AND PAVING, INC. Norco, CA 92860		WHEELER PAVING, INC. Riverside, CA 92509				
ITEM NO.	ITEM CODE	CONTRACT ITEM	UNITS	QUANTITY	BID UNIT PRICE	BID ESTIMATE	BID UNIT PRICE	BID ESTIMATE
1	066102	DUST ABATEMENT	LS	1	1,000.00	1,000.00	2,500.00	2,500.00
2	074020	WATER POLLUTION CONTROL	LS	1	1,500.00	1,500.00	3,000.00	3,000.00
3	120100	TRAFFIC CONTROL SYSTEM [including Construction Project Funding Identification Signs]	LS	1	1,500.00	1,500.00	8,000.00	8,000.00
4	017314	MINOR CONCRETE PAVEMENT (DIP SECTION) (CRS 307)	SQFT	2,620	6.60	17,292.00	9.75	25,545.00
5	152370	RELOCATE MAILBOX	EA	10	100.00	1,000.00	150.00	1,500.00
6	152392	RELOCATE SIGN	EA	5	100.00	500.00	150.00	750.00
7	000003	HEADER CUT (COLD PLANE) ASPHALT CONCRETE PAVEMENT	SQYD	930	6.80	6,324.00	6.00	5,580.00
8	160101	CLEARING AND GRUBBING [including Minor Tree Trimming]	LS	1	1,500.00	1,500.00	2,500.00	2,500.00
9	160120	REMOVE TREE	EA	7	100.00	700.00	425.00	2,975.00
10	190101	ROADWAY EXCAVATION [including Earthwork, and Dirt Berm]	CY	1,150	54.10	62,215.00	25.00	29,900.00
11	220101	FINISHING ROADWAY	LS	1	4,023.00	4,023.00	7,000.00	7,000.00
12	260201	CLASS 2 AGGREGATE BASE [including Dip Section]	CY	1,120	39.75	44,520.00	30.00	33,600.00
13	390103	ASPHALT CONCRETE (TYPE B)	TON	820	81.15	66,543.00	80.00	65,600.00
14	394002	PLACE ASPHALT CONCRETE (MISCELLANEOUS AREA) [Aprons, Walkway Transitions, Pads, Pad Transitions, Miscellaneous Transitions, Dikes, and Dike Transitions]	LS	1	5,300.00	5,300.00	8,000.00	8,000.00
15	510501	MINOR CONCRETE [Concrete Collar- RCFC & WCD STD. DWG. 803]	EA	2	1,045.00	2,090.00	2,500.00	5,000.00
16	518201	MASONRY BLOCK WALL [Remove and Reconstruct]	LF	80	72.50	5,800.00	131.00	10,480.00
17	65001B	18" REINFORCED CONCRETE PIPE [D 2000]	LF	192	104.00	19,968.00	125.00	24,000.00
18		DELETED BY ADDENDUM		-	0.00	0.00	0.00	0.00
19	720000	ROCK SLOPE PROTECTION (Facing- Method B) [Swale, Rip Rap, Fabric]	LS	1	2,150.00	2,150.00	20,000.00	20,000.00
20	017304	MINOR CONCRETE (CURB AND GUTTER) (CRS 200)	LF	1,140	15.00	17,100.00	22.00	25,080.00
21	017310	MINOR CONCRETE (DRIVEWAY APPROACH) (CRS 207)	EA	7	1,900.00	13,300.00	2,150.00	15,050.00
22	731521	MINOR CONCRETE (SIDEWALK) (CRS 401)	SQFT	6,400	3.62	23,168.00	4.00	25,600.00
23	017315	MINOR CONCRETE (CURB RAMP) (CRS 403 - CASE A)	EA	3	3,475.00	10,425.00	1,350.00	4,050.00
24	017316	MINOR CONCRETE (CURB RAMP) (CRS 403 - CASE B)	EA	1	3,475.00	3,475.00	1,850.00	1,850.00
25	869040	PULL BOX [Remove and Replace]	EA	3	560.00	1,680.00	500.00	1,500.00
26	999990	MOBILIZATION	LS	1	9,900.00	9,900.00	5,000.00	5,000.00
27	860811	DETECTOR LOOP [Install and stub outs (Type E)]	EA	8	460.00	3,680.00	450.00	3,600.00
28	152379	RELOCATE FENCE	LF	50	20.00	1,000.00	30.00	1,500.00
29	017305	MINOR CONCRETE (CURB AND GUTTER) (CRS 201)	LF	70	23.80	1,666.00	23.00	1,610.00
30	017007	CONCRETE DROP INLET [RCFC & WCD DWG. CB 110]	EA	1	5,970.00	5,970.00	5,000.00	5,000.00
31	000003	SLURRY BACKFILL	CY	30	92.00	2,760.00	175.00	5,250.00
32	840656	PAINT TRAFFIC STRIPE (2 COAT)	LF	820	1.75	1,435.00	1.75	1,435.00
33	840666	PAINT PAVEMENT MARKING (2 COAT)	SQFT	30	15.00	450.00	6.00	180.00
						339,934.00		352,635.00
						ITEMS 1-33		

**Riverside County Transportation Department  
Summary of Bids**

Advertised: December 18, 2007 (Agenda item 3.59)  
Bids Open: 2:00 pm Date: Wednesday, January 16, 2008

PROJECT: Grand Avenue Project

Sidewalk and Other: Gregory Place to 100' Southerly and Morrison Place to 650'  
Southerly of Stoneman Street Drainage Improvements at Fairmount Lane  
PROJECT NOS. B7-0769

Updated: 1/16/2008

Bid Schedule		4-CON ENGINEERING, INC. Riverside, CA 92509		ALL AMERICAN ASPHALT Corona, CA 92878			
ITEM NO./ITEM CODE	CONTRACT ITEM	UNITS	QUANTITY	BID UNIT PRICE	BID ESTIMATE	BID UNIT PRICE	BID ESTIMATE
1	066102 DUST ABATEMENT	LS	1	4,000.00	4,000.00	1.00	1.00
2	074020 WATER POLLUTION CONTROL	LS	1	1,200.00	1,200.00	4,127.00	4,127.00
3	120100 TRAFFIC CONTROL SYSTEM [Including Construction Project Funding Identification Signs]	LS	1	9,000.00	9,000.00	14,000.00	14,000.00
4	017314 MINOR CONCRETE PAVEMENT (DIP SECTION) (CRS 307)	SQFT	2,820	10.00	26,200.00	18.50	48,470.00
5	152370 RELOCATE MAILBOX	EA	10	170.00	1,700.00	150.00	1,500.00
6	152392 RELOCATE SIGN	EA	5	130.00	650.00	115.00	575.00
7	000003 HEADER CUT (COLD PLANE) ASPHALT CONCRETE PAVEMENT	SQYD	930	7.00	6,510.00	7.50	6,975.00
8	160101 CLEARING AND GRUBBING [including Minor Tree Trimming]	LS	1	3,000.00	3,000.00	4,800.00	4,800.00
9	160120 REMOVE TREE	EA	7	1,250.00	8,750.00	750.00	5,250.00
10	190101 ROADWAY EXCAVATION [including Earthwork, and Dirt Berm]	CY	1,150	50.00	57,500.00	37.00	42,550.00
11	220101 FINISHING ROADWAY	LS	1	1,500.00	1,500.00	1,400.00	1,400.00
12	260201 CLASS 2 AGGREGATE BASE [including Dip Section]	CY	1,120	60.00	67,200.00	26.00	29,120.00
13	390103 ASPHALT CONCRETE (TYPE B)	TON	820	80.00	65,600.00	67.00	54,940.00
14	394002 PLACE ASPHALT CONCRETE (MISCELLANEOUS AREA) [Aprons, Walkway Transitions, Pads, Pad Transitions, Miscellaneous Transitions, Dikes, and Dike Transitions]	LS	1	8,000.00	8,000.00	16,500.00	16,500.00
15	510501 MINOR CONCRETE [Concrete Collar- RCFC & WCD STD. DWG. 803]	EA	2	1,000.00	2,000.00	1,050.00	2,100.00
16	518201 MASONRY BLOCK WALL [Remove and Reconstruct]	LF	80	75.00	6,000.00	140.00	11,200.00
17	650018 18" REINFORCED CONCRETE PIPE [D 2000]	LF	192	90.00	17,280.00	99.00	19,008.00
18	DELETED BY ADDENDUM	-	-	0.00	0.00	0.00	0.00
19	720000 ROCK SLOPE PROTECTION (Facing- Method B) [Swale, Rip Rap, Fabric]	LS	1	2,200.00	2,200.00	1,800.00	1,800.00
20	017304 MINOR CONCRETE (CURB AND GUTTER) (CRS 200)	LF	1,140	22.00	25,080.00	25.00	28,500.00
21	017310 MINOR CONCRETE (DRIVEWAY APPROACH) (CRS 207)	EA	7	1,500.00	10,500.00	1,350.00	9,450.00
22	731521 MINOR CONCRETE (SIDEWALK) (CRS 401)	SQFT	6,400	3.48	22,272.00	5.15	32,960.00
23	017315 MINOR CONCRETE (CURB RAMP) (CRS 403 - CASE A)	EA	3	1,382.50	4,147.50	2,500.00	7,500.00
24	017316 MINOR CONCRETE (CURB RAMP) (CRS 403 - CASE B)	EA	1	655.83	655.83	2,500.00	2,500.00
25	669040 PULL BOX [Remove and Replace]	EA	3	250.00	750.00	450.00	1,350.00
26	999990 MOBILIZATION	LS	1	3,000.00	3,000.00	6,875.00	6,875.00
27	860811 DETECTOR LOOP [Install and stub outs (Type E)]	EA	8	459.07	3,672.56	350.00	2,800.00
28	152379 RELOCATE FENCE	LF	50	33.28	1,664.00	75.00	3,750.00
29	017305 MINOR CONCRETE (CURB AND GUTTER) (CRS 201)	LF	70	22.58	1,580.60	25.00	1,750.00
30	017007 CONCRETE DROP INLET [RCFC & WCD DWG. CB 110]	EA	1	2,388.38	2,388.38	5,600.00	5,600.00
31	000003 SLURRY BACKFILL	CY	30	174.29	5,228.70	185.00	5,550.00
32	840656 PAINT TRAFFIC STRIPE (2 COAT)	LF	820	1.72	1,410.40	1.65	1,353.00
33	840666 PAINT PAVEMENT MARKING (2 COAT)	SQFT	30	5.74	172.20	4.00	120.00
ITEMS 1-33					370,812.17		374,374.00

# Riverside County Transportation Department Summary of Bids

Advertised: December 18, 2007 (Agenda item 3.59)  
Bids Open: 2:00 pm Date: Wednesday, January 16, 2008

PROJECT: Grand Avenue Project  
Sidewalk and Other: Gregory Place to 100' Southerly and Morrison Place to 650'  
Southerly of Stoneman Street Drainage Improvements at Fairmount Lane  
PROJECT NOS. B7-0769

Updated: 1/16/2008

Bid Schedule		OLIVAS VALDEZ, INC. Rancho Cucamonga, CA 91729		ELITE BOBCAT SERVICE Corona, CA 92879				
ITEM NO.	ITEM CODE	CONTRACT ITEM	UNITS	QUANTITY	BID UNIT PRICE	BID ESTIMATE	BID UNIT PRICE	BID ESTIMATE
1	066102	DUST ABATEMENT	LS	1	2,500.00	2,500.00	3,000.00	3,000.00
2	074020	WATER POLLUTION CONTROL	LS	1	600.00	600.00	1,000.00	1,000.00
3	120100	TRAFFIC CONTROL SYSTEM [including Construction Project Funding Identification Signs]	LS	1	6,500.00	6,500.00	16,500.00	16,500.00
4	017314	MINOR CONCRETE PAVEMENT (DIP SECTION) (CRS 307)	SQFT	2,820	10.00	28,200.00	3.25	8,515.00
5	152370	RELOCATE MAILBOX	EA	10	110.00	1,100.00	200.00	2,000.00
6	152392	RELOCATE SIGN	EA	5	200.00	1,000.00	198.00	980.00
7	000093	HEADER CUT (COLD PLANE) ASPHALT CONCRETE PAVEMENT	SQYD	930	7.00	6,510.00	6.00	5,580.00
8	160101	CLEARING AND GRUBBING [including Minor Tree Trimming]	LS	1	3,000.00	3,000.00	25,000.00	25,000.00
9	160120	REMOVE TREE	EA	7	890.00	6,230.00	950.00	6,650.00
10	190101	ROADWAY EXCAVATION [including Earthwork, and Dirt Berm]	CY	1,150	66.00	75,900.00	60.00	69,000.00
11	220101	FINISHING ROADWAY	LS	1	10,000.00	10,000.00	7,000.00	7,000.00
12	260201	CLASS 2 AGGREGATE BASE [including Dip Section]	CY	1,120	28.00	29,120.00	40.00	44,800.00
13	390103	ASPHALT CONCRETE (TYPE B)	TON	820	84.00	68,880.00	74.00	60,680.00
14	394002	PLACE ASPHALT CONCRETE (MISCELLANEOUS AREA) [Aprons, Walkway Transitions, Pads, Pad Transitions, Miscellaneous Transitions, Dikes, and Dike Transitions]	LS	1	17,000.00	17,000.00	8,500.00	8,500.00
15	510501	MINOR CONCRETE [Concrete Collar- RCFC & WCD STD. DWG. 803]	EA	2	3,000.00	6,000.00	580.00	1,160.00
16	518201	MASONRY BLOCK WALL [Remove and Reconstruct]	LF	80	103.00	8,240.00	95.00	7,600.00
17	850018	18" REINFORCED CONCRETE PIPE [D 2000]	LF	182	106.00	20,352.00	155.00	29,750.00
18	-	DELETED BY ADDENDUM	-	-	0.00	0.00	0.00	0.00
19	720000	ROCK SLOPE PROTECTION (Facing- Method B) [Swale, Rip Rap, Fabric]	LS	1	7,500.00	7,500.00	2,600.00	2,600.00
20	017304	MINOR CONCRETE (CURB AND GUTTER) (CRS 200)	LF	1,140	22.00	25,080.00	21.00	23,940.00
21	017310	MINOR CONCRETE (DRIVEWAY APPROACH) (CRS 207)	EA	7	800.00	5,600.00	2,000.00	14,000.00
22	731521	MINOR CONCRETE (SIDEWALK) (CRS 401)	SQFT	6,400	4.00	25,600.00	3.20	20,480.00
23	017315	MINOR CONCRETE (CURB RAMP) (CRS 403 - CASE A)	EA	3	1,500.00	4,500.00	2,900.00	8,700.00
24	017316	MINOR CONCRETE (CURB RAMP) (CRS 403 - CASE B)	EA	1	1,700.00	1,700.00	2,900.00	2,900.00
25	869040	PULL BOX [Remove and Replace]	EA	3	400.00	1,200.00	550.00	1,650.00
26	999990	MOBILIZATION	LS	1	3,000.00	3,000.00	5,000.00	5,000.00
27	860811	DETECTOR LOOP [Install and stub outs (Type E)]	EA	8	25.00	200.00	450.00	3,600.00
28	152379	RELOCATE FENCE	LF	50	24.00	1,200.00	45.00	2,250.00
29	017305	MINOR CONCRETE (CURB AND GUTTER) (CRS 201)	LF	70	22.00	1,540.00	21.00	1,470.00
30	017007	CONCRETE DROP INLET [RCFC & WCD DWG. CB 110]	EA	1	6,000.00	6,000.00	7,000.00	7,000.00
31	000003	SLURRY BACKFILL	CY	30	198.00	5,940.00	135.00	4,050.00
32	840856	PAINT TRAFFIC STRIPE (2 COAT)	LF	820	1.20	984.00	1.20	984.00
33	840866	PAINT PAVEMENT MARKING (2 COAT)	SQFT	30	15.00	450.00	6.00	180.00
ITEMS 1-33						379,626.00		396,539.00