

**SUBMITTAL TO THE BOARD OF SUPERVISORS  
COUNTY OF RIVERSIDE, STATE OF CALIFORNIA**

317A



**FROM:** TLMA - Transportation Dept.

**SUBMITTAL DATE:**  
May 12, 2008

**SUBJECT:** Landscaping and Lighting Maintenance District No. 89-1-Consolidated,  
Annexation of Zone 112 (Woodcrest).

**RECOMMENDED MOTION:** That the Board adopt the following Resolutions:

Resolution No. 2008-222 a Resolution of the County of Riverside initiating proceedings for the annexation of Zone 112 to Landscaping and Lighting Maintenance District No. 89-1-Consolidated and ordering preparation of the Engineer's Report regarding the proposed annexation of Zone 112.

Resolution No. 2008-223, a Resolution of the County of Riverside declaring its intent to order the annexation of Zone 112 to Landscaping and Lighting Maintenance District No. 89-1-Consolidated of the County of Riverside pursuant to the Landscaping and Lighting Act of

Juan C. Perez  
Director of Transportation

JAW:jp

<b>FINANCIAL DATA</b>	Current F.Y. Total Cost:	\$0	In Current Year Budget:	N/A
	Current F.Y. Net County Cost:	\$0	Budget Adjustment:	N/A
	Annual Net County Cost:	\$0	For Fiscal Year:	2007-08

<b>SOURCE OF FUNDS:</b> Landscaping and Lighting Maintenance District No. 89-1-Consolidated – 100%	<b>Positions To Be Deleted Per A-30</b>	<input type="checkbox"/>
	<b>Requires 4/5 Vote</b>	<input type="checkbox"/>

**C.E.O. RECOMMENDATION:**

APPROVE

BY:   
Tina Grande

County Executive Office Signature

FORM APPROVED COUNTY COUNSEL  
BY: DALE A. GARDNER  
DATE: 4/23/08  
Departmental Concurrence

Policy  
 Policy  
 Consent  
 Consent  
 Dept't Recomm.:  
 Per Exec. Ofc.:

Prev. Agn. Ref. | District: 1 | Agenda Number:

3.50 226

The Honorable Board of Supervisors

RE: Landscaping and Lighting Maintenance District No. 89-1-Consolidated, Annexation of Zone 112 (Woodcrest).

May 12, 2008

Page 2 of 2

1972 for the maintenance and servicing of landscaping, multi-purpose trails, and fencing, and graffiti abatement; adopting the preliminary engineer's report; giving notice of and setting the time and place of the public hearing on the annexation of Zone 112, ordering a mailed ballot election; and directing notice of the public hearing and ballot be mailed pursuant to Article XIID of the California Constitution.

**BACKGROUND:** Adoption of Resolution No. 2008-222 appoints the Director of the Transportation Department as the Engineer to prepare a Report regarding the proposed annexation of Zone 112 to Landscaping and Lighting Maintenance District No. 89-1-Consolidated ("L&LMD No. 89-1-C").

Resolution No. 2008-223 declares the Board's intention of ordering the annexation of Zone 112 to L&LMD No. 89-1-C. Annexation of Zone 112 to L&LMD No. 89-1-C will fund the maintenance and servicing of landscaping, multi-purpose trails, and fencing, and graffiti abatement within public right-of-way located southerly of Mariposa Ave and northeasterly of Mockingbird Canyon Rd in the Woodcrest area and includes 131 single-family residential lots.

The proposed budget for fiscal year 2008-09 for Zone 112 is \$46,844.00 that will result in an assessment for fiscal year 2008-09 within Zone 112 of \$357.58 per parcel. The annual assessment will be adjusted annually by the greater of 2% or the cumulative percentage increase in the CPI-U, if any, as it stands as of March of each year over the base index for March of 2008.

Consistent with the Board's direction regarding compliance with Article XIID of the California Constitution and the Landscaping and Lighting Act of 1972, the attached resolutions have been prepared and a public hearing scheduled for 9:30 a.m. on July 15, 2008 to receive testimony for and against the proposed assessment. Each property owner within the proposed Zone 112 will receive a notice of the public hearing and mail-in ballot, an impartial analysis, a copy of Resolution No. 2008-223, and an information sheet.

Ballots must be returned prior to the conclusion of the public hearing. If, at the time designated for the tabulation of the ballots, the ballots submitted in favor of the annexation and levy of the assessment exceed the ballots submitted in opposition of said annexation and levy, Zone 112 will be annexed to L&LMD No. 89-1-C.

The individuals/entities, which own all of the property within the proposed boundaries of Zone 112, have executed a "Waiver and Consent Regarding Date of Assessment Ballot Election" allowing for the election and public hearing to be held on July 15, 2008.

2 **RESOLUTION NO. 2008-222**

3 **RESOLUTION OF THE BOARD OF SUPERVISORS OF THE COUNTY OF RIVERSIDE INITIATING**  
4 **PROCEEDINGS FOR THE ANNEXATION OF ZONE 112 TO LANDSCAPING AND LIGHTING**  
5 **MAINTENANCE DISTRICT NO. 89-1-CONSOLIDATED OF THE COUNTY OF RIVERSIDE**  
6 **PURSUANT TO THE LANDSCAPING AND LIGHTING ACT OF 1972 AND ORDERING**  
7 **PREPARATION OF ENGINEER'S REPORT REGARDING SAID ANNEXATION**

8 **WHEREAS**, the Board of Supervisors (hereinafter the "Board of Supervisors") of the County of  
9 Riverside (hereinafter the "County") has been advised by the Transportation Department (hereinafter  
10 "Department") of the County that said Department has received an application from the owner (the  
11 "Applicant") of all the property within the unincorporated area of the County (hereinafter "Zone 112"),  
12 as shown and described in Exhibit "A", which is attached hereto and made a part hereof, to be  
13 annexed to Landscaping and Lighting Maintenance District No. 89-1-Consolidated (hereinafter  
14 "L&LMD No. 89-1-C") of the County of Riverside, State of California, and the Board of Supervisors has  
15 determined that it is necessary and desirable to initiate proceedings for the annexation of Zone 112 to  
16 L&LMD No. 89-1-C pursuant to the Landscaping and Lighting Act of 1972, Part 2 (commencing with  
17 Section 22500) of Division 15 of the Streets and Highways Code (hereinafter, respectively, the "Act"  
18 and the "Street and Highways Code"); and

19 **WHEREAS**, such proceedings shall comply with the requirements of Article XIID of the  
20 California Constitution and Section 4000 of the Elections Code requiring voter approval of the  
21 proposed assessment to be levied by L&LMD No. 89-1-C for Zone 112; and

22 **WHEREAS**, the Applicants have executed a "Waiver and Consent Regarding Date of  
23 Assessment Ballot Election" allowing for the election to be held on July 15, 2008; and

24 **WHEREAS**, the Director of the Department, or his designee, is a licensed and registered civil  
25 engineer, has expertise with respect to the annexation of territory to landscaping and lighting  
26 maintenance districts and the levying of assessments for said purposes and, therefore, is able to serve

1 as the engineer (hereinafter the "Engineer") for the County with regard to the annexation of Zone 112  
2 to L&LMD No. 89-1-C.

3 **NOW, THEREFORE, BE IT RESOLVED, FOUND, DETERMINED AND ORDERED** by the  
4 Board of Supervisors of the County of Riverside assembled in regular session on May 20, 2008 as  
5 follows:

6 **Section 1. Recitals.** The Board of Supervisors hereby finds and determines that all  
7 the above recitals are true and correct.

8 **Section 2. Annexation.** The Board of Supervisors proposes to annex Zone 112 to  
9 L&LMD No. 89-1-C and to initiate and conduct proceedings therefore pursuant to the Act for the  
10 purpose of levying an annual assessment on all parcels within Zone 112 to pay the costs of the  
11 following services:

- 12 (a) The maintenance and servicing of landscaping and multi-purpose trails within  
13 the public right-of-way including the trimming, fertilizing, weeding and replanting  
14 of trees, shrubs, grass, and other ornamental vegetation; and
- 15 (b) The maintenance and servicing of irrigation and electrical facilities associated  
16 with the landscaping, including but not limited to electricity for operation of the  
17 irrigation system and water for irrigation; and
- 18 (c) Providing graffiti abatement services to walls and structures with the public right-  
19 of-way including incidental costs and expenses.

20 **Section 3. Boundaries and Designation.** The boundaries of Zone 112 that are  
21 proposed to be annexed to L&LMD No. 89-1-C shall include all of the property as shown and  
22 described in Exhibit "A".

23 **Section 4. Report.** The Director of the Department of the County, or his designee,  
24 is hereby designated Engineer and is ordered to prepare and file a report with the Clerk of the Board  
25 of Supervisors in accordance with Sections 22608 and 22585 et. seq. of the Streets and Highways  
26

1 Code and Section 4 of Article XIID of the California Constitution regarding said annexation and the  
2 levy.

3 **Section 5. Effective Date.** This Resolution shall take effect from and after its date  
4 of adoption.

10  
11  
12  
13 FORM APPROVED COUNTY COUNSEL  
14 BY: DALE A. GARDNER 4/30/08  
DATE

**EXHIBIT "A"**

**DESCRIPTION OF BOUNDARIES**

The boundaries of Zone 112 to be annexed into Landscaping and Lighting Maintenance District No. 89-1-Consolidated, of the County of Riverside are coterminous with the boundaries of lots 1 through 21 as shown on Tract Map No. 22100, of lots 1 through 59 as shown on Tract Map No. 22100-2, and of lots 1 through 51 as shown on Tract Map No. 22100-3 in the County of Riverside, State of California for fiscal year 2008-09.

1  
2  
3  
4  
5  
6  
7  
8  
9  
10  
11  
12  
13  
14  
15  
16  
17  
18  
19  
20  
21  
22  
23  
24

# LANDSCAPING AND LIGHTING MAINTENANCE DISTRICT NO. 89-1-CONSOLIDATED

## ZONE 112

PORTION OF SECTIONS 26 & 35, T.3S., R.5W.

TRACT MAP NOS. 22100, 22100-2, & 22100-3

131 PARCELS

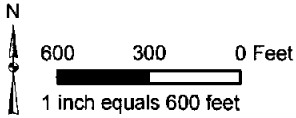



The County of Riverside assumes no warranty or legal responsibility for the information contained on this map. Data and information represented on this map is subject to updates, modifications and may not be complete or appropriate for all purposes. County GIS and other sources should be queried for the most current information. Do not copy or reuse this map.

Printed by jpickeri on 4/4/08

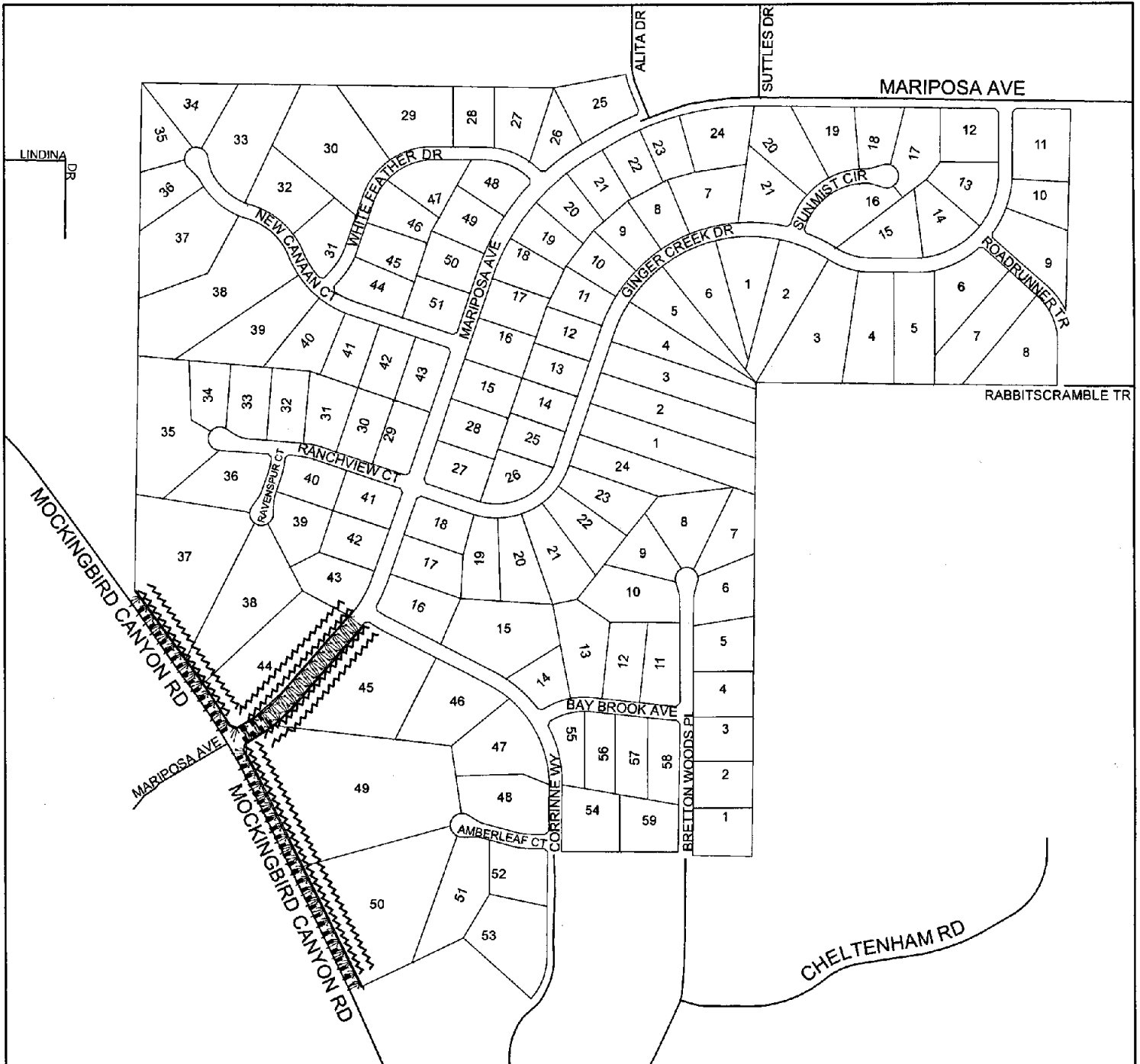
### ASSESSMENT DIAGRAM



-  DENOTES LANDSCAPED AND MAINTAINED PARKWAY
-  DENOTES MAINTAINED MULTI-PURPOSE TRAIL AND FENCE
-  DENOTES MAINTAINED GRAFFITI ABATEMENT

**RESOLUTION NO. 2008-223**

**RESOLUTION OF THE BOARD OF SUPERVISORS OF THE COUNTY OF RIVERSIDE DECLARING ITS INTENT TO ORDER THE ANNEXATION OF ZONE 112 TO LANDSCAPING AND LIGHTING MAINTENANCE DISTRICT NO. 89-1-CONSOLIDATED OF THE COUNTY OF RIVERSIDE PURSUANT TO THE LANDSCAPING AND LIGHTING ACT OF 1972 FOR THE MAINTENANCE AND SERVICING OF LANDSCAPING, MULTI-PURPOSE TRAILS, AND FENCING, AND GRAFFITI ABATEMENT; ADOPTING THE PRELIMINARY ENGINEER'S REPORT; GIVING NOTICE OF AND SETTING THE TIME AND PLACE OF THE PUBLIC HEARING ON THE ANNEXATION OF ZONE 112; ORDERING AN ASSESSMENT PROCEEDING; ORDERING A MAILED BALLOT ELECTION; AND DIRECTING NOTICE OF THE PUBLIC HEARING AND THE ASSESSMENT BALLOT TO BE MAILED PURSUANT TO ARTICLE XIID OF THE CALIFORNIA CONSTITUTION AND SECTION 4000 OF THE ELECTIONS CODE**

**WHEREAS**, the Board of Supervisors (hereinafter the "Board of Supervisors") of the County of Riverside (hereinafter the "County") has adopted Resolution No. 2008-222 on May 20, 2008 initiating proceedings for the annexation of Zone 112 (hereinafter "Zone 112"), as described and shown in Exhibit "A", which is attached hereto and incorporated herein, to Landscaping and Lighting Maintenance District No.89-1-Consolidated of the County of Riverside, State of California, (hereinafter "L&LMD No. 89-1-C") pursuant to the Landscaping and Lighting Act of 1972 (hereinafter the "Act"), which is Part 2 (commencing with Section 22500) of Division 15 of the Streets and Highways Code (hereinafter the "Street and Highways Code"), and ordering the preparation of a report (hereinafter the "Report") regarding the proposed annexation of Zone 112 and the assessments to be levied within Zone 112 each fiscal year beginning fiscal year 2008-09 for the the maintenance and servicing of landscaping, multi-purpose trails, and fencing, and graffiti abatement within the public right-of-way within said Zone; and

**WHEREAS**, such proceedings shall comply with the requirements of Article XIID of the California Constitution (hereinafter "Article XIID:."), the Act, and Section 4000 of the Elections Code requiring voter approval of the proposed assessment to be levied by L&LMD No. 89-1-C for Zone 112; and

b

1           **WHEREAS**, the Board of Supervisors by Resolution No. 2008-222 directed the Director of the  
2 Transportation Department, or his designee (hereinafter the "Engineer"), to prepare and file the Report  
3 with the Clerk of the Board of Supervisors in accordance with Sections 22608 and 22585 et. seq. of the  
4 Street and Highways Code and Section 4 of Article XIID; and

5           **WHEREAS**, said Engineer has filed the Report with the Clerk of the Board of Supervisors and  
6 the Report has been presented to and considered by the Board of Supervisors; and

7           **WHEREAS**, the Applicants have executed a "Waiver and Consent Regarding Date of  
8 Assessment Ballot Election" allowing for the election to be held on July 15, 2008; and

9           **WHEREAS**, it is necessary that the Board of Supervisors adopt a resolution of intention  
10 pursuant to Section 22624 of the Streets and Highways Code, which fixes and gives notice, pursuant to  
11 Section 22626 of the Streets and Highways Code, of the time and place of a public hearing on said  
12 Report, the annexation of Zone 112, and the assessments to be levied on parcels within Zone 112  
13 beginning in fiscal year 2008-09;

14           **NOW, THEREFORE, BE IT RESOLVED, FOUND, DETERMINED AND ORDERED** by the  
15 Board of Supervisors in regular session assembled on May 20, 2008 as follows:

16           **Section 1.    Findings.** The Board of Supervisors, after reviewing the Report, finds that:

- 17           (a)    The foregoing recitals are true and correct;
- 18           (b)    The Report contains all matters required by Sections 22565 through 22574 of the  
19               Streets and Highways Code and Section 4 of Article XIID and may, therefore, be  
20               approved by the Board of Supervisors;
- 21           (c)    The annual assessment for fiscal year 2008-09 on all parcels within Zone 112 proposed  
22               to be annexed to L&LMD No. 89-1-C will be \$357.58 per parcel.

23           **Section 2.    Intent.** The Board of Supervisors hereby declares its intention to order the  
24 annexation of Zone 112, as described and shown in Exhibit "A", to L&LMD No. 89-1-C, and to levy and  
25 collect an annual assessment on all assessable lots and parcels of property within Zone 112  
26 commencing with the fiscal year 2008-09 as set forth in the Report. The Report expressly states that

1 there are no parcels or lots within Zone 112 that are owned by a federal, state or other local  
2 governmental agency that will benefit from the services to be financed by the annual assessments. The  
3 annual assessments will be collected at the same time and in the same manner as property taxes are  
4 collected, and all laws providing for the collection and enforcement of property taxes shall apply to the  
5 collection and enforcement of said assessments.

6 **Section 3. Boundaries.** All the property within boundaries of Zone 112 is proposed to be  
7 annexed into L&LMD No. 89-1-C and shall include that property in the unincorporated area of the  
8 County as described and shown in Exhibit "A".

9 **Section 4. Description of Services to be Provided.** The maintenance and servicing of  
10 landscaping, multi-purpose trails, and fencing, and graffiti abatement authorized for Zone 112 of  
11 L&LMD No. 89-1-C are:

- 12 (a) The maintenance and servicing of landscaping and multi-purpose trails within the public  
13 right-of-way including the trimming, fertilizing, weeding and replanting of trees, shrubs,  
14 grass, and other ornamental vegetation; and
- 15 (b) The maintenance and servicing of irrigation and electrical facilities associated with the  
16 landscaping, including but not limited to electricity for operation of the irrigation system  
17 and water for irrigation; and
- 18 (c) Providing graffiti abatement services to walls and structures with the public right-of-way  
19 including incidental costs and expenses.

20 **Section 5. Amount to be Levied.** The assessment to be levied upon each parcel that  
21 benefits from the annexation of Zone 112 of L&LMD No. 89-1-C will be \$357.58 per parcel for fiscal  
22 year 2008-09. As stated in the Report, the total budget for Zone 112 for the fiscal year 2008-09 is  
23 \$46,844.00; there are 131 parcels that are to be assessed. The annual assessment will be increased  
24 by the greater of two percent (2.0%) or the cumulative percentage increase, if any, in the Consumer  
25 Price Index for all Urban Consumers ("CPI-U") for the Los Angeles-Riverside-Orange County California  
26 Standard Metropolitan Statistical area ("Index") published by the Bureau of Labor Statistics of the

1 United States Department of Labor. The annual CPI-U adjustment will be based on the cumulative  
2 increase, if any, in the Index as it stands on March of each year over the base Index for March of 2008.  
3 Any increase larger than the greater of 2.0% or the CPI-U annual adjustment requires a majority  
4 approval of all the property owners within Zone 112. The Board of Supervisors will levy the assessment  
5 in each subsequent fiscal year until the Board of Supervisors undertakes proceedings for the  
6 dissolution of Zone 112 of L&LMD No. 89-1-C. The annual assessment will fund the services described  
7 in Section 4 of this Resolution. For further particulars, reference is to be made to the Report on file in  
8 the Office of the Clerk of the Board of Supervisors.

9 **Section 6. The Property to be Annexed.** The property to be annexed into L&LMD No.  
10 89-1-C is Zone 112. The boundaries of Zone 112 are located within the unincorporated area of the  
11 County and are described and shown in the Report and Exhibit "A".

12 **Section 7. Report.** The Report, which is on file with the Clerk of the Board of Supervisors  
13 and which has been presented to the Board of Supervisors, is hereby approved. Reference is made to  
14 the Report for a full and detailed description of the services, the boundaries of Zone 112, and the  
15 annual assessment to be levied upon assessable lots and parcels within Zone 112 proposed to be  
16 annexed to L&LMD No. 89-1-C.

17 **Section 8. Public Hearing.** The question of whether Zone 112 shall be annexed into  
18 L&LMD No. 89-1-C and an annual assessment levied beginning with fiscal year 2008-09 shall be  
19 considered at a public hearing (hereinafter the "Public Hearing") to be held on July 15, 2008, at 9:30  
20 a.m. at the meeting room of the Board of Supervisors of the County at 4080 Lemon Street, 1<sup>st</sup> Floor,  
21 Riverside, California.

22 **Section 9. Majority Protest.** Each owner of record of property within Zone 112 is to receive  
23 by mail an assessment ballot that shall conform to the requirements of Section 4 of Article XIID and  
24 Section 4000 of the California Elections Code. The assessment ballots are to be returned prior to the  
25 Public Hearing. L&LMD No. 89-1-C shall not impose assessments on property within the boundaries of  
26 Zone 112 if there is a majority protest with regard to the annexation of Zone 112. A majority protest

1 exists if, upon the conclusion of the Public Hearing, the tabulation of the assessment ballots submitted  
2 in opposition to the annexation and assessment of Zone 112 exceeds the assessment ballots in favor  
3 of the annexation and assessment of Zone 112.

4 **Section 10. Information.** Any property owner desiring additional information regarding  
5 Zone 112 of L&LMD No. 89-1-C, the Report, or the proposed assessment is to contact Ms. Judy A.  
6 Watterlond, Technical Engineering Unit Supervisor, Transportation Department of the County of  
7 Riverside, 4080 Lemon Street, 8th Floor, Riverside, California, 92501 or by telephone at  
8 (951) 955-6829.

9 **Section 11. Notice of the Public Hearing.** Notice of Public Hearing with regard to the  
10 annexation of Zone 112 to L&LMD No. 89-1-C shall be given consistent with Section 22626 of the  
11 Streets and Highways Code and Section 4 of Article XIID. The Clerk of the Board of Supervisors shall  
12 give notice of the Public Hearing by causing a certified copy of this Resolution to be published once in  
13 *The Press Enterprise* at least ten (10) days prior to the date of the Public Hearing that is July 15, 2008.  
14 Publication of this Resolution is to be effected by the Clerk of the Board of Supervisors. Notice shall  
15 also be given by mailing first-class, postage prepaid, those notices, as prepared by County Counsel,  
16 assessment ballot and information sheets as required by Section 4 of Article XIID and Section 4000 of  
17 the California Elections Code to all owners of record of property within Zone 112 as shown on the last  
18 equalized assessment roll of the County. Mailing is to be made by the Engineer and deposited with the  
19 U. S. Post Office at least forty-five (45) days prior to the Public Hearing on July 15, 2008.

20 **Section 12. Effective Date.** This Resolution shall take effect from and after its date of  
21 adoption.

22  
23  
24 FORM APPROVED COUNTY COUNSEL  
BY DALE A. GARDNER 4/30/08  
DATE

**EXHIBIT "A"**

**DESCRIPTION OF BOUNDARIES**

The boundaries of Zone 112 to be annexed into Landscaping and Lighting Maintenance District No. 89-1-Consolidated, of the County of Riverside are coterminous with the boundaries of lots 1 through 21 as shown on Tract Map No. 22100, of lots 1 through 59 as shown on Tract Map No. 22100-2, and of lots 1 through 51 as shown on Tract Map No. 22100-3 in the County of Riverside, State of California for fiscal year 2008-09.

1  
2  
3  
4  
5  
6  
7  
8  
9  
10  
11  
12  
13  
14  
15  
16  
17  
18  
19  
20  
21  
22  
23  
24

LANDSCAPING AND LIGHTING MAINTENANCE DISTRICT NO. 89-1-CONSOLIDATED

**ZONE 112**

PORTION OF SECTIONS 26 & 35, T.3S., R.5W.

TRACT MAP NOS. 22100, 22100-2, & 22100-3

131 PARCELS



The County of Riverside assumes no warranty or legal responsibility for the information contained on this map. Data and information represented on this map is subject to updates, modifications and may not be complete or appropriate for all purposes. County GIS and other sources should be queried for the most current information. Do not copy or resell this map.

Printed by jpickeri on 4/4/08

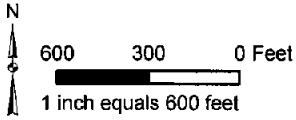

**ASSESSMENT DIAGRAM**

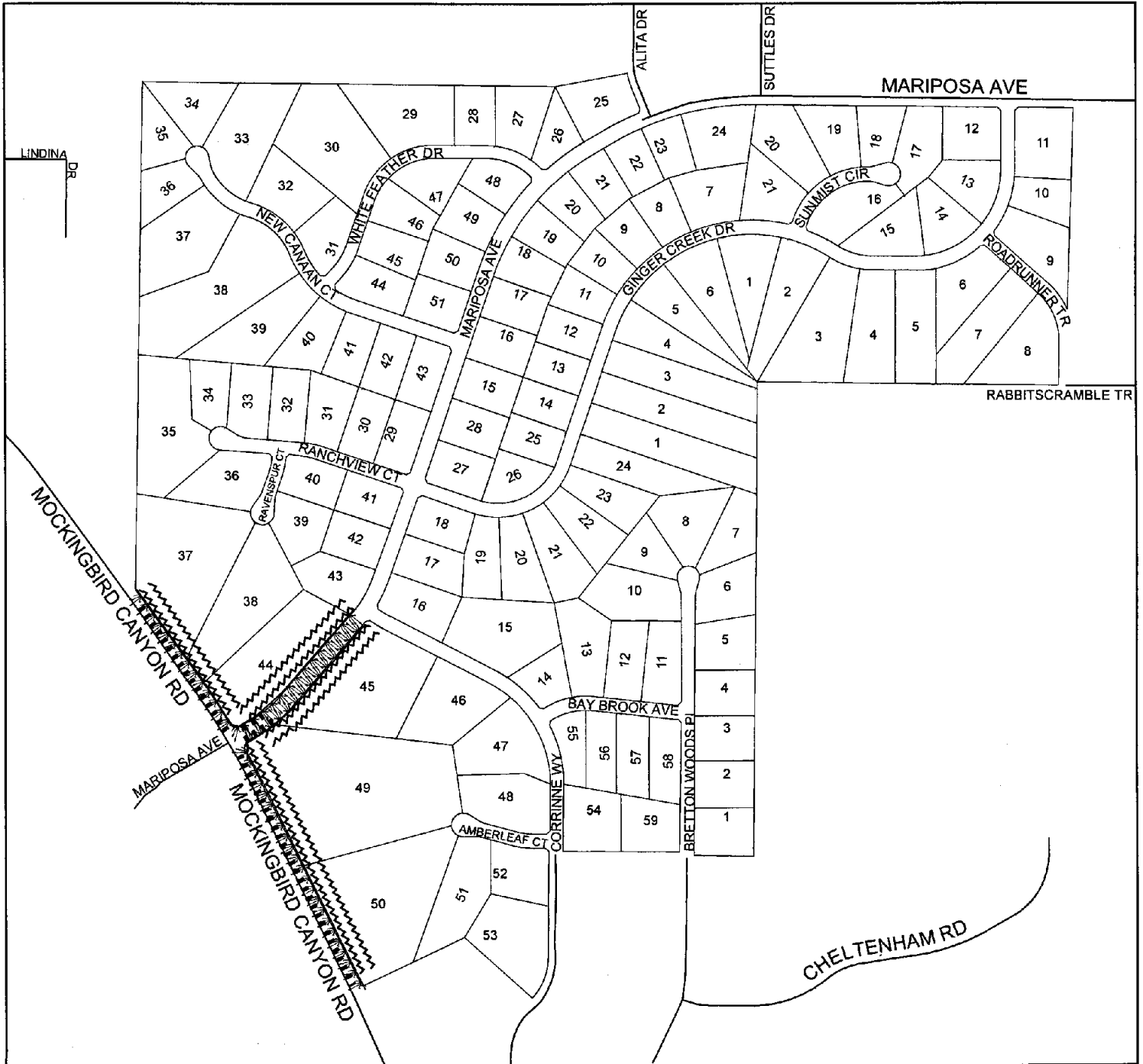

DENOTES LANDSCAPED AND MAINTAINED PARKWAY

DENOTES MAINTAINED MULTI-PURPOSE TRAIL AND FENCE

DENOTES MAINTAINED GRAFFITI ABATEMENT