

**SUBMITTAL TO THE BOARD OF SUPERVISORS
COUNTY OF RIVERSIDE, STATE OF CALIFORNIA**

315 B



FROM: TLMA – Transportation Department

SUBMITTAL DATE:
July 7, 2008

SUBJECT: Ordinance No. 452.224 to establish speed zones enforceable by radar speed detection equipment – Temescal Canyon, Hemet, Menifee, Sun City, Temecula, Murrieta and Desert Hot Springs areas.

RECOMMENDED MOTION: That the Board introduce Ordinance No. 452.224, amending Ordinance No. 452 relating to prima facie speed limits to establish various speed zones in the above-referenced areas of Riverside County.

BACKGROUND: Transportation Department staff has conducted Engineering and Traffic Surveys (E&TS) for various roads in the subject areas, as required by the California Vehicle Code.

Based upon the results of the E&TS for these roads, the radar-enforceable speed limits recommended by the Department are summarized in the attached tables.

It is recommended that the Board adopt this amendment at the next regularly scheduled meeting.

County Counsel has approved the ordinance amendment.

Transportation Department staff has contacted the Riverside, San Geronio Pass, Temecula and Indio offices of the California Highway Patrol regarding the proposed speed zones.

Juan C. Perez
Director of Transportation

LTT:bjl

REVIEWED BY EXECUTIVE OFFICE

DATE 9/10/08 mmg
Tina Grande
Departmental Concurrence

FORM APPROVED COUNTY COUNSEL
BY: Joe S. Rank 8/4/08
DATE
JOE S. RANK
Departmental Concurrence

Policy
 Policy

Consent
 Consent

Dept's Recomm.:
Per Exec. Ofc.:

Prev. Agn. Ref. 10/17/06, Item 3.55 | District: 1, 3, 5 | Agenda Number:

3.141

1 amended to add a new subsection 14. thereto to read as follows:

2 "14. On Domenigoni Parkway from Menifee Road to a point approximately 1,900
3 feet west of Leon Road, a total distance of approximately 2.31 miles, in the
4 Hemet area."

5 Section 5. Subsection 7. of Section 2.7 of Ordinance No. 452 adopted on February 4,
6 2003, pursuant to Ordinance No. 452.214 is repealed in its entirety. Subsection 7. of Section 2.7 established
7 a fifty-five miles per hour speed limit on Newport Road between Murrieta Road and I-215.

8 Section 6. This ordinance shall take effect 30 days after its adoption.

9
10 BOARD OF SUPERVISORS OF THE COUNTY
11 OF RIVERSIDE, STATE OF CALIFORNIA

12 BY _____

13 Chairman

14
15 ATTEST:

16 CLERK OF THE BOARD:

17
18 By: _____

19 Deputy

20
21 APPROVED AS TO FORM:

22 June 23, 2008

23
24 By: Katherine A. Lind
25 KATHERINE A. LIND
Principal Deputy County Counsel

26
27 KAL:mdk
06/23/08

28 G:\Property\KLIND\Ordinances\Ord. 452.224 Prima Facie Speed Limits.doc

**LIST OF SPEED ZONE SUBMITTALS
SUPERVISORIAL DISTRICT NO. 1**

AREA	ROAD NAME/ LIMITS	EXISTING SPEED LIMIT	PROPOSED SPEED LIMIT	NOTES
Temescal Canyon	Squaw Mountain Road Temescal Canyon Road to Mojeska Summit Road	Not Posted*	40 mph	New speed zone

*Maximum allowable speed limit for a two-lane highway is 55 mph

**LIST OF SPEED ZONE SUBMITTALS
SUPERVISORIAL DISTRICT NO. 3**

AREA	ROAD NAME/ LIMITS	EXISTING SPEED LIMIT	PROPOSED SPEED LIMIT	NOTES
Hemet	Domenigoni Parkway Menifee Road to 1,900 feet west of Leon Road	Not Posted**	55 mph	New speed zone
Menifee	Tally Road Antelope Road to Tate Road	Not Posted*	40 mph	New speed zone
Sun City	Newport Road Murrieta Road to I-215	55 mph	50 mph	Speed survey update
Temecula	Avenida Lestonnac Butterfield Stage Road easterly to its terminus	Not Posted*	40 mph	New speed zone
Murrieta	Shrimp Lane From a point approximately 1,730 feet west of Madallena Road (cul-de-sac) to Washington Street	Not Posted*	40 mph	New speed zone

* Maximum allowable speed limit for a two-lane highway is 55 mph

**Maximum allowable speed limit for a multi-lane highway is 65 mph

**LIST OF SPEED ZONE SUBMITTALS
SUPERVISORIAL DISTRICT NO. 5**

AREA	ROAD NAME/ LIMITS	EXISTING SPEED LIMIT	PROPOSED SPEED LIMIT	NOTES
Desert Hot Springs	20 th Avenue Bubbling Wells Road to Mountain View Drive	Not Posted*	45 mph	New speed zone

* Maximum allowable speed limit for a two-lane highway is 55 mph

LEGEND:

- ////// CITY LIMITS
- ▬ RADAR ZONE
- - - SURVEY STATION
- ==== OTHER STREET OR ROAD



NO SCALE

AVENIDA LESTONNAC

(# 1438)

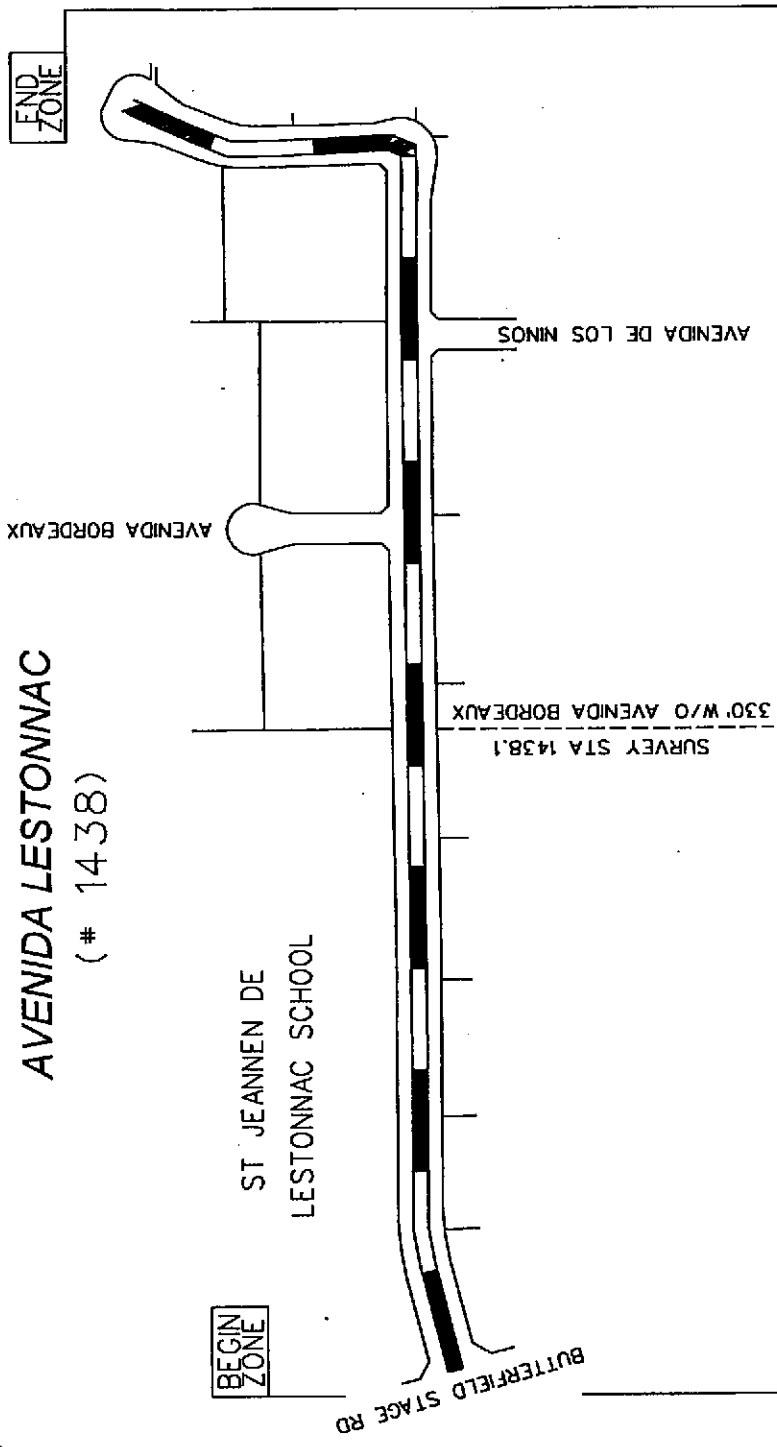

	SCOOl ZONE, SCHOOL AGE PEDESTRIANS, RESIDENTIAL AREA
RECOMMENDED SPEED LIMIT	40 MPH
PREVAILING SPEED (85%)	43.0 MPH
VEHICLES IN 24 HR (2 WAY)	1,800
SEGMENT LENGTH	1.76 MILE
ALL ACCIDENTS IN 2 YRS.	0
ACCIDENT RATE★	0.00 MVM
EXISTING SPEED LIMIT	NOT POSTED

★ RATE = $\frac{\text{ACCIDENT} \times 1,000,000}{\text{VEH} \times 365 \times 2 \times \text{MILE}}$

COUNTY AREA:	TEMECULA AREA	SURVEY DATE:	OCT 12 2006
COUNTY MAP:	129	MAP DATE:	AUG 13 2007
SUPERVISOR DISTRICT:	3	DRAWN BY:	N AHMAD
		CAD FILE:	AVENIDA.ESC.DGN

APPROVED BY: *Lawrence T. Tai*
 DATE: 8/13/2007
 LAWRENCE T. TAI, P.E.
 COUNTY TRAFFIC ENGINEER

DOMENIGONI PKWY (#1268)

- LEGEND:**
- ////// CITY LIMITS
 - ▬ RADAR ZONE
 - - - - RADAR SURVEY STATION
 - ==== OTHER STREET OR ROAD

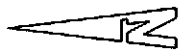

NO SCALE

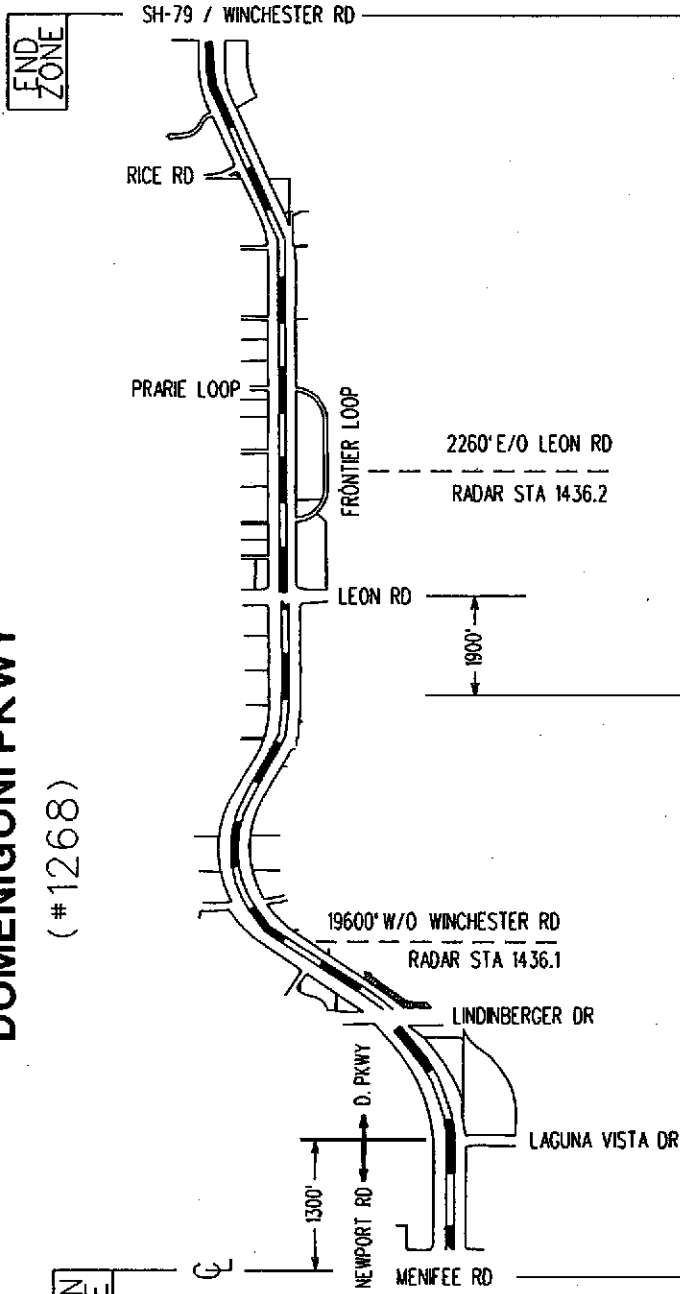

<p>*** NEW SEGMENT OPENED DEC 2006</p>	<p>TRANSITION SPEED ZONE FOR WESTERLY SEGMENT (45 MPH W/O MENIFEE RD) & EASTERLY SEGMENT (65 MPH E/O LEON RD)</p>	<p>MAX SPEED PER CVC 22349</p>
<p>RECOMMENDED SPEED LIMIT</p>	<p>55 MPH</p>	<p>65 MPH</p>
<p>PREVAILING SPEED (85%)</p>	<p>65 MPH</p>	<p>68.1 MPH</p>
<p>VEHICLES IN 24 HR (2 WAY)</p>	<p>19,400</p>	<p>15,400</p>
<p>SEGMENT LENGTH</p>	<p>2.31 MI</p>	<p>2.05 MI</p>
<p>ALL ACCIDENTS IN 2 YRS.</p>	<p>0 **</p>	<p>1 **</p>
<p>ACCIDENT RATE ☆</p>	<p>0.00 MVM</p>	<p>0.04 MVM</p>
<p>EXISTING SPEED LIMIT</p>	<p>NOT POSTED</p>	<p>NOT POSTED</p>

☆ RATE: ACCIDENT x 1,000,000
VEH x 365 x 2YR x MILE

COUNTY AREA: MENIFEE / WINCHESTER
 COUNTY MAP: 113, 114, 115, 117
 SUPERVISOR DISTRICT: 3

 COUNTY OF RIVERSIDE
 TRANSPORTATION DEPARTMENT
 TRAFFIC ENGINEERING SECTION

ENGINEERING AND TRAFFIC SURVEY
 AT
DOMENIGONI PKWY

PAGE
 2 OF 2

APPROVED BY: *Lawrence T. Tai P.E.*
 DATE: 11/27/07
 LAWRENCE T. TAI P.E.
 COUNTY TRAFFIC ENGINEER

SURVEY DATE: MAR 1, 2007
 MAP DATE: NOV 7, 2007
 DRAWN BY: N AHMAD
 CAD FILE: DOMINEGONIPKWY.DGN

LEGEND:

- ////// CITY LIMITS
- ▬ RADAR ZONE
- - - - RADAR SURVEY STATION
- ==== OTHER STREET OR ROAD

NEWPORT ROAD
(#1051)

END ZONE

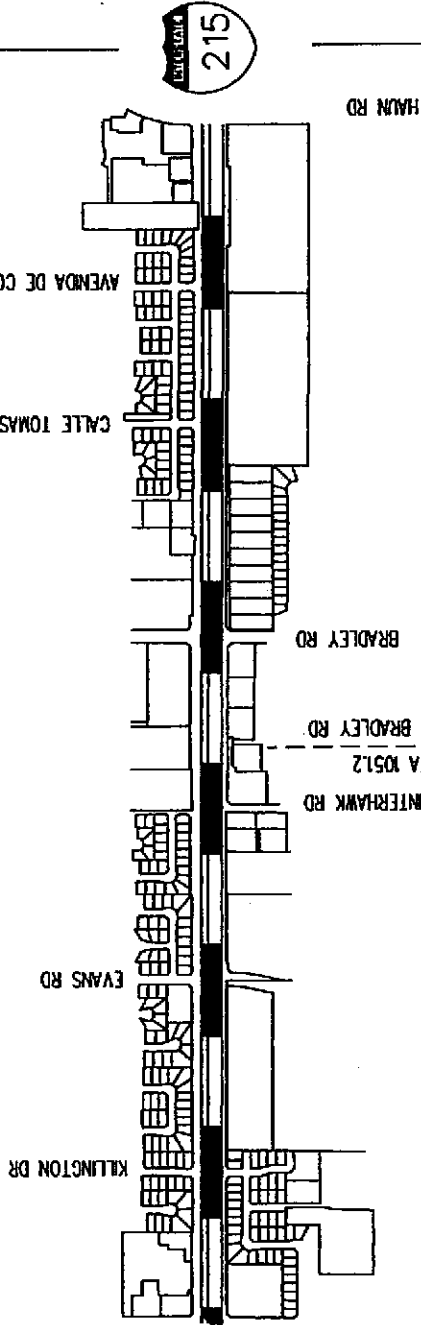

MATCHLINE
SEE SHEET 3 OF 3

MATCHLINE
SEE SHEET 1 OF 3

215

NO SCALE

BEGIN ZONE

RECOMMENDED SPEED LIMIT	50 MPH
PREVAILING SPEED (85%)	52.2 MPH
VEHICLES IN 24 HR (2 WAY)	19,200
SEGMENT LENGTH	1.98 MI
ALL ACCIDENTS IN 2 YRS.	88
ACCIDENT RATE ★	3.17 MVM
EXISTING SPEED LIMIT	55 MPH

★ RATE: $\frac{\text{ACCIDENT} \times 1000,000}{\text{VEH} \times 365 \times 2\text{YR} \times \text{MILE}}$

SURVEY DATE:	JUL 7 07	APPROVED BY:	<i>Lawrence T. Tai</i>
MAP DATE:	JUL 13 07	DRAWN BY:	N AHMAD
CAD FILE:	NEWPORT.DGN	DATE:	7/13/2007

COUNTY OF RIVERSIDE TRANSPORTATION DEPARTMENT TRAFFIC ENGINEERING SECTION	PAGE 2 OF 3
ENGINEERING AND TRAFFIC SURVEY AT NEWPORT ROAD	

COUNTY AREA: SUN CITY
COUNTY MAP: 71, 117
SUPERVISOR DISTRICT: 3

SHRIMP LANE

(# 1439)

- LEGEND:
- ////// CITY LIMITS
 - ▬ RADAR ZONE
 - - - SURVEY STATION
 - ==== OTHER STREET OR ROAD

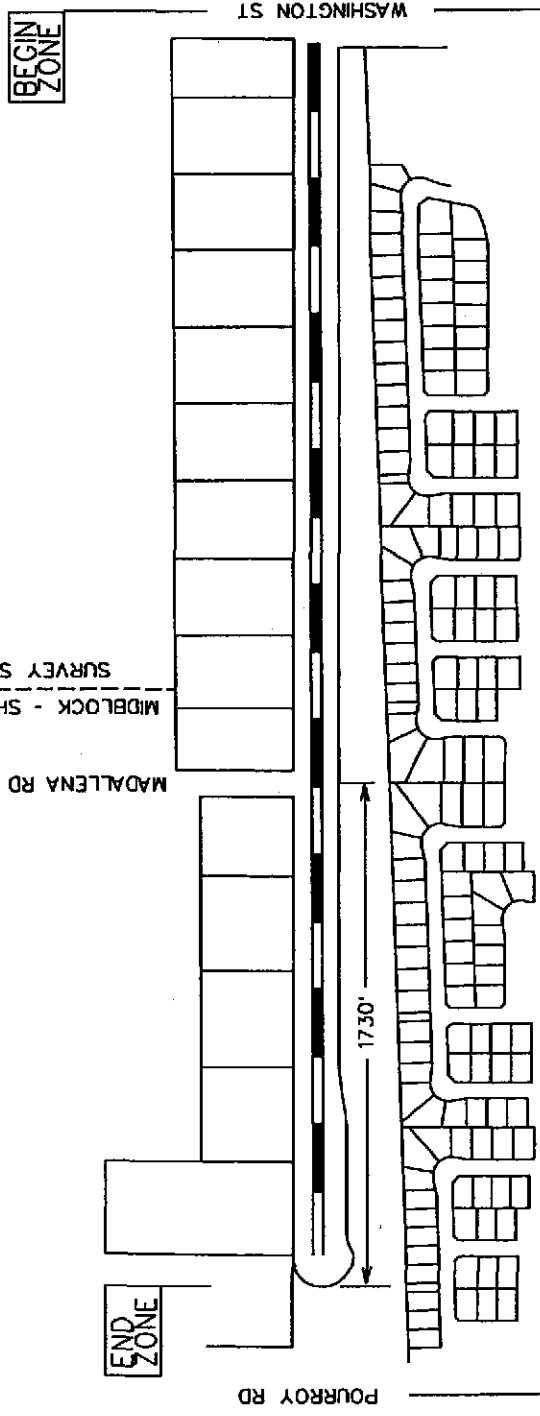

MIDDLEBLOCK - SHRIMP LANE
SURVEY STA 1439.1
MADALENA RD
POURROY RD
WASHINGTON ST

RECOMMENDED SPEED LIMIT	RESIDENTIAL AREA, EQUESTRIANS, DRIVEWAYS NOT READILY APPARENT
PREVAILING SPEED (85%)	40 MPH
VEHICLES IN 24 HR (2 WAY)	44 MPH
SEGMENT LENGTH	200
ALL ACCIDENTS IN 2 YRS.	4,350'
ACCIDENT RATE ★	0
EXISTING SPEED LIMIT	0 MVM
	NOT POSTED

★ RATE = $\frac{\text{ACCIDENT} \times 10000}{\text{VEH} \times 365 \times 2 \times \text{MILE}}$

COUNTY AREA:	MURRIETA AREA
COUNTY MAP:	125A
SUPERVISOR DISTRICT:	3
SURVEY DATE:	JUL 24 2007
MAP DATE:	AUG 13 2007
DRAWN BY:	N AHMAD
CAD FILE:	AVENIDALESC.DGN

APPROVED BY: *Lawrence T. Tai*
DATE: 8/13/2007
LAWRENCE T. TAI, P.E.
COUNTY TRAFFIC ENGINEER

SQUAW MOUNTAIN RD (#1437)

- LEGEND:**
- ////// CITY LIMITS
 - ▬ RADAR ZONE
 - - - SURVEY STATION
 - ==== OTHER STREET OR ROAD

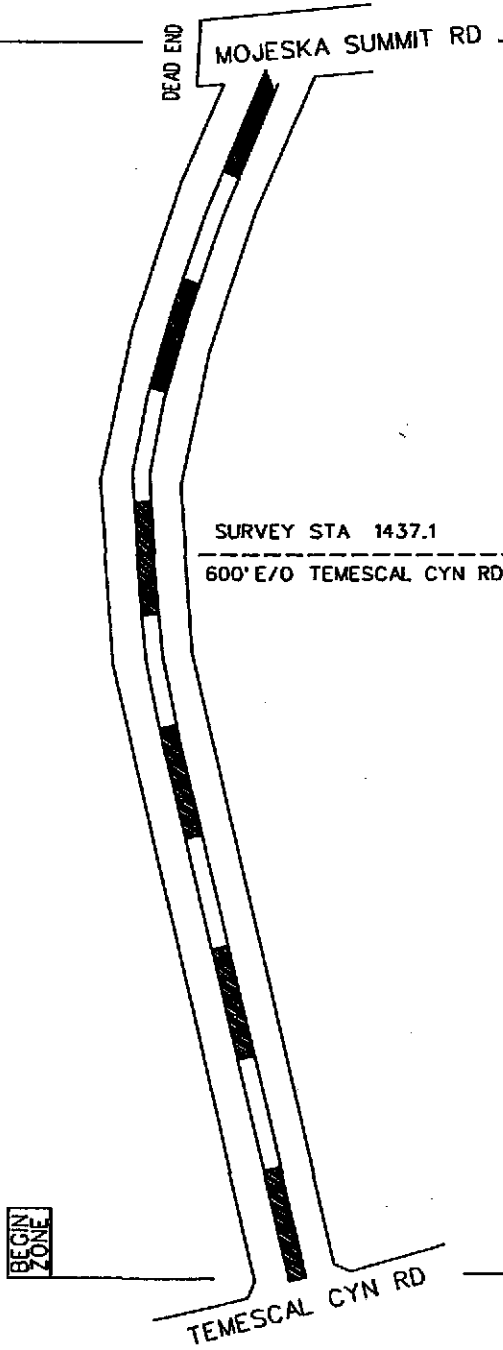

NO SCALE

RECOMMENDED SPEED LIMIT	RESIDENTIAL AREA
PREVAILING SPEED (85%)	40 MPH
VEHICLES IN 24 HR (2 WAY)	44 MPH
SEGMENT LENGTH	650
ALL ACCIDENTS IN 2 YRS.	.22 MILE
ACCIDENT RATE ★	0
EXISTING SPEED LIMIT	0.00 MVM
	NOT POSTED

★ RATE: ACCIDENT x 1,000,000
VEH x 365 x 2 x MILE

COUNTY AREA:	TEMESCAL CANYON AREA	SURVEY DATE:	JUL 10 2007	APPROVED BY:	<i>Lawrence T. Vai</i>	COUNTY OF RIVERSIDE TRANSPORTATION DEPARTMENT TRAFFIC ENGINEERING SECTION
COUNTY MAP:	33-B	MAP DATE:	JUL 10 2007	DATE:	7/13/2007	ENGINEERING AND TRAFFIC SURVEY AT
SUPERVISOR DISTRICT:	1	DRAWN BY:	N AHMAD			SQUAW MOUNTAIN RD
		CAD FILE:	SQUAW MT.DGN			PAGE 1 OF 1

TALLY ROAD

(#1443)

SURVEY STA 1443.1
75' N/O BUTLER CIR

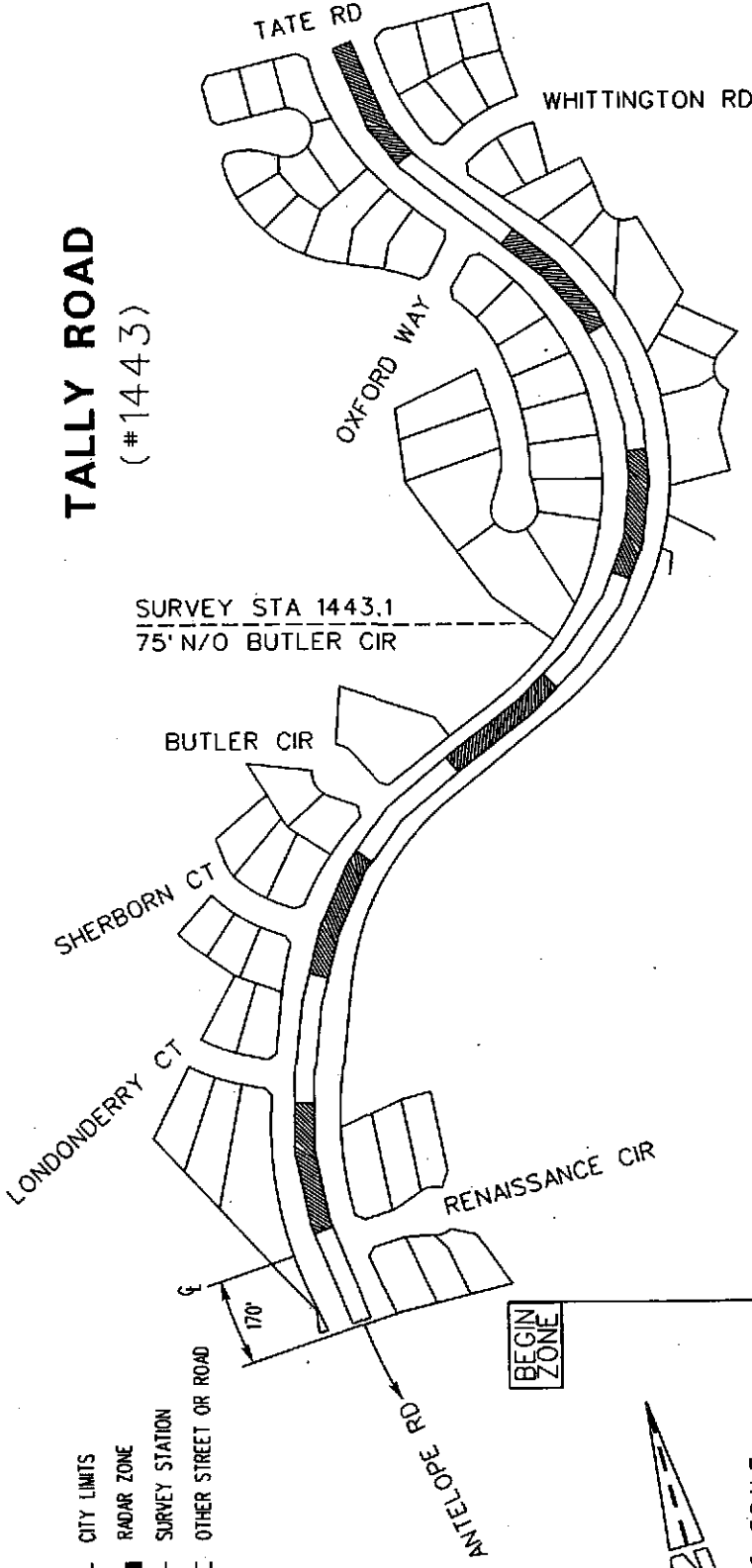

- LEGEND:
- ////// CITY LIMITS
 - ▬ RADAR ZONE
 - - - SURVEY STATION
 - OTHER STREET OR ROAD

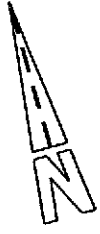

NO SCALE

RECOMMENDED SPEED LIMIT	40 MPH
PREVAILING SPEED (85%)	44.0 MPH
VEHICLES IN 24 HR (2 WAY)	3,175
SEGMENT LENGTH	.60 MI
ALL ACCIDENTS IN 2 YRS.	2
ACCIDENT RATE ☆	1.44 MVM
EXISTING SPEED LIMIT	NOT POSTED
HIDDEN DRIVEWAYS - SIGHT DISTANCE - REDUCE TO 40 MPH	

☆ RATE: ACCIDENT x 1,000,000
VEH x 365 x 2 x MILE

COUNTY AREA:	MENIFEE	SURVEY DATE:	NOV 1, 2007
COUNTY MAP:	69	MAP DATE:	NOV 27, 2007
SUPERVISOR DISTRICT:	3	DRAWN BY:	N AHMAD
		CAD FILE:	TALLY.DGN

APPROVED BY: *Lawrence T. Tal*
DATE: 11/27/07
LAWRENCE T. TAL, P.E.
COUNTY TRAFFIC ENGINEER

20TH AVENUE (# 1440)

LEGEND:

- ////// CITY LIMITS
- ▬ RADAR ZONE
- - - SURVEY STATION
- ▬▬▬ OTHER STREET OR ROAD

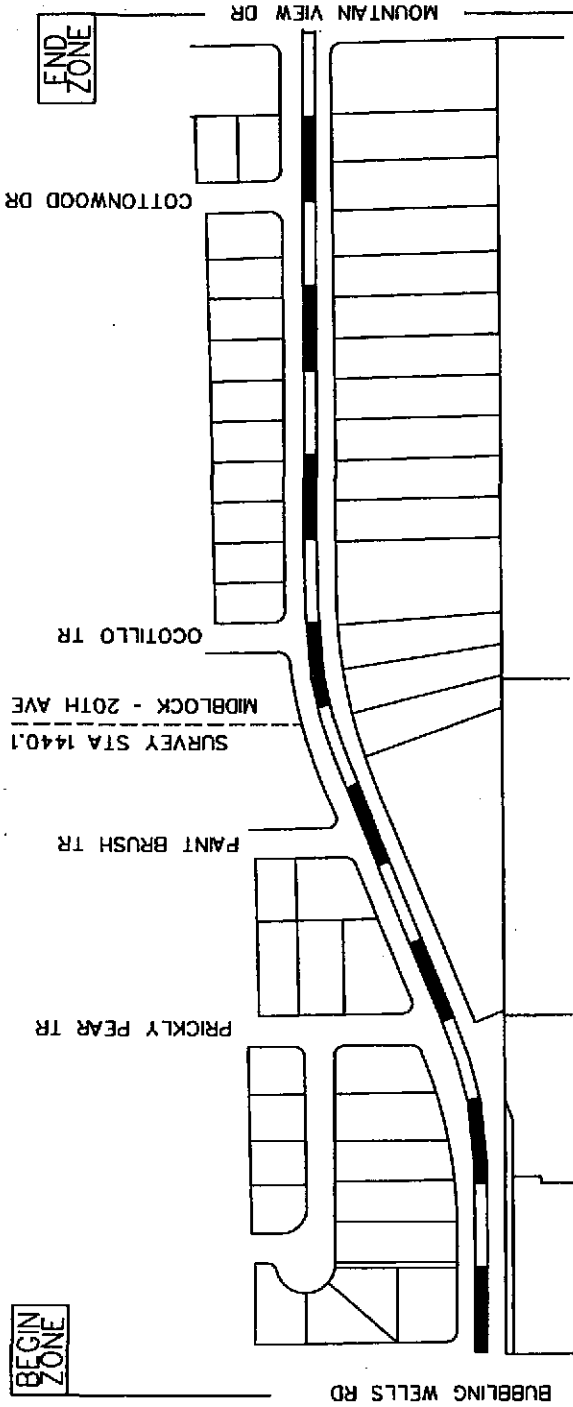

NO SCALE

HIGH ACCIDENT RATE - RESIDENTIAL AREA - SIGHT DISTANCE AT INTERSECTIONS - REDUCE TO 45MPH	45 MPH
RECOMMENDED SPEED LIMIT	48 MPH
PREVAILING SPEED (85%)	1600
VEHICLES IN 24 HR (2 WAY)	.51 MI
SEGMENT LENGTH	3
ALL ACCIDENTS IN 2 YRS.	5.04 MVM
ACCIDENT RATE ☆	NOT POSTED
EXISTING SPEED LIMIT	

☆ RATE: ACCIDENT x 1,000,000
VEH x 365 x 2 x MILE

		COUNTY OF RIVERSIDE TRANSPORTATION DEPARTMENT TRAFFIC ENGINEERING SECTION	COUNTY OF RIVERSIDE TRANSPORTATION DEPARTMENT TRAFFIC ENGINEERING SECTION
SURVEY DATE: NOV 29 2006		APPROVED BY: <i>Lawrence T. Tai</i>	ENGINEERING AND TRAFFIC SURVEY
MAP DATE: AUG 13 2007		DATE: 8/28/2007	AT 20TH AVE
DRAWN BY: N AHMAD		LAWRENCE T. TAI, P.E. COUNTY TRAFFIC ENGINEER	PAGE 1 OF 1
COUNTY AREA: DESERT HOT SPRINGS AREA	173	CAD FILE: AVENIDAESC.DGN	
COUNTY MAP:	5		
SUPERVISOR DISTRICT:			