

**SUBMITTAL TO THE BOARD OF SUPERVISORS  
COUNTY OF RIVERSIDE, STATE OF CALIFORNIA**

207B



**SUBMITTAL DATE:**  
November 7, 2008

**FROM:** TLMA - Transportation Department

**SUBJECT:** Tract 29652  
A Schedule "B" Subdivision in the Woodcrest Area  
**Extension of Time Agreements**

**RECOMMENDED MOTION:** That the Board approve the attached agreements (which grant an extension of time for twelve months to complete improvements).

**BACKGROUND:** On August 28, 2007, the Board entered into agreements with MDM, LLC for the improvement of streets and the installation of a water system within the above referenced subdivision. Accompanying these agreements were faithful performance securities posted by Developers Surety and Indemnity Company as follows:

- \$517,000 - Bond #828859S for the completion of street improvements
- \$141,000 - Bond #828859S for the completion of the water system
- \$21,700 - Bond #828860S for the completion of the monumentation

The developer requests an extension of time for the completion of this project. Our records indicate that this project is approximately 30% completed for streets and utility work. The agreements for the extension of time have been approved by County Counsel.



Juan C. Pérez  
Director of Transportation

HS:lf  
 Submittals: Vicinity Map  
 Road/Drainage Agrmts  
 Water System Agrmts  
 Monumentation Agrmts

REVIEWED BY EXECUTIVE OFFICE

DATE 11/07/08  
 Departmental Concurrence Grande

FORM APPROVED COUNTY COUNSEL  
 BY: PAMELA J. WALLS  
 DATE 10/21/08

Dept's Recomm.:  Consent  
 Per Exec. Ofc.:  Consent

Policy  
 Policy

Prev. Agn. Ref. 08/28/07 - 2.41 | District: 1 | Agenda Number:

2.37

# Vicinity Map



The County of Riverside assumes no warranty or legal responsibility for the information contained on this map. Data and information represented on this map is subject to update, modifications and may not be complete or appropriate for all purposes. County GIS and other sources should be queried for the most current information. Do not copy or reuse this map.

## Tract 29652

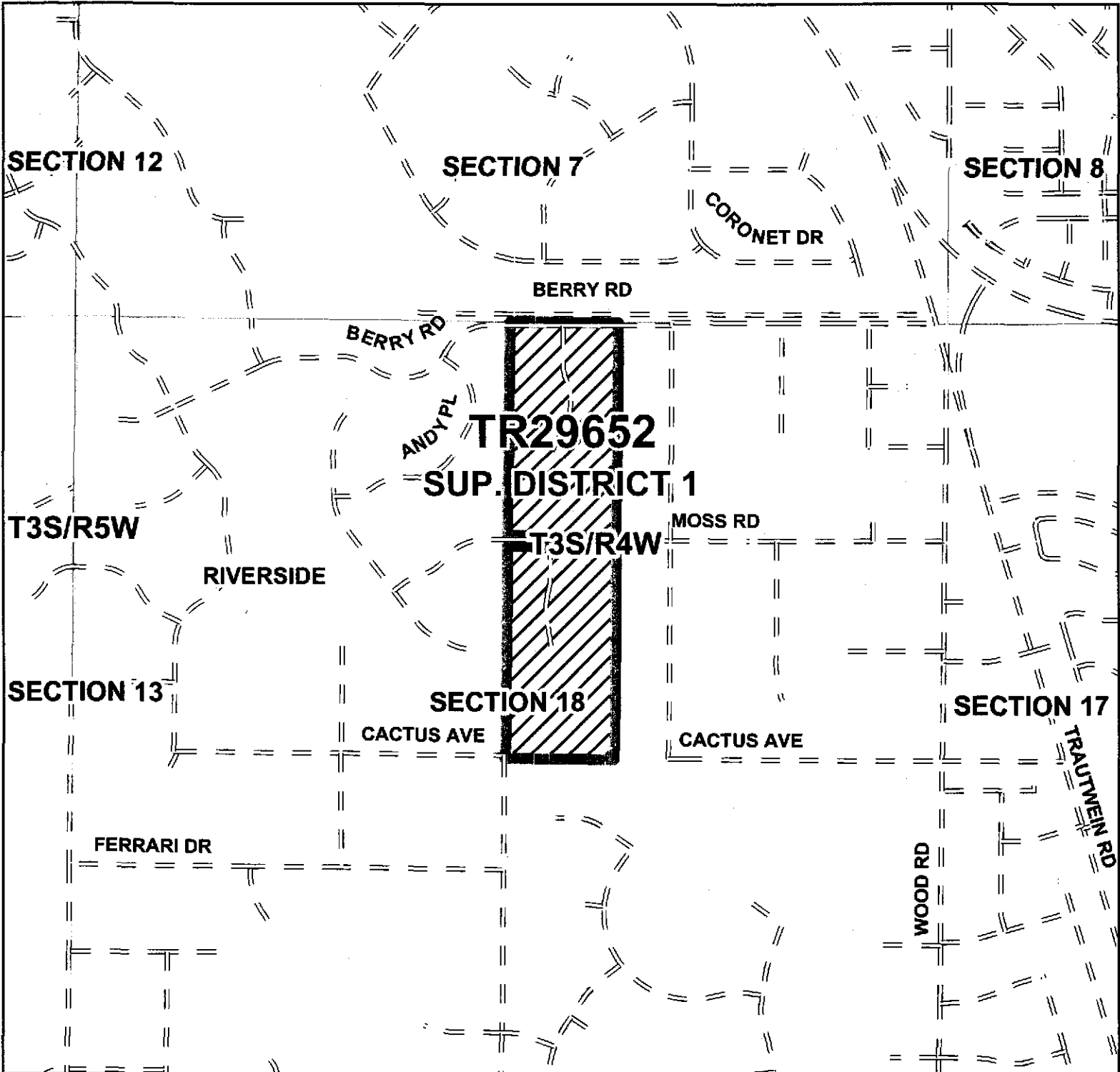

**TR29652**  
**SUP. DISTRICT 1**



### Roadway Legend

- |  |                             |             |
|--|-----------------------------|-------------|
| FEDERAL AID INTERSTATE; STATE HIGHWAYS | NON-COUNTY ROAD             | HWY         |
| F.A.S./F.A.U. MAINTAINED               | CITY ROAD                   | INTERCHANGE |
| PAVED SURFACE MAINTAINED               | UNDEFINED                   | INTERSTATE  |
| GRAVELED SURFACE MAINTAINED            | ABANDON                     | OFFRAMP     |
| DIRT SURFACE MAINTAINED                | VACATED                     | ONRAMP      |
| ACCEPTED FOR PUBLIC USE                | CITY OR WILDOMAR MAINTAINED | USHWY       |