

SUBMITTAL TO THE BOARD OF SUPERVISORS
COUNTY OF RIVERSIDE, STATE OF CALIFORNIA



211 B

FROM: TLMA - Transportation Department

SUBMITTAL DATE:
November 7, 2008

SUBJECT: Miscellaneous Case 3960
A Subdivision in the Lake Elsinore Area
Extension of Time Agreements

RECOMMENDED MOTION: That the Board approve the attached agreements (which grant an extension of time for twelve months to complete improvements).

BACKGROUND: On August 15, 2006, the Board entered into agreements with KB Home Coastal, Inc for the improvement of streets and the installation of a water and sewer system within the above referenced subdivision. Accompanying these agreements were faithful performance securities posted by Safeco Insurance Company of America as follows:

- \$3,451,500 - Bond #6311191 for the completion of street improvements
- \$53,500 - Bond #6311192 for the completion of the water system
- \$5,500 - Bond #6311193 for the completion of the sewer system

The developer requests an extension of time for the completion of this project. Our records indicate that this project is approximately 0% completed for streets and utility work. The agreements for the extension of time have been approved by County Counsel.



Juan C. Perez
Director of Transportation

HS:lf
Submittals: Vicinity Map
Road/Drainage Agrmts
Water System Agrmts
Sewer System Agrmts

REVIEWED BY EXECUTIVE OFFICE
DATE 11/10/08 *Jina Grande*
Departmental Concurrence

FORM APPROVED COUNTY COUNSEL
BY PAMELA J. WALLS DATE 10/12/08

Policy

Consent

Dept's Recomm.:
Per Exec. Ofc.:

Prev. Agn. Ref. 08/15/06 - 2.35 | District: 1 | Agenda Number:

ATTACHMENTS FILED
WITH THE CLERK OF THE BOARD

2.43



Miscellaneous Case 3960

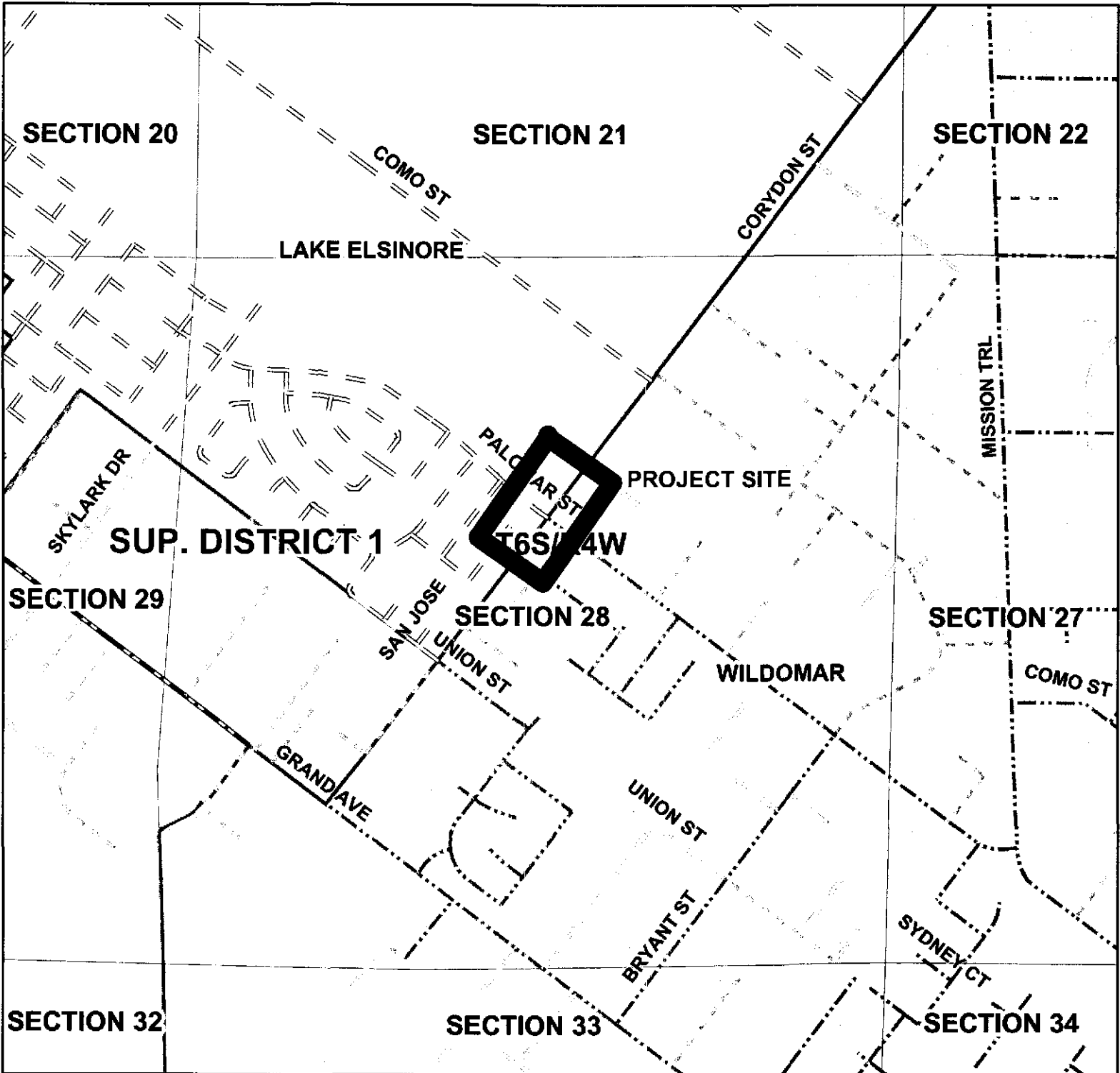

Roadway Legend

- | | | |
|--|---------------------------------|---------------|
| — FEDERAL AID INTERSTATE: STATE HIGHWAYS | --- NON-COUNTY ROAD | — HWY |
| — F.A.S./F.A.U. MAINTAINED | — CITY ROAD | — INTERCHANGE |
| — PAVED SURFACE MAINTAINED | — UNDEFINED | — INTERSTATE |
| --- GRAVELED SURFACE MAINTAINED | — ABANDON | — OFFRAMP |
| — DIRT SURFACE MAINTAINED | ... VACATED | — ONRAMP |
| --- ACCEPTED FOR PUBLIC USE | --- CITY OR WILDOMAR MAINTAINED | — USHWY |